

INSTRUCTION, WL-6A FOAM PADS INSTALLATION KIT

42" WL-6A - P/N 265959

48" WL-6A - P/N 265959-01

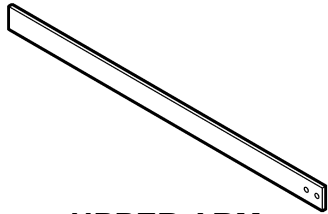

**UPPER ARM
FOAM PAD
QTY - 2**

**42" WL-6A - P/N 265978-01
48" WL-6A - P/N 265978-02**



**BASE SUPPORT
FOAM PAD
QTY - 2**

**42" WL-6A - P/N 265979-01
48" WL-6A - P/N 265979-01**

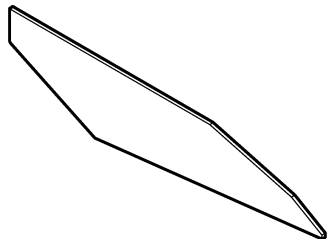

**RIGHT HAND SHIELD
FOAM PAD
QTY - 1**

**42" WL-6A - P/N 265980-02
48" WL-6A - P/N 265981-02**

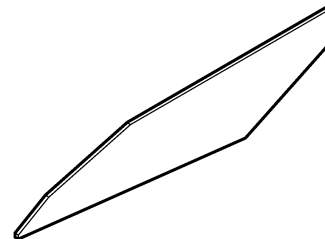

**LEFT HAND SHIELD
FOAM PAD
QTY - 1**

**42" WL-6A - P/N 265980-01
48" WL-6A - P/N 265981-01**

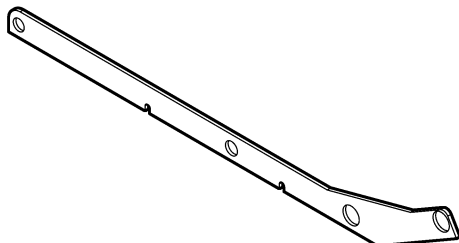

**RIGHT HAND
VERTICLE ARM
FOAM PAD
QTY - 1**

**42" WL-6A - P/N 265977-01
48" WL-6A - P/N 265977-02**

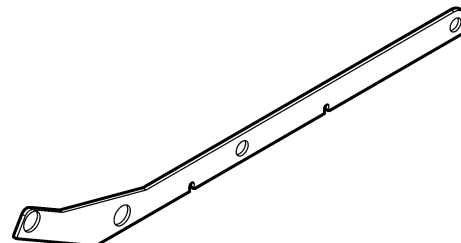

**LEFT HAND
VERTICLE ARM
FOAM PAD
QTY - 1**

**42" WL-6A - P/N 265977-03
48" WL-6A - P/N 265977-04**

1. Match all of the Foam Pads in the Kit to the lift as shown in **FIG.1**. Adhesive side of each Foam Pad must face the correct mounting surface on the lift (**FIG.1**).

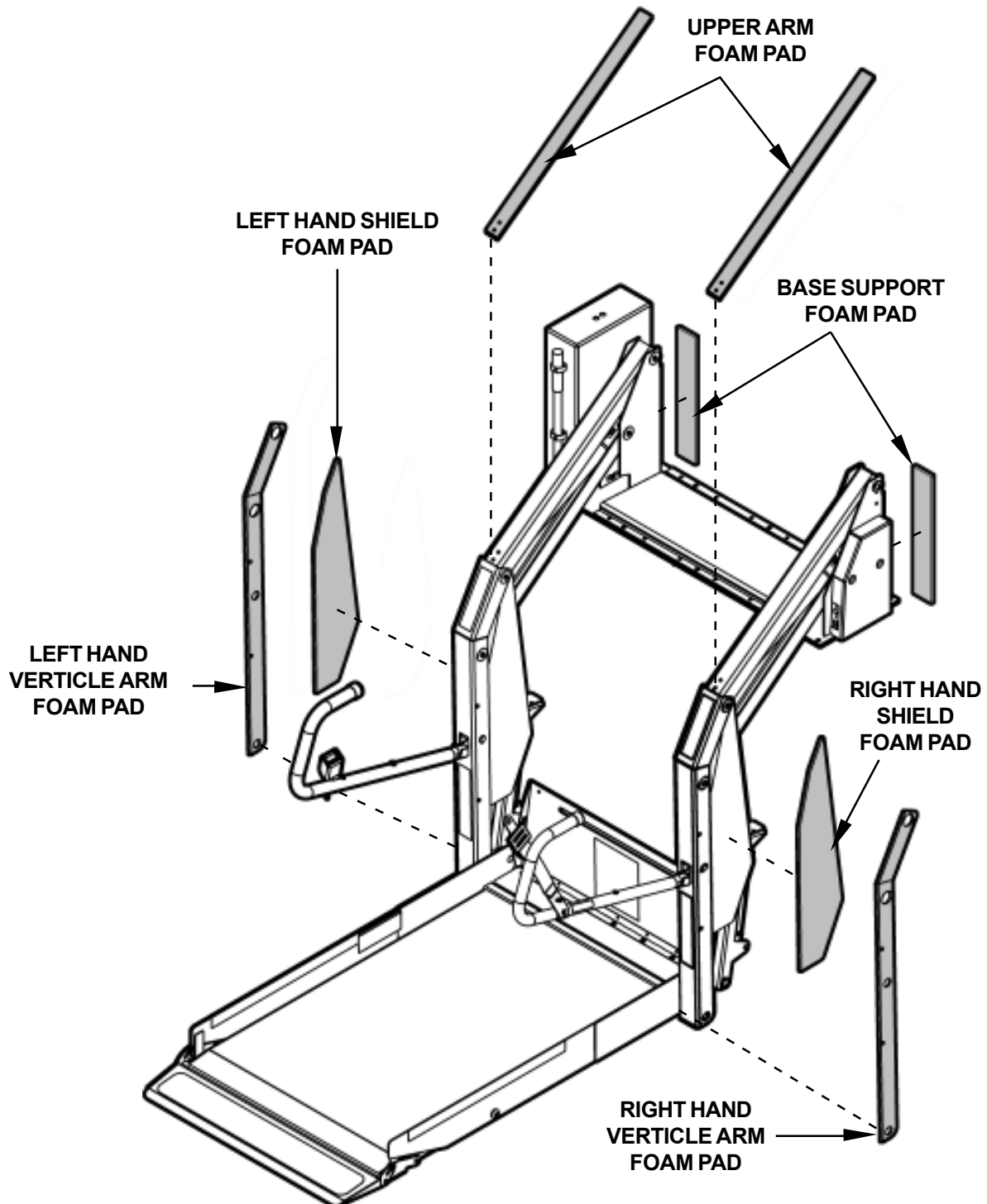

FIG. 1

2. Peel the protective backing (**FIG. 2B**) from each Foam Pad. Then apply each Foam Pad to the lift (**Fig.2A**).

NOTE: Foam Pads are shown shaded except for the 4 Pads hidden from view.

