

M-00-39
REV. L
SEPTEMBER 2015

MAXON®

INSTALLATION MANUAL

MTB-25 & MTB-30

TUK-A-WAY®
LIFT GATE SERIES

To find **maintenance & parts** information for your **MTB Liftgate**, go to www.maxonlift.com. Click the **PRODUCTS**, **TUK-A-WAY** & **MTB** buttons. Open the **Maintenance Manual** in the **PRODUCT DOCUMENTATION** window.

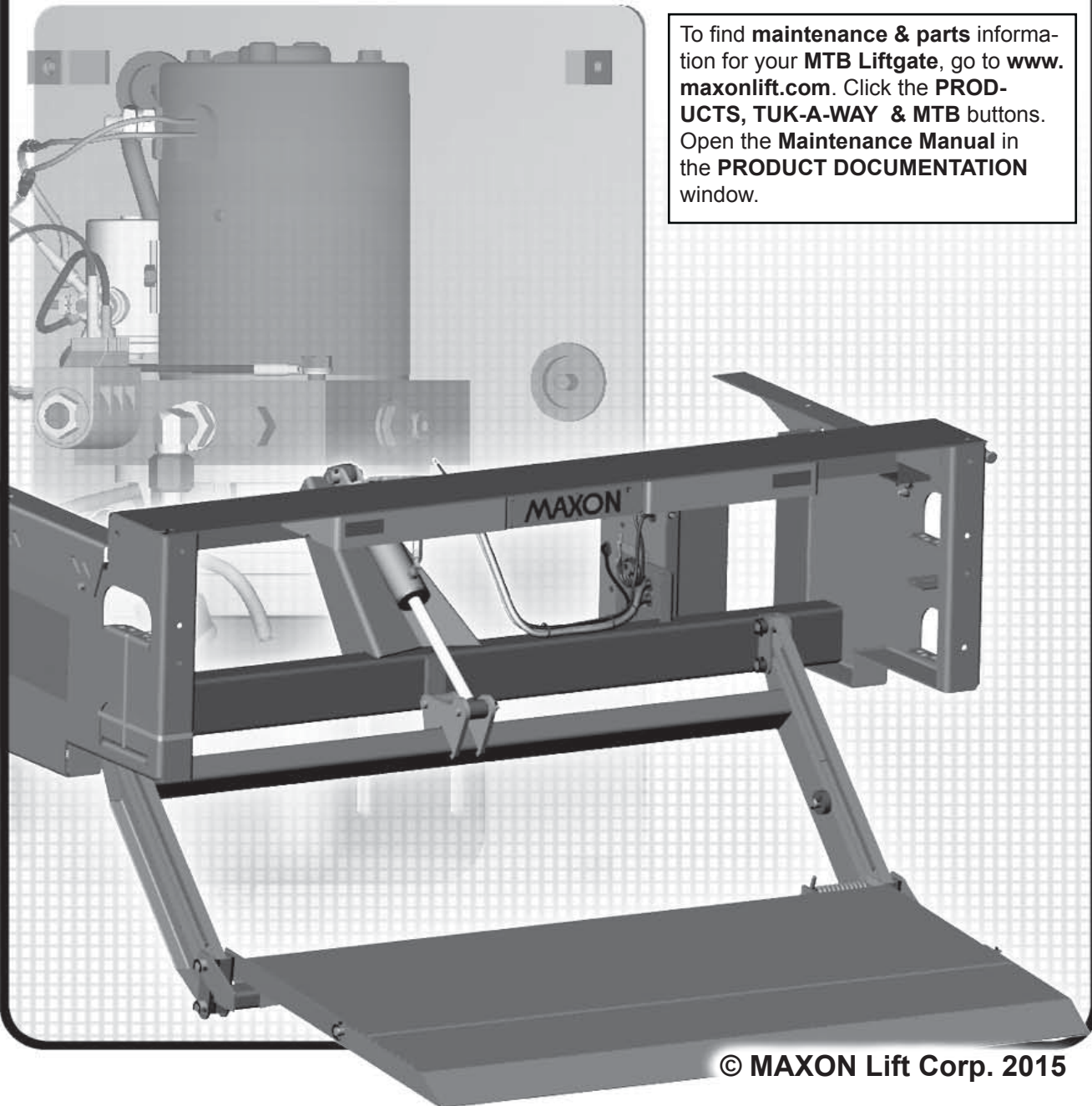

TABLE OF CONTENTS

| | |
|---|-----------|
| SUMMARY OF CHANGES: M-00-39, REVISION L | 4 |
| WARNINGS | 5 |
| SAFETY INSTRUCTIONS | 6 |
| NOTICE | 6 |
| MTB-25 & MTB-30 LIFTGATE COMPONENTS | 7 |
| PARTS BOX FOR MTB-25 GRAVITY DOWN | 8 |
| PARTS BOX FOR MTB-30 GRAVITY DOWN | 9 |
| PARTS BOX FOR MTB-25 POWER DOWN | 10 |
| PARTS BOX FOR MTB-30 POWER DOWN | 11 |
| STEP 1 - PREPARE VEHICLE | 12 |
| STEP 2 - MOUNT LIFTGATE ON VEHICLE BODY | 17 |
| OPTION 1 | 17 |
| OPTION 2 | 22 |
| STEP 3 - ATTACH OPTIONAL BATTERY BOX & FRAME TO VEHICLE (IF EQUIPPED) . | 28 |
| STEP 4 - RUN POWER CABLE..... | 35 |
| STEP 5 - CONNECT GROUND CABLE | 36 |
| STEP 6 - CONNECT POWER CABLE..... | 37 |
| STEP 7 - INSTALL CONTROL SWITCH | 38 |
| STEP 8 - CONNECT POWER CABLE TO BATTERY..... | 40 |
| STEP 9 - LOWER THE PLATFORM FOR ACCESS | 41 |
| STEP 10, PART A - WELDING METHOD FOR EXTENSION PLATE..... | 42 |
| STEP 10, PART B - BOLTING METHOD FOR EXTENSION PLATE..... | 43 |
| STEP 11 - PLATFORM ADJUSTMENT (IF REQUIRED) | 44 |
| STEP 12 - ADJUST SAFETY HOOK (IF REQUIRED) | 46 |
| STEP 13 - VEHICLE TAILLIGHT POSITIONING (IF REQUIRED)..... | 47 |
| ATTACH DECALS | 48 |
| TOUCHUP PAINT PRECAUTION | 49 |

TABLE OF CONTENTS - Continued

| | |
|---|-----------|
| HYDRAULIC SYSTEM DIAGRAMS | 50 |
| HYDRAULIC SCHEMATIC (GRAVITY DOWN)..... | 50 |
| HYDRAULIC SCHEMATIC (POWER DOWN) | 51 |
| ELECTRICAL SYSTEM DIAGRAMS | 52 |
| ELECTRICAL SCHEMATIC (GRAVITY DOWN) | 52 |
| ELECTRICAL SCHEMATIC (POWER DOWN)..... | 53 |
| OPTIONS | 54 |
| OPTIONAL LIFTGATE COMPONENTS..... | 54 |
| RUBBER DOCK BUMPER KIT | 55 |

Comply with the following **WARNINGS** and **SAFETY INSTRUCTIONS** while installing Liftgates. See Operation Manual for operating safety requirements.

⚠ WARNING

- Do not stand, or allow obstructions, under the platform when lowering the Liftgate. **Be sure your feet are clear of the Liftgate.**
- **Keep fingers, hands, arms, legs, and feet clear of moving Liftgate parts (and platform edges) when operating the Liftgate.**
- **Correctly stow platform when not in use. Extended platforms could create a hazard for people and vehicles passing by.**
- **Make sure vehicle battery power is disconnected** while installing Liftgate. Connect vehicle battery power to the Liftgate only when installation is complete or as required in the installation instructions.
- If it is necessary to stand on the platform while operating the Liftgate, keep your feet and any objects clear of the inboard edge of the platform. Your feet or objects on the platform can become trapped between the platform and the Liftgate extension plate.
- Never perform unauthorized modifications on the Liftgate. Modifications may result in early failure of the Liftgate and may create hazards for Liftgate operators and maintainers.
- Recommended practices for welding on steel parts are contained in the current **AWS (American Welding Society) D1.1 Structural Welding Code - Steel**. Damage to Liftgate and/or vehicle, and personal injury can result from welds that are done incorrectly.
- Welding on galvanized parts gives off especially hazardous fumes. Comply with WARNING decal on the galvanized part (**FIG. 5-1**). To minimize hazard remove galvanizing from weld area, provide adequate ventilation, and wear suitable respirator.

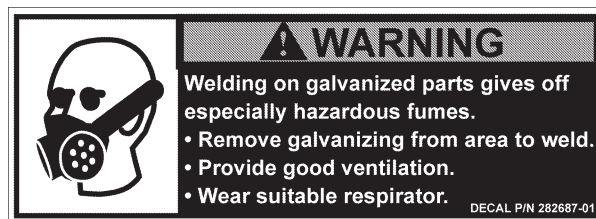

FIG. 5-1

SAFETY INSTRUCTIONS

- Read and understand the instructions in this **Installation Manual** before installing Liftgate.
- Before operating the Liftgate, read and understand the operating instructions in **Operation Manual**.
- Comply with all **WARNING** and instruction decals attached to the Liftgate.
- Keep decals clean and legible. If decals are illegible or missing, replace them. Free replacement decals are available from **Maxon Customer Service**.
- Consider the safety and location of bystanders and location of nearby objects when operating the Liftgate. Stand to one side of the platform while operating the Liftgate.
- Do not allow untrained persons to operate the Liftgate.
- Wear appropriate safety equipment such as protective eyeglasses, faceshield and clothing while performing maintenance on the Liftgate and handling the battery. Debris from drilling and contact with battery acid may injure unprotected eyes and skin.
- Be careful working by an automotive type battery. Make sure the work area is well ventilated and there are no flames or sparks near the battery. Never lay objects on the battery that can short the terminals together. If battery acid gets in your eyes, immediately seek first aid. If acid gets on your skin, immediately wash it off with soap and water.
- If an emergency situation arises (vehicle or Liftgate) while operating the Liftgate, release the control switch to stop the Liftgate.
- A correctly installed Liftgate operates smoothly and reasonably quiet. The only noticeable noise during operation comes from the power unit while the platform is raised and lowered. Listen for scraping, grating and binding noises and correct the problem before continuing to operate Liftgate.

NOTICE

- Maxon Lift is responsible for the instructions to correctly install **MAXON** Liftgates on trucks or trailers only.
- Liftgate installers, not Maxon Lift, are responsible for reviewing and complying with all applicable Federal, State, and Local regulations pertaining to the trailer or truck.
- Installers of the liftgate should ensure that all trucks and trailers are equipped with grab handles as needed.

MTB-25 & MTB-30 LIFTGATE COMPONENTS

⚠ CAUTION

Prevent injuries and equipment damage. Before cutting the shipping straps from the Liftgate, put Liftgate on level ground that will support at least 1500 pounds. Be careful lifting and moving components (such as extension plate) after shipping straps are removed.

NOTE: Make sure you have all components and parts before you start installing Liftgate. Compare parts in the part box and each kit box with packing list enclosed in each box. If parts and components are missing or incorrect, call:

Maxon Customer Service

Call (800) 227-4116 or

Send e-mail to customersupport@maxonlift.com

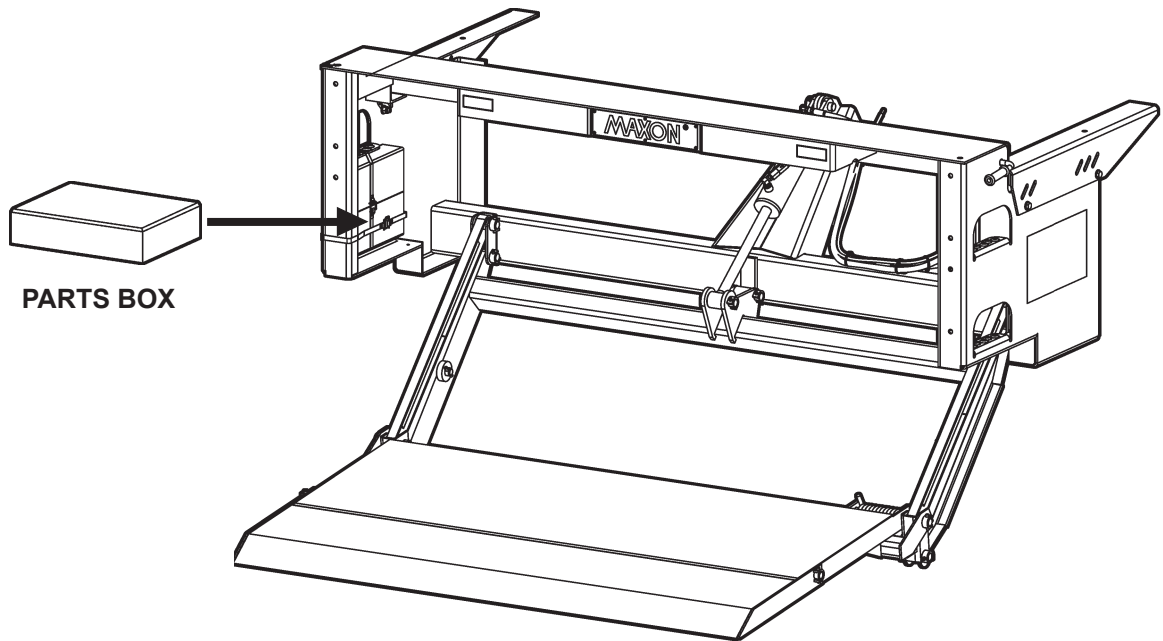

MTB-25 & MTB-30 LIFTGATE

MTB-25 & MTB-30 COMPONENTS

FIG. 7-1

11921 Slauson Ave. Santa Fe Springs, CA. 90670 (800) 227-4116 FAX (888) 771-7713

MAXON[®]

PARTS BOX FOR MTB-25 GRAVITY DOWN

NOTE: To find **maintenance & parts** information for your **MTB Liftgate**, go to **www.maxonlift.com**. Click the **PRODUCTS, TUK-A-WAY & MTB** buttons. Open the **Maintenance Manual** in the **PRODUCT DOCUMENTATION** window.

| ITEM | QTY. | PART NO. | DESCRIPTION |
|------------|------|-----------|-------------------------------------|
| REF | 1 | 280455-01 | PARTS BOX, MTB-25 (GRAVITY DOWN) |
| 1 | 15 | 050079 | CLIP FRAME |
| 2 | 4 | 205780 | PLASTIC TIE, 7" |
| 3 | 1 | 264422 | CABLE ASSEMBLY, 175 AMP, 38 FT. LG. |
| 4 | 1 | 267959-01 | MOLDED SWITCH ASSEMBLY |
| 5 | 1 | 280454-01 | KIT, MANUAL & DECAL, MTB-25 |
| 5A | 1 | M-00-39 | MANUAL, INSTALLATION MTB-25/30 |
| 5B | 1 | M-00-40 | MANUAL, OPERATION MTB-25/30 |
| 5C | 1 | 264507 | DECAL UP & DOWN |
| 5D | 1 | 265438 | DECAL WARNING & LOGO MTB-25 (SPARE) |
| 5E | 2 | 265736-03 | DECAL,WARNING PINCH HAZARD (SPARE) |
| 5F | 2 | 282847-02 | DECAL,WARNING,STOW,TUK-A-WAY |
| 6 | 1 | 900009-2 | CAP SCREW, 5/16"-18 X 1" LG, GR8 |
| 7 | 2 | 900057-5 | SCREW, SELF TAP, 10-24 X 1" LG. |
| 8 | 1 | 901001 | LOCK NUT, 5/16"-18 |
| 9 | 10 | 901023 | LOCK NUT, FLANGE |
| 10 | 10 | 901024-2 | HEX BOLT, 1/2"-13 X 1-3/4" LG. |
| 11 | 1 | 902000-7 | FLAT WASHER, 5/16" |
| 12 | 1 | 903400-01 | WASHER, EXTERNAL TOOTH, 5/16" I.D. |
| 13 | 1 | 905286-01 | HEAT-SHRINK TUBING, 4" LG. |
| 14 | 1 | 906497-02 | LUG, 2GA, 5/16" |
| 15 | 1 | 907038 | SPLICER REDUCER |

TABLE 8-1

PARTS BOX FOR MTB-30 GRAVITY DOWN

NOTE: To find maintenance & parts information for your **MTB Liftgate**, go to www.maxonlift.com. Click the **PRODUCTS, TUK-A-WAY & MTB** buttons. Open the **Maintenance Manual** in the **PRODUCT DOCUMENTATION** window.

| ITEM | QTY. | PART NO. | DESCRIPTION |
|------------|------|-----------|-------------------------------------|
| REF | 1 | 280455-02 | PARTS BOX, MTB-30 (GRAVITY DOWN) |
| 1 | 15 | 050079 | CLIP FRAME |
| 2 | 4 | 205780 | PLASTIC TIE, 7" |
| 3 | 1 | 264422 | CABLE ASSEMBLY, 175 AMP, 38 FT. LG. |
| 4 | 1 | 267959-01 | MOLDED SWITCH ASSEMBLY |
| 5 | 1 | 280454-02 | KIT, MANUAL & DECAL, MTB-30 |
| 5A | 1 | M-00-39 | MANUAL, INSTALLATION MTB-25/30 |
| 5B | 1 | M-00-40 | MANUAL, OPERATION MTB-25/30 |
| 5C | 1 | 264507 | DECAL UP & DOWN |
| 5D | 1 | 265439 | DECAL WARNING & LOGO MTB-30 (SPARE) |
| 5E | 2 | 265736-03 | DECAL,WARNING PINCH HAZARD (SPARE) |
| 5F | 2 | 282847-02 | DECAL,WARNING,STOW,TUK-A-WAY |
| 6 | 1 | 900009-2 | CAP SCREW, 5/16"-18 X 1" LG, GR8 |
| 7 | 2 | 900057-5 | SCREW, SELF TAP, 10-24 X 1" LG. |
| 8 | 1 | 901001 | LOCK NUT, 5/16"-18 |
| 9 | 10 | 901023 | LOCK NUT, FLANGE |
| 10 | 10 | 901024-2 | HEX BOLT, 1/2"-13 X 1-3/4" LG. |
| 11 | 1 | 902000-7 | FLAT WASHER, 5/16" |
| 12 | 1 | 903400-01 | WASHER, EXTERNAL TOOTH, 5/16" I.D. |
| 13 | 1 | 905286-01 | HEAT-SHRINK TUBING, 4" LG. |
| 14 | 1 | 906497-02 | LUG, 2GA, 5/16" |
| 15 | 1 | 907038 | SPLICER REDUCER |

TABLE 9-1

PARTS BOX FOR MTB-25 POWER DOWN

NOTE: To find **maintenance & parts** information for your **MTB Liftgate**, go to **www.maxonlift.com**. Click the **PRODUCTS, TUK-A-WAY & MTB** buttons. Open the **Maintenance Manual** in the **PRODUCT DOCUMENTATION** window.

| ITEM | QTY. | PART NO. | DESCRIPTION |
|------|------|-----------|-------------------------------------|
| REF | 1 | 280455-03 | PARTS BOX, MTB-25 (POWER DOWN) |
| 1 | 15 | 050079 | CLIP FRAME |
| 2 | 4 | 205780 | PLASTIC TIE, 7" |
| 3 | 1 | 264422 | CABLE ASSEMBLY, 175 AMP, 38 FT. LG. |
| 4 | 1 | 264951-04 | MOLDED SWITCH & CABLE ASSEMBLY |
| 5 | 2 | 280454-01 | KIT, MANUAL & DECAL, MTB-25 |
| 5A | 1 | M-00-39 | MANUAL, INSTALLATION MTB-25/30 |
| 5B | 1 | M-00-40 | MANUAL, OPERATION MTB-25/30 |
| 5C | 1 | 264507 | DECAL UP & DOWN |
| 5D | 1 | 265438 | DECAL WARNING & LOGO MTB-25 (SPARE) |
| 5E | 2 | 265736-03 | DECAL,WARNING PINCH HAZARD (SPARE) |
| 5F | 1 | 282847-02 | DECAL,WARNING,STOW,TUK-A-WAY |
| 6 | 1 | 900009-2 | CAP SCREW, 5/16"-18 X 1" LG, GR8 |
| 7 | 2 | 900057-5 | SCREW, SELF TAP, 10-24 X 1" LG. |
| 8 | 1 | 901001 | LOCK NUT, 5/16"-18 |
| 9 | 10 | 901023 | LOCK NUT, FLANGE |
| 10 | 10 | 901024-2 | HEX BOLT, 1/2"-13 X 1-3/4" LG. |
| 11 | 1 | 902000-7 | FLAT WASHER, 5/16" |
| 12 | 1 | 903400-01 | WASHER, EXTERNAL TOOTH, 5/16" I.D. |
| 13 | 1 | 905286-01 | HEAT-SHRING TUBING, 4" LG. |
| 14 | 1 | 906497-02 | LUG, 2GA, 5/16" |
| 15 | 1 | 907038 | SPLICER REDUCER |

TABLE 10-1

PARTS BOX FOR MTB-30 POWER DOWN

NOTE: To find **maintenance & parts** information for your **MTB Liftgate**, go to www.maxonlift.com. Click the **PRODUCTS, TUK-A-WAY & MTB** buttons. Open the **Maintenance Manual** in the **PRODUCT DOCUMENTATION** window.

| ITEM | QTY. | PART NO. | DESCRIPTION |
|------------|------|-----------|-------------------------------------|
| REF | 1 | 280455-04 | PARTS BOX, MTB-30 (POWER DOWN) |
| 1 | 15 | 050079 | CLIP FRAME |
| 2 | 4 | 205780 | PLASTIC TIE, 7" |
| 3 | 1 | 264422 | CABLE ASSEMBLY, 175 AMP, 38 FT. LG. |
| 4 | 1 | 264951-04 | MOLDED SWITCH & CABLE ASSEMBLY |
| 5 | 1 | 280454-02 | KIT, MANUAL & DECAL, MTB-30 |
| 5A | 1 | M-00-39 | MANUAL, INSTALLATION MTB-25/30 |
| 5B | 1 | M-00-40 | MANUAL, OPERATION MTB-25/30 |
| 5C | 1 | 264507 | DECAL UP & DOWN |
| 5D | 1 | 265439 | DECAL WARNING & LOGO MTB-30 (SPARE) |
| 5E | 2 | 265736-03 | DECAL, WARNING PINCH HAZARD (SPARE) |
| 5F | 2 | 282847-02 | DECAL, WARNING, STOW, TUK-A-WAY |
| 6 | 1 | 900009-2 | CAP SCREW, 5/16"-18 X 1" LG, GR8 |
| 7 | 2 | 900057-5 | SCREW, SELF TAP, 10-24 X 1" LG. |
| 8 | 1 | 901001 | LOCK NUT, 5/16"-18 |
| 9 | 10 | 901023 | LOCK NUT, FLANGE |
| 10 | 10 | 901024-2 | HEX BOLT, 1/2"-13 X 1-3/4" LG. |
| 11 | 1 | 902000-7 | FLAT WASHER, 5/16" |
| 12 | 1 | 903400-01 | WASHER, EXTERNAL TOOTH, 5/16" I.D. |
| 13 | 1 | 905286-01 | HEAT-SHRING TUBING, 4" LG. |
| 14 | 1 | 906497-02 | LUG, 2GA, 5/16" |
| 15 | 1 | 907038 | SPLICER REDUCER |

TABLE 11-1

STEP 1 - PREPARE VEHICLE

TRUCK BODY STRENGTH REQUIREMENTS

⚠ WARNING

Consult truck body manufacturer for truck body strength data. Make sure the forces created by the Liftgate are within the limits prescribed by truck body manufacturer.

The MTB-25 and MTB-30 are body-mounted Liftgates that put force on the back of the truck body as shown in **FIG 12-1**. For correct installation, truck body must be able to withstand the vertical force and moment of force shown.

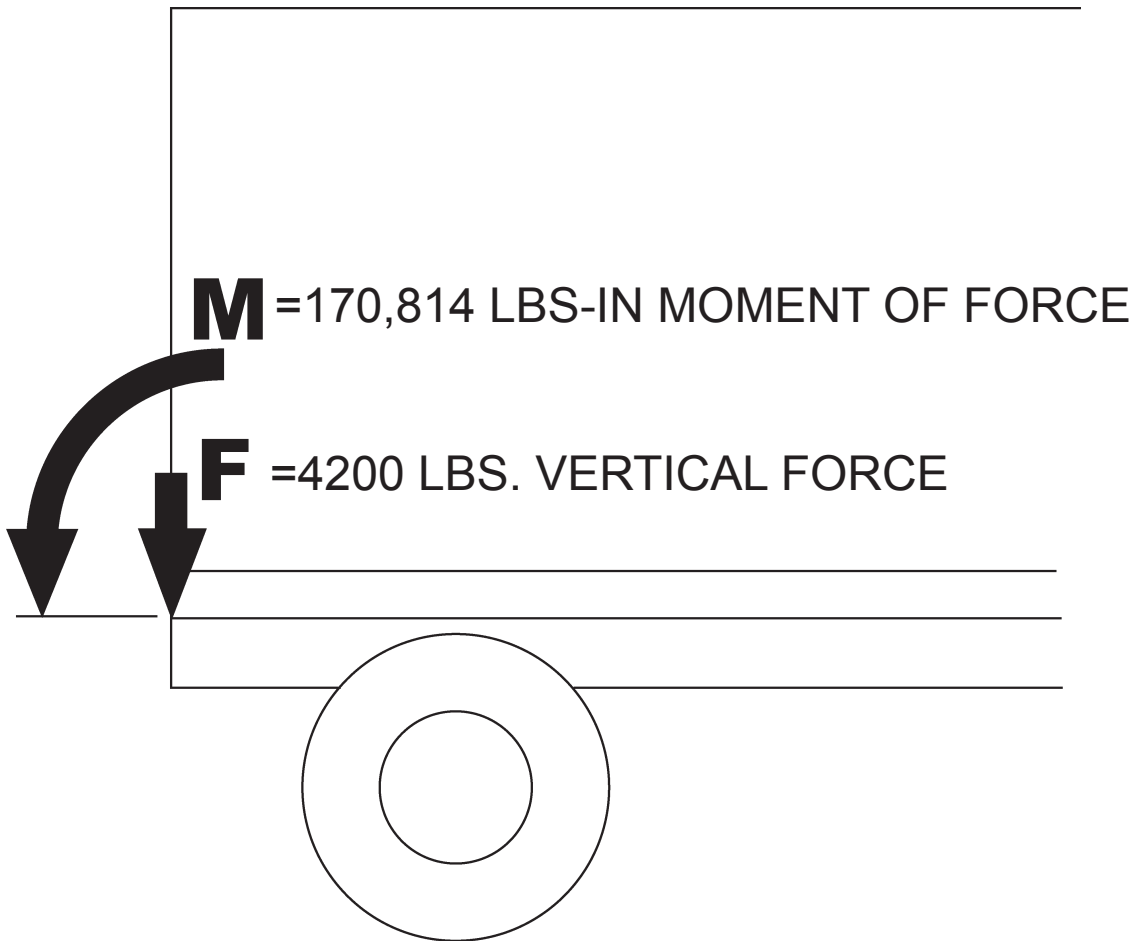

FIG. 12-1

STEP 1 - PREPARE VEHICLE - Continued

NOTE: Make sure vehicle is parked on level ground while preparing vehicle and installing Liftgate.

NOTE: Dimensions are provided as a reference only for fitting Liftgate to vehicle body.

NOTE: Measure the width of the Liftgate and the width of the vehicle body before you start doing this procedure. Ensure the Liftgate is the correct width for vehicle.

NOTE: BODY Maximum and Minimum Operating Bed Height:

For Standard Platform and Platform with Aluminum Retention Ramp -
Maximum height is 54" (Unloaded). Minimum height is 43" (Loaded).

For Wedge Platform -

Maximum height is 54" (Unloaded). Minimum height is 48" (Loaded).

Do not install this Liftgate on vehicle bodies equipped with swing open doors.

1. Check for correct clearances (**FIG. 13-1**) on vehicle to prevent interference between vehicle and Liftgate.

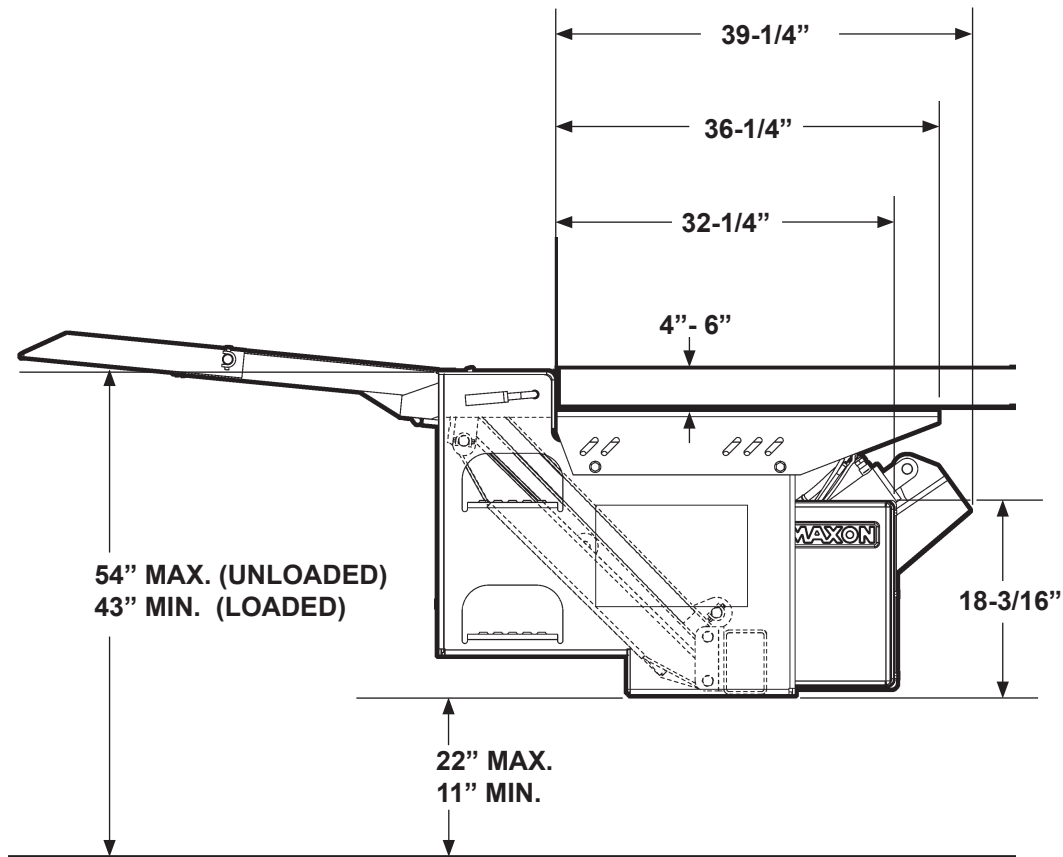

CLEARANCE FOR MTB-25 & MTB-30
FIG. 13-1

STEP 1 - PREPARE VEHICLE - Continued

NOTE: The platform cutout area shown below applies to trucks and trailers.

NOTE: The dimensions shown below are maximums except as indicated.

2. Fit the Liftgate to truck body by cutting frame as shown in **FIG. 14-1**.

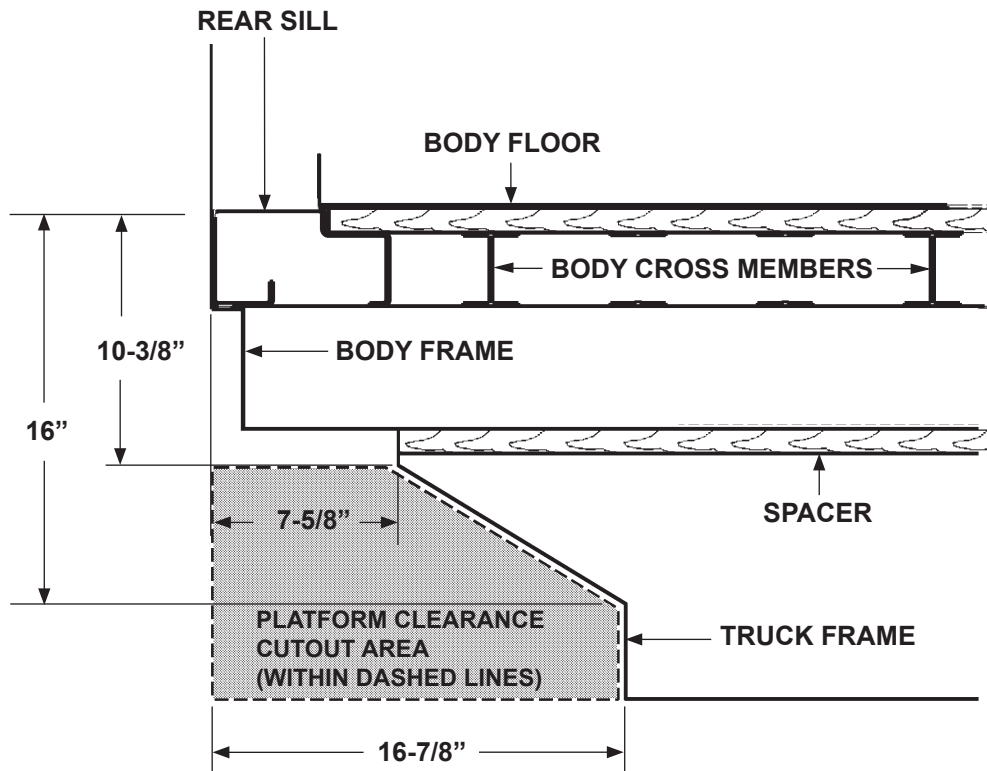

VEHICLE FRAME CUT FOR MTB-25 & MTB-30
FIG. 14-1

STEP 1 PREPARE VEHICLE - Continued

CAUTION

Before installing Liftgate on a truck body, attach truck body to truck frame to prevent body from moving out of position. Use body manufacturer's prescribed method for attaching body to frame.

3. Measure distance from vehicle body floor to bottom of rear sill as shown in **FIG. 15-1**. Note minimum and maximum rear sill thickness (**FIG. 15-1**) required for Liftgate to fit correctly.

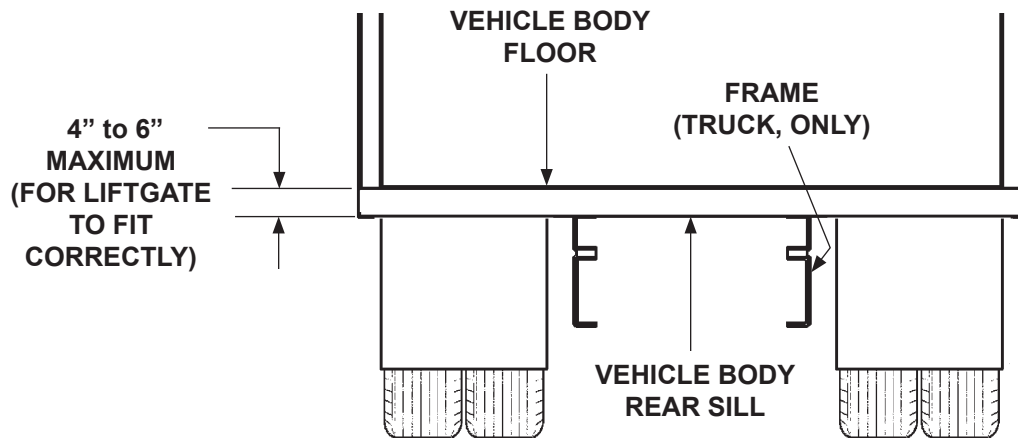

FIG. 15-1

STEP 1 PREPARE VEHICLE - Continued

DRILL HOLES IN VEHICLE BODY

NOTE: If you are going to weld the extension plate onto the truck body, skip this drilling step and go to next item.

4. Measure, mark, and drill (11) 9/16" holes on vehicle body as shown in **FIG. 16-1**.

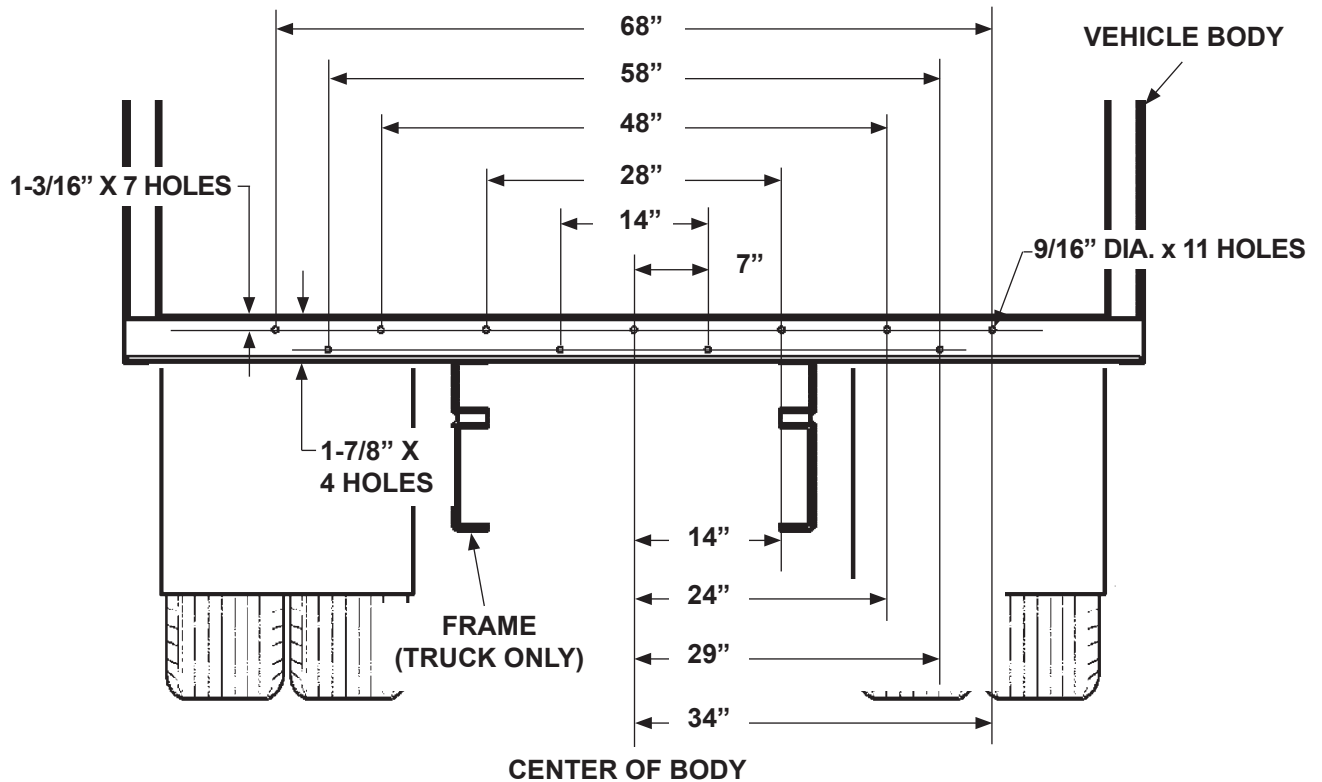

**DRILLING BOLT HOLES IN VEHICLE BODY
(REAR VIEW OF VEHICLE BODY)
FIGURE 16-1**

STEP 2 - MOUNT LIFTGATE ON VEHICLE BODY OPTION 1

NOTE: Do the **OPTION 1** or **OPTION 2** procedure to mount Liftgate on vehicle body. The **OPTION 1** procedure is for first welding mounting angles to vehicle body. The Liftgate is bolted to mounting angles. In the **OPTION 2** procedure, mounting angles are bolted to Liftgate and then welded to vehicle body.

NOTE: Save the 4 bolts, flat washers, and lock nuts removed from mounting angles. Reuse to secure Liftgate to mounting angles near the end of this **OPTION 1** procedure.

1. Unbolt the mounting angles and shims from Liftgate (**FIG. 17-1**).

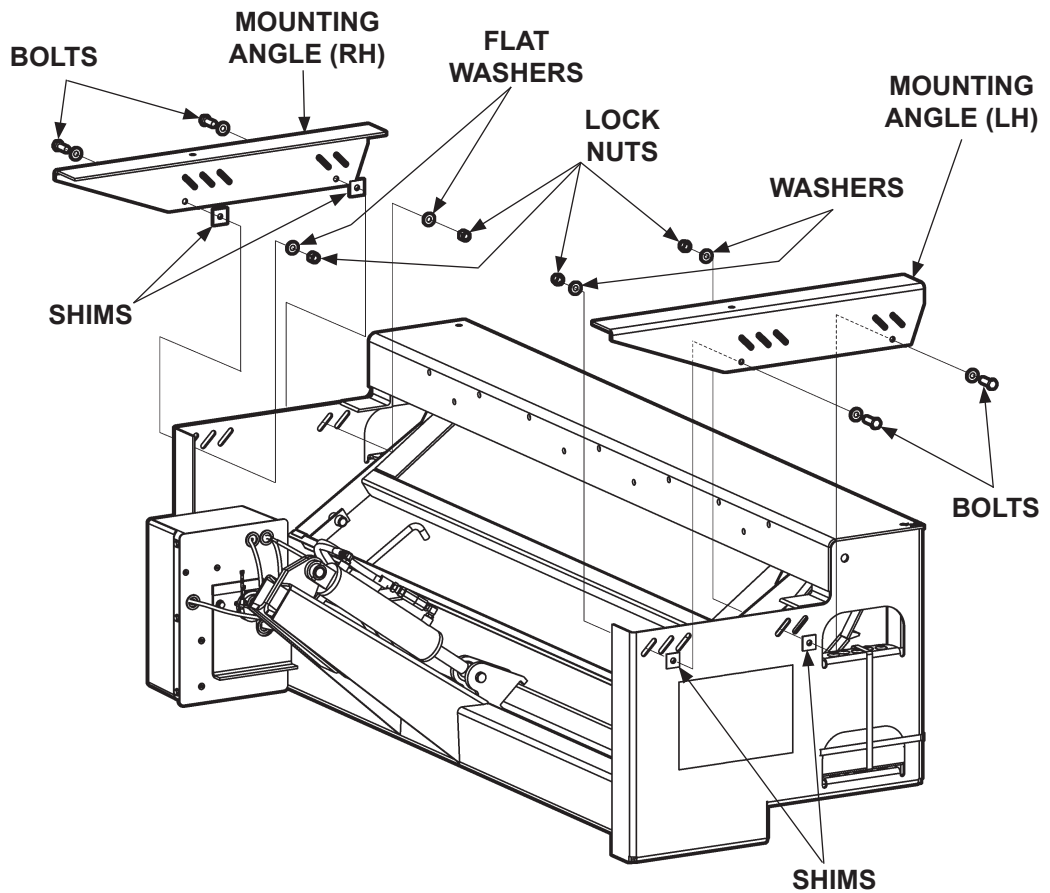

UNBOLTING MOUNTING ANGLES

FIG. 17-1

STEP 2 - MOUNT LIFTGATE ON VEHICLE BODY - Continued OPTION 1

- Position 2 mounting angles against bottom of the truck body cross members (FIGS. 18-1A and 18-1B).
Tack weld each angle in place (FIG. 18-1A).

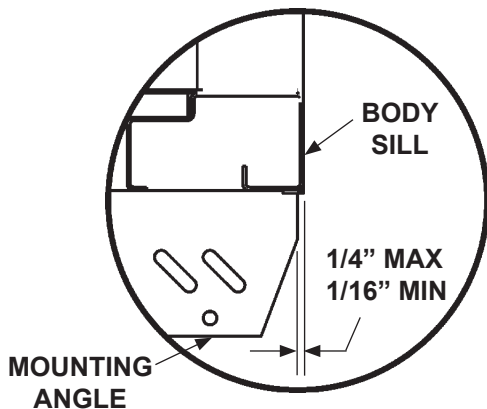

**LH SIDE VIEW OF BODY SILL
& MOUNTING ANGLE
FIG. 18-1B**

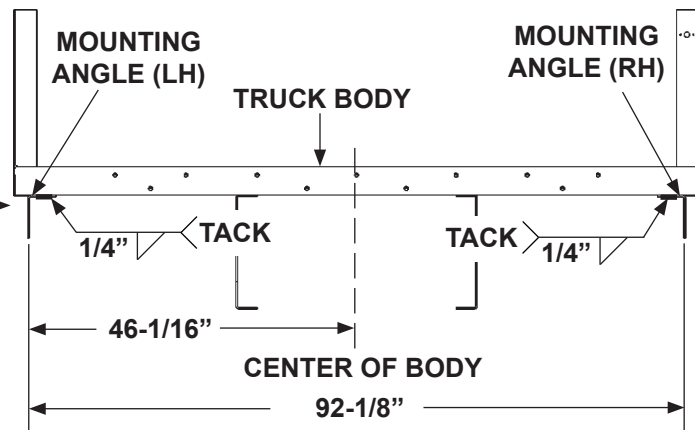

**POSITIONING MOUNTING ANGLES ON
TRUCK BODY
FIG. 18-1A**

- Weld the 2 mounting angles to the truck body cross members (FIG. 18-2).

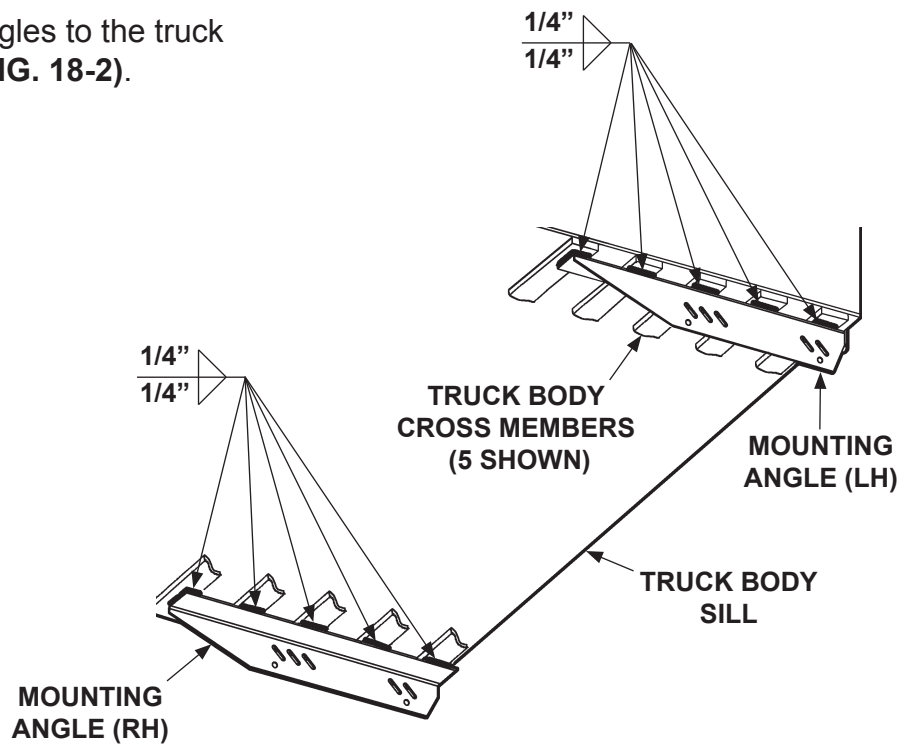

**WELDING MOUNTING PLATES
(VIEW UNDER TRUCK BODY)
FIG. 18-2**

STEP 2 - MOUNT LIFTGATE ON VEHICLE BODY - Continued OPTION 1

⚠ WARNING

Keep Liftgate clamped to forklift until Liftgate is welded (or bolted if required) to vehicle body. Liftgate may be damaged and create a hazard for the installer if it falls off the forklift.

NOTE: Rest the Liftgate extension plate against the forklift mast.

4. Secure Liftgate to forklift with “C”-clamps as shown in **FIGS. 19-1A, 19-1B and 19-1C**. Use an 8' length of 4" x 4" steel tubing to help support the Liftgate with forklift (**FIGS. 19-1A and 19-1C**).

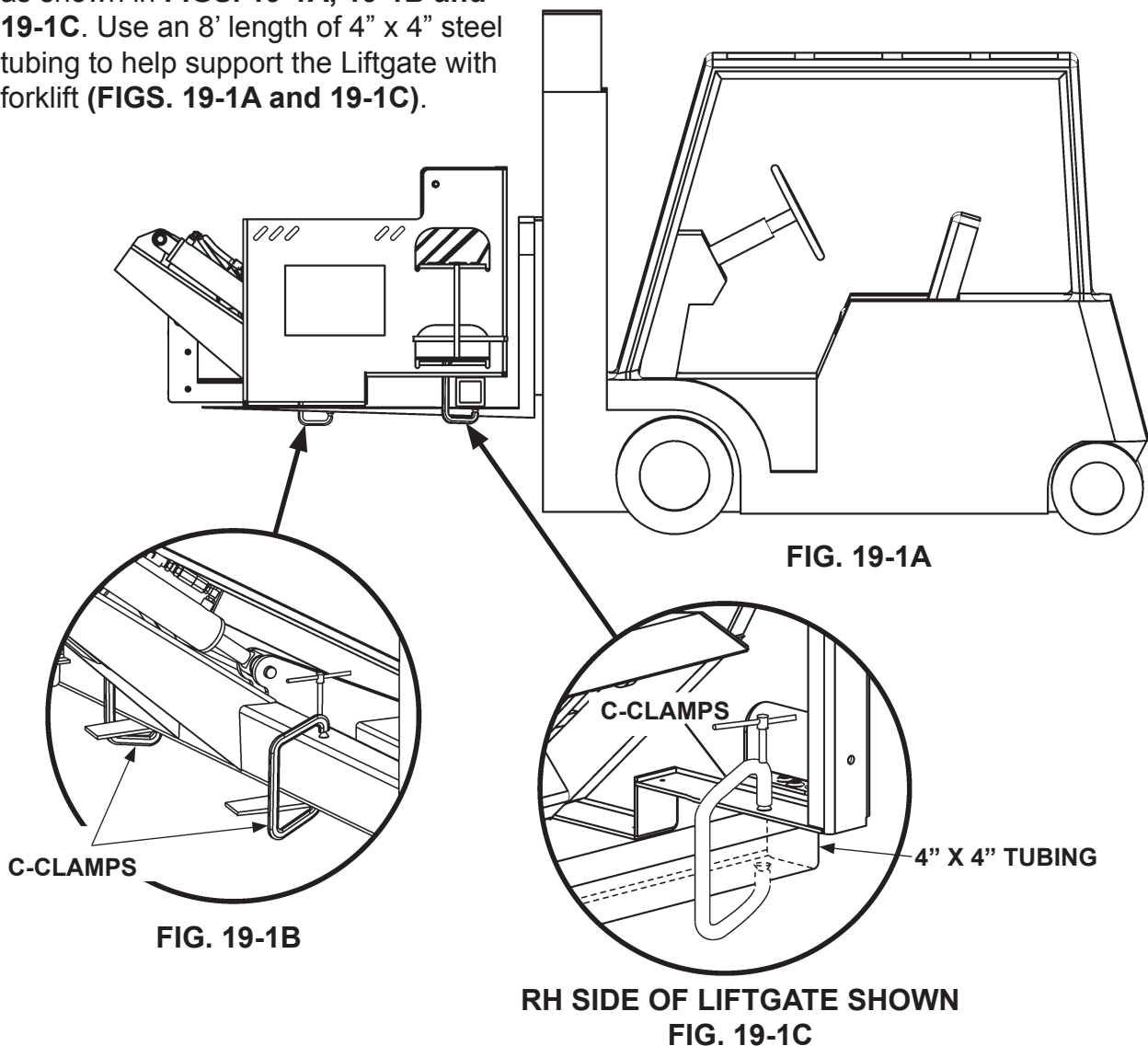

5. Use forklift to center the Liftgate in position on the back of the truck body (**FIG. 19-1A**). If necessary, have 1 person operate the forklift and another person check alignment of Liftgate and truck body.

STEP 2 - MOUNT LIFTGATE ON VEHICLE BODY - Continued OPTION 1

6. Position the Liftgate against the truck body (**FIG. 20-1**). Make sure extension plate fits tight against body sill.

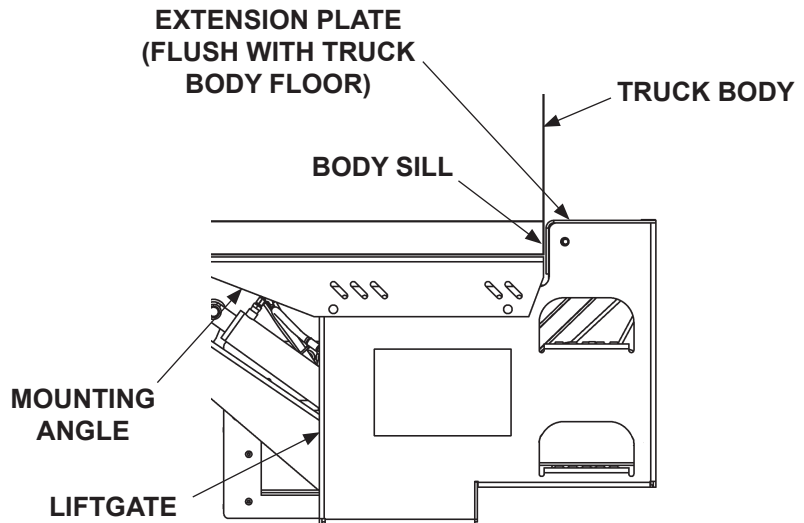
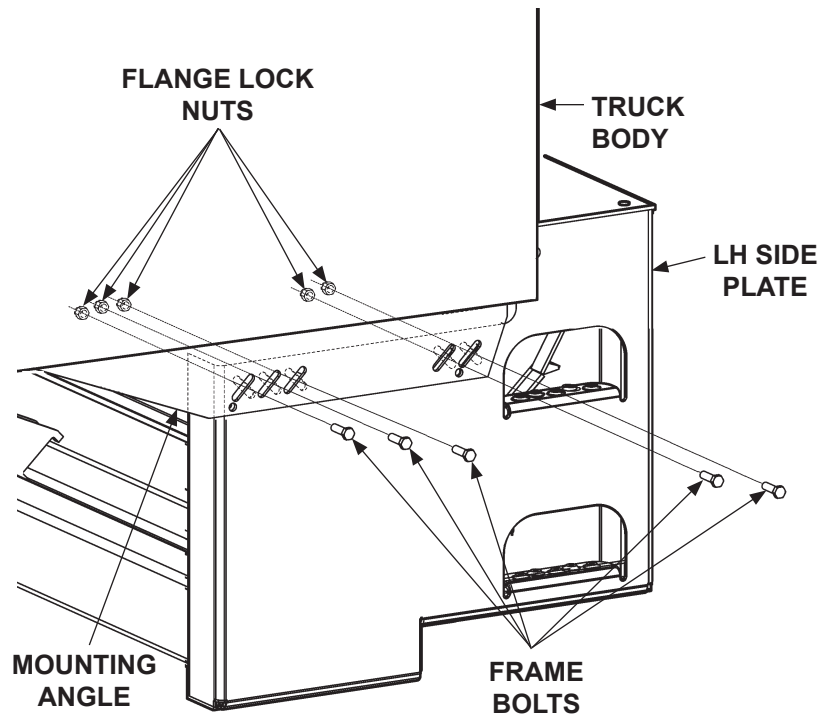

FIG. 20-1

7. Bolt the LH and RH side plates to the mounting angles on the truck body (**FIG. 20-2**). Use 5 bolts and 5 flange lock nuts from part box for each side plate (**FIG. 20-2**).



**BOLTING LH SIDE PLATE
FIG. 20-2**

8. Tighten the 5 flange lock nuts. Torque each of the flange lock nuts (**FIG. 20-2**) to 105 lbs-ft.

STEP 2 - MOUNT LIFTGATE ON VEHICLE BODY - Continued OPTION 1

NOTE: To bolt the 2 mounting angles to the Liftgate, use the 4 bolts, flat washers, and lock nuts saved at start of this **OPTION 1** procedure.

9. Using mounting angle as a template, drill 2 matching holes in the LH side plate (**FIG. 21-1**). Repeat for RH side plate.

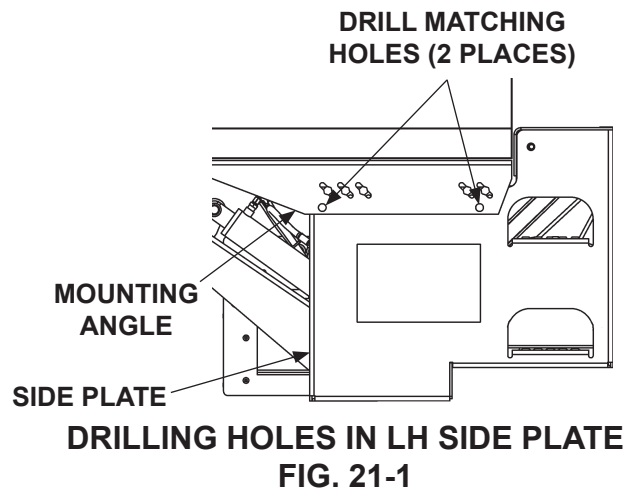

10. Bolt mounting angle to LH side plate (**FIG. 21-2**). Torque each of the lock nuts to **105 lbs-ft.** Repeat for RH side plate.

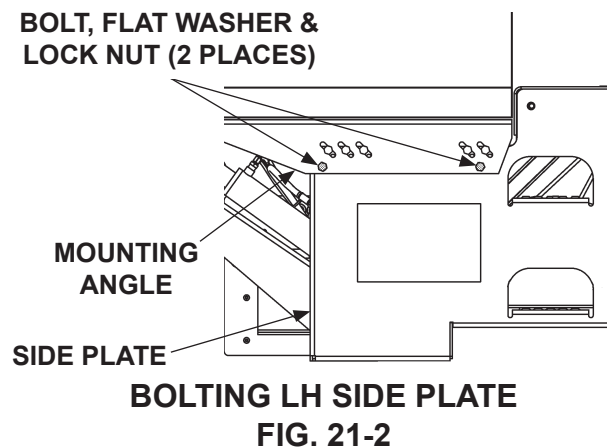

11. Remove "C"-clamps from Liftgate (**FIG. 21-3**). Back out forklift.

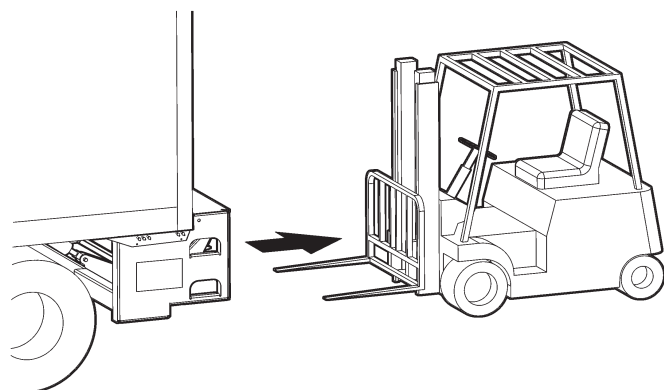

STEP 2 - MOUNT LIFTGATE ON VEHICLE BODY - Continued OPTION 2

1. Measure record distance "S" from vehicle body floor to bottom of rear body sill as shown in FIG. 22-1.

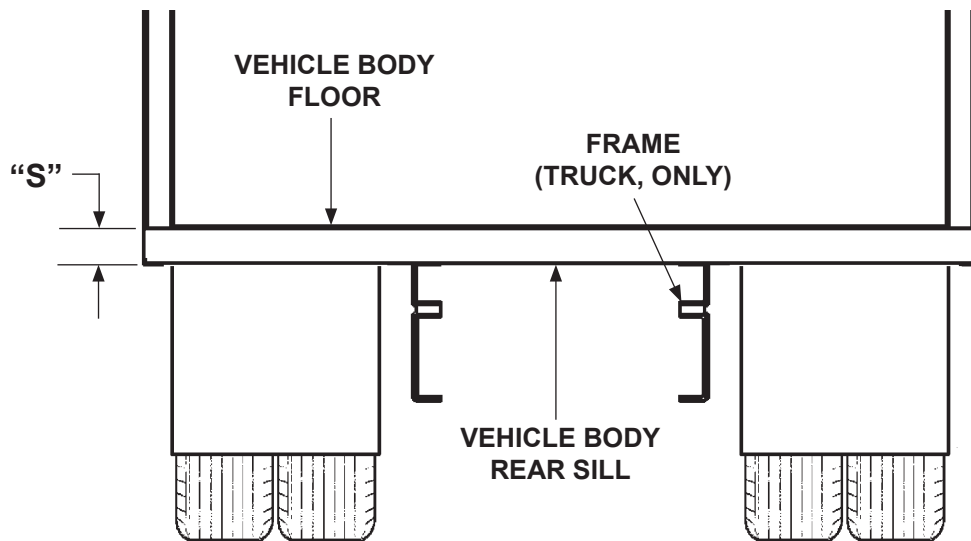
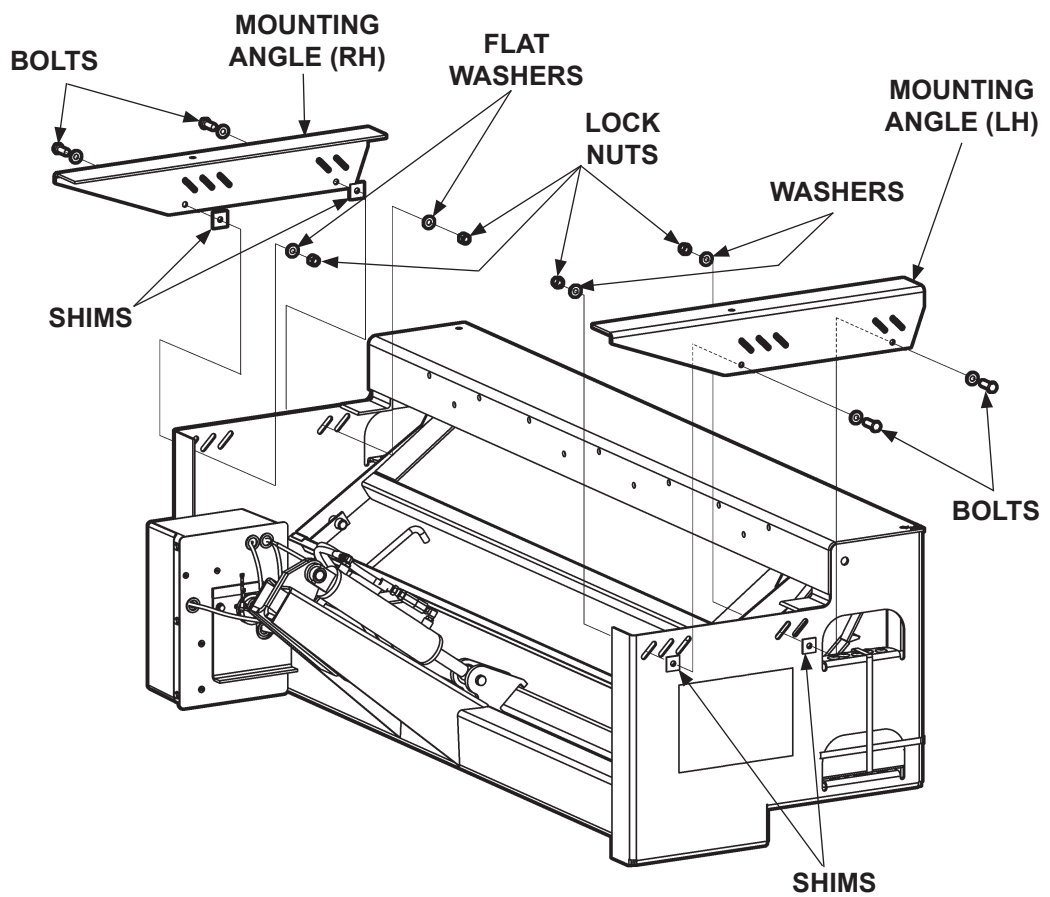

FIG. 22-1

STEP 2 - MOUNT LIFTGATE ON VEHICLE BODY - Continued OPTION 2

NOTE: Save the 4 bolts, flat washers, and lock nuts removed from mounting angles. Reuse to secure Liftgate to mounting angles near the end of this **OPTION 2** procedure.

2. Unbolt the mounting angles and shims from Liftgate (**FIG. 23-1**).



UNBOLTING MOUNTING ANGLES
FIG. 23-1

STEP 2 - MOUNT LIFTGATE ON VEHICLE BODY - Continued OPTION 2

3. Bolt a mounting angle to LH side plate (FIG.24-1) with 5 bolts and 5 flange lock nuts from parts box. Do not tighten flange lock nuts.

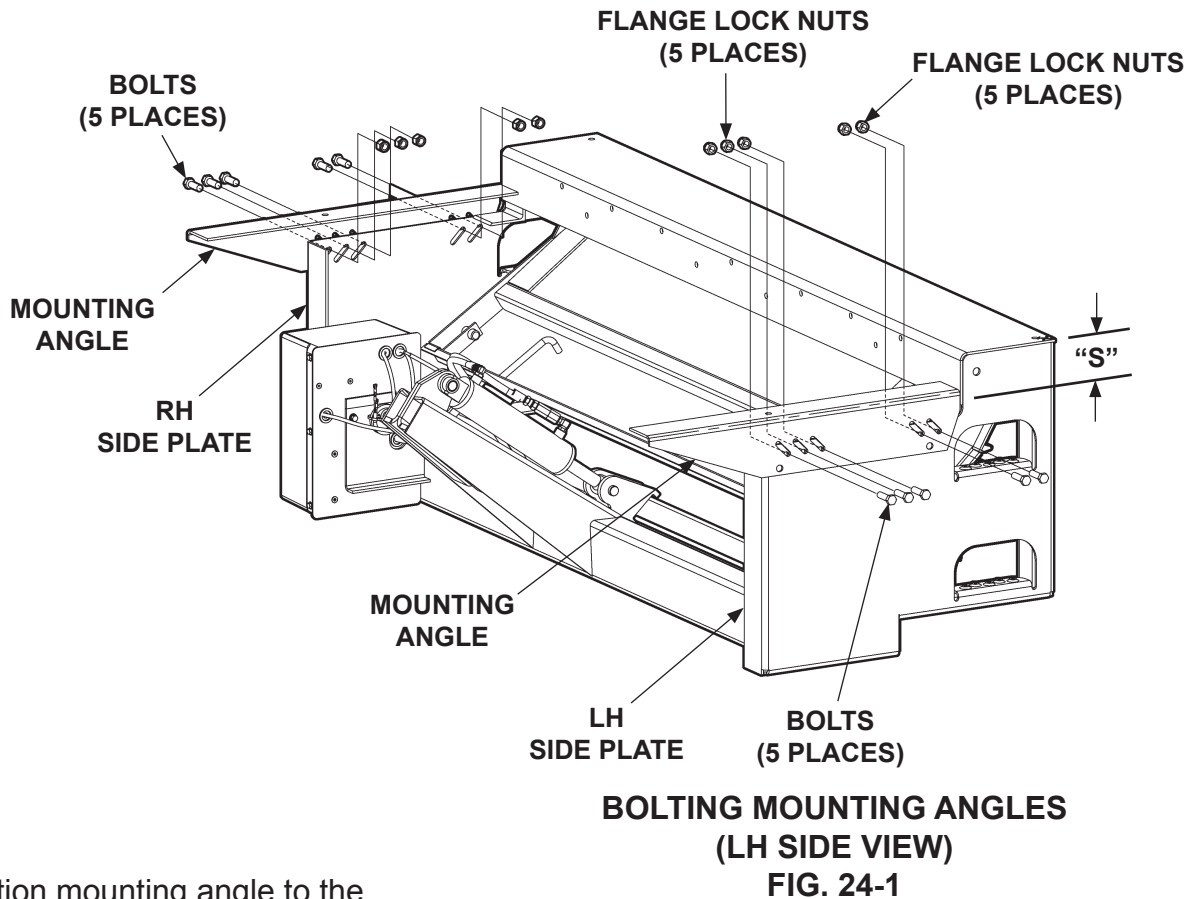

4. Position mounting angle to the distance "S" recorded in the first instruction (see FIG. 24-1).
5. Tighten the 5 flange lock nuts. Torque each of the flange lock nuts (FIG. 24-1) to **105 lbs-ft.**
6. Repeat instructions 3 - 5 for the RH side plate.

STEP 2 - MOUNT LIFTGATE ON VEHICLE BODY - Continued OPTION 2

⚠ WARNING

Keep Liftgate clamped to forklift until Liftgate is welded (or bolted if required) to vehicle body. Liftgate may be damaged and create a hazard for the installer if it falls off the forklift.

NOTE: Rest the Liftgate extension plate against the forklift mast.

7. Secure Liftgate to forklift with “C”-clamps as shown in **FIGS. 25-1A, 25-1B and 25-1C**. Use an 8' length of 4" x 4" steel tubing to help support the Liftgate with forklift (**FIGS. 25-1A and 25-1C**).

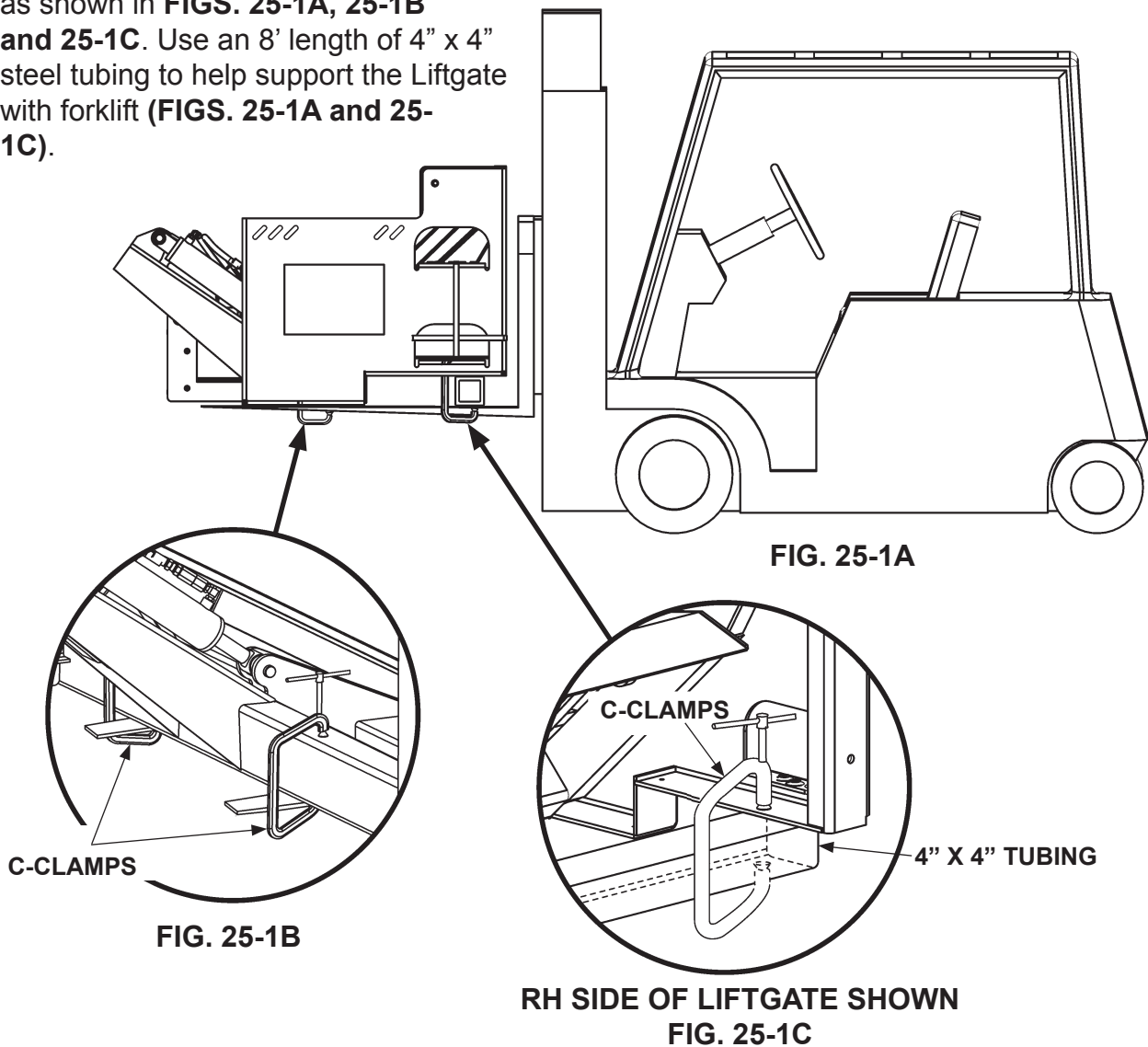

8. Use forklift to center the Liftgate in position on the back of the truck body (**FIG. 25-1A**). If necessary, have 1 person operate the forklift and another person check alignment of Liftgate and truck body.

STEP 2 - MOUNT LIFTGATE ON VEHICLE BODY - Continued

OPTION 2

9. Position the Liftgate against the truck body (**FIG. 26-1**). Make sure extension plate fits tight against body sill (**FIG. 26-1**).

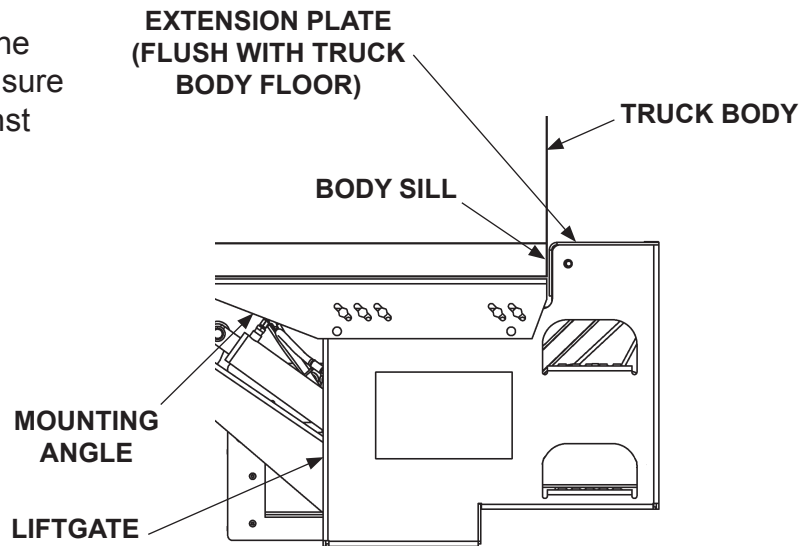
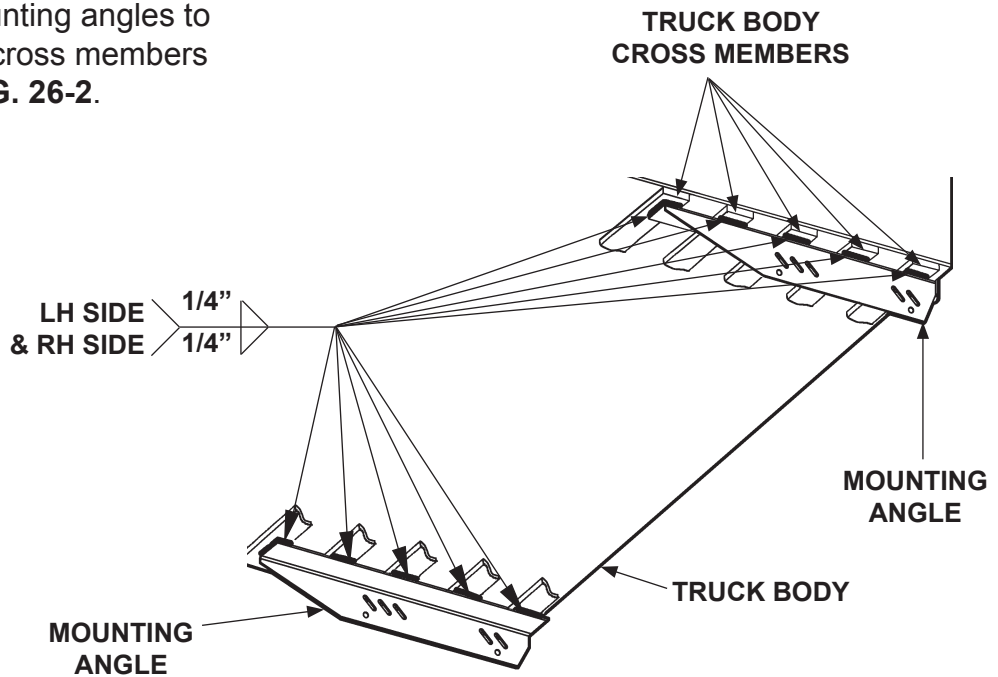

FIG. 26-1

10. Weld the 2 mounting angles to the truck body cross members as shown in **FIG. 26-2**.



**WELDING MOUNTING PLATES
(VIEW UNDER TRUCK BODY -
LIFTGATE NOT SHOWN)**

FIG. 26-2

STEP 2 - MOUNT LIFTGATE ON VEHICLE BODY - Continued OPTION 2

NOTE: To bolt the 2 mounting angles to the Liftgate, use the 4 bolts, flat washers, and lock nuts saved at start of this **OPTION 2** procedure.

11. Using mounting angle as a template, drill 2 matching holes in the LH side plate (**FIG. 27-1**). Repeat for RH side plate.

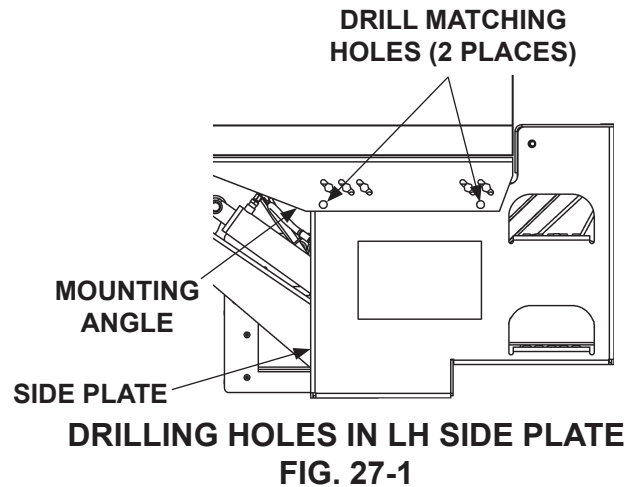

12. Bolt mounting angle to LH side plate (**FIG. 27-2**). Torque each of the lock nuts to **105 lbs-ft**. Repeat for RH side plate.

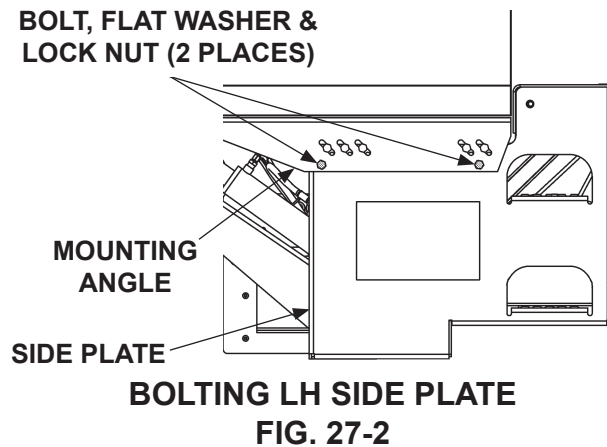

13. Remove "C"-clamps from Liftgate (**FIG. 27-3**). Back out forklift.

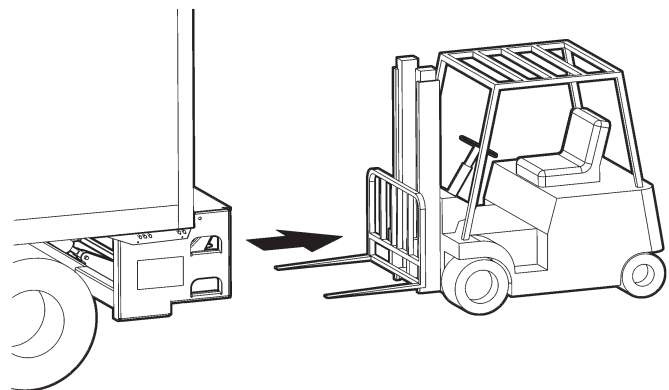

STEP 3 - ATTACH OPTIONAL BATTERY BOX & FRAME TO VEHICLE (IF EQUIPPED)

RECOMMENDED CONFIGURATION

NOTE: Make sure the Liftgate power unit, and all batteries on the vehicle for the power unit, are connected correctly to a common chassis ground.

1. Liftgate and optional battery box are typically installed on trailers as shown in **FIG. 28-1** and on trucks as shown in **FIG. 28-2**. See the following page for battery and cable connections.

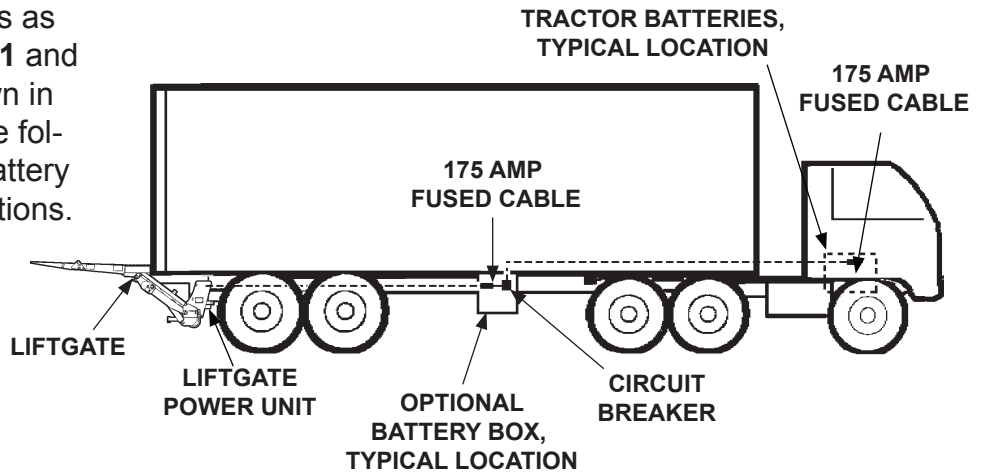

RECOMMENDED LIFTGATE & OPTIONAL BATTERY BOX INSTALLATION ON TRAILER
FIG. 28-1

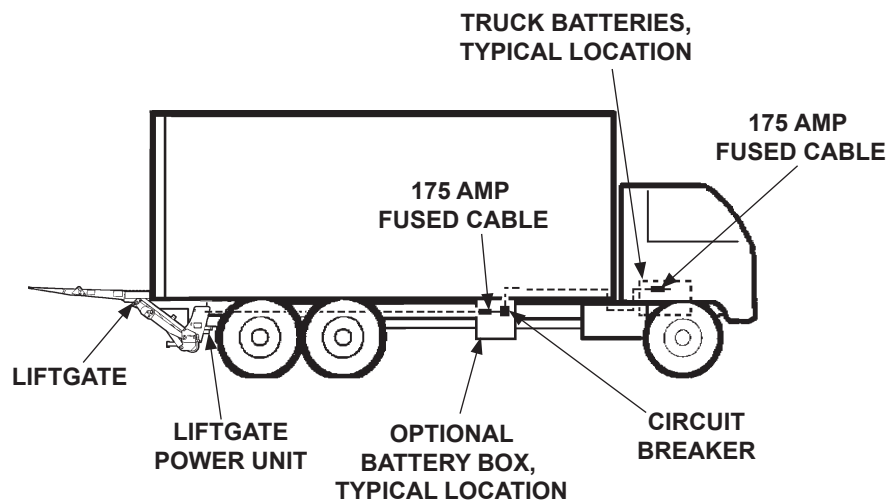

RECOMMENDED LIFTGATE & BATTERY BOX INSTALLATION ON TRUCK
FIG. 28-2

STEP 3 - ATTACH OPTIONAL BATTERY BOX & FRAME TO VEHICLE (IF EQUIPPED) - Continued

2. Select holes on top of battery box frame to align mounting brackets flush to cross members. Refer to **FIGS. 29-1A & 29-1B** for trailers and **FIG. 29-2** for trucks. Bolt mounting brackets to battery box frame as shown in **FIG. 29-1C**. Torque each bolt and lock nut to **85-128 lb-ft.**

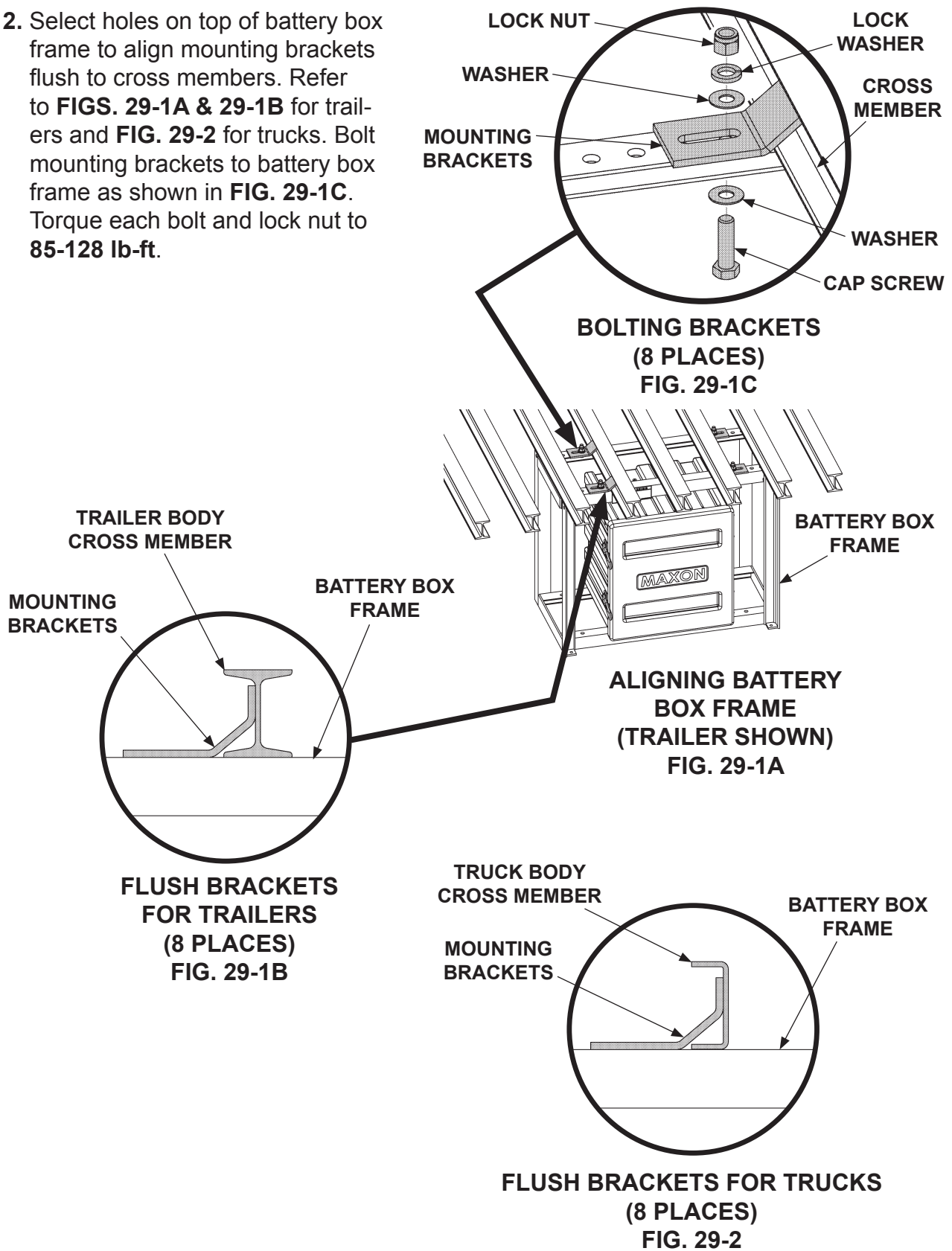

STEP 3 - ATTACH OPTIONAL BATTERY BOX & FRAME TO VEHICLE (IF EQUIPPED) - Continued

NOTE: If welding mounting brackets to cross members, skip instruction 3.

- Using mounting brackets as a template mark and drill holes through cross members (FIG. 30-1). Bolt mounting brackets to cross members as shown in FIGS. 30-2A and 30-2B. Torque bolts and lock nuts to 85-128 lb-ft.

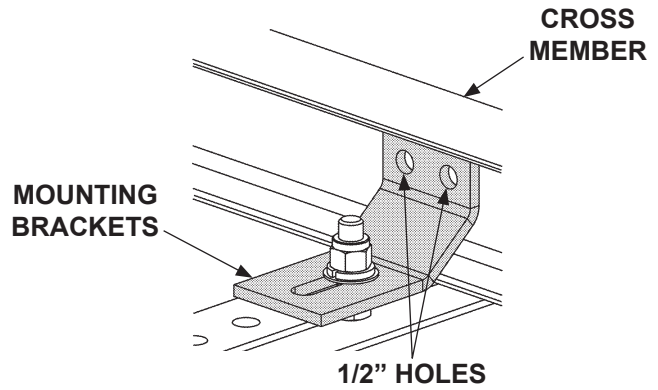

**MARK AND DRILL
FIG. 30-1**

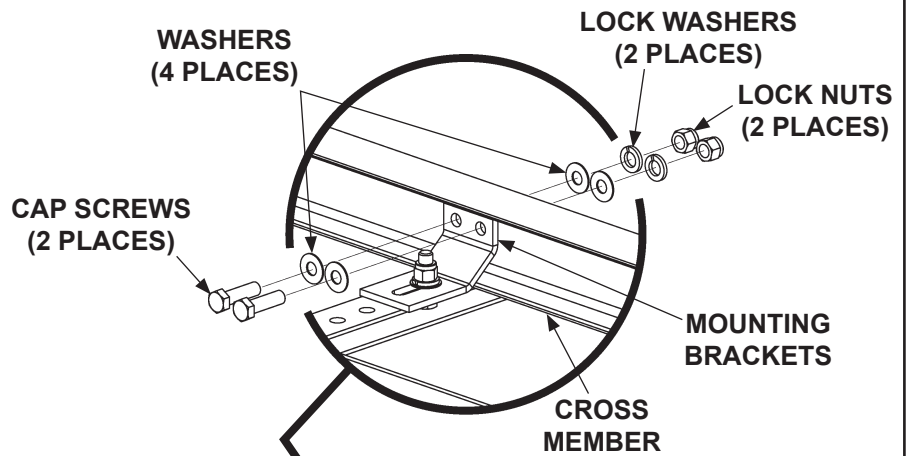

**BOLTING BRACKETS
(8 PLACES)
FIG. 30-2B**

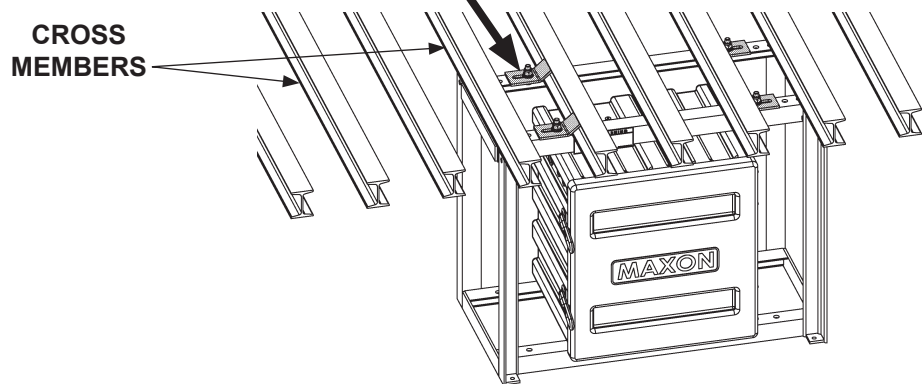

**BOLTING BATTERY BOX FRAME
FIG. 30-2A**

STEP 3 - ATTACH OPTIONAL BATTERY BOX & FRAME TO VEHICLE (IF EQUIPPED) - Continued

⚠ WARNING

Recommended practices for welding on steel parts are contained in the current AWS (American Welding Society) D1.1 Structural Welding Code - Steel. Damage to Liftgate and/or vehicle, and personal injury can result from welds that are done incorrectly.

CAUTION

To prevent pump box components from being damaged by electric current from welding, connect welder grounding cable to the part being welded.

CAUTION

Cover pump box and optional battery box with flame-resistant covering before welding pump box frame to vehicle.

- For galvanized frame, read warning decal shown in FIGS. 31-1A and FIGS. 31-1B before welding. Weld each bracket to cross members as shown in FIGS. 31-1A and 31-1C. Weld top of bracket if accessible.

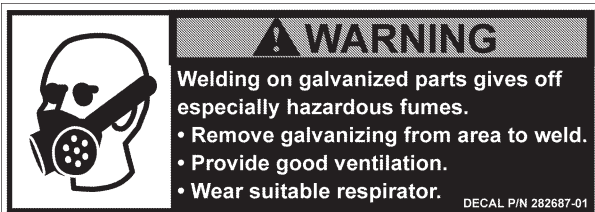
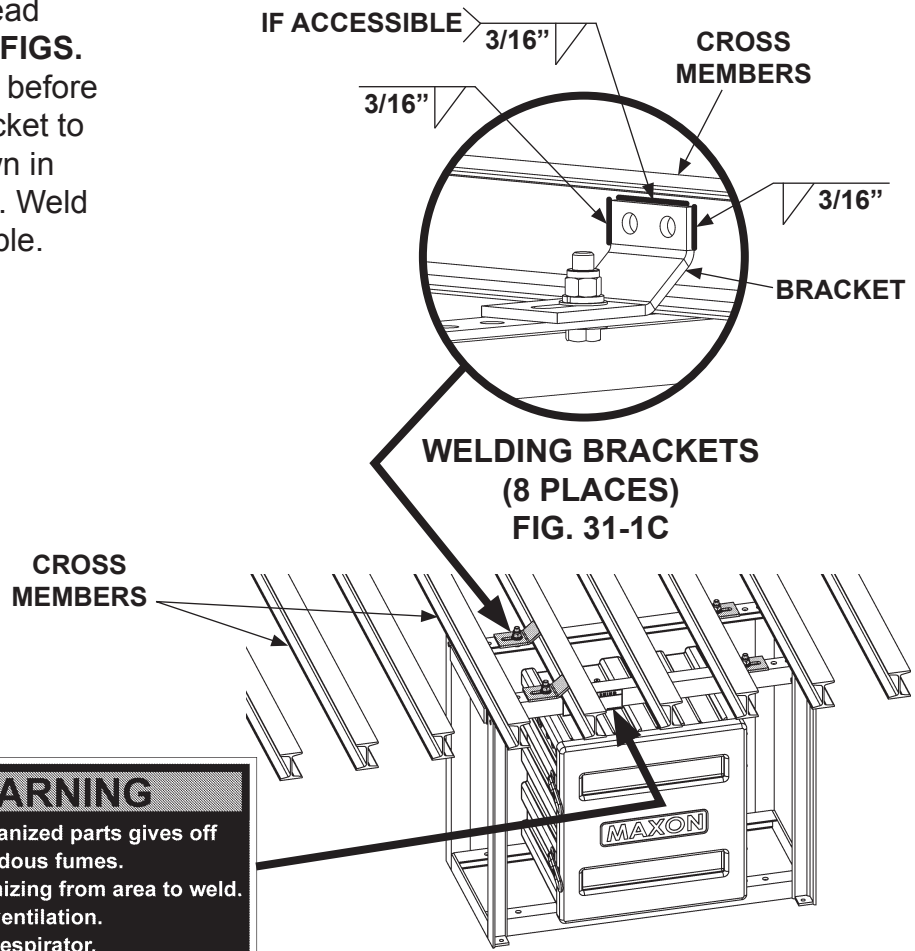

WELDING GALVANIZED, WARNING DECAL
FIG. 31-1B

BOLTING PUMP & BATTERY
BOX FRAME
FIG. 31-1A

STEP 3 - ATTACH OPTIONAL BATTERY BOX & FRAME TO VEHICLE (IF EQUIPPED) - Continued

⚠ WARNING

Remove all rings, watches and jewelry before doing any electrical work.

NOTE: Always connect fused end of power cable to battery positive (+) terminal.

NOTE: To connect charge lines, refer to instructions provided with each charge line kit.

NOTE: MAXON recommends using dielectric grease on all electrical connections.

5. Connect battery cables, fused cables, and ground cables as shown in **FIG. 32-1**.

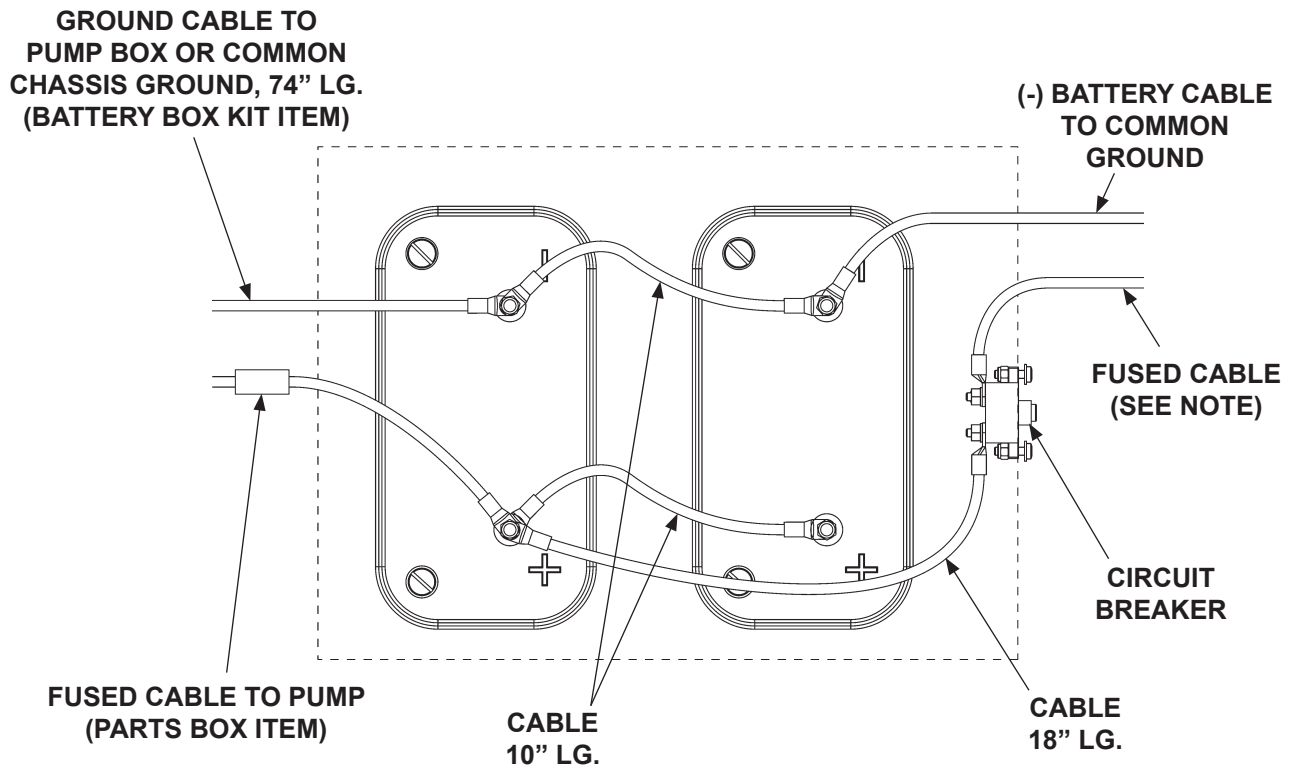
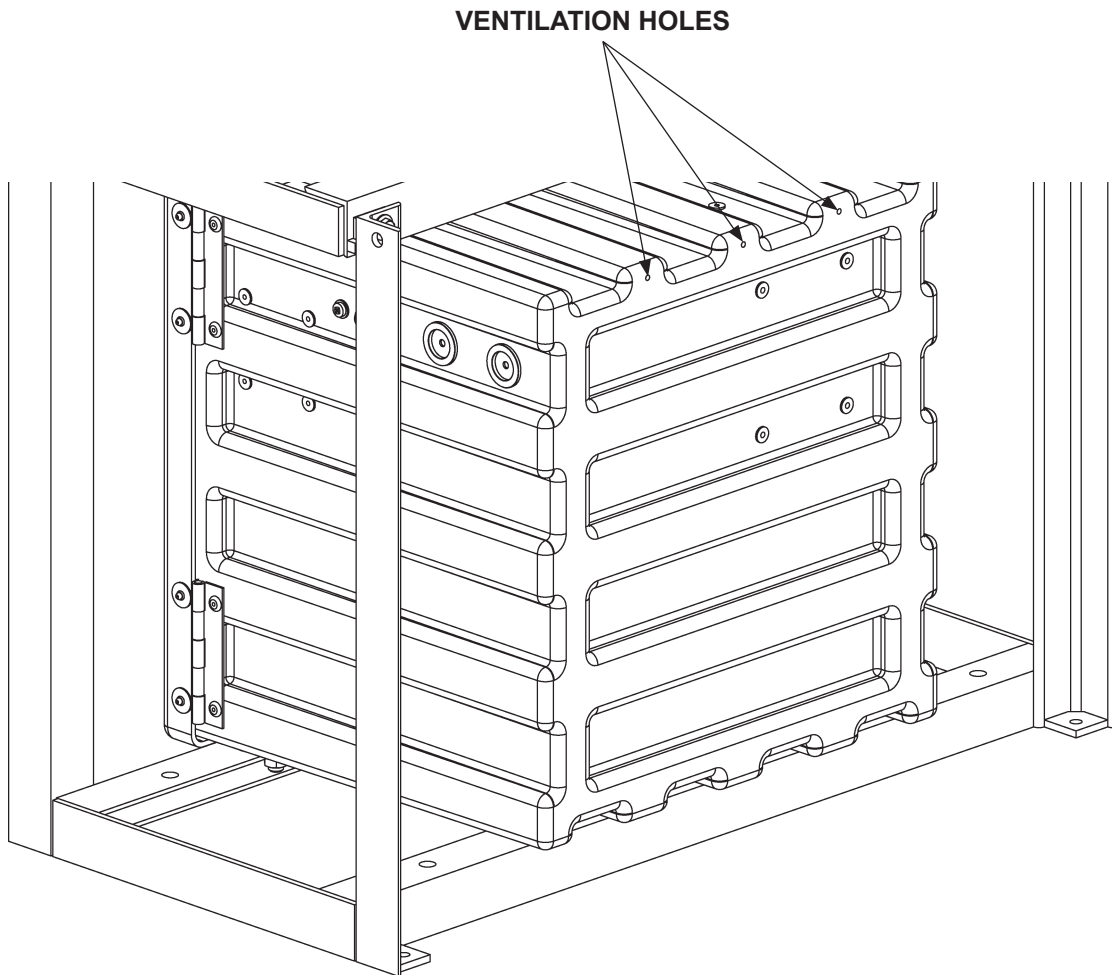

FIG. 32-1

STEP 3 - ATTACH OPTIONAL BATTERY BOX & FRAME TO VEHICLE (IF EQUIPPED) - Continued

⚠ WARNING

Explosive hydrogen gas from charging batteries can accumulate in battery box if not vented from the box. To prevent hydrogen gas from accumulating, ensure the 3 ventilation holes in battery box are not plugged or covered.



BATTERY BOX ASSEMBLY (REAR VIEW SHOWN)
FIG. 33-1

STEP 3 - ATTACH OPTIONAL BATTERY BOX & FRAME TO VEHICLE (IF EQUIPPED) - Continued

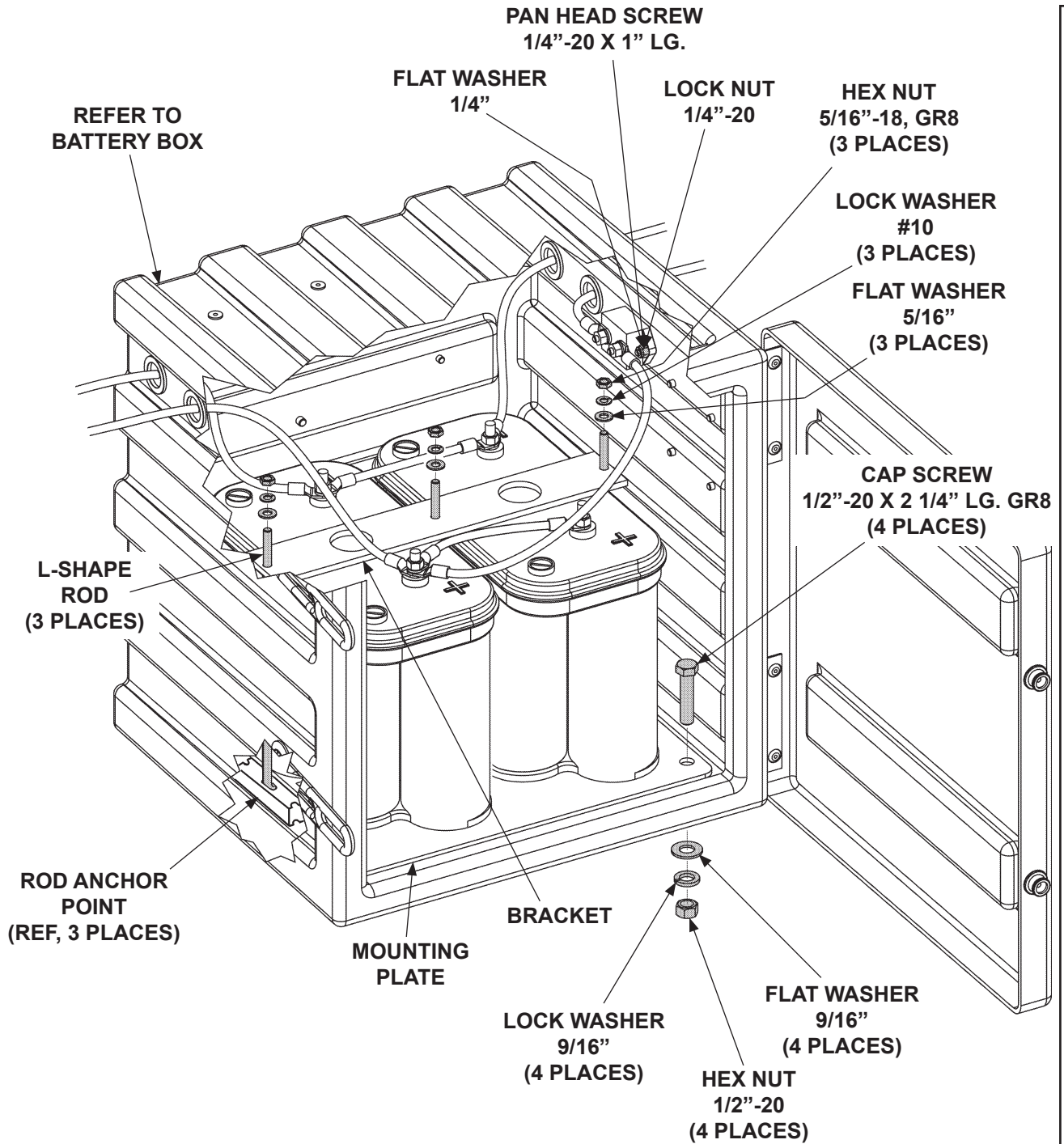

FIG. 34-1

STEP 4 - RUN POWER CABLE

⚠ CAUTION

Never route an energized wire. Make sure the vehicle battery is disconnected. Always route electrical wires clear of moving parts, brake lines, sharp edges and exhaust systems. Avoid making sharp bends in wiring. Attach securely. If drilling is necessary, first check behind the drilling surface so you do not damage any fuel lines, vent lines, brake lines or wires.

Clip fused power cable to vehicle chassis with fuse nearest the vehicle battery, as shown in **FIG. 35-1**. Keep enough cable near the battery to reach the positive terminal without straining cable (after connection). Run cable to power cable tied to the Liftgate main frame.

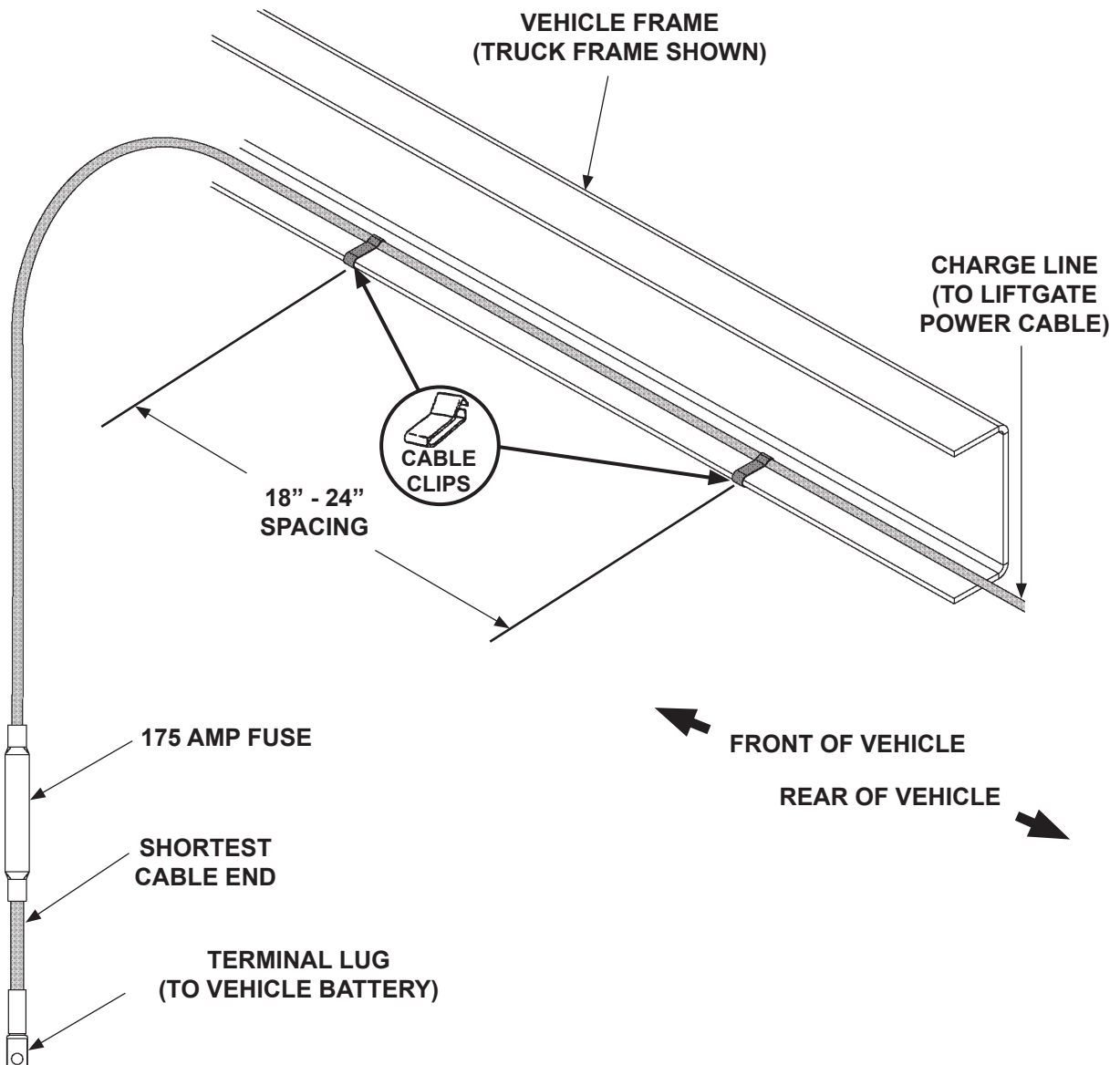

FIG. 35-1

STEP 5 - CONNECT GROUND CABLE

1. Remove cable tie that bundles ground cable and power cable for shipping. Next, remove plastic wrapping from the end of ground cable and power cable (**FIG. 36-1A**).

NOTE: If there is a grounding point on the frame, use it to connect ground cable. Then, skip the step for drilling a hole.

NOTE: Clean the ground cable connection point on the frame down to bare metal.

2. Extend the ground cable to reach vehicle frame (**FIG. 36-2**) without putting tension on cable (after connection). Connect to an existing grounding point if available.
3. If necessary, drill a 11/32" (0.343") hole in vehicle frame for bolting the ground cable terminal lug (**FIG. 36-2**).

NOTE: MAXON recommends using dielectric grease on all electrical connections.

4. Bolt the ground cable terminal lug to vehicle frame as shown in **FIG. 36-2**.

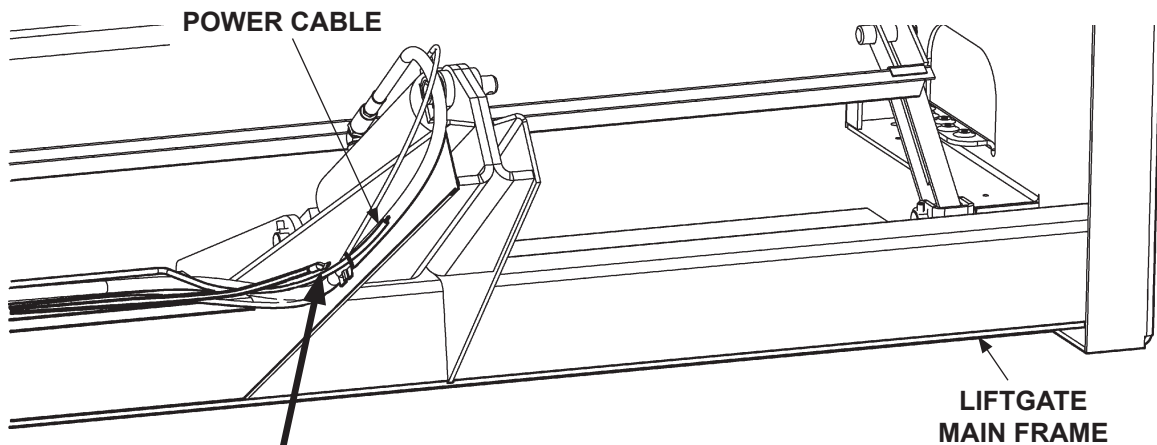

FIG. 36-1A

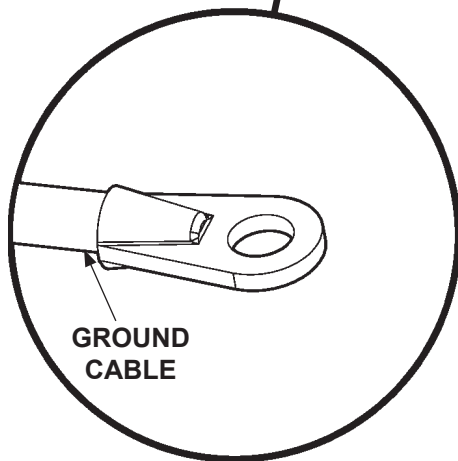

FIG. 36-1B

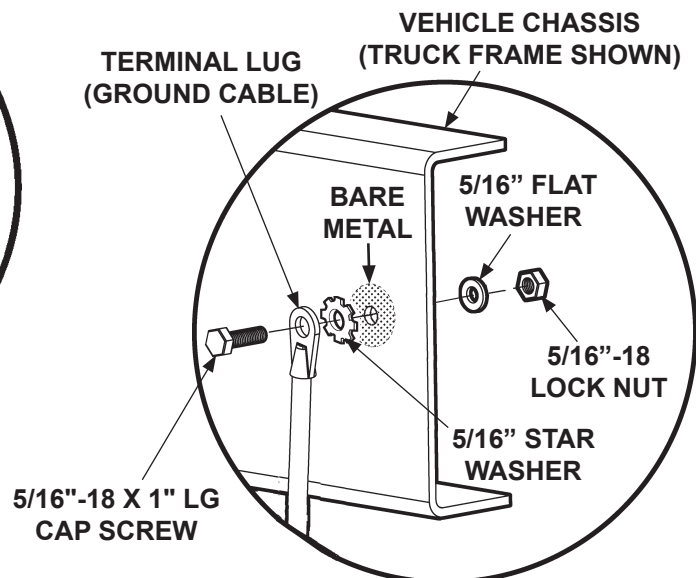

FIG. 36-2

STEP 6 - CONNECT POWER CABLE

NOTE: MAXON recommends using dielectric grease on all electrical connections.

Extend Liftgate power cable (**FIGS. 37-1A & 37-1B**) to reach bare wire end of fused power cable (installed on vehicle chassis in a previous step). Make sure there is enough cable to reach the Liftgate power cable without putting tension on the cables (after connection). Measure if necessary. Cut excess cable from end of fused power cable closest to Liftgate. Slide shrink tubing (**FIG. 37-1B**) over power cable. Splice the fused power cable and Liftgate power cable together as shown in **FIG. 37-1B**. Slide shrink tubing over splice and shrink in place with heatgun (**FIG. 37-2**).

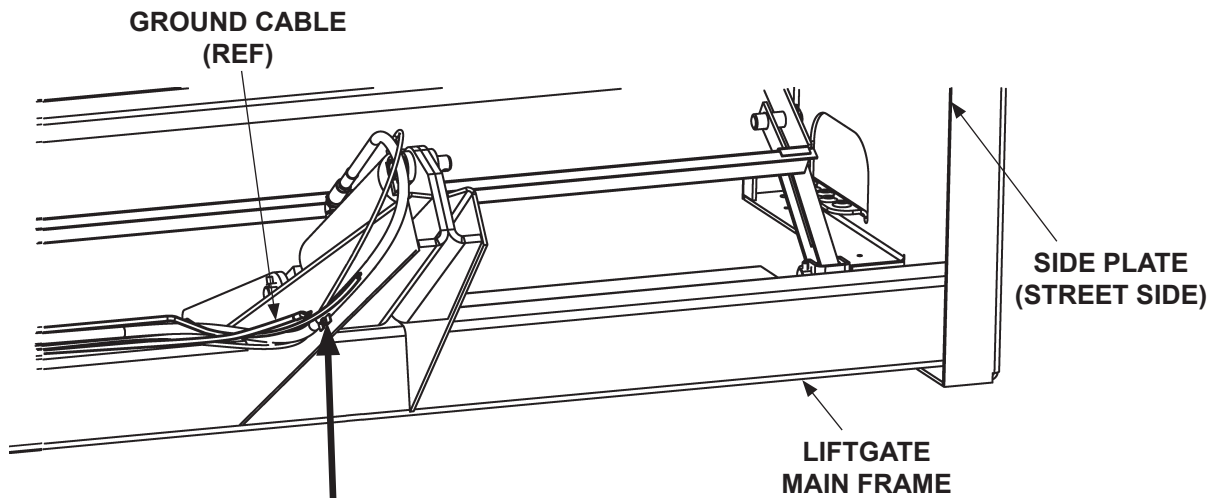

FIG. 37-1A

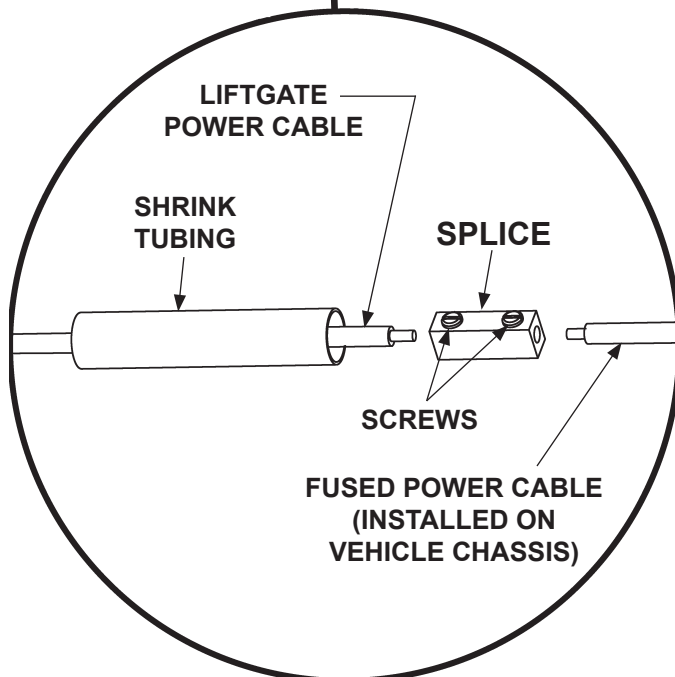

FIG. 37-1B

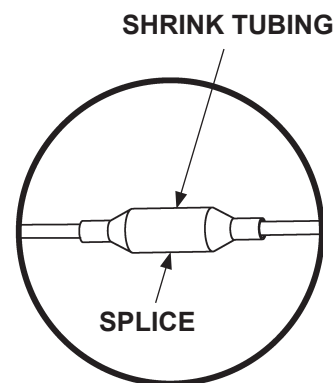
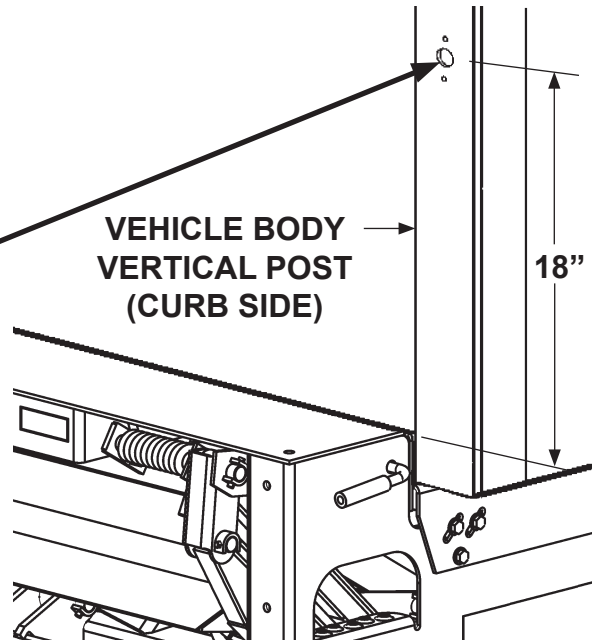
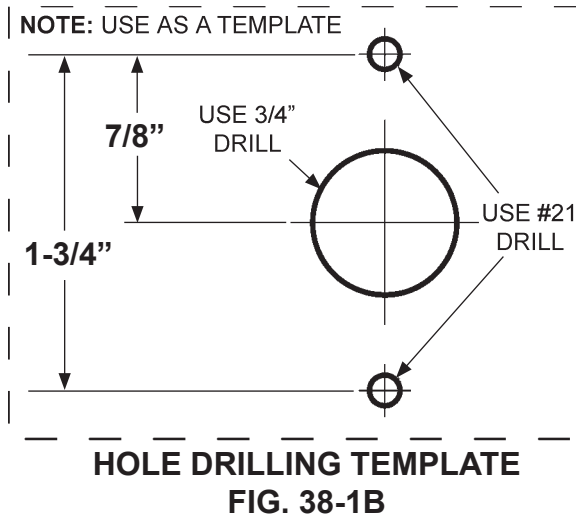

FIG. 37-2

STEP 7 - INSTALL CONTROL SWITCH

1. Drill one 3/4" hole and two #21-size holes in the vertical post on curb side of vehicle body as shown in FIG. 38-1A. Use template shown in FIG. 38-1B.



2. Locate wiring harness behind the pump mounting plate (FIG. 38-2). Remove plastic wrapping from the end of the wiring harness.

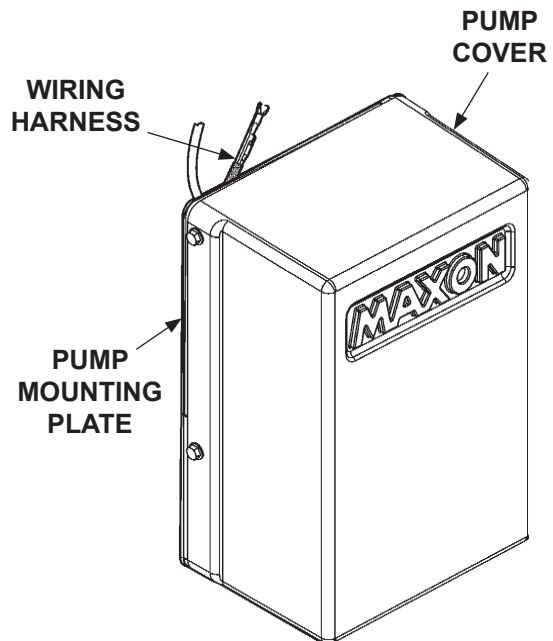

STEP 7 - INSTALL CONTROL SWITCH - Continued

NOTE: MAXON recommends using dielectric grease on all electrical connections.

3. Run wiring harness under vehicle body (see dashed line in FIG. 39-1) and up through inside vertical post. Pull control switch wiring harness out the 3/4" hole drilled in vertical post (FIG. 39-1). Connect the control switch wiring to the wiring harness as shown in FIG. 39-2. Push extended wiring back into the 3/4" hole in the vertical post until control switch touches the post. Attach control switch to vertical post with 2 self-tapping screws (FIG. 39-2).

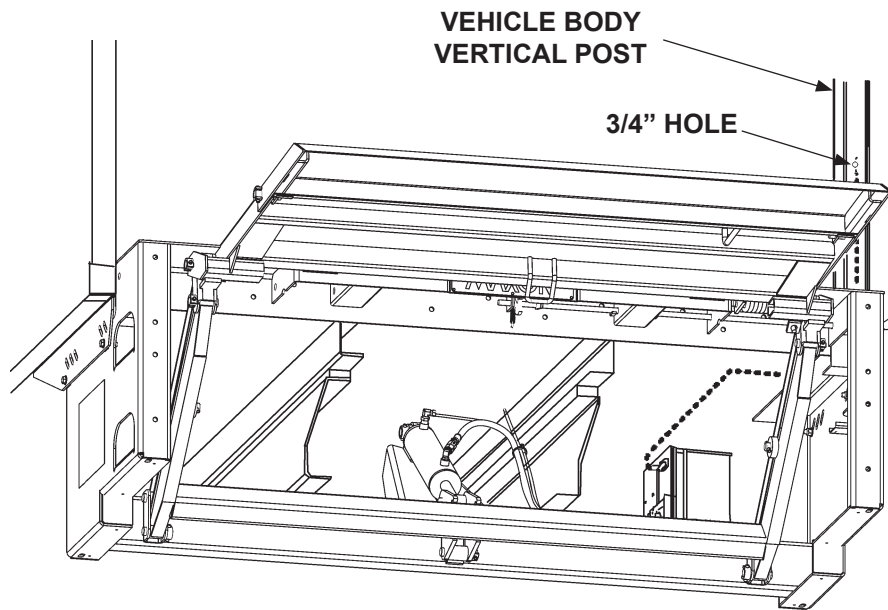

ROUTING CONTROL SWITCH WIRING
FIG. 39-1

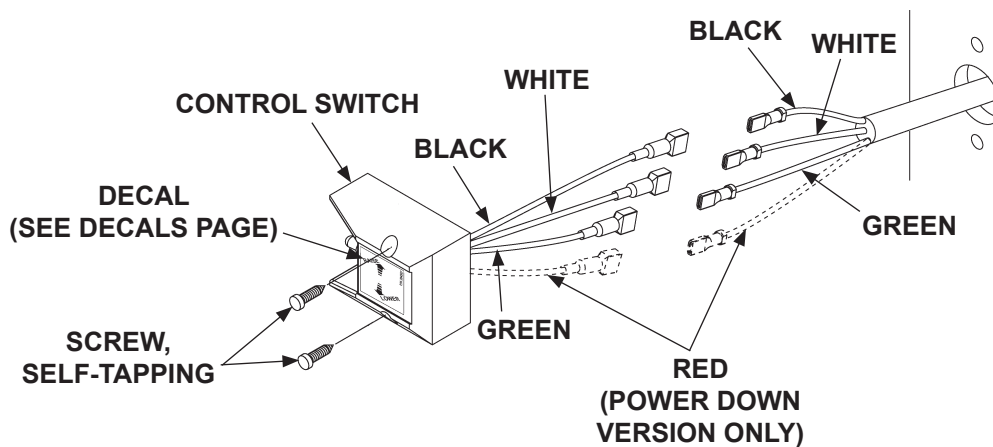

CONTROL SWITCH WIRING CONNECTIONS
FIG. 39-2

STEP 8 - CONNECT POWER CABLE TO BATTERY

NOTE: MAXON recommends using dielectric grease on all electrical connections.

1. Remove nut from negative (-) battery terminal. Disconnect negative (-) battery cable (**FIG. 40-1**).

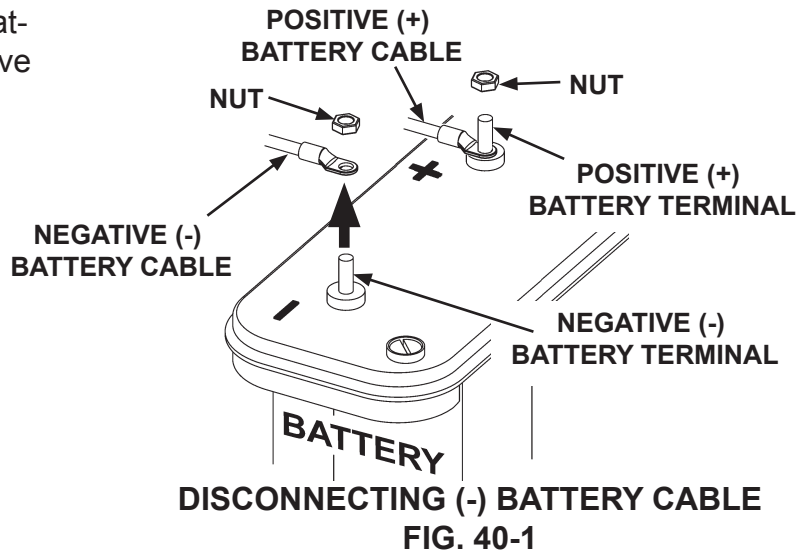

2. Remove nut from positive (+) battery terminal (**FIG. 40-2**).

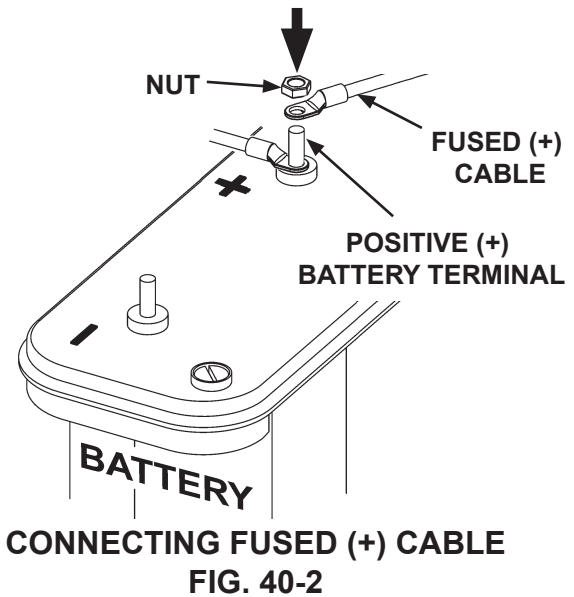

3. Connect fused positive (+) cable to positive (+) battery terminal (**FIG. 40-2**). Then, reinstall nut on positive (+) battery terminal (**FIG. 40-2**).

4. Reconnect negative (-) battery cable to negative (-) battery terminal (**FIG. 40-3**). Then, reinstall nut on negative (-) battery terminal (**FIG. 40-3**).

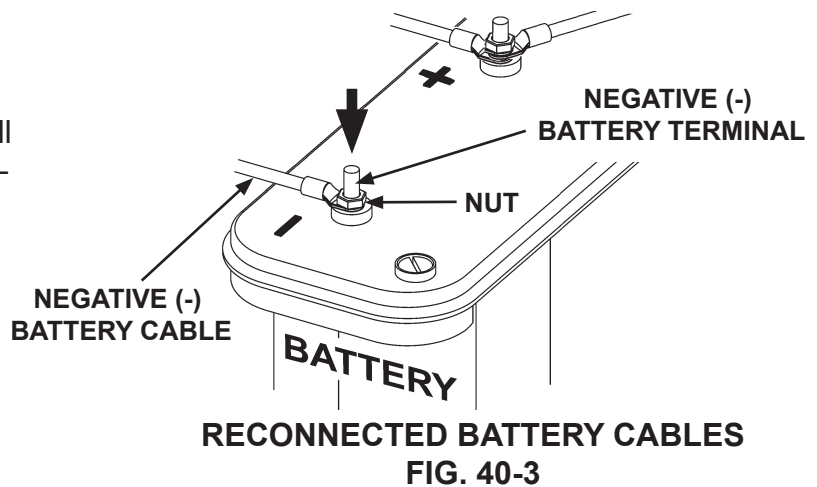

STEP 9 - LOWER THE PLATFORM FOR ACCESS

1. Depress handle (FIG. 41-1A) and push control switch (FIG. 41-1B) to lower Liftgate to the ground (FIG. 41-1C).

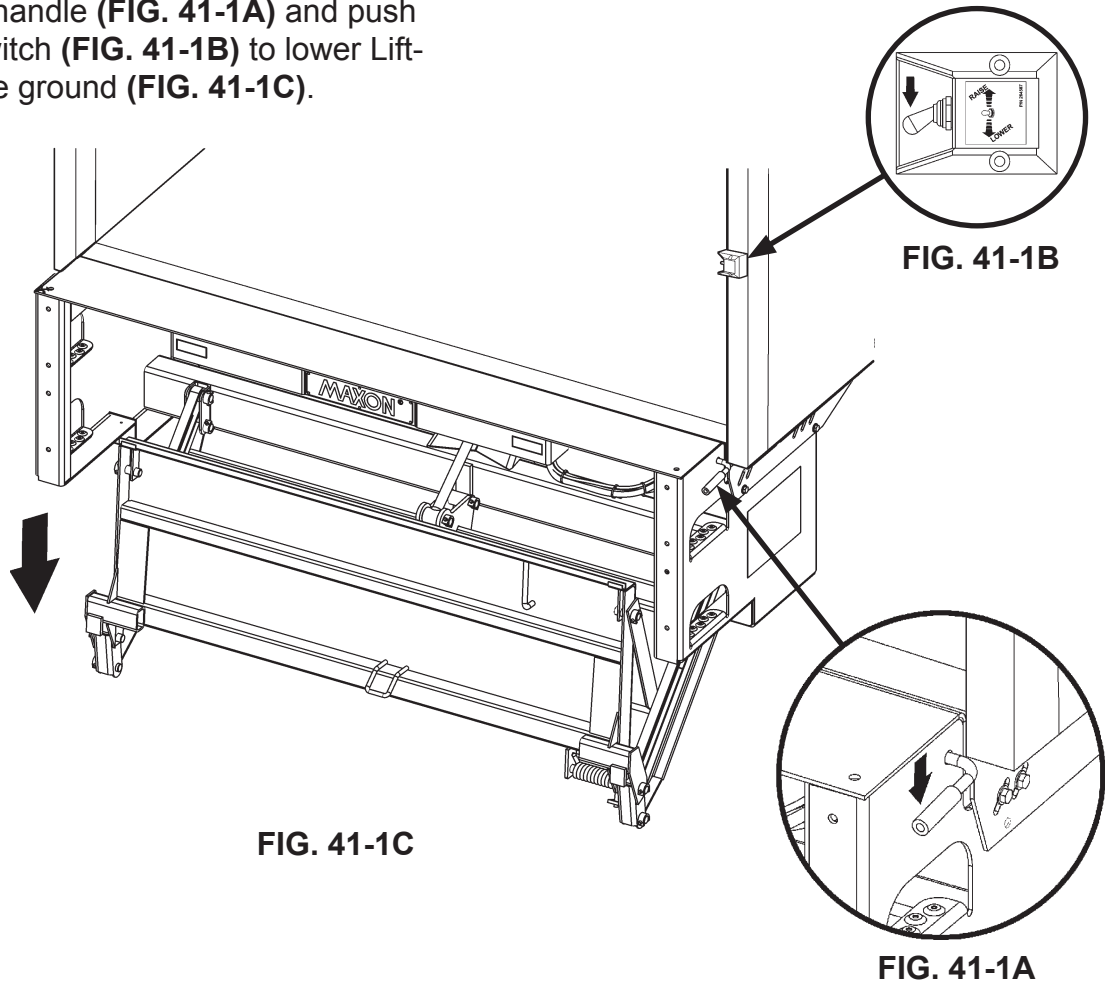

⚠ WARNING
To prevent accidental personal injury and equipment damage, make sure power is disconnected from Liftgate while installing parts.

2. Disconnect power. Remove nut from positive (+) battery terminal connector to disconnect power cable (FIG. 41-2). Reinstall nut.

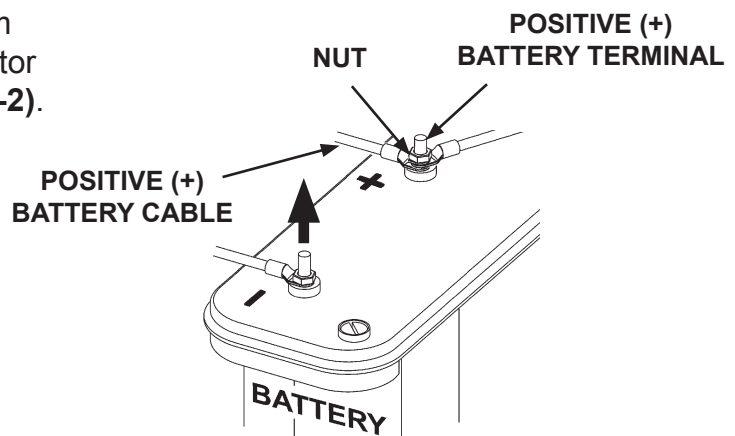

DISCONNECTING (+) BATTERY CABLE
FIG. 41-2

STEP 10, PART A - WELDING METHOD FOR EXTENSION PLATE

NOTE: If using **BOLTING METHOD** to install Liftgate, skip **PART A** and go to **PART B**.

Make sure extension plate fits tight against truck body sill. Weld flush between top of extension plate and floor of truck body as shown in **FIG. 42-1**.

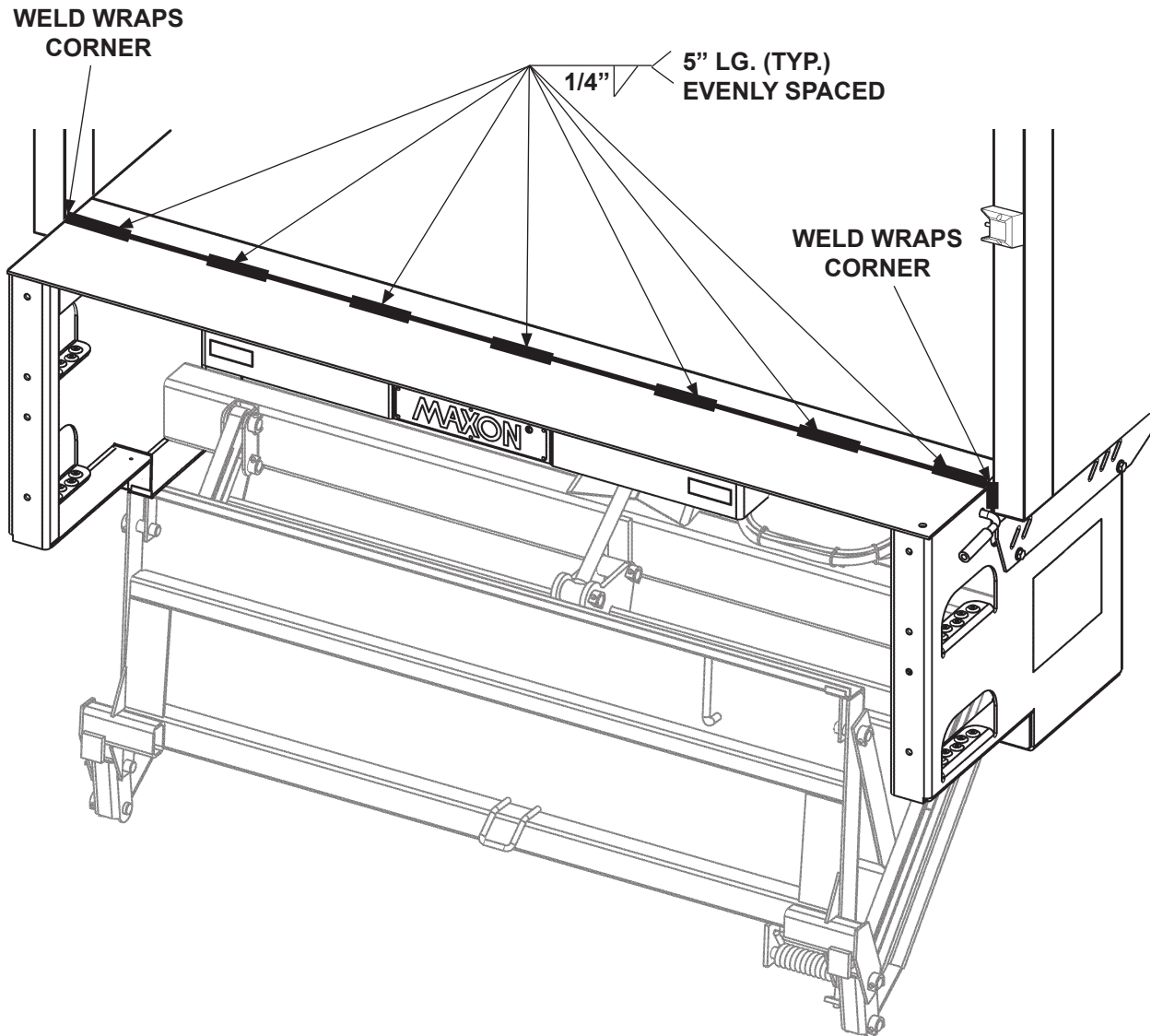
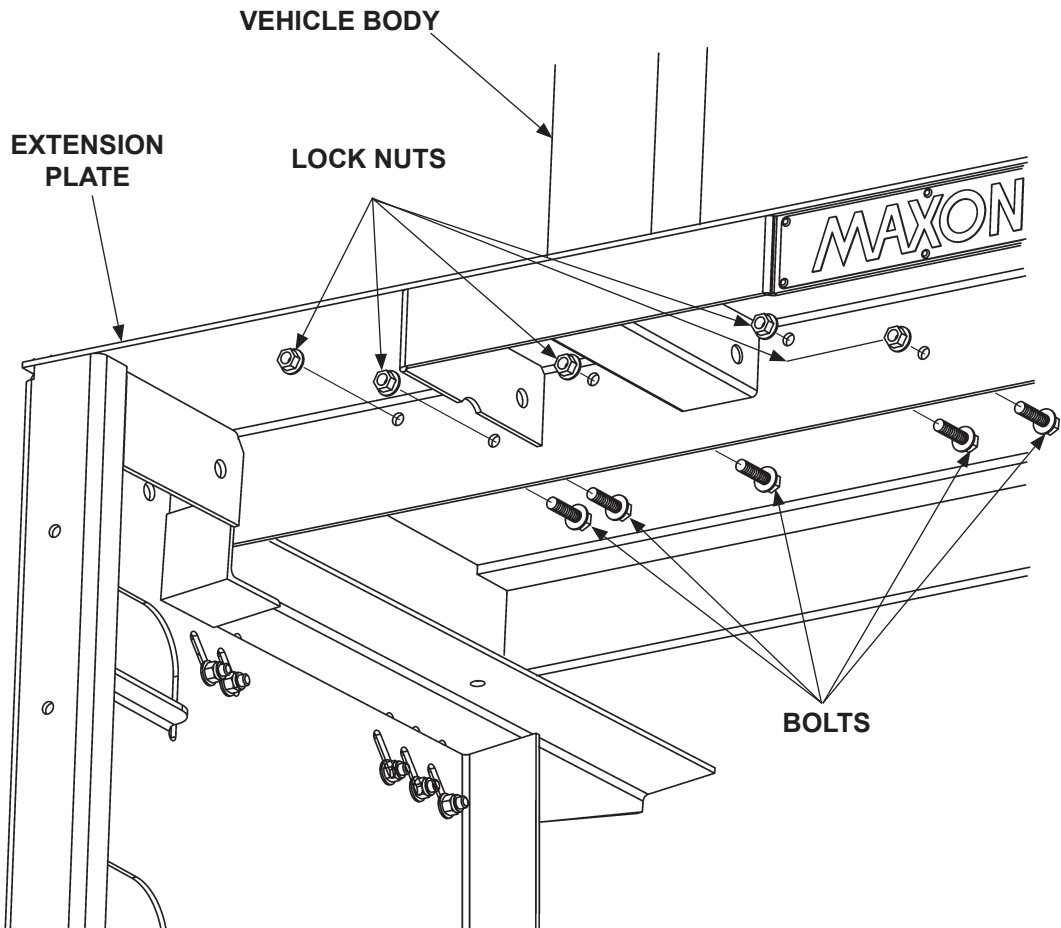

FIG. 42-1

STEP 10, PART B - BOLTING METHOD FOR EXTENSION PLATE

NOTE: The extension plate has bolt holes so it can be bolted to vehicle body. **Grade 8 bolts** are required. **MAXON** recommends getting the optional extension plate hardware kit listed in **OPTIONS** section. Vehicle body must be drilled according to instructions. If necessary, extension plate may also be welded to vehicle body. Do the following bolting or welding instructions.

Unfold platform to gain access to bottom side of extension plate. Bolt the Liftgate extension plate to vehicle body with the eleven frame bolts and flange lock nuts from the optional extension plate hardware kit (**FIG. 43-1**). **Torque the 11 bolts to 105 lbs-ft each.** Reconnect power cable to battery (**FIG. 40-3**).



**EXTENSION PLATE BOLT PATTERN
(VIEW FROM UNDER EXTENSION PLATE)
FIG. 43-1**

STEP 11 - PLATFORM ADJUSTMENT (IF REQUIRED)

NOTE: Before doing the following procedure, make sure vehicle is parked on level ground.

1. Make sure platform is at ground level. Unfold the platform and flipover. As the platform first touches the ground, shackles and tip of flipover must touch the ground at the same time (**FIG. 44-1**). If the shackles and the tip of flipover touch the ground at the same time, raise platform to bed height (**FIG. 44-2**). Outboard edge on top of flipover should be above bed level (**FIG. 44-2**). If indications are correct in both cases (**FIGS. 44-1 & 44-2**), Liftgate is installed correctly and no adjustment is needed. If indications are incorrect, continue with instruction 2.

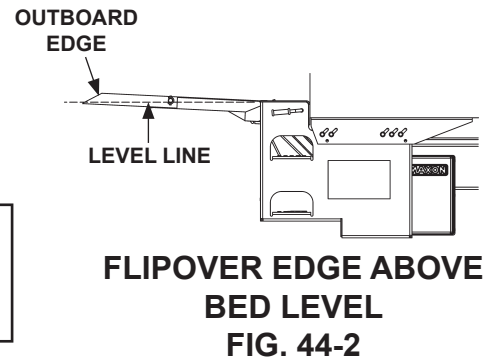
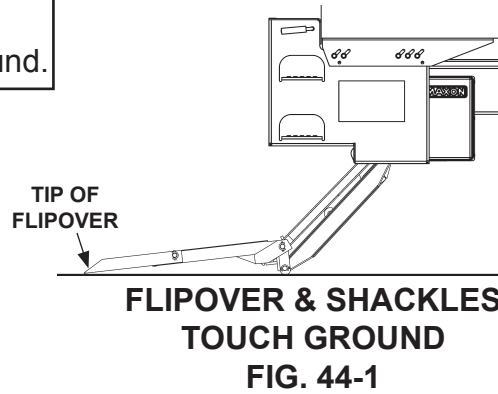

NOTE: If tip of flipover touches first (**FIG. 44-3**), do instruction 2. If the shackle touches first (**FIG. 44-1**), skip instruction 2 and do 3.

2. Make sure platform is still at ground level. If the shackle is not touching the ground, measure and compare distance "A" (**FIG. 44-3**) with **TABLE 44-1** to determine the correct shim. Make shims as needed (**FIG. 44-5**). Weld shim as shown in **FIG. 44-4**.

| RAISE TIP OF FLIPOVER THIS DISTANCE "A" | REQUIRED SHIM THICKNESS | WELD SIZE "W" |
|---|-------------------------|---------------|
| 7/8" | 1/16" | 1/16" |
| 1-3/4" | 1/8" | 1/8" |
| 2-5/8" | 3/16" | 3/16" |
| 3-1/2" | 1/4" | 1/4" |

TABLE 44-1

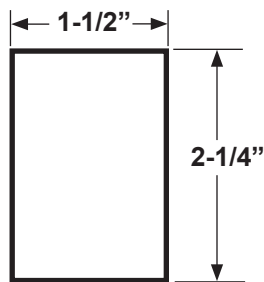

SHIM (1/16", 1/8", 3/16", or 1/4") MADE FROM STEEL FLAT FIG. 44-5

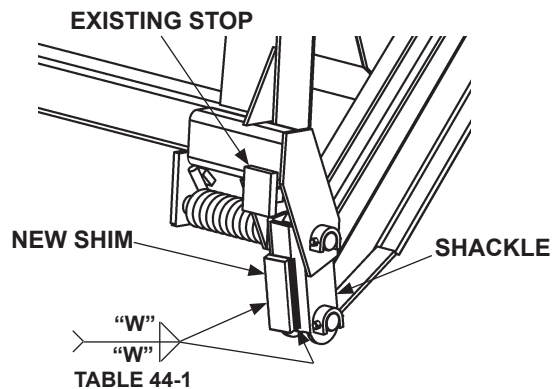
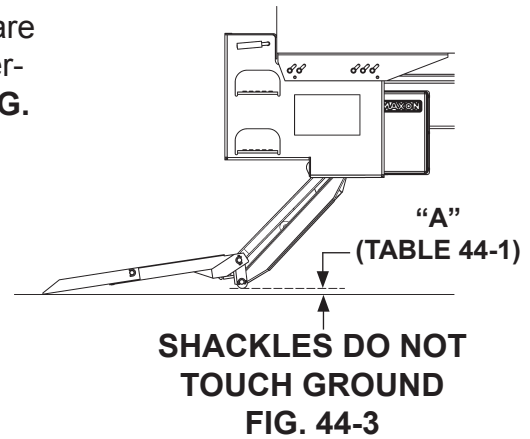

WELDING SHIMS (CURBSIDE SHOWN) FIG. 44-4

STEP 11 - PLATFORM ADJUSTMENT (IF REQUIRED)

- Continued

3. Make sure platform is still at ground level. If the tip of flipover is not touching the ground, measure and compare distance "B" (FIG. 45-1) with TABLE 45-1 to determine how much to grind from the platform stops (FIG. 45-2). Grind correct amount of metal (TABLE 45-1) from platform stop as shown in FIG. 45-2.

| LOWER TIP OF FLIPOVER THIS DISTANCE "B" | GRIND METAL FROM PLATFORM STOP |
|---|--------------------------------|
| 7/8" | 1/16" |
| 1-3/4" | 1/8" |
| 2-5/8" | 3/16" |
| 3-1/2" | 1/4" |

TABLE 45-1

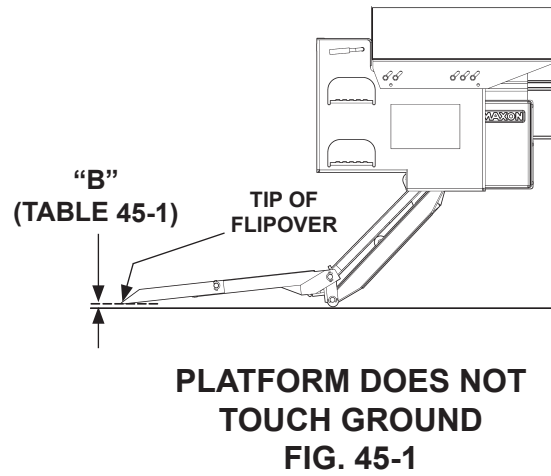

4. Raise the platform, then lower it to the ground. As the platform first touches the ground, the tip of flipover and shackle should touch at the same time as shown in FIG. 44-1.

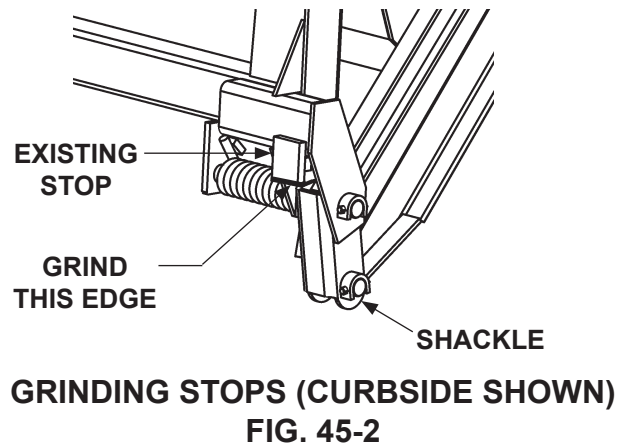

STEP 12 - ADJUST SAFETY HOOK (IF REQUIRED)

CHECK SAFETY HOOK FUNCTION

1. When raising platform to stowed position, listen for sound of **safety hook** engaging **platform loop**.
2. When the Liftgate is stowed, see if **platform loop** is positioned above the **safety hook** as shown in **FIG. 46-1**.

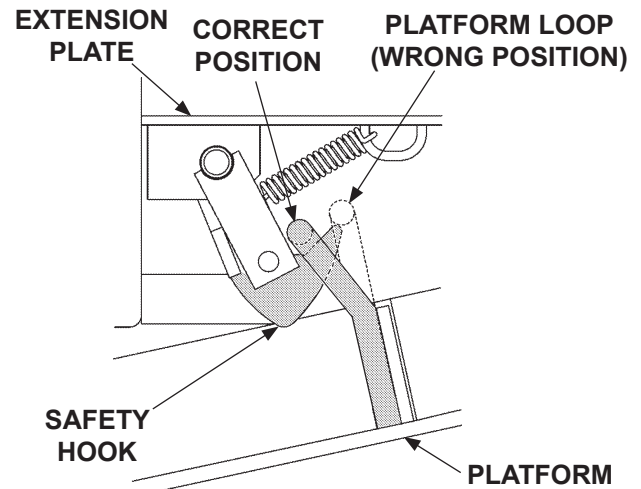

FIG. 46-1

LOOP ADJUSTMENT

1. If the safety hook is not positioned correctly (**FIG. 46-1**), **LOWER** platform to ground level (see **Operation Manual**).
2. Adjust by bending the platform loop as shown in **FIG. 46-2**.
3. Stow the platform and check for correct safety hook position. Repeat adjustment if required.

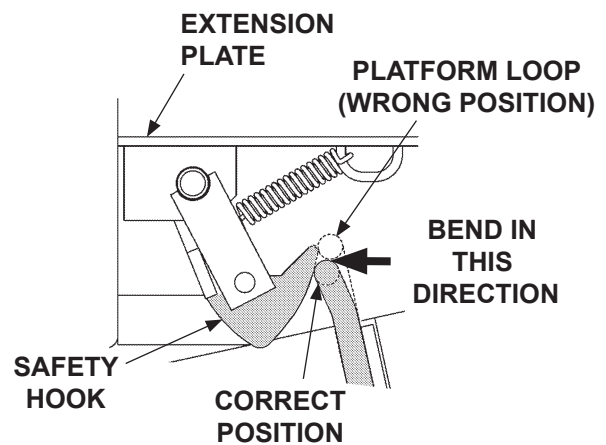

FIG. 46-2

LUBRICATION (IF REQUIRED)

1. Make sure front surface of safety hook (**FIG. 46-3**) is lubricated with automotive grease. Apply grease if required.
2. Make sure control handle rod (**FIG. 46-3**) is lubricated where it has contact with brackets. Apply automotive grease if required.

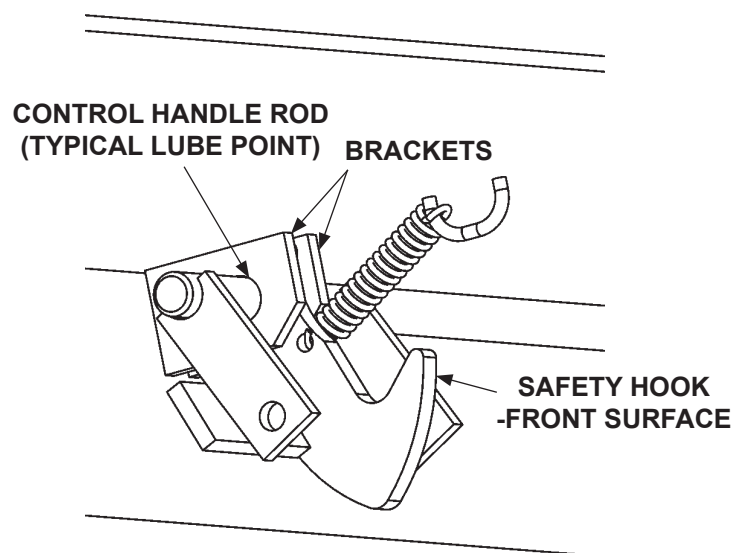
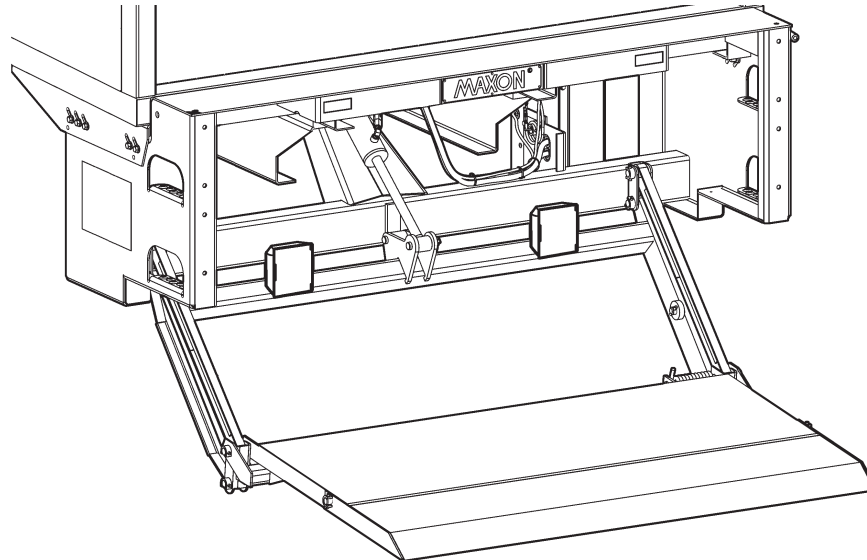

FIG. 46-3

STEP 13 - VEHICLE TAILLIGHT POSITIONING (IF REQUIRED)

NOTE: Positions are based on using taillights of 6-3/4" height by 5-3/4" width for Liftgates with ramp flipover and retention ramp flipover. Larger taillights may interfere with Liftgate. Only standard oval truck lights can be used with wedge flipover. Taillights and attaching hardware are not provided with the Liftgate.

Position taillights as shown (FIGS. 47-1, 47-2 & 47-3).



**VEHICLE TAILLIGHTS INSTALLED ON LIFTGATE
FIG. 47-1**

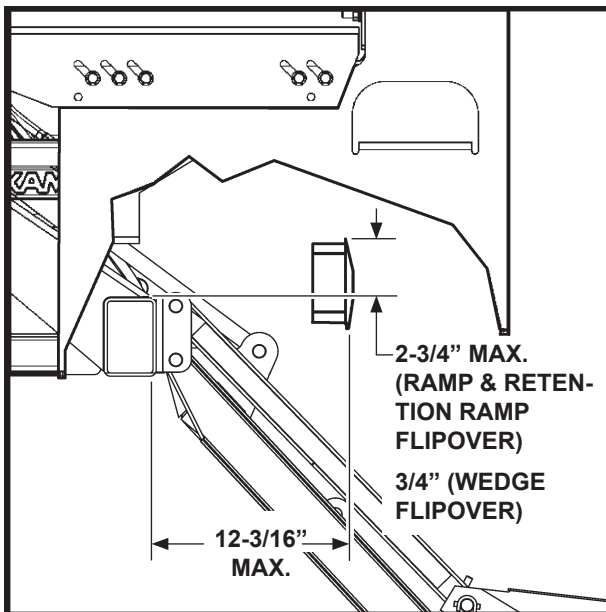

**TAILLIGHT POSITIONS, LEFT HAND
SIDE VIEW
FIG. 47-2**

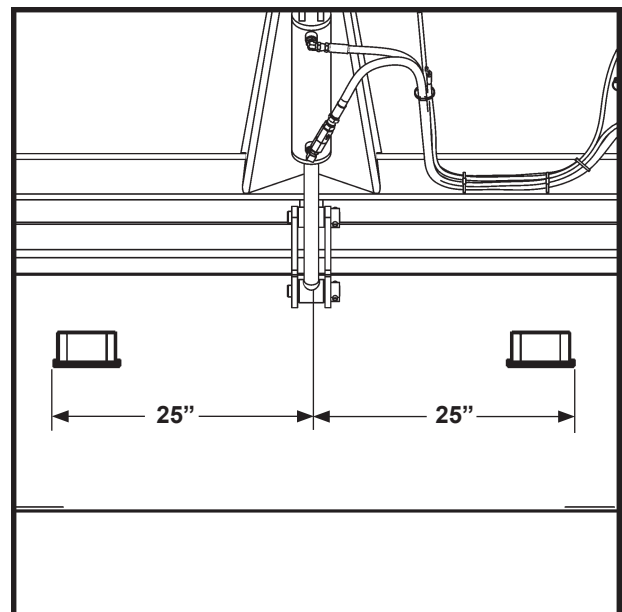

**TAILLIGHT HORIZONTAL SPACING,
TOP VIEW
FIG. 47-3**

ATTACH DECALS

NOTE: Ensure there is no residue, dirt, or corrosion where decals are attached. If necessary, clean surface before attaching decals.

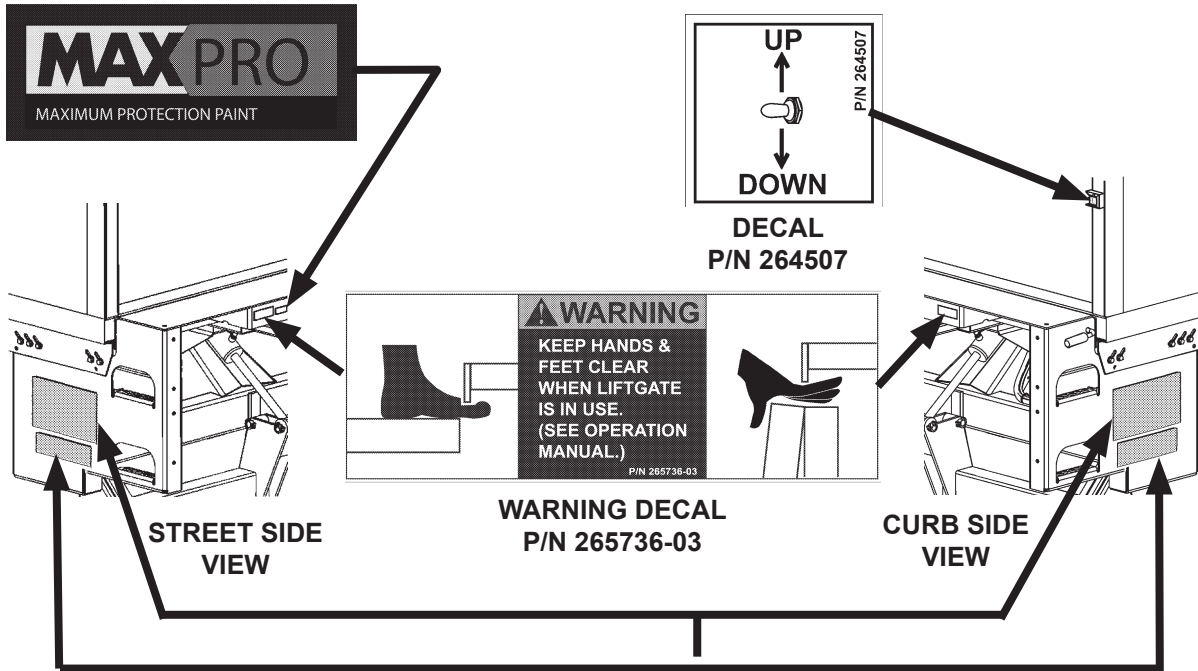

OPERATING INSTRUCTIONS

READ CAREFULLY

Improper operation of this Liftgate can result in serious personal injury. Do not operate unless you have been properly instructed and have read and are familiar with the operating instructions. If you do not have a copy of the instructions, please obtain them from your employer, distributor, or dealer before you attempt to operate the Liftgate.

Be certain that the vehicle is properly and securely braked before using the Liftgate.

Always inspect this Liftgate for maintenance or damage before using it. If there are signs of damage or maintenance, damage to this unit, or damage to Platform surface, do not use the Liftgate until the problem has been corrected.

Do not overload the Liftgate. The load limit is based on evenly distributed cargo over the entire Platform surface. If you are using a pallet, be sure it can be maneuvered safely. Do not operate a forklift on the Platform or board with the platform in an open position at any time.

Load should be placed in a stable position close to the edge of the Platform toward the truck. The heaviest portion of the load should never be placed beyond the center of the Platform away from the truck.

Never allow yourself, a helper, or bystander to stand in a position where a falling load could land on either of you. Also do not allow any part of your helper's body to be placed inside, within, or across any portion of the moving Liftgate, or its mechanism, or in a position that would trap them between the platform and the ground or truck when the Liftgate is operated.

If a helper is riding the Platform with you, make sure you are both doing so safely and that you are not in danger of coming in contact with any moving or potentially moving obstacles. USE GOOD COMMON SENSE. If load appears to be unstable, do not lift or lower it.

For a free copy of manuals that pertain to this model Liftgate, please visit www.maxonlift.com or call Customer Service at (888) 227-4716.

DECAL #16 265438

WARNING
MAXIMUM CAPACITY OF THIS LIFT IS
2500 lbs.
WHEN LOAD IS CENTERED ON
LOAD CARRYING SURFACE OF PLATFORM

MAXON

DECAL (2 PLACES, MTB-25 ONLY)
P/N 265438

OPERATING INSTRUCTIONS

READ CAREFULLY

Improper operation of this Liftgate can result in serious personal injury. Do not operate unless you have been properly instructed and have read and are familiar with the operating instructions. If you do not have a copy of the instructions, please obtain them from your employer, distributor, or dealer before you attempt to operate the Liftgate.

Be certain that the vehicle is properly and securely braked before using the Liftgate.

Always inspect this Liftgate for maintenance or damage before using it. If there are signs of damage or maintenance, damage to this unit, or damage to Platform surface, do not use the Liftgate until the problem has been corrected.

Do not overload the Liftgate. The load limit is based on evenly distributed cargo over the entire Platform surface. If you are using a pallet, be sure it can be maneuvered safely. Do not operate a forklift on the Platform or board with the platform in an open position at any time.

Load should be placed in a stable position close to the edge of the Platform toward the truck. The heaviest portion of the load should never be placed beyond the center of the Platform away from the truck.

Never allow yourself, a helper, or bystander to stand in a position where a falling load could land on either of you. Also do not allow any part of your helper's body to be placed inside, within, or across any portion of the moving Liftgate, or its mechanism, or in a position that would trap them between the platform and the ground or truck when the Liftgate is operated.

If a helper is riding the Platform with you, make sure you are both doing so safely and that you are not in danger of coming in contact with any moving or potentially moving obstacles. USE GOOD COMMON SENSE. If load appears to be unstable, do not lift or lower it.

For a free copy of manuals that pertain to this model Liftgate, please visit www.maxonlift.com or call Customer Service at (888) 227-4716.

DECAL #16 265439

WARNING
MAXIMUM CAPACITY OF THIS LIFT IS
3000 lbs.
WHEN LOAD IS CENTERED ON
LOAD CARRYING SURFACE OF PLATFORM

MAXON

DECAL (2 PLACES, MTB-30 ONLY)
P/N 265439

WARNING
A Liftgate extending from a moving vehicle could injure bystanders & damage property. Stow liftgate in correct transit position before moving vehicle.

DECAL P/N 282847-02

WARNING DECAL (2 PLACES)
P/N 282847-02

FIG. 48-1

TOUCHUP PAINT PRECAUTION

CAUTION

Damaged cylinder seals and contaminated hydraulic fluid can result from painting the polished portion of the cylinder rod. To prevent damage, protect the exposed polished portion of the cylinder rod while painting.

- If bare metal or primer is exposed on the painted portions of the Liftgate, touch up the paint. To maintain the protection provided by the original paint system, MAXON recommends aluminum primer touchup paint kit, P/N 908134-01.
- If bare metal is exposed on galvanized portions of the Liftgate, touch up the galvanized finish. To maintain the protection provided by the original galvanized finish, MAXON recommends cold galvanize spray, P/N 908000-01.

HYDRAULIC SYSTEM DIAGRAMS

HYDRAULIC SCHEMATIC (GRAVITY DOWN)

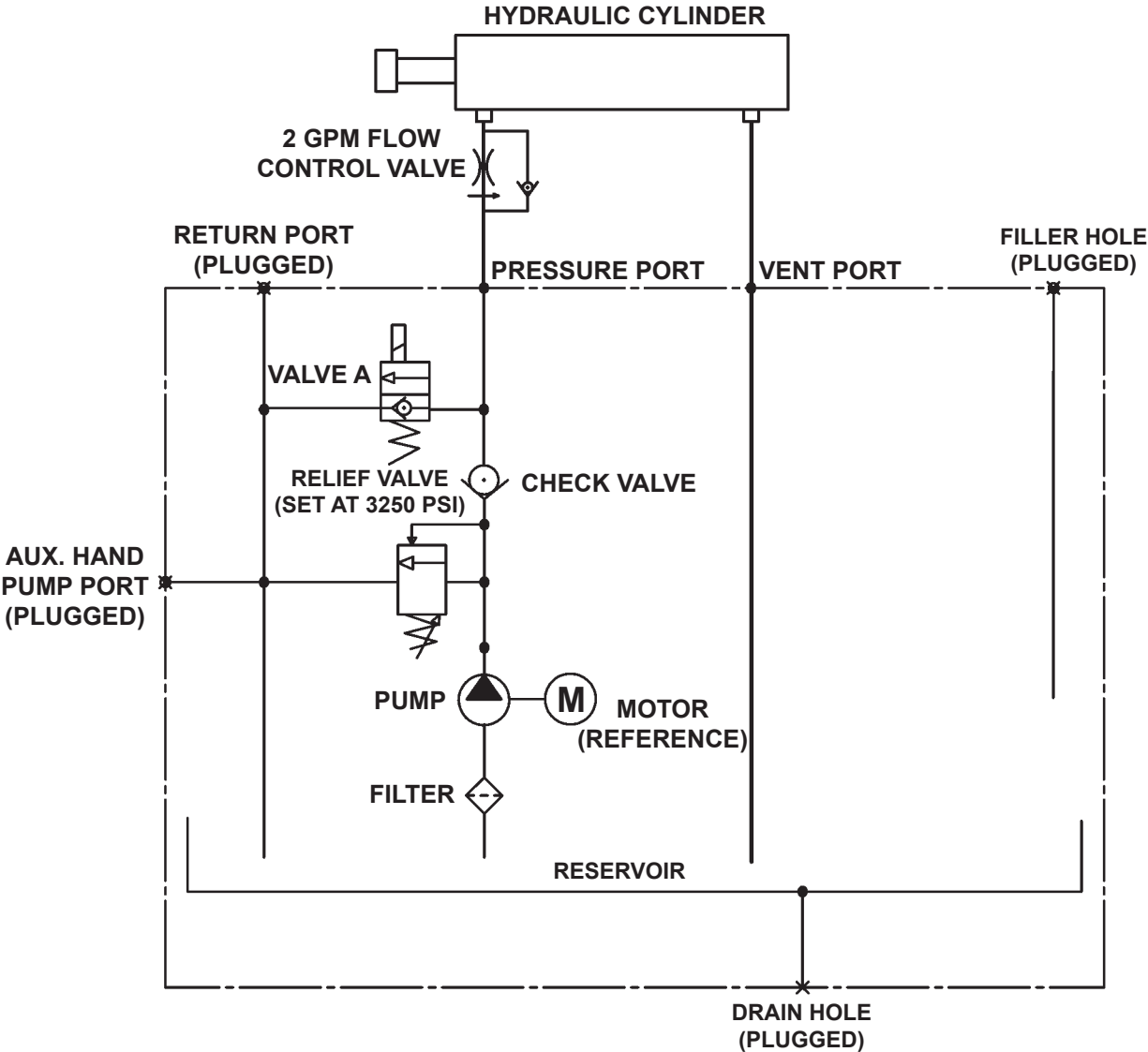

FIG. 50-1

HYDRAULIC SYSTEM DIAGRAMS

HYDRAULIC SCHEMATIC (POWER DOWN)

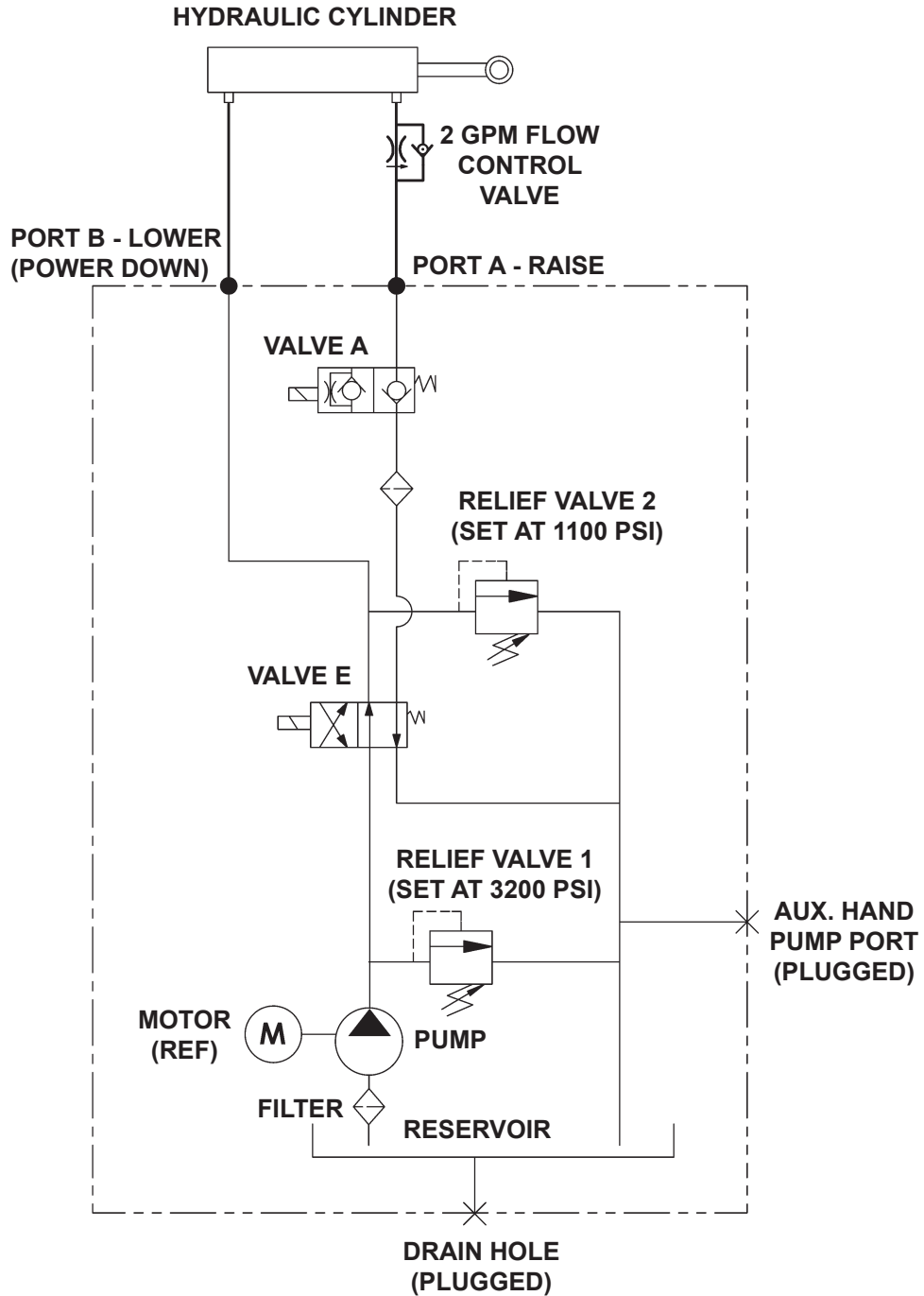

FIG. 51-1

ELECTRICAL SYSTEM DIAGRAMS

ELECTRICAL SCHEMATIC (GRAVITY DOWN)

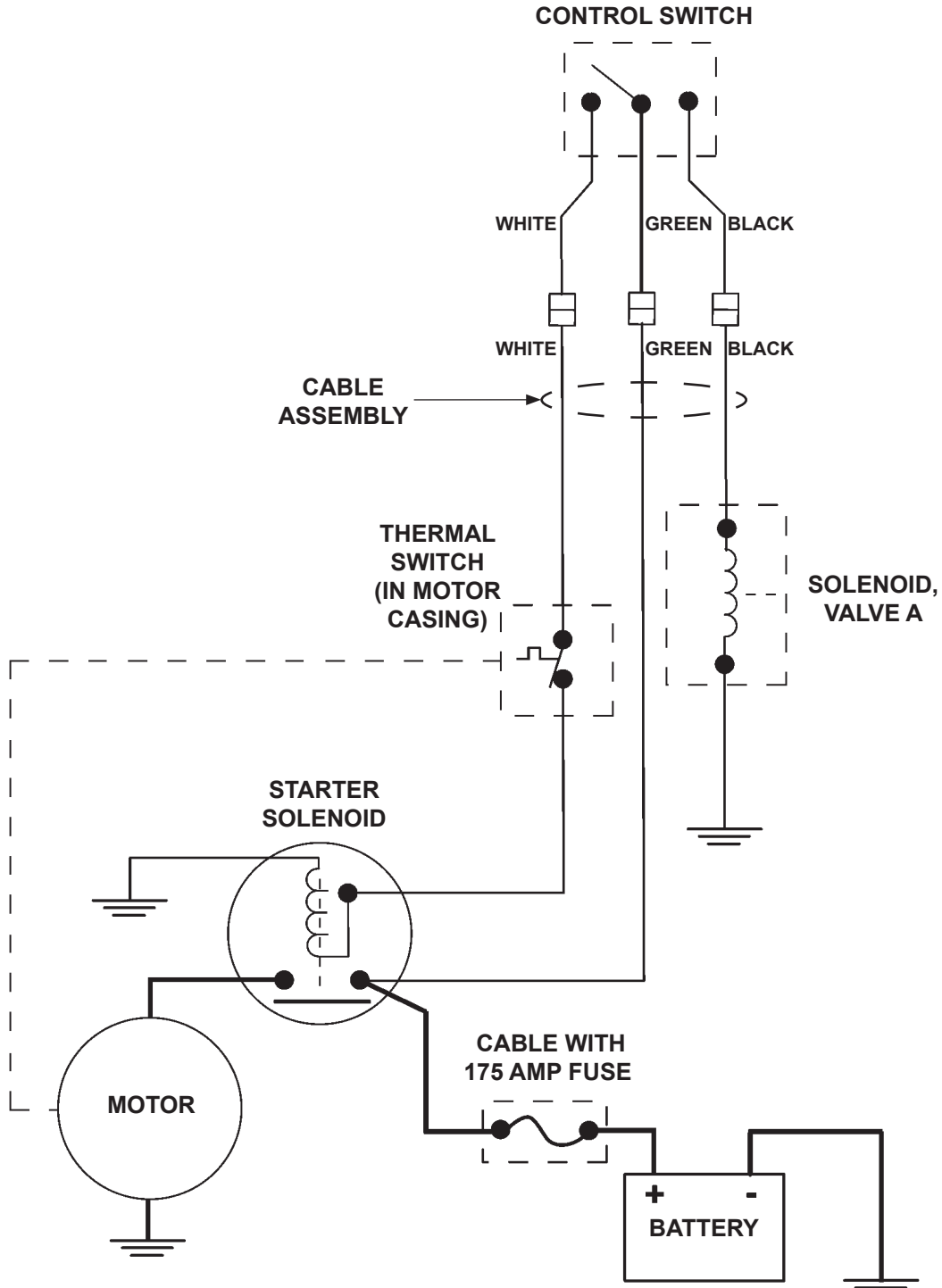

FIG. 52-1

ELECTRICAL SYSTEM DIAGRAMS

ELECTRICAL SCHEMATIC (POWER DOWN)

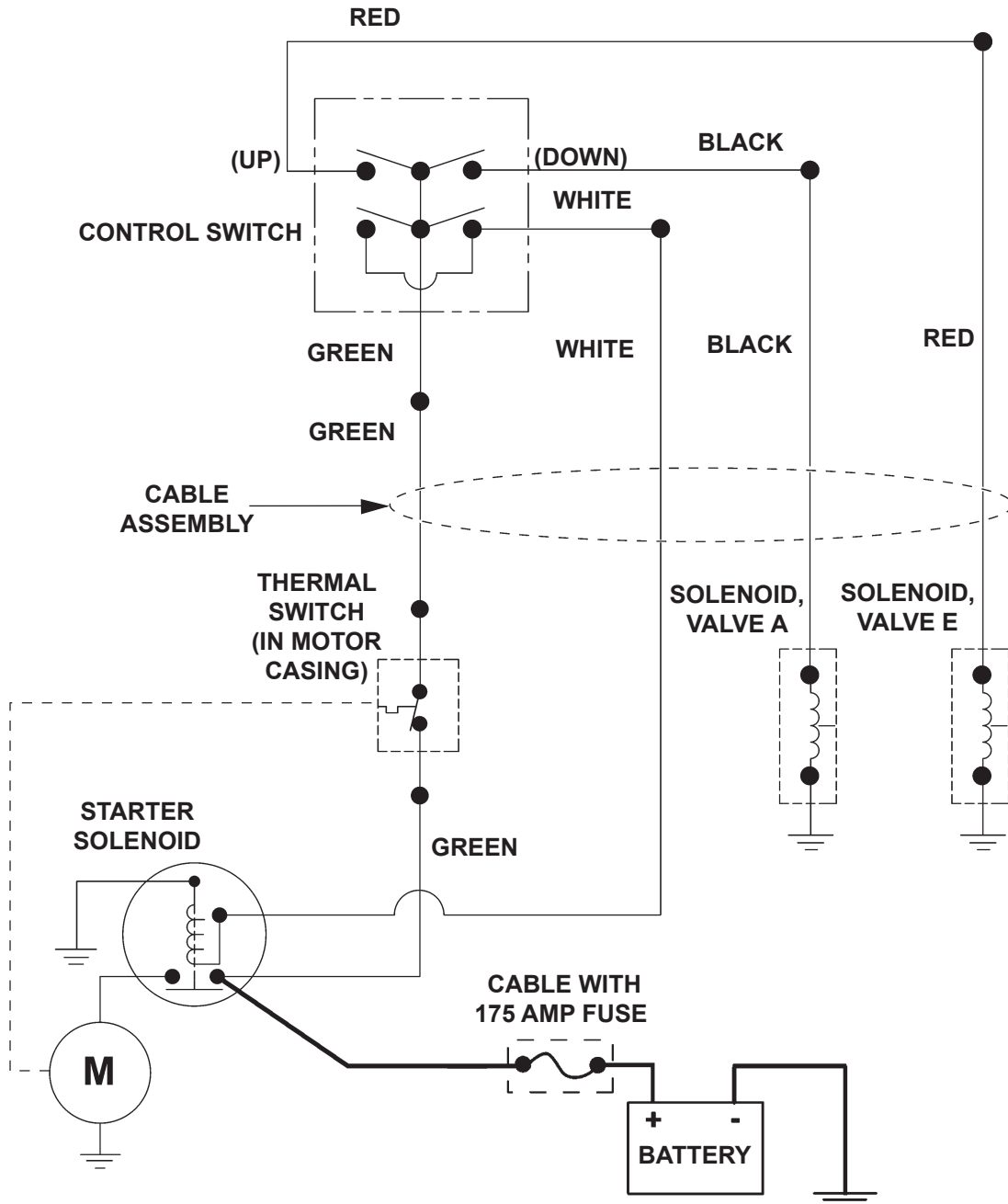

FIG. 53-1

OPTIONS OPTIONAL LIFTGATE COMPONENTS

| DOCK BUMPER KITS | | | |
|--|-----------------|-----------|-----------|
| RUBBER DOCK BUMPER KIT | 203410 | X | X |
| MISCELLANEOUS KITS | | | |
| | PART NO. | GD | PD |
| TRAFFIC CONES | 268893-01 | X | X |
| EXTENSION KIT (102" WIDE VEH) | 266113 | X | X |
| EXTENSION KIT (102" WIDE VEH), GALVANIZED | 266113-01G | X | X |
| EXTENSION PLATE HARDWARE KIT | 283257-03 | X | X |
| HAND PUMP, TUK-A-WAY (RECTANGLE-CUT RESERVOIRS, GRAVITY DN ONLY) | 281614-01 | X | |
| HAND PUMP, TUK-A-WAY (RECT & SQUARE RESERVOIRS, GRAVITY DN ONLY) | 268075-01 | X | |
| UNDERRIDE INSTALLATION | 264391 | X | X |
| UNDERRIDE INSTALLATION, GALVANIZED | 264391-01G | X | X |
| ELECTRICAL KITS | | | |
| IN CAB ON-OFF SWITCH | 250477 | X | X |
| TUK-A-WAY DUAL CONTROL KIT | 264845 | X | |
| TUK-A-WAY DUAL CONTROL KIT | 264845-02 | | X |
| 2 OVAL LIGHT FRAME MOUNTING BRACKET KIT | 282372-01 | X | X |
| 10 FT POWER CABLE EXTENSION | 264849 | X | X |
| STREET SIDE CONTROL KIT, TUK-A-WAY, GRAVITY DOWN | 280265-01 | X | |
| STREET SIDE CONTROL KIT, TUK-A-WAY, POWER DOWN | 280265-03 | | X |
| HAND HELD CONTROL ASSEMBLY (3 COND) | 280570-01 | X | |
| HAND HELD CONTROL ASSEMBLY (4 COND) | 280570-03 | | X |
| GROUND CABLE, 2 GAUGE X 38' LG. | 269190-01 | X | X |
| CIRCUIT BREAKER (150 AMP) | 251576 | X | X |
| CYCLE COUNTER KIT | 280590-01 | X | X |
| TOUCH-UP PAINT KIT | | | |
| TOUCH-UP PAINT (BCG) WITH ALUMINUM PRIMER, SMALL | 908134-01 | X | X |
| COLD GALVANIZE SPRAY, 16 OZ (GALVANIZED ONLY), | 908000-01 | X | X |
| BRIGHT ZINC SPRAY PAINT, 16 OZ (GALVANIZED ONLY) | 908100-01 | X | X |

MAXON[®] 11921 Slauson Ave. Santa Fe Springs, CA. 90670 (800) 227-4116 FAX (888) 771-7713

OPTIONS - Continued

RUBBER DOCK BUMPER KIT

NOTE: The rubber dock bumper kit P/N 203410 contains 2 rubber bumpers and 2 sets of fasteners. One additional rubber dock bumper kit can be installed if needed.

Bolt a rubber dock bumper to the RH side plate (**FIG. 55-1**). Repeat step for the LH side plate.

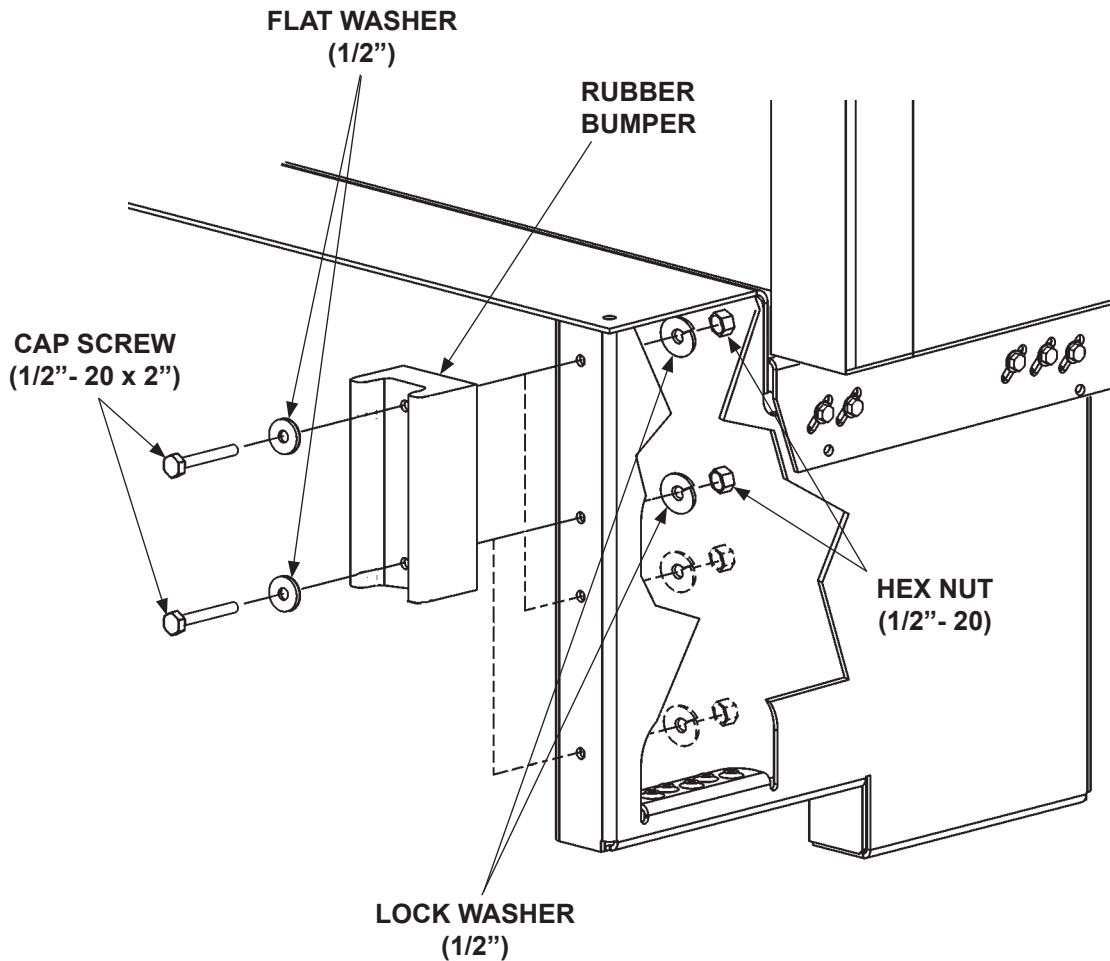

**BOLTING RUBBER BUMPER TO SIDE PLATE
(RIGHT HAND SIDE PLATE SHOWN)**

FIG. 55-1

