

# INSTRUCTION, GPT LOW VOLTAGE SWITCH (LVS) INSTALLATION KIT P/N 267494-01

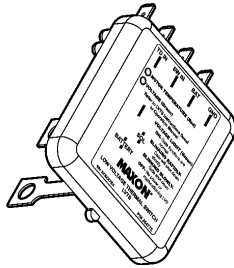

**LOW VOLTAGE SWITCH (LVS)**  
P/N 905291  
QTY. 1

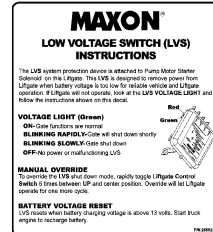

**LVS INSTRUCTION DECAL**  
P/N 265923-01  
QTY. 1

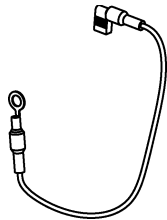

**GROUND WIRE  
(RED WIRE)**  
P/N 267473-01  
QTY. 1

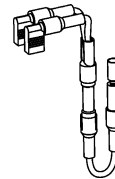

**LVS WIRE ASSEMBLY  
(WHITE WIRE)**  
P/N 280547-01  
QTY. 1

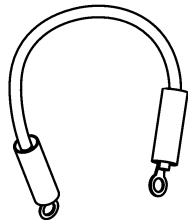

**CABLE ASSEMBLY,  
#4 GA, 10" LG.**  
P/N 250926-05  
QTY. 1



**SHRINK TUBING,  
1/4" x 1" LG, BLACK**  
P/N 250673  
QTY. 1

**⚠ WARNING**

To prevent personal injury and equipment damage, make sure power is disconnected from Liftgate while installing electrical parts.

1. Remove nut from positive (+) battery terminal connector. Disconnect the Fused Power Cable (**FIG. 2-1**). Reinstall nut.

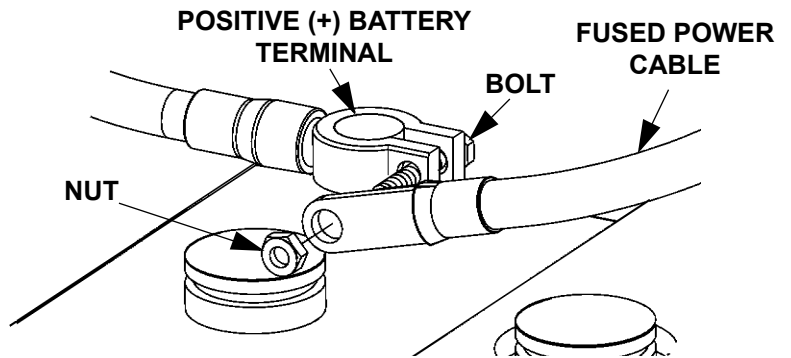

**DISCONNECTING FUSED POWER CABLE  
FIG. 2-1**

2. Open Pump Box Cover (**FIG. 2-2**) to gain access to wiring connected to Pump and Motor (**FIG. 2-2**).

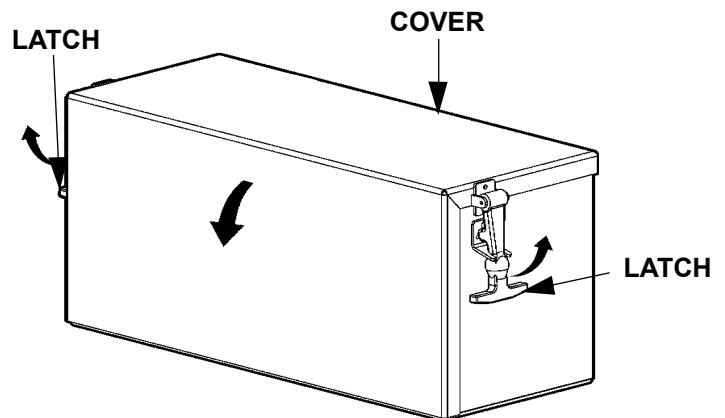

**OPENING PUMP BOX COVER  
FIG. 2-2**

3. Disconnect the Green Wire, Fused Power Cable, and White Wire from Starter Solenoid (**FIG. 3-1**) by removing 2 nuts and 2 lock washers. Also, remove Bus Bar by removing 2 hex nuts and 2 lock washers (**FIG. 3-1**). Keep all hex nuts and lock washers to reinstall.

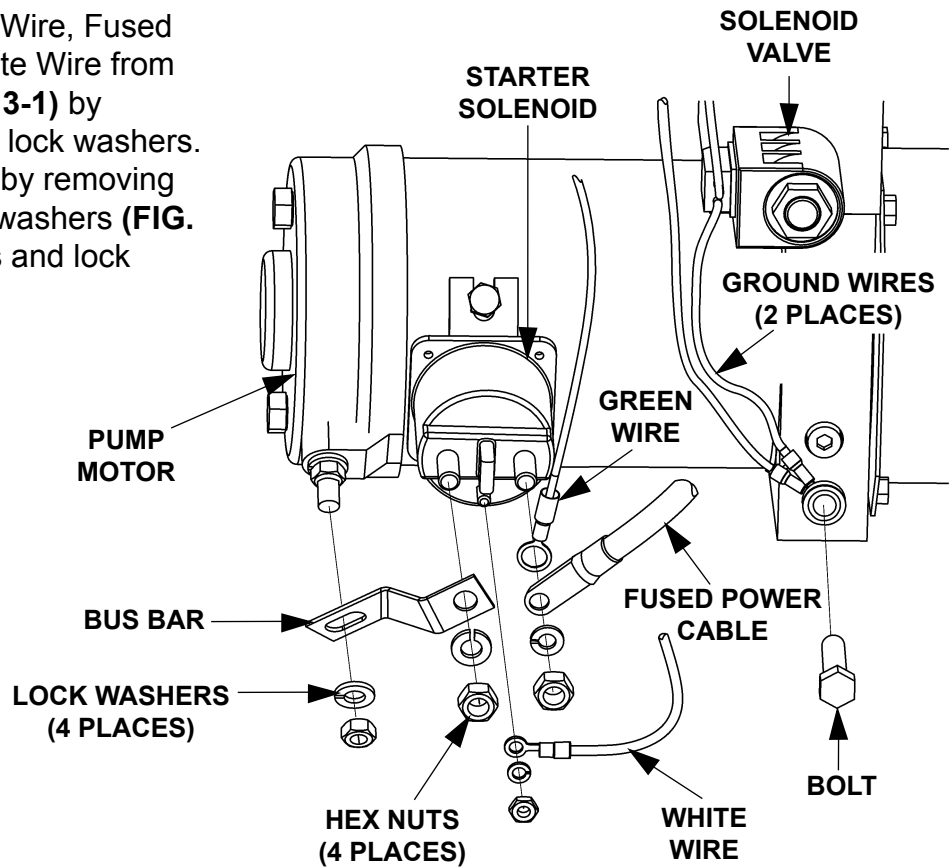

**DISCONNECTING WIRING FROM PUMP & MOTOR  
FIG. 3-1**

4. Unbolt the 2 Solenoid Valve ground wires (**FIG. 3-1**).

**CAUTION**

To prevent damage to Motor and Starter Solenoid, torque the hex nuts on the electrical terminals to 40 lbs-in.

**NOTE:** For the Pump to operate correctly, the LVS & connecting wiring must be connected only as shown in **FIG. 4-1**. The Green Wire & Fused Power Cable are reconnected to a different Starter Solenoid terminal than the original connections. The 4 Gauge Cable, that replaces original Bus Bar, is also connected to a different terminal on the Starter Solenoid.

5. Connect 4 Gauge Cable (Kit item) to Starter Solenoid and Motor as shown in **FIG. 4-1**. Next reconnect Green Wire and Fused Power Cable to Starter Solenoid (**FIG. 4-1**). Then connect LVS Device (Kit item) to Starter Solenoid as shown in **FIG. 4-1**. Torque the 4 hex nuts to 40 lbs.-in.

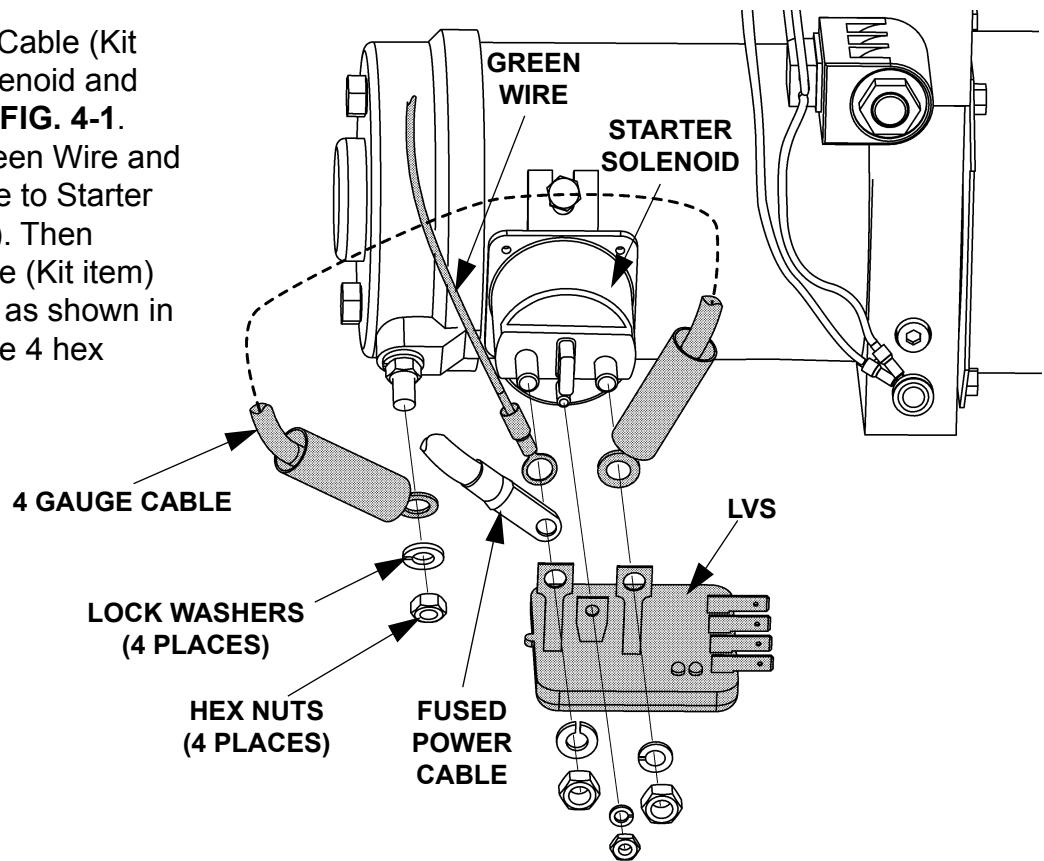
**FIG. 4-1**

6. Connect Red Wire (Kit item) to GRND terminal on the LVS Device (**FIG 5-1**). Then bolt the other end of Red Wire and the 2 Solenoid Valve ground wires to the Pump (**FIG. 5-1**).

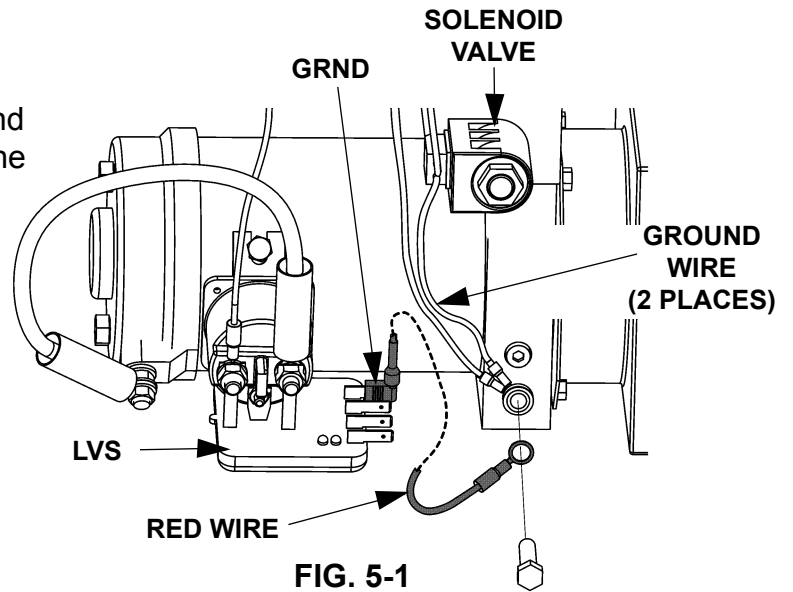

7. Disconnect male bullet terminal from White Wire Assembly (**FIG. 5-2**). Cut off terminal lug from White Wire disconnected in Step 3. Strip 1/4" insulation from disconnected white wire and crimp male bullet terminal on stripped end of White Wire (**FIG. 5-3**). Slide Shrink Tubing over crimped portion of male bullet terminal as shown in (**FIG. 5-4**) and use heat gun to shrink it in place. Connect male bullet terminal on White Wire to White Wire Assembly (Kit Item) (**FIG. 5-5**).

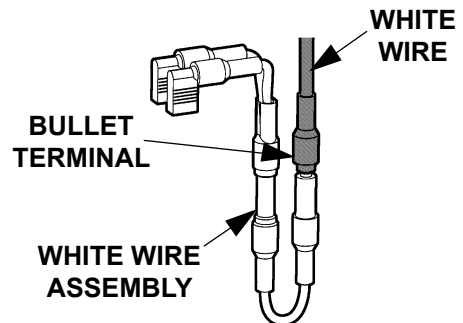
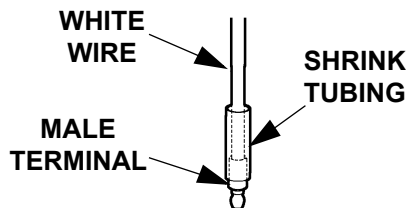
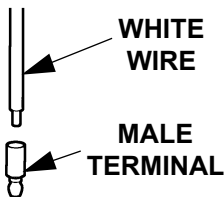
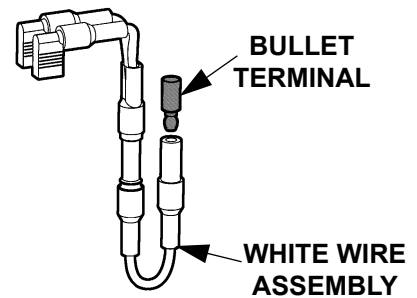

8. Connect the 2 terminals lugs on White Wire Assembly (Kit item) to “SW IN” & “TD IN” terminals on the LVS Device as shown FIG. 6-1.

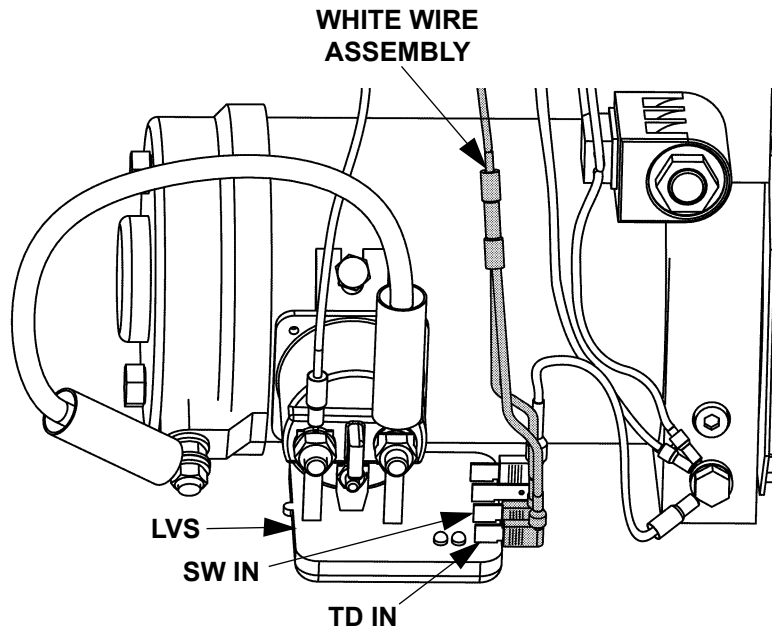

**CONNECTING WHITE WIRE ASSY  
FIG. 6-1**

9. Make sure wiring is connected correctly (FIG. 6-2).

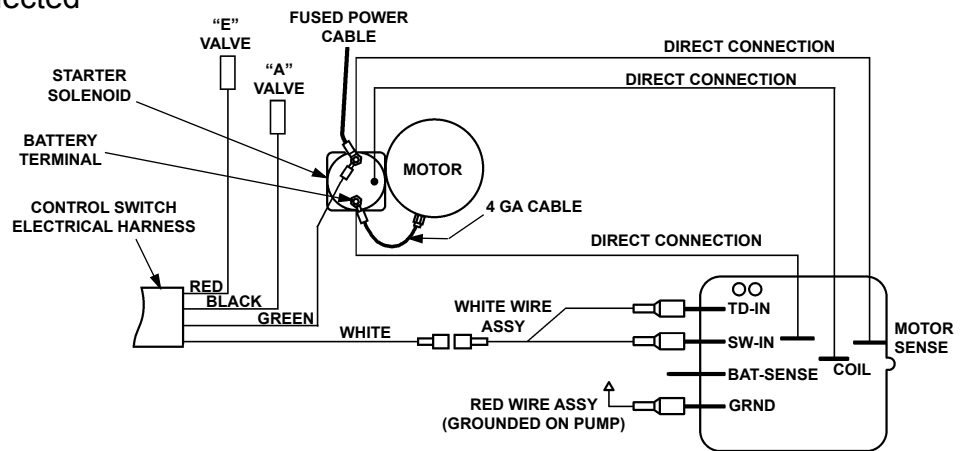

**LVS WIRING DIAGRAM  
FIG. 6-2**

10. Attach decal to pump reservoir (FIG. 7-1).

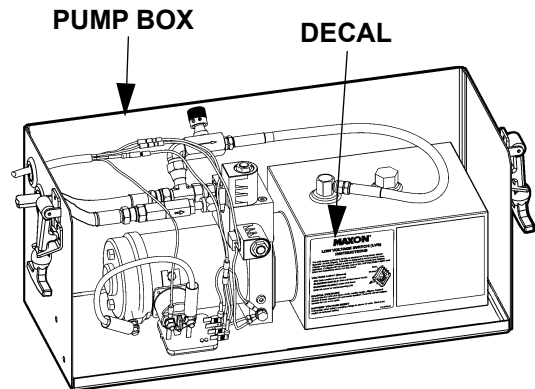

**DECAL ATTACHED TO PUMP RESERVOIR  
FIG. 7-1**

11. Close Pump Box Cover (FIG. 7-2).

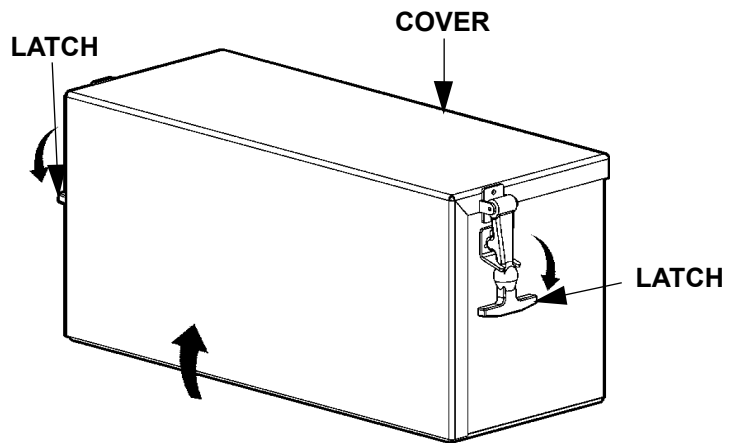

**CLOSING PUMP BOX COVER  
FIG. 7-2**

12. Remove nut from positive (+) battery terminal connector. Re-connect the Fused Power Cable to positive (+) battery terminal connector (FIG. 7-3). Reinstall and tighten nut.

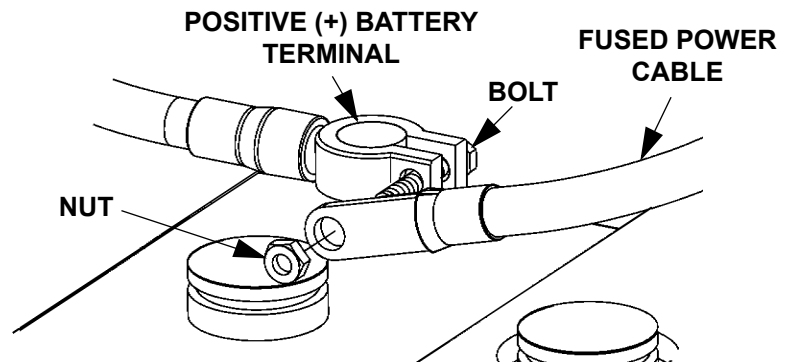

**RECONNECTING FUSED POWER CABLE  
FIG. 7-3**