

INSTRUCTION, GPT GREASE-ABLE PINS KIT

GPT-25 & GPT-3 (COMMON ASSEMBLY) KIT P/N 283450-01

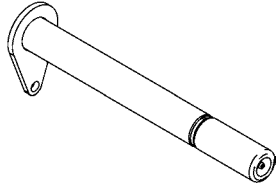

PIN ASSEMBLY, SPRING
P/N 265807-101
QTY. 2

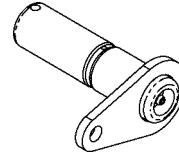

PIN ASSEMBLY, SHACKLE, 5-1/2" LG.
P/N 282714-101
QTY. 2

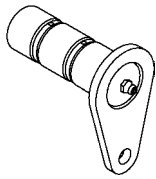

PIN ASSEMBLY, CYLINDER
P/N 228922-101
QTY. 2

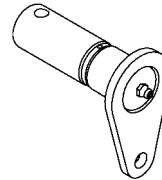

PIN ASSEMBLY, LIFT ARM
P/N 266035-101
QTY. 2

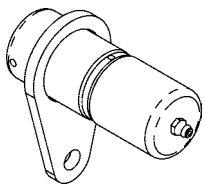

PIN ASSEMBLY
P/N 229657-101
QTY. 2

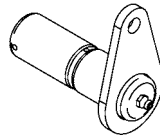

PIN ASSEMBLY, PARALLEL ARM
P/N 250310-101
QTY. 2

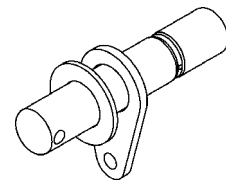

PIN ASSEMBLY (ROLLER)
P/N 253045-101
QTY. 2

REPLACING PINS & ROLLERS

1. Lower platform to the ground.
2. Unfold platform and flipover.
3. Raise platform to comfortable work height.
Place jack stands under the LH and RH shackles and under the platform near the platform and flipover hinge.

! WARNING

To prevent personal injury and equipment damage, make sure power is disconnected before replacing parts on Liftgate.

4. Disconnect power by removing nut from positive (+) battery terminal connector and disconnecting fused power cable (FIG. 2-1). Reinstall nut.

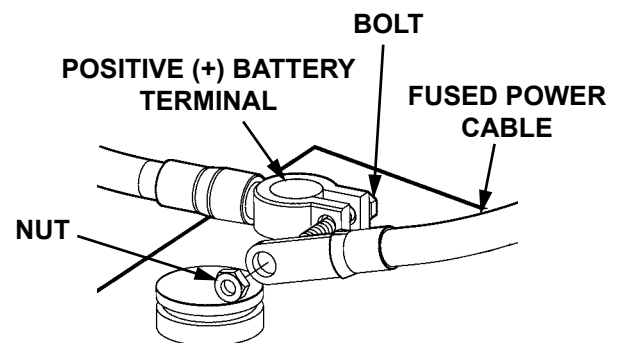

**DISCONNECTING POWER &
RECONNECTING POWER TO LIFTGATE
FIG. 2-1**

! CAUTION

To prevent possible personal injury and equipment damage, replace cylinder pins only with platform at ground level.

5. Replace the pins shown on **Sheet 3** with grease-able pins from the Kit.
When replacing cylinder pins, comply with **CAUTION** above. Use procedure on **Sheet 4** to replace spring pins.
6. When installation is complete, grease each pin through grease fitting. Use a grease suitable for heavy machinery operating in below-freezing temperatures
7. Reconnect power by removing nut from positive (+) battery terminal connector and reconnecting fused power cable (FIG. 2-1). Reinstall nut.

NOTE: The illustration below is a guide for replacing the original pins, on a GPT-25 or GPT-3 Liftgate with grease-able pins from the Kit. Replace one pin at a time. Do not completely disassemble liftgate.

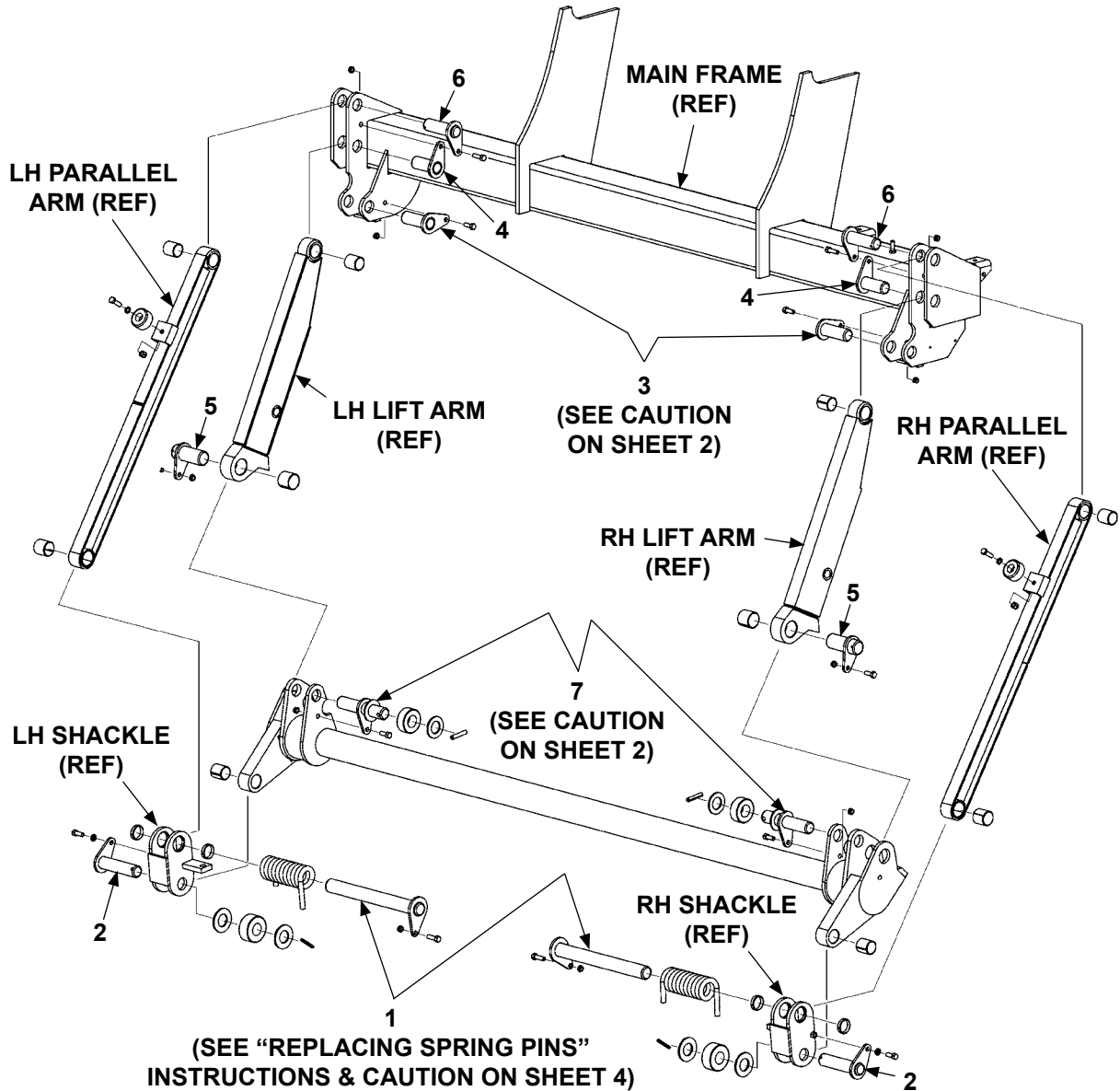

ITEM	QTY.	PART NO.	DESCRIPTION
1	2	265807-101	PIN ASSEMBLY, SPRING
2	2	262714-101	PIN ASSEMBLY, SHACKLE
3	2	228922-101	PIN ASSEMBLY, CYLINDER
4	2	266035-101	PIN ASSEMBLY, LIFT ARM
5	2	229657-101	PIN ASSEMBLY
6	2	250310-101	PIN ASSEMBLY, PARALLEL ARM
7	2	253045-101	PIN ASSEMBLY (CYLINDER & ROLLER)

REPLACING SPRING PINS

NOTE: The following procedure shows how to replace spring pin on RH side of platform with a grease-able spring pin from Kit. Also use this procedure for replacing spring pin on the LH side.

1. Fold platform and flipover to gain access and release tension on the torsion spring.

CAUTION

To prevent injury and equipment damage, make sure there is no tension on torsion spring before removing spring pin.

2. Unbolt spring pin from hinge support (FIG. 4-1). Remove bolt and lock nut. Drive the spring pin inboard toward shackle with a hammer and pin punch, just enough to free the torsion spring (FIG. 4-1). Remove spring from shackle. Then remove the spring pin.

3. Install the torsion spring as shown in FIG. 4-2. Make sure the long leg of the spring is inserted in the bracket located on shackle (FIG. 4-2). Make sure the short end of the spring is visible and resting against the edge of the hinge support (FIG. 4-2).

4. Drive the new spring pin (Kit item) into correct position (FIG. 4-2) through the hinge support with a hammer and pin punch. Line up the bolt hole in the spring pin with the hole in the hinge support. Bolt spring pin to hinge support with bolt and lock nut (FIG. 4-2).

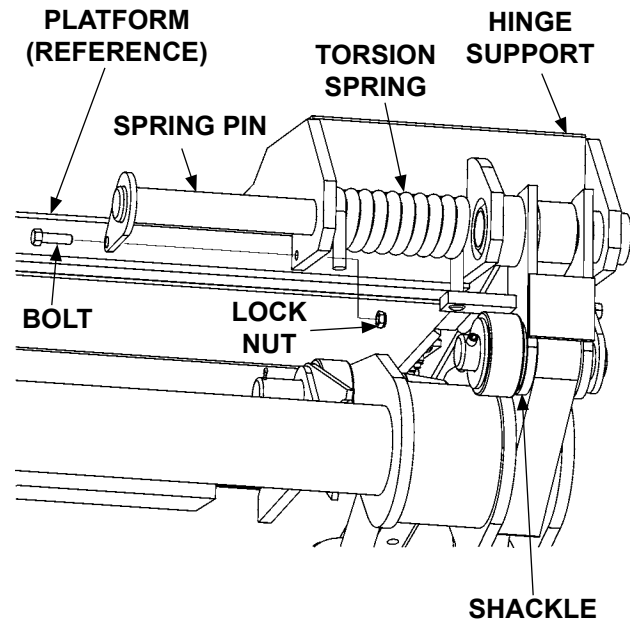

REMOVING SPRING & SPRING PIN
FIG. 4-1

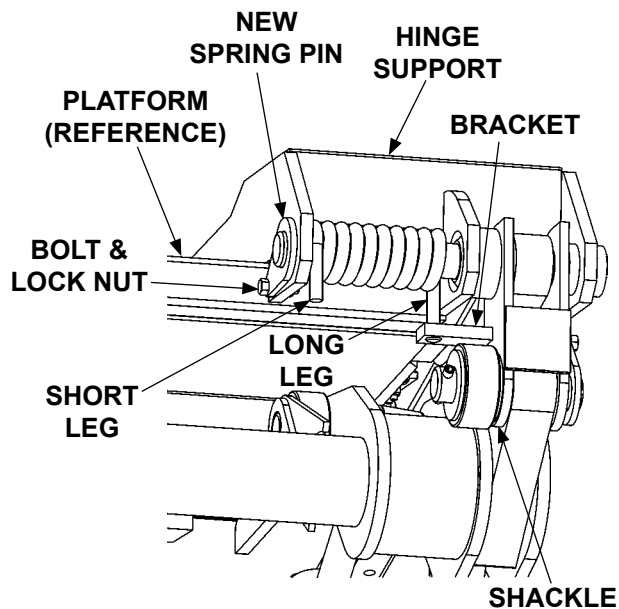

INSTALLING SPRING & SPRING PIN
FIG. 4-2