

INSTRUCTION, BMRA COUPLING BOLT FIELD KIT

KIT P/N 285280-01

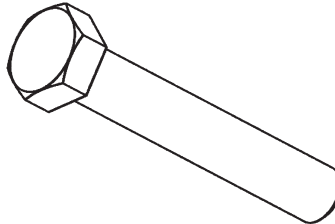

HEX BOLT PIN, 3/4"-10 X 4-1/2" LG.
P/N 900032-7
QTY. 1

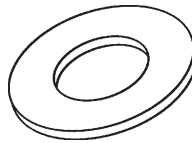

FLAT WASHER, 3/4", .090" THICK
P/N 902000-20
QTY. 1

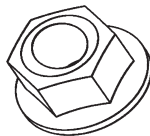

FLANGE LOCK NUT, 3/4"-10
P/N 901023-05
QTY. 1

NOTE: Refer to **Operation Manual** for instructions to operate Liftgate.

1. Use control box to lower the platform **(DOWN)** to approximately 12" above the ground. Support platform with 2 jack stands (**FIG. 2-1**). Make sure ramp edge is 4" higher than inboard edge of platform.

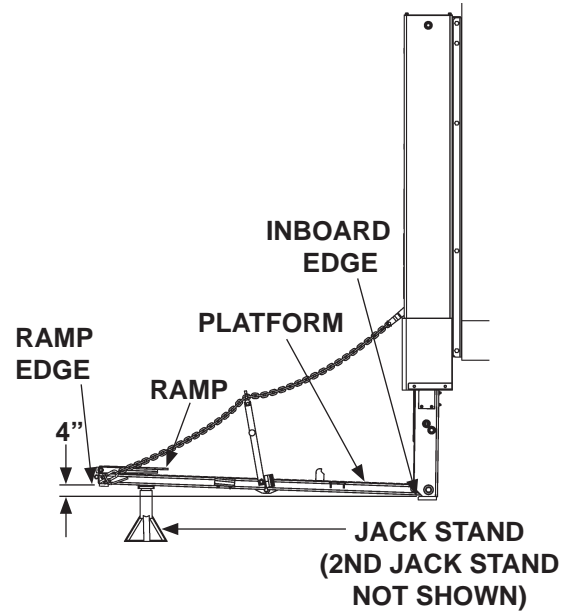

FIG. 2-1

2. Unbolt pin collar from RH runner to remove chain arm (**FIG. 2-2**). Then, unbolt and remove cover from runner. Repeat for LH chain arm and LH runner.

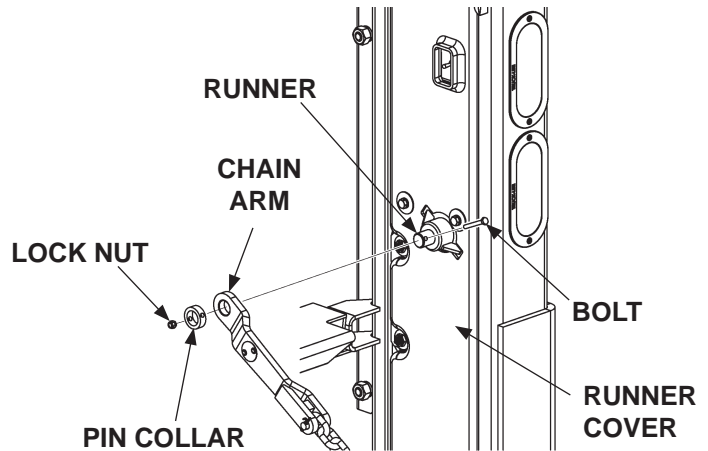

FIG. 2-2

3. Raise the platform (UP) slightly and place 2 more jack stands near the inboard edge (FIG. 3-1).

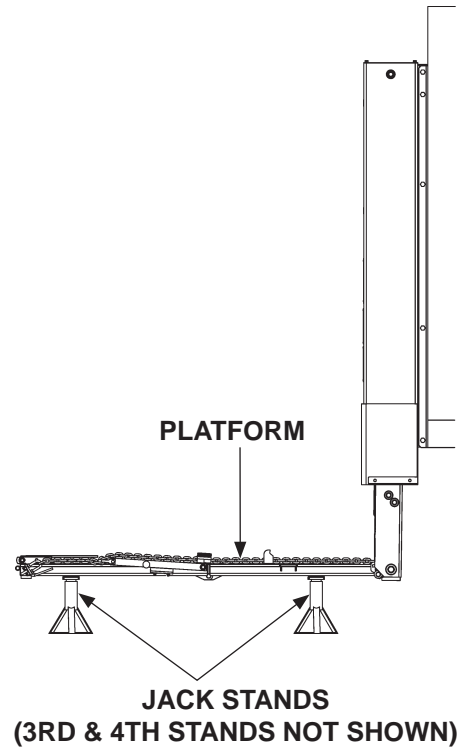
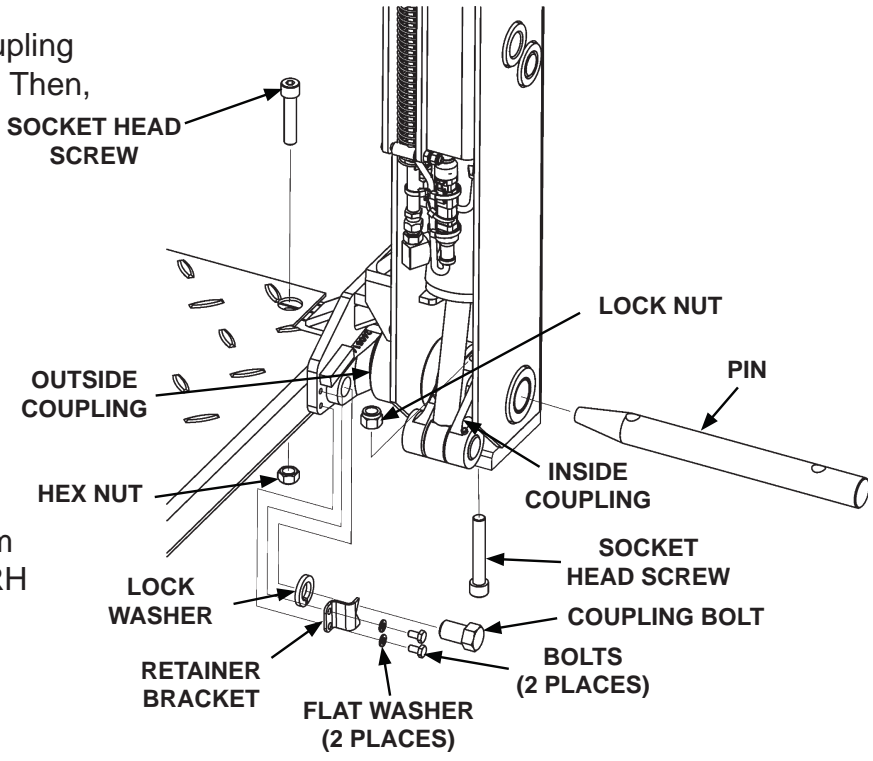

FIG. 3-1

4. Unbolt pin from platform connector bar and inner coupling at the RH runner (FIG. 3-2). Then, remove pin.



5. Unbolt outside coupling from platform connector bar on RH side of platform (FIG. 3-2). Discard bolt.

FIG. 3-2

6. Unbolt pin from platform connector bar, LH coupling, and pin collar on the LH runner (FIG. 4-1). Then, remove pin.

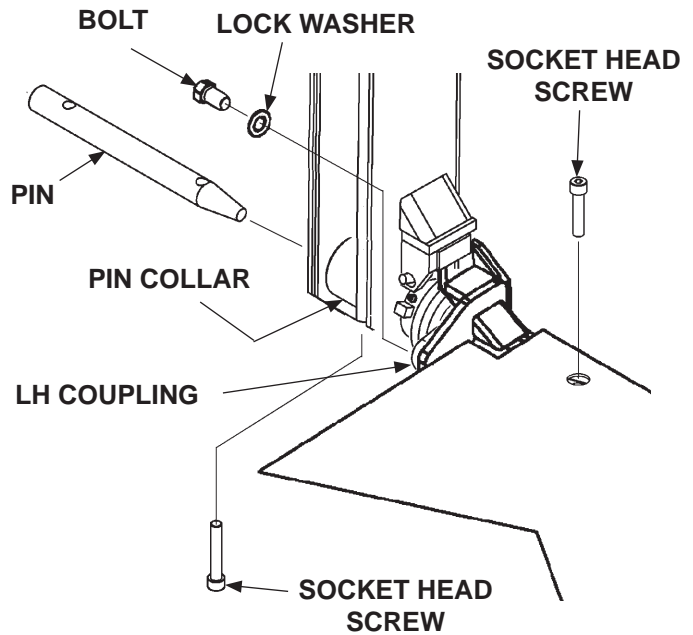

7. Unbolt LH coupling from platform connector bar on LH side of platform (FIG. 4-1). Save bolt to reinstall.

FIG. 4-1

8. Use a forklift or equivalent lifting device to move the platform approximately 6" towards the front of the vehicle to clear the platform away from the attaching points on the runners (FIG. 5-1). When platform is clear of the runners, raise the runners (UP) a few inches. Then, lower platform down on the supports.

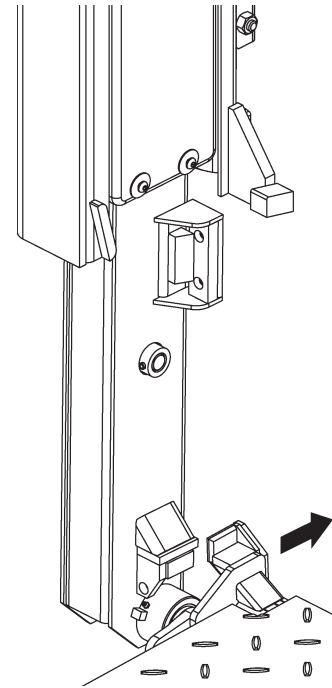

MOVING PLATFORM CLEAR OF RUNNERS

FIG. 5-1

9. Using the RH platform connector bracket as a template (FIG. 5-2A) mark center of hole for the new coupling bolt.

10. Drill a 1/4" pilot hole through platform tube (FIG. 5-2B). Next, use either a titanium step drill or tapered reamer to drill 3/4" hole through RH platform connector bracket and platform tube.

CONNECTOR BRACKET

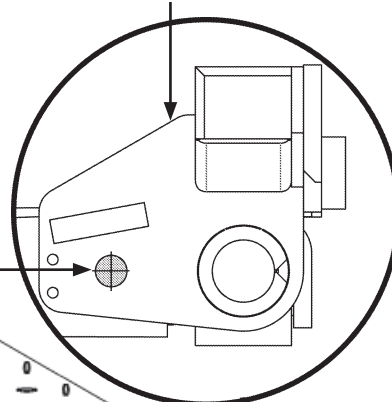

MARKING CENTER FOR BOLT HOLE
FIG. 5-2A

BOLT HOLE

STEEL PLATFORM (REF)

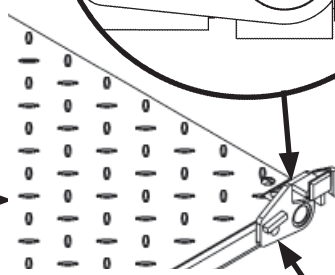
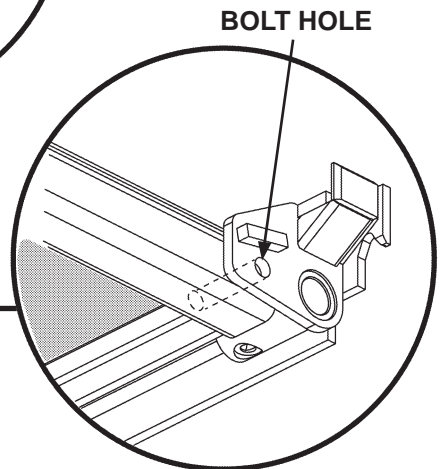

FIG. 5-2



BOLT HOLE

DRILLING BOLT HOLE
FIG. 5-2B

11. Use a forklift or equivalent lifting device to lift platform and line it up with attaching points on the LH runner (FIG. 6-1) and RH runner.

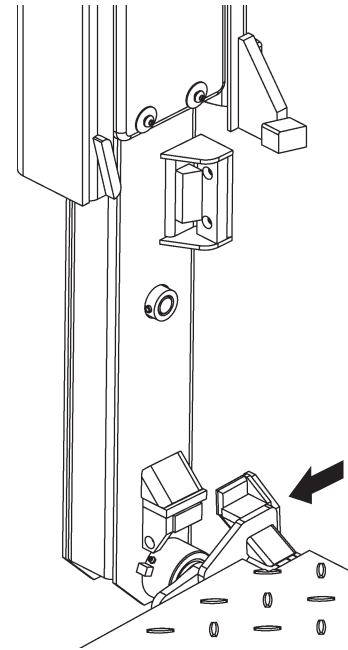

FIG. 6-1

12. Insert pin through runner, inside and outside couplings, and platform connector at the RH runner. Then, bolt pin to inside coupling and platform (FIG. 6-2).

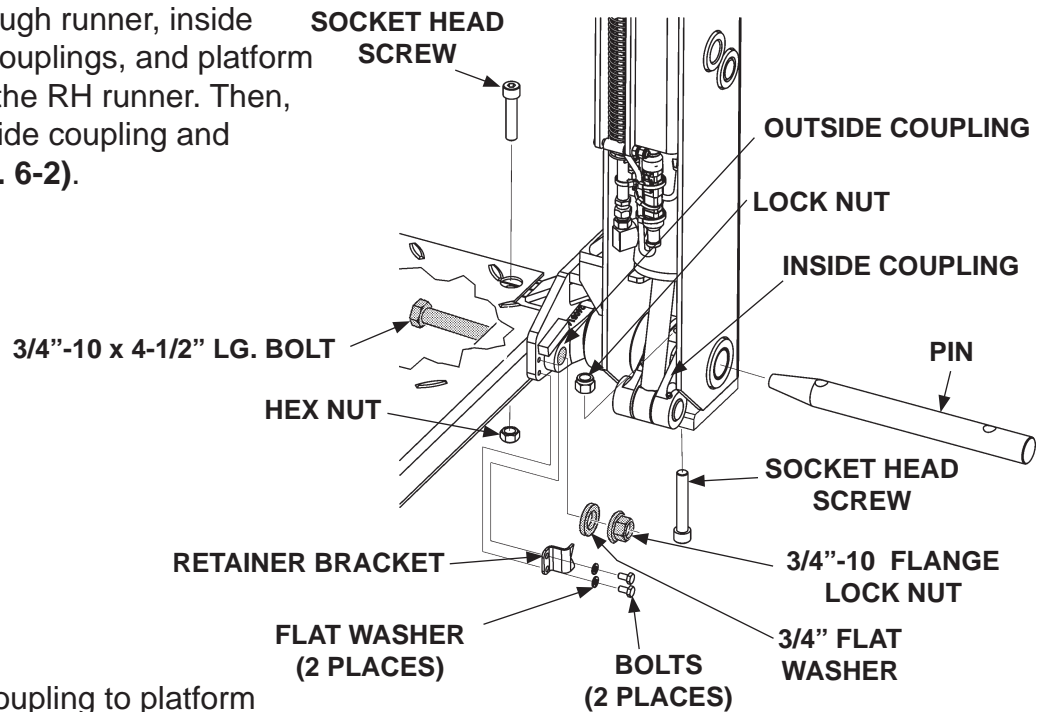
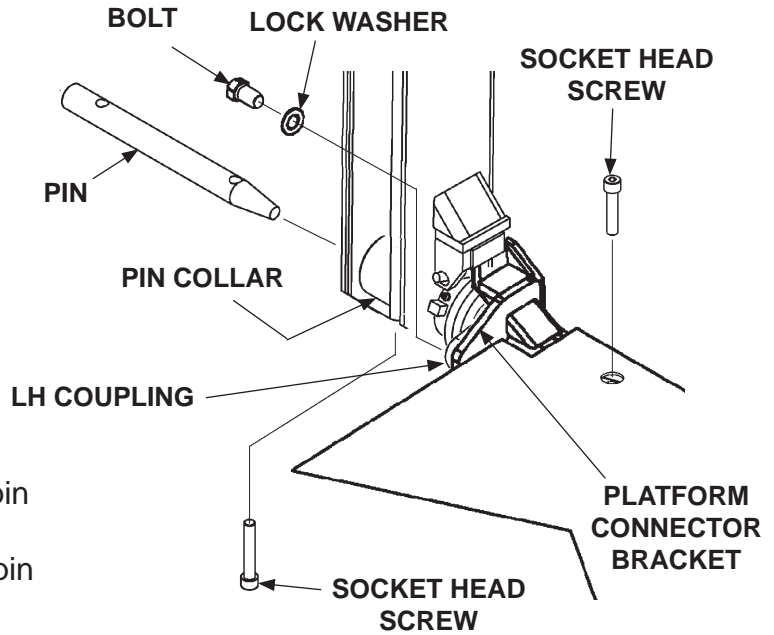

FIG. 6-2

13. Bolt outside coupling to platform connector bracket with 3/4"-10 bolt, 3/4" flat washer and 3/4" -10 flange lock nut. (Kit items) (FIG. 6-2). Then, bolt retainer bracket (if equipped) to connector bracket.

14. Bolt LH coupling to LH platform connector bracket (FIG. 7-1).



15. Insert pin through LH coupling, pin collar and platform at LH runner (FIG. 7-1). Then, bolt pin to LH pin collar and platform (FIG. 7-1).

FIG. 7-1

16. Use control box to raise the platform (UP) slightly and remove 2 jack stands near the inboard edge (FIG. 7-2).

17. Use control box to lower (DOWN) platform on jack stands (FIG. 7-2) so inboard edge is 4" below ramp edge.

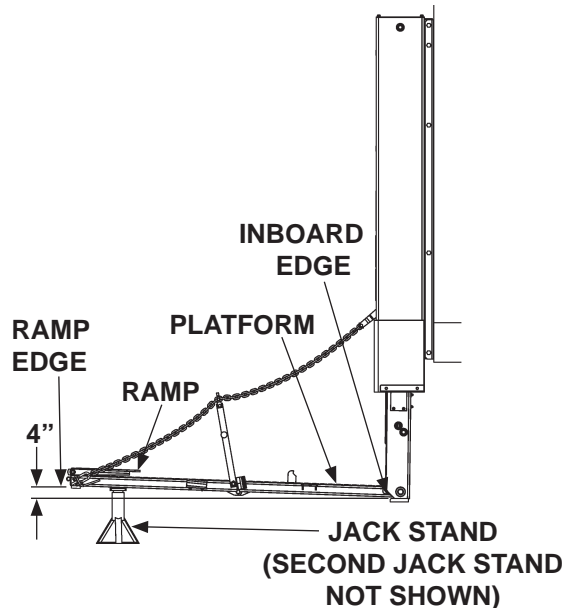

FIG. 7-2

18. Reattach chain arm to RH runner. Then, bolt on the pin collar to secure chain arm (FIG. 8-1). Repeat for LH runner.

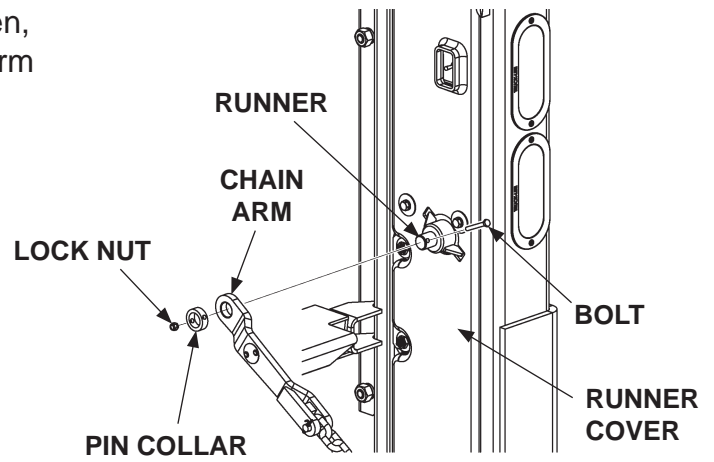

FIG. 8-1