

INSTRUCTION, BMR AUXILIARY CONTROL**GRAVITY DOWN CONTROL KIT, P/N 297080-11****POWER DOWN CONTROL KIT, P/N 297080-12**

ELECTRICAL CONTROL TEE
P/N 296898-01
QTY. 1

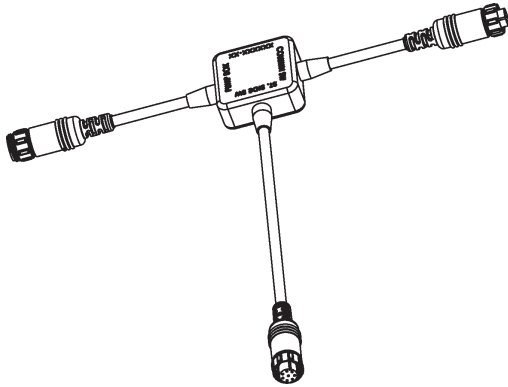

**PLASTIC ENCLOSURE WITH
GRAVITY DOWN CONTROL (-11 KIT) OR
POWER DOWN CONTROL (-12 KIT)**
QTY. 1

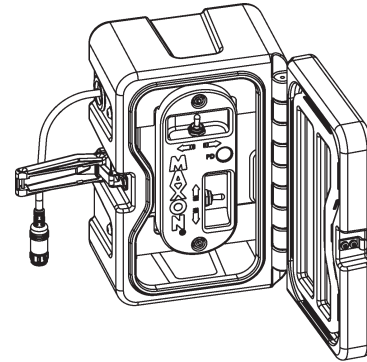
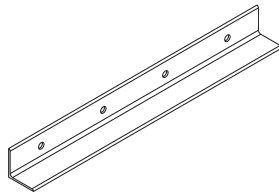

ANGLE, 2" X 2" X 1/8" X 20" LG
P/N 263299
QTY. 1

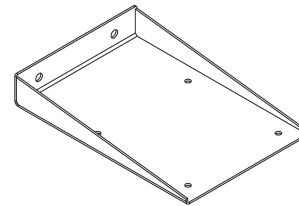

ANGLE PLATE
P/N 263264-01
QTY. 1

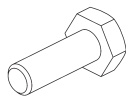

CAP SCREW
1/4"-20 X 1" LG, GRADE 8
P/N 900004-3
QTY. 4

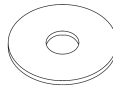

WASHER, 1/4"
P/N 903438-01
QTY. 8



LOCK NUT, 1/4"-20
P/N 901000
QTY. 8

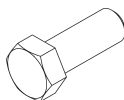

HEX CAP SCREW
3/8"-16 X 1" LG, GRADE 8
P/N 900014-4
QTY. 2



FLAT WASHER, 3/8"
P/N 902001-2
QTY. 4



LOCK NUT, 3/8"-16
P/N 901002
QTY. 2

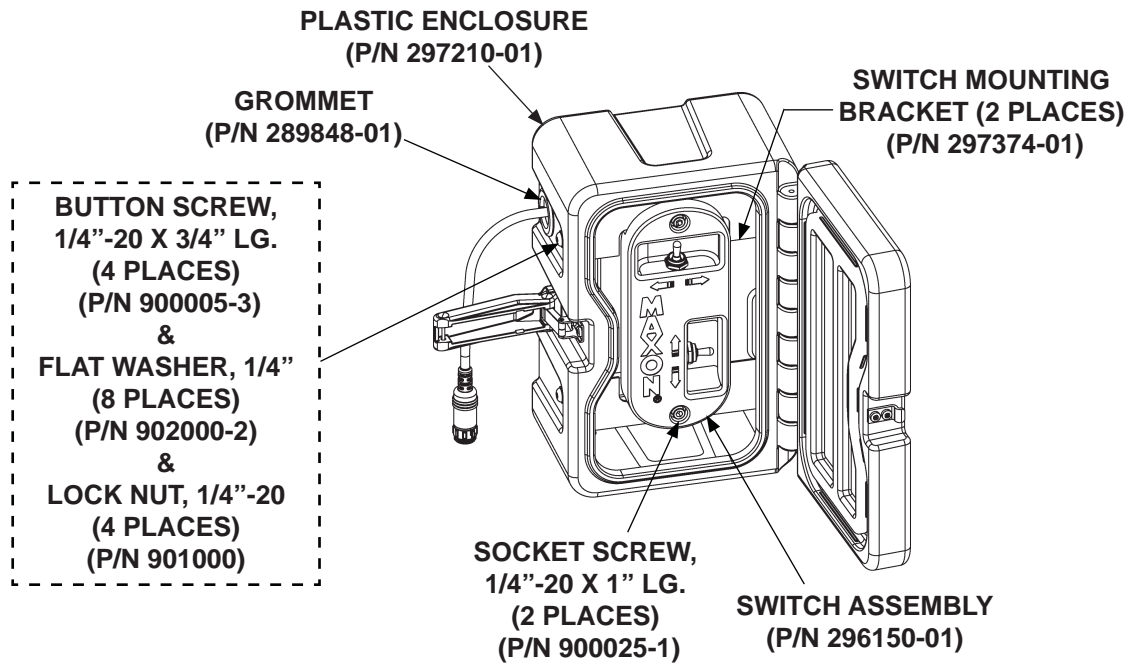

ENCLOSURE ASSEMBLY WITH GRAVITY DOWN CONTROL (-11 KIT)

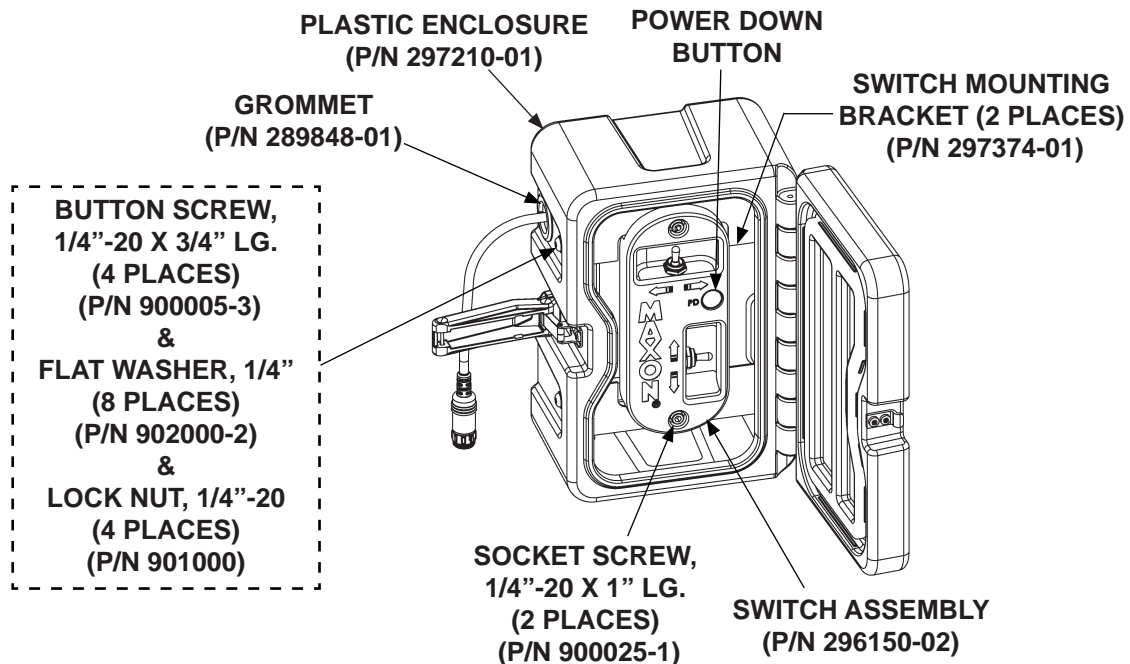

ENCLOSURE ASSEMBLY WITH POWER DOWN CONTROL (-12 KIT)

WIRING HARNESS LOCKING RING CONNECTORS

CAUTION

Before connecting, ensure connectors are clean inside. Ensure there is a thin coating of dielectric grease on face of receptacle, and there is no dielectric grease on connector contacts.

Refer to illustrations below for disconnecting, checking for dielectric grease, and reconnecting locking ring style connectors.

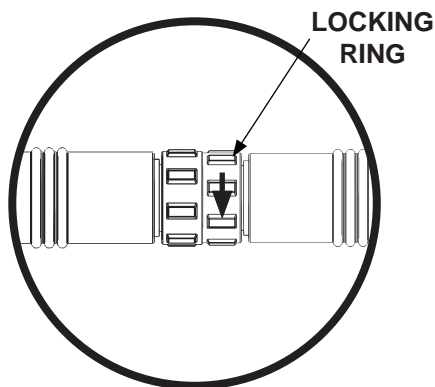

TURN LOCKING RING TO UNLOCK
FIG. 3-1

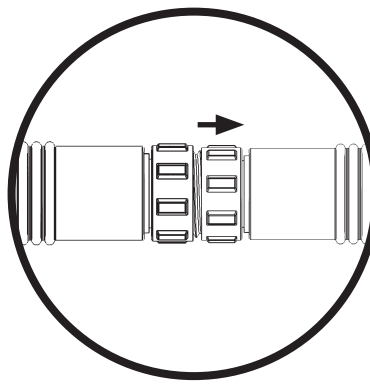

PULL LOCKING RING TO DISENGAGE
FIG. 3-2

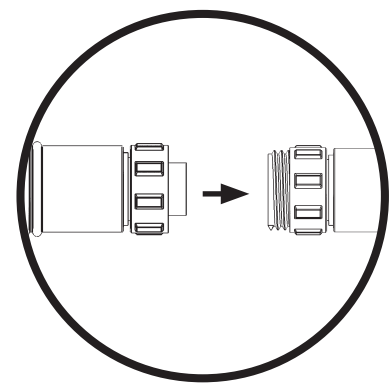

PULL CONNECTOR TO DISCONNECT
FIG. 3-3

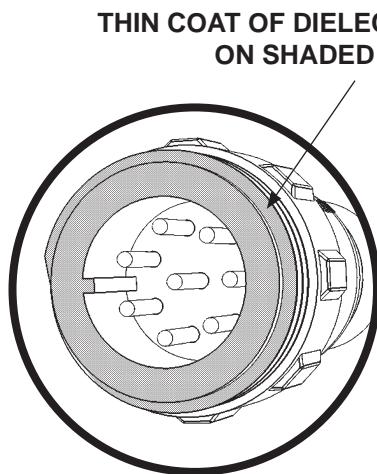

DIELECTRIC GREASE ON RECEPTACLE
FIG. 3-4

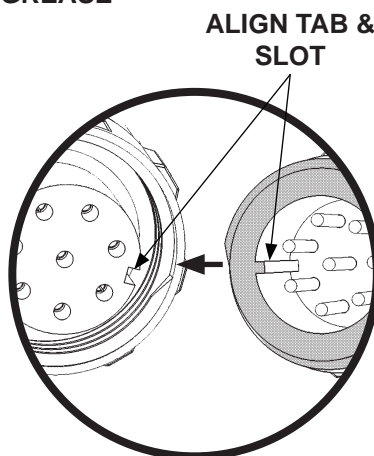

ALIGN & CONNECT
FIG. 3-5

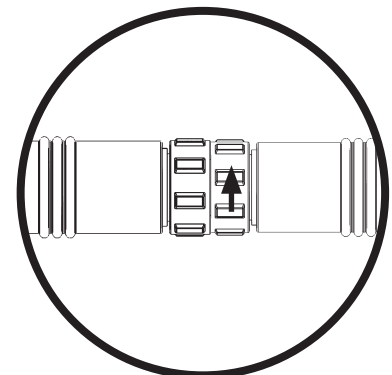

TIGHTEN TO LOCK
FIG. 3-6

⚠ WARNING

Recommended practices for welding on steel parts are contained in the current AWS (American Welding Society) D1.1 Structural Welding Code - Steel. Damage to Liftgate and/or vehicle, and personal injury can result from welds that are done incorrectly.

1. Measure and mark 10" from the RH column and 2" in from the edge of the vehicle. Then position the angle (Kit item) to crossmembers of vehicle body (FIG. 4-1).

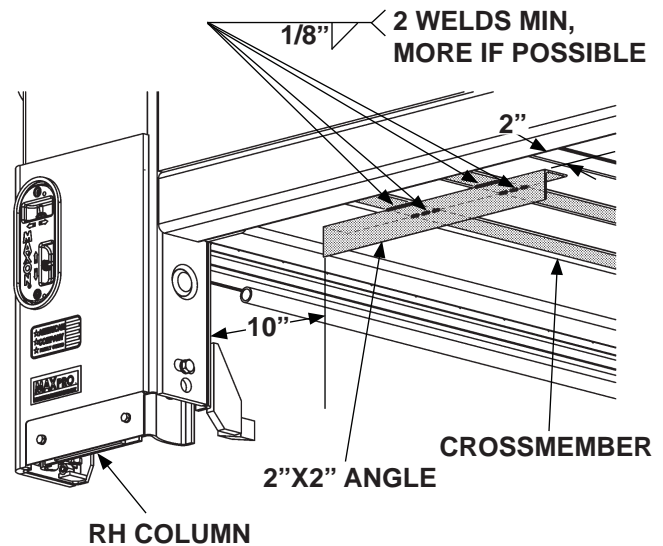

**VIEW OF VEHICLE BODY & RH COLUMN
FIG. 4-1**

2. Weld the angle to the truck/trailer crossmembers (FIG. 4-1).
3. Bolt the angle plate (Kit item) to angle (FIG. 4-2).

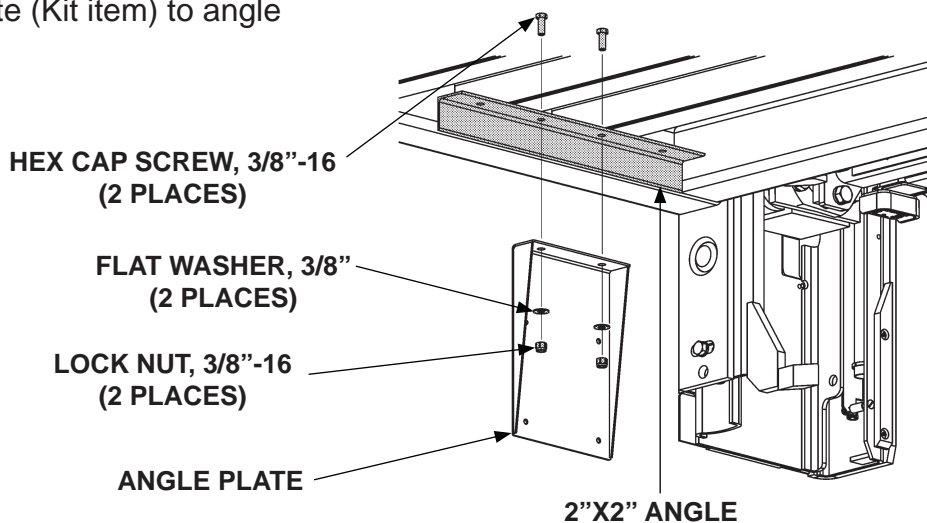

**BOLTING ANGLE PLATE TO ANGLE (RH COLUMN SHOWN)
FIG. 4-2**

CAUTION

Allow welds to cool before attaching plastic enclosure.

4. Bolt the plastic enclosure (Kit item) to the angle plate (**FIG. 5-1**).

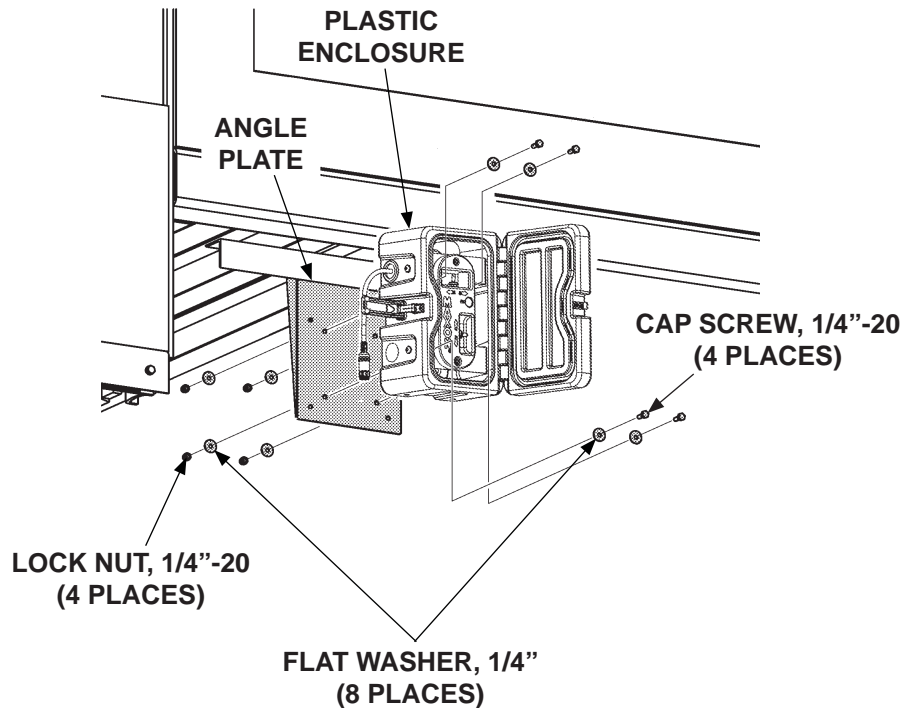

BOLTING ENCLOSURE TO ANGLE PLATE
FIG. 5-1



To prevent accidental personal injury and equipment damage, make sure power is disconnected from Liftgate while installing parts.

5. Turn **OFF** the master disconnect switch at the pump box to disconnect battery power from the hydraulic pumps. Refer to **BMR Operation Manual** for detailed instructions.

6. Route the tee (Kit item) to the RH column (**FIG. 6-1**).

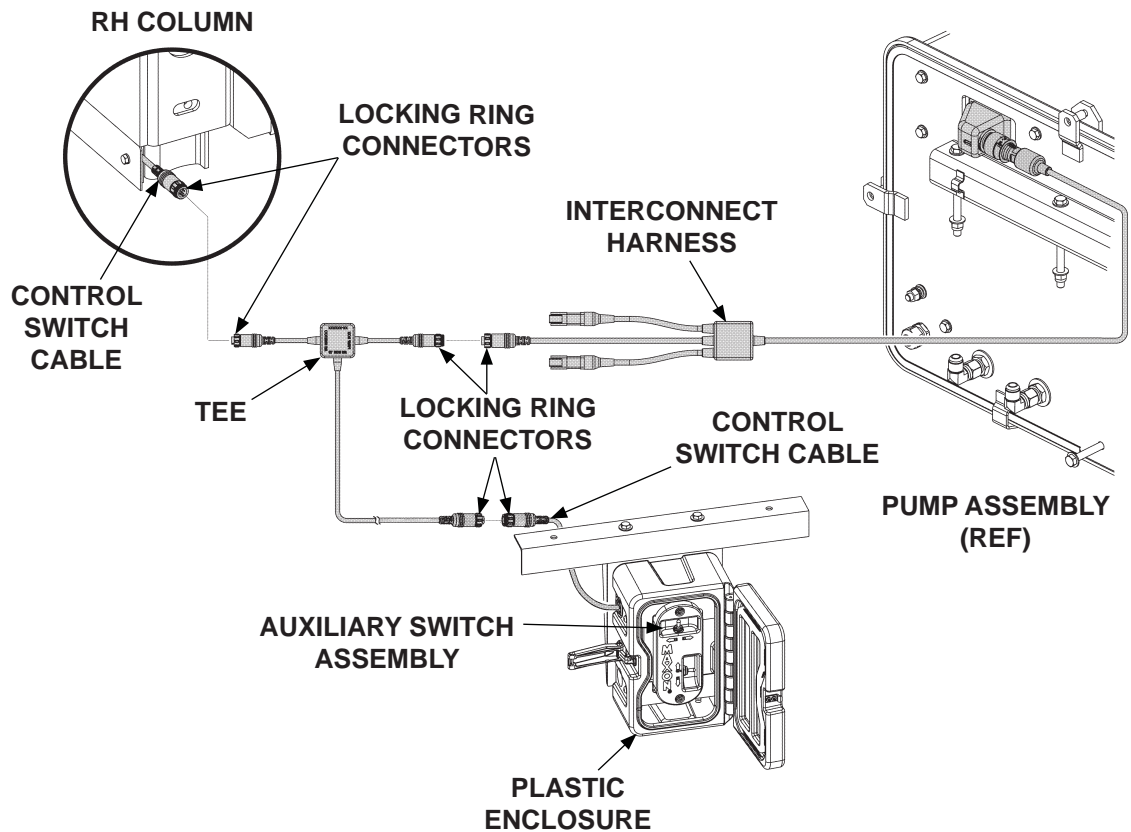

CONNECTING CABLES TO CONTROL TEE
FIG. 6-1

NOTE: Refer to Sheet 3 for important information about locking ring electrical connectors.

7. Disconnect interconnect harness from control switch cable on the RH column (**FIG. 6-1**). Then, connect tee to control switch cable in the RH column and interconnect harness (**FIG. 6-1**).
8. Connect tee to the control switch cable connector extending from plastic enclosure (**FIG. 6-1**).
9. Reconnect battery power to the hydraulic pumps by turning **ON** the master disconnect switch at the pump box. Refer to **BMR Operation Manual** for detailed instructions.

NOTE: Use the auxiliary control to check operation of the Liftgate.

10. Push column **UP/DOWN** toggle switch to **DOWN** position (**FIG. 7-1**) to lower platform (**FIG. 7-2A**) until yellow runner arrow and column decal are aligned (**FIG. 7-2B**). Platform will be released from the locking wedges on the Liftgate column. Next, use auxiliary control switches **1** and **2** to **UNFOLD** platform (**FIG. 7-2C**). Hold both toggle switches until platform reaches the unfolded (horizontal) position and then release the switches.

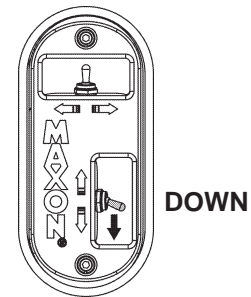

**AUXILIARY CONTROL SWITCH
(GRAVITY DOWN SHOWN)
FIG. 7-1**

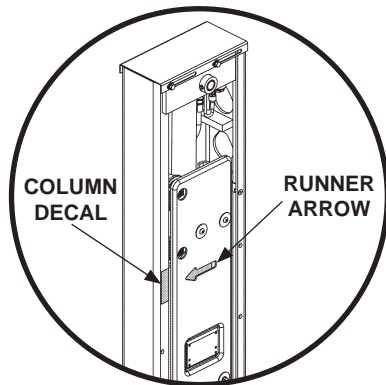
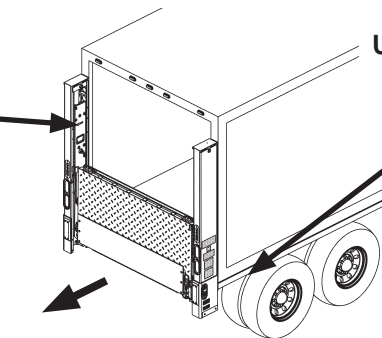
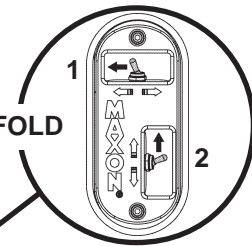

FIG. 7-2B



**UNFOLDING PLATFORM
FIG. 7-2A**



**AUXILIARY CONTROL
FIG. 7-2C**

11. To **LOWER** platform to the ground, use auxiliary control switch as shown in **FIG. 8-1**. Release toggle switch when platform reaches the ground.

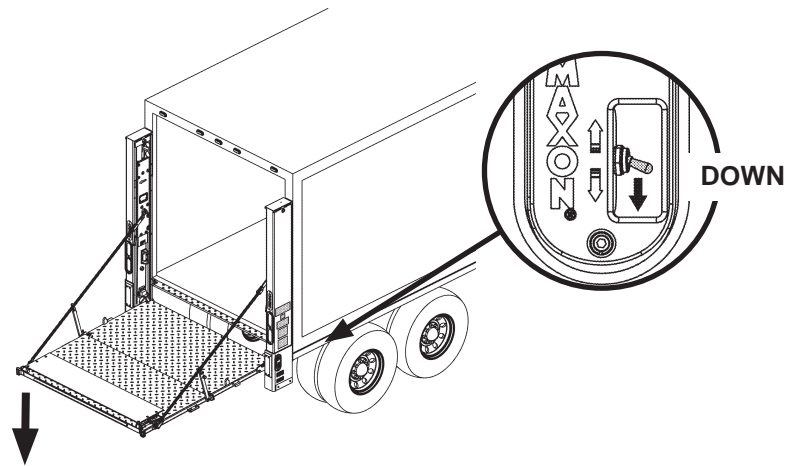

**LOWERING PLATFORM TO GROUND
USING AUXILIARY CONTROL SWITCH
FIG. 8-1**

12. To **RAISE** platform, use auxiliary control switch as shown in **FIG. 8-2**. Release switch when platform reaches bed height.

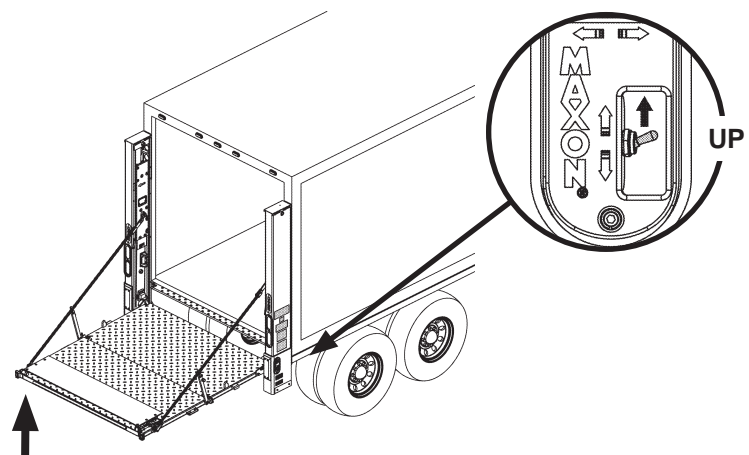

**RAISING PLATFORM
USING AUXILIARY CONTROL SWITCH
FIG. 8-2**

13. To stow platform, push toggle switch to **DOWN** position (**FIG. 9-1A**) to lower platform until yellow runner arrow and column decal are aligned (**FIG. 9-1B**).

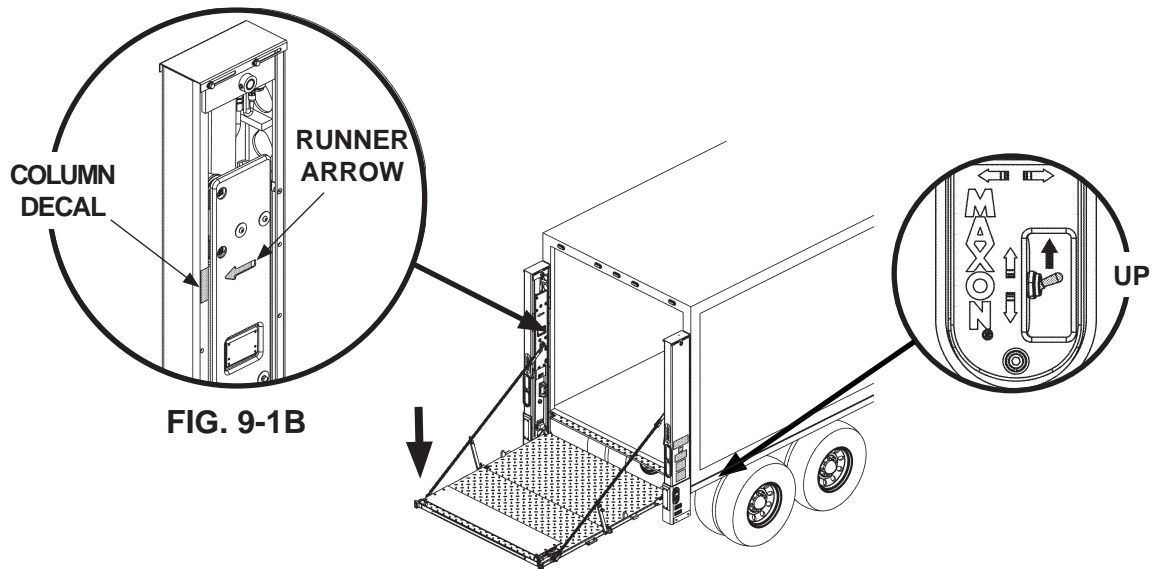

**STOWING PLATFORM
USING AUXILIARY CONTROL SWITCH
FIG. 9-1A**

14. Hold both street side control switches 1 and 2 to **FOLD** platform (**FIG. 9-2**).

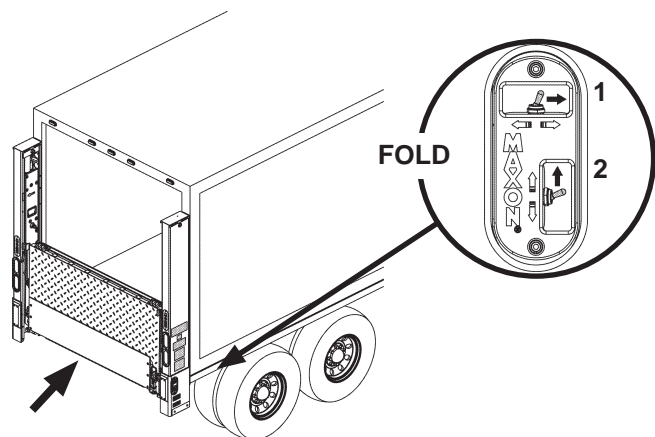

**FOLDING PLATFORM
USING AUXILIARY CONTROL SWITCH
FIG. 9-2**

⚠ WARNING
Upper locking wedges must be engaged before moving vehicle.

15. Use auxiliary control switch to raise **(UP)** platform to upper locking position as follows **(FIG. 10-1A)**. Raise platform until round wedge on each opener arm is behind the upper locking wedge on each column **(FIG. 10-1B)**.

