

INSTRUCTION, GPT LOW VOLTAGE THERMAL SWITCH (LVTS) INSTALLATION KIT P/N 282473-01

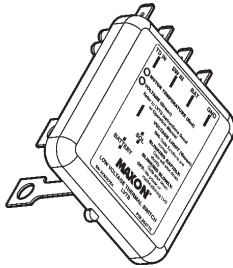

LOW VOLTAGE THERMAL SWITCH (LVTS)
P/N 905291
QTY. 1

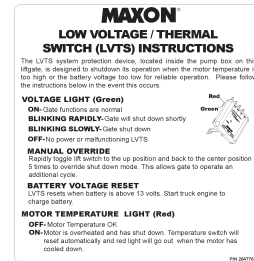

INSTRUCTION DECAL
P/N 264776
QTY. 1

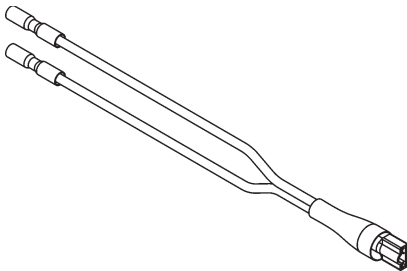

**WIRE ASSEMBLY
DUAL (WHITE WIRE)**
P/N 282519-01
QTY. 1

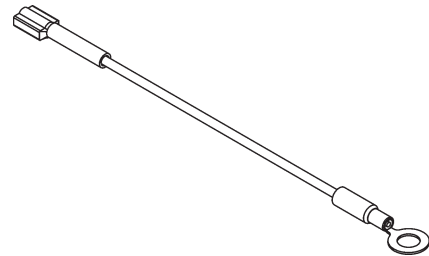

**WIRE ASSEMBLY
(BLACK WIRE)**
P/N 282518-01
QTY. 1

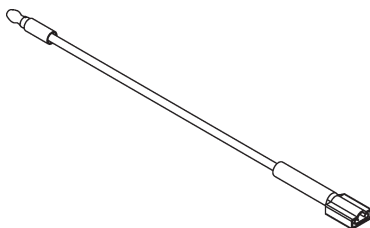

**WIRE ASSEMBLY
(BLUE WIRE)**
P/N 282516-01
QTY. 1



PLASTIC TIE
P/N 208153
QTY. 3



MALE BULLET
P/N 263345-01
QTY. 1

⚠ WARNING

To prevent personal injury and equipment damage, make sure power is disconnected from Liftgate while installing electrical parts.

1. Remove nut from positive (+) battery terminal connector. Disconnect the fused power cable (**FIG. 2-1**). Reinstall nut.

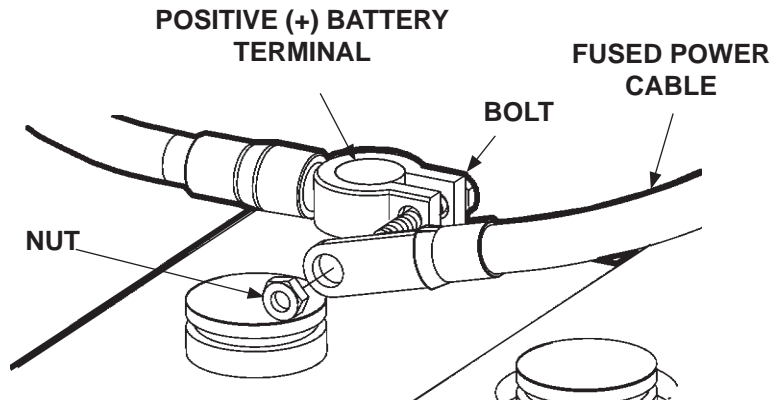

FIG. 2-1

2. Remove pump cover to gain access to pump assembly (**FIG. 2-2**).

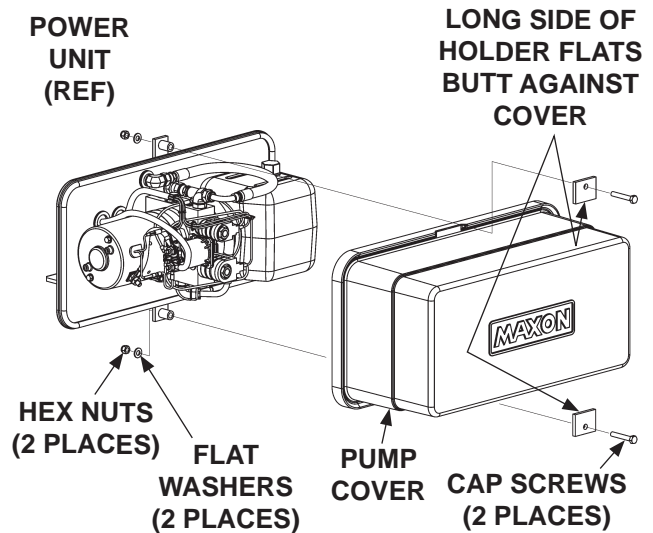
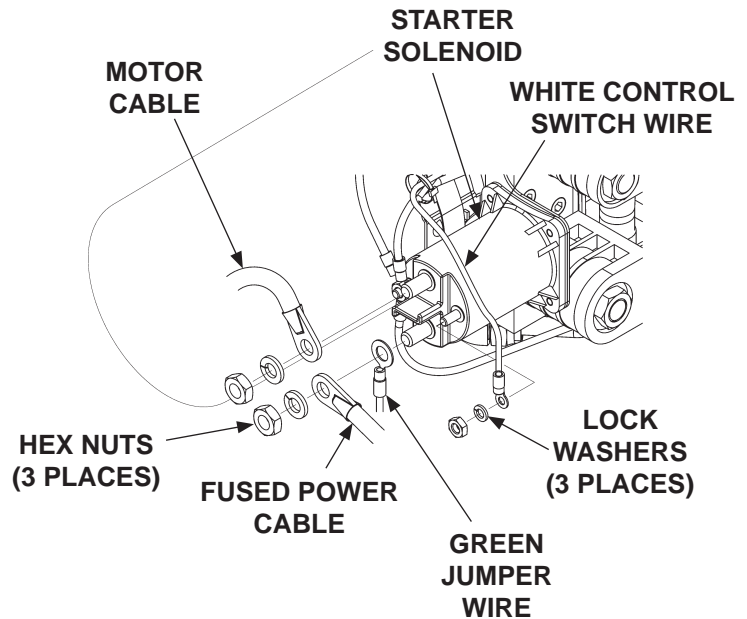

FIG. 2-2

NOTE: Refer to LVTS wiring diagram on sheet 9.

3. Remove 3 hex nuts and 3 lock washers from the starter solenoid (**FIG. 3-1**). Disconnect the green jumper wire, fused power cable, white control switch wire, and motor cable from starter solenoid as shown in **FIG. 3-1**.



DISCONNECTING WIRING FROM STARTER SOLENOID
FIG. 3-1

CAUTION

To prevent damage to motor and starter solenoid, torque the hex nuts on the electrical terminals to 40 lb-in.

4. Connect the 3 mounting tabs on the LVTS to the 3 “empty” terminal posts on the starter solenoid as shown in **FIG. 3-2**. Reconnect the jumper wire to starter solenoid. Then, reconnect the motor cable and the fused power cable to the correct terminals (**FIG. 3-2**). Reinstall the 3 hex nuts, 3 lock washers and torque to specifications.

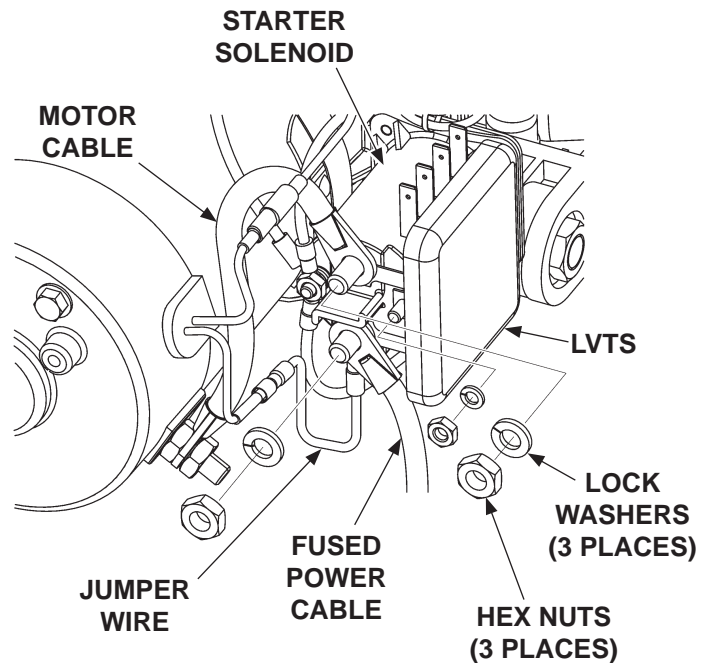

CONNECTING LVTS TO STARTER SOLENOID
FIG. 3-2

NOTE: For the pump to operate correctly, the LVTS must be connected to the wiring.

5. Disconnect the thermal switch wiring in 2 places (green control switch wire and green jumper wire) (**FIG. 4-1**).

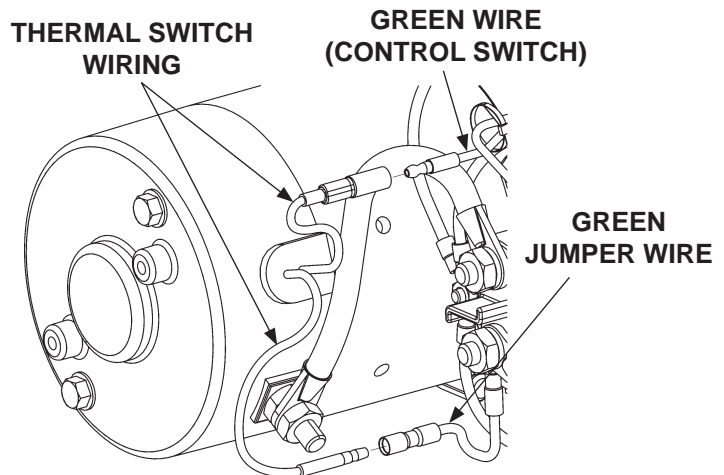

DISCONNECTING THERMAL SWITCH
FIG. 4-1

6. Cut the ring terminal off the white control switch wire (**FIG. 4-2**). Crimp male bullet (Kit item) to white wire as shown in **FIG. 4-3**.

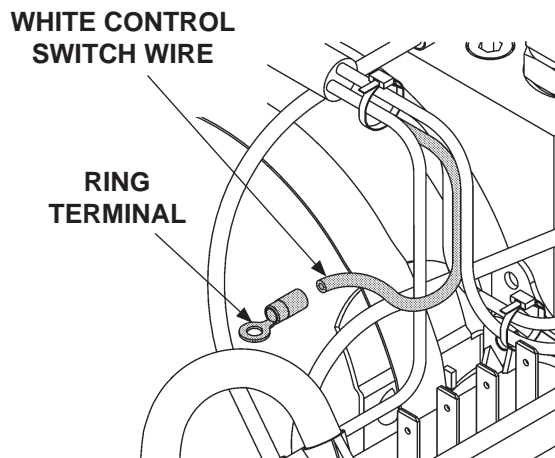

REMOVING RING TERMINAL
FIG. 4-2

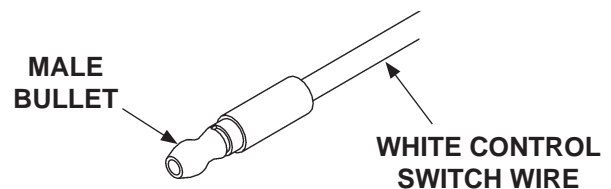

MALE BULLET CRIMPED TO WHITE WIRE
FIG. 4-3

7. Connect the green jumper wire to green control switch wire (FIG. 5-1).

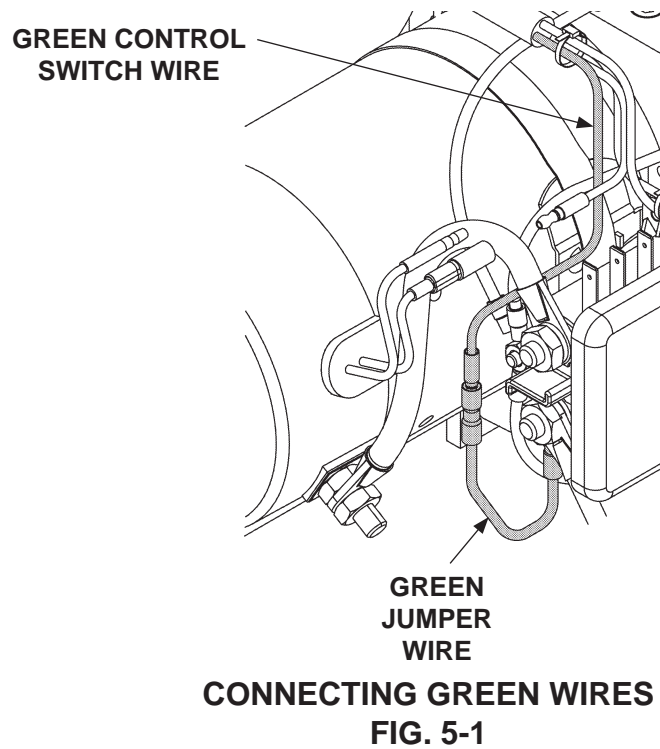

8. Connect blue wire assembly (Kit item) to LVTS "TD IN" spade terminal and the thermal switch wire with female bullet (FIG. 5-2).

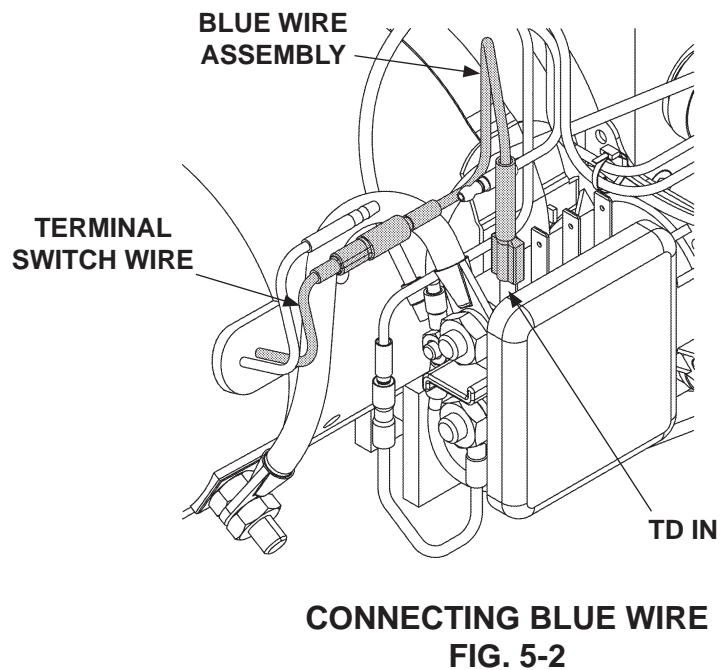

9. Connect dual (white) wire assembly (Kit item) to LVTS “**SW IN**” spade terminal and the thermal switch wire with male bullet (FIG. 6-1).

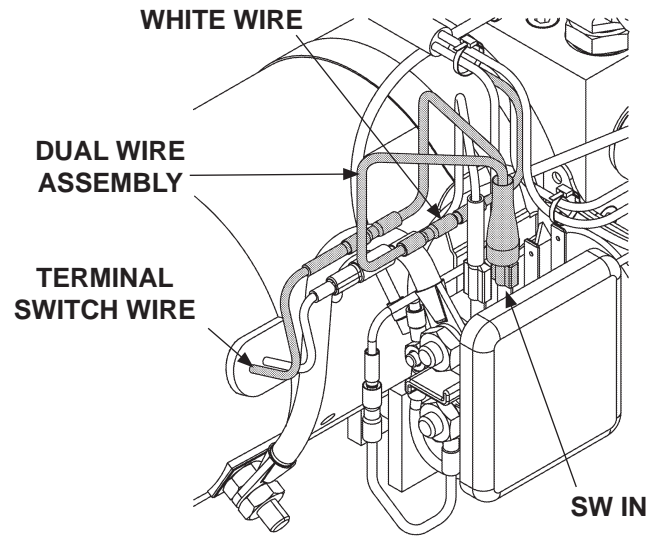

CONNECTING DUAL (WHITE) WIRE
FIG. 6-1

10. Connect black wire assembly (Kit item) to LVTS “**GRND**” spade terminal and the ground bolt on the pump (FIG. 6-2).

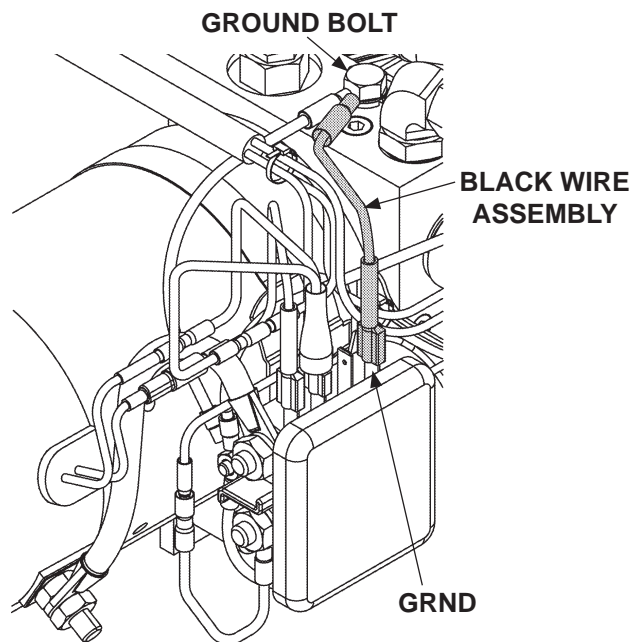

CONNECTING BLACK WIRE
FIG. 6-2

11. Check that wiring is correctly routed and connected. Secure wiring with the 3 plastic ties (Kit items) (**FIG. 7-1**).

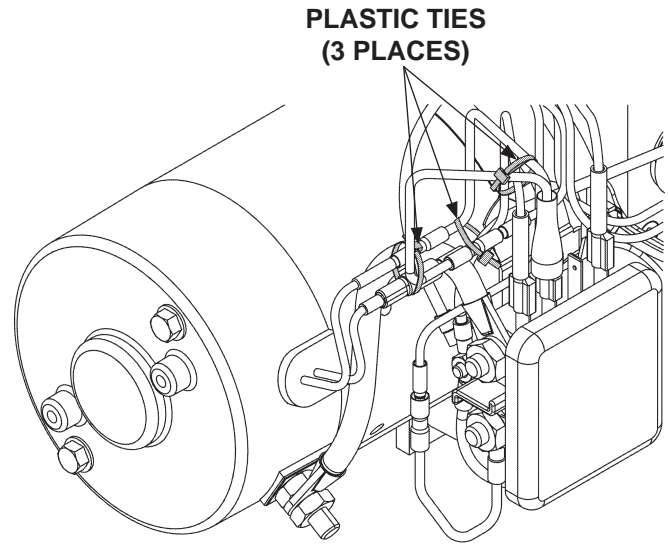

SECURING LVTS WIRING
FIG. 7-1

12. Attach LVTS instruction decal (Kit item) to pump cover (**FIG. 7-2**).

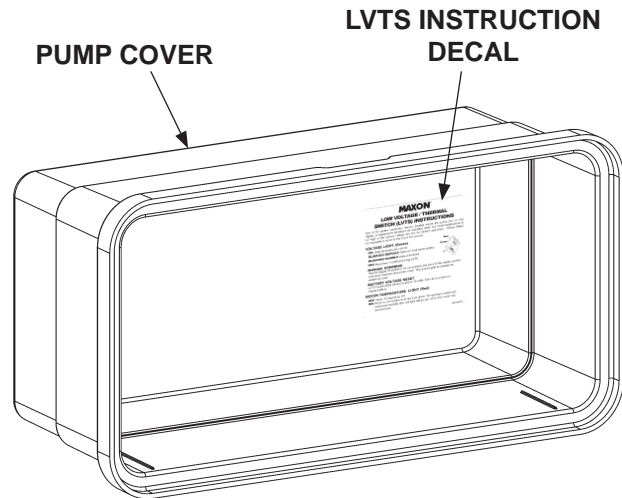

ATTACHING DECAL TO PUMP COVER
FIG. 7-2

13. Reinstall pump cover (FIG. 8-1).
Torque the 5/16"-18 cover bolts from
10 to 14 lb-ft.

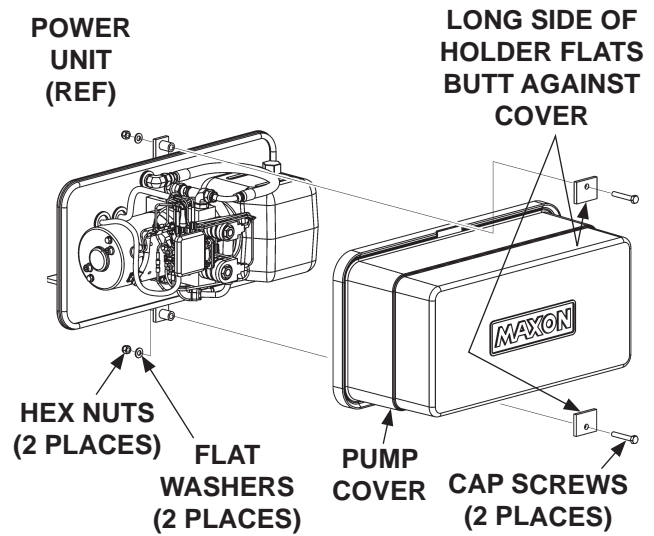

FIG. 8-1

14. Remove nut from positive (+)
battery terminal connector. Re-
connect the fused power cable
to positive (+) battery terminal
connector (FIG. 8-2). Reinstall
and tighten nut.

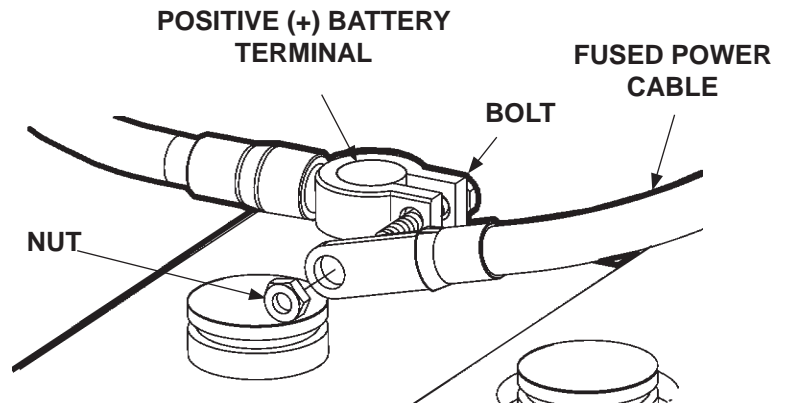
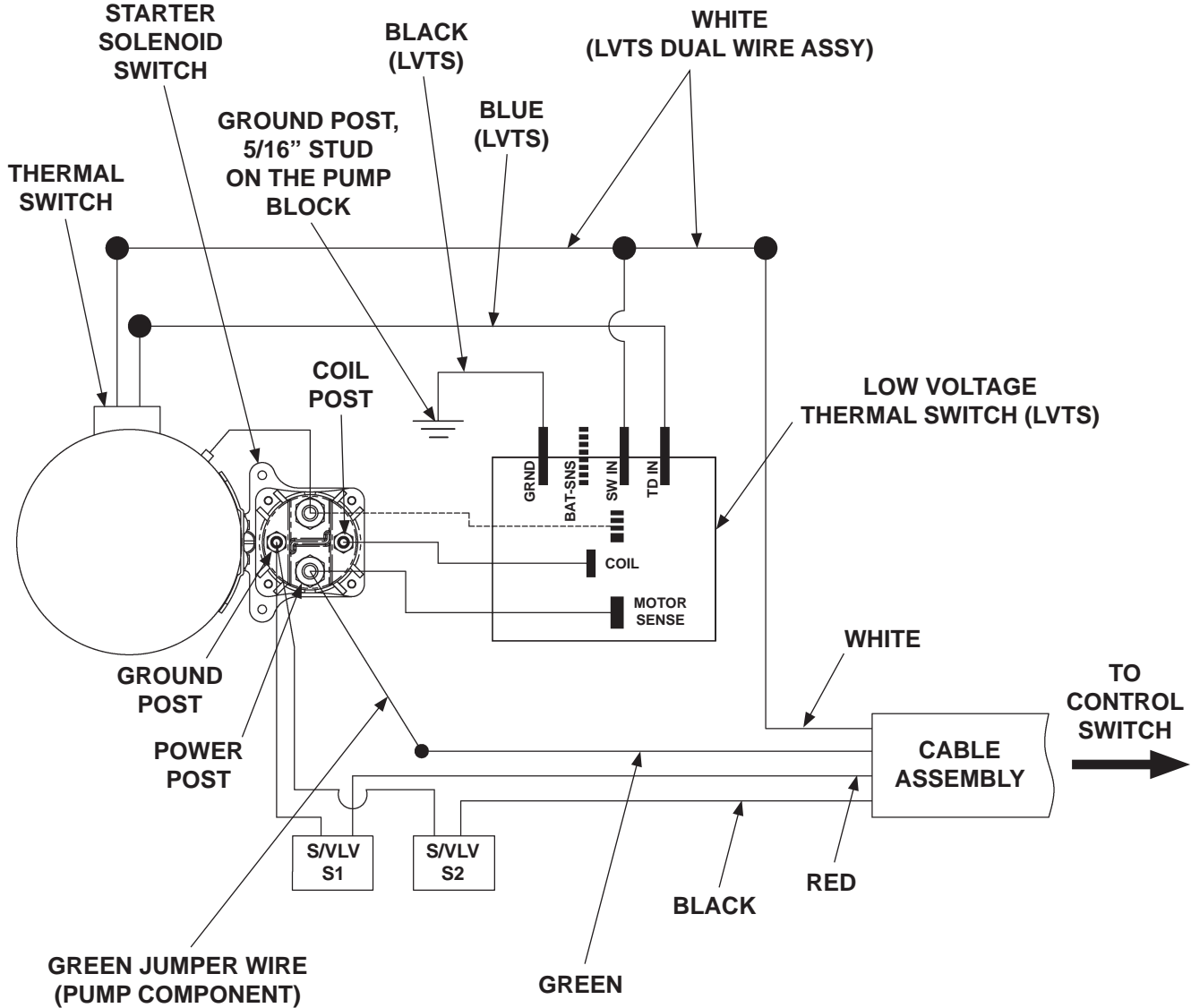

FIG. 8-2

15. Before operating Liftgate, do the
CHECKING HYDRAULIC FLUID
procedure in the Maintenance
Manual.



LVTS WIRING DIAGRAM
FIG. 9-1