

M-05-12
REV. E
JANUARY 2010

TE-25 TE-25L

OPERATION MANUAL

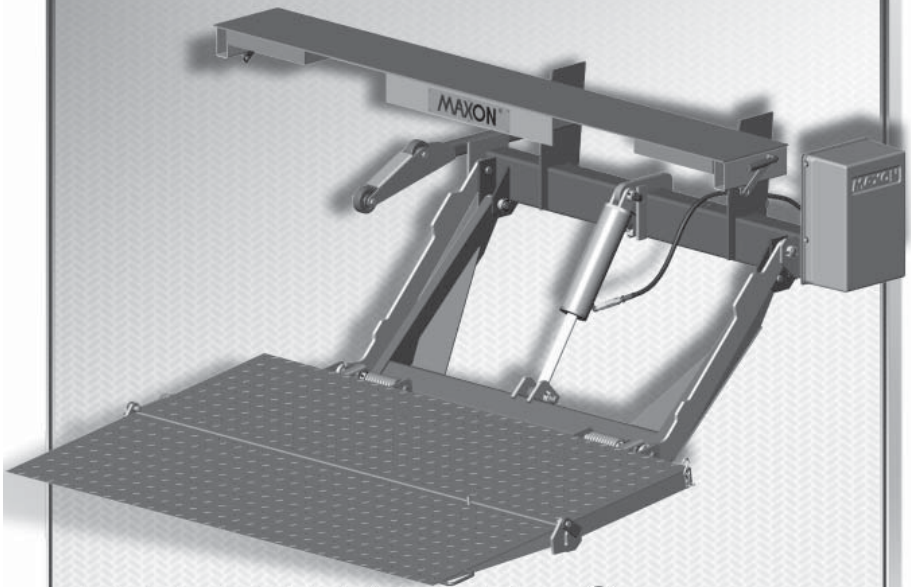

MAXON®

KEEP THIS MANUAL IN CAB OF VEHICLE

Register your liftgate on line at www.maxonlift.com/htm/services/reg.htm.

For a free copy of other manuals that pertain to this model liftgate, please visit our website at www.maxonlift.com or call Customer Service at (800) 227-4116.

© 2010 MAXON LIFT CORP.

TABLE OF CONTENTS

WARNINGS	4
LIFTGATE TERMINOLOGY	5
TE-25 & TE-25L.....	5
RECOMMENDED DAILY OPERATION CHECKS.....	6
DECALS	8
FORKLIFT ADVISORY	10
ROADSIDE OPERATION ADVISORY	11
OPERATION.....	12

WARNING

1. Incorrect operation of this Liftgate can result in serious personal injury. Comply with **WARNINGS** and Liftgate operating instructions in this manual. Do not allow untrained persons or children to operate the Liftgate. If you need to replace an **Operation Manual**, additional copies are available from:

MAXON Lift Corp.
11921 Slauson Ave
Santa Fe Springs, CA 90670
(800) 227-4116

NOTE: For latest version manuals (and replacements), download manuals from Maxon's website at **www.maxonlift.com**.

2. Do not exceed rated load capacity of the Liftgate, which is **2500 lbs. (2000 lbs. for special Liftgates)**.
3. Do not allow any part of your body to be placed under, within, or around any portion of the moving Liftgate or its mechanisms, or in a position that would trap them between the platform and the floor of truck body (or between platform and the ground) when Liftgate is operating.
4. Consider the safety and location of bystanders and location of nearby objects when operating the Liftgate. Stand to one side of platform while operating the Liftgate. Be certain that the area the Liftgate will move through during operation is clear of all obstacles.
5. Comply with all attached instruction decals and warning decals.
6. Keep decals clean and legible. If decals are illegible or missing, have them replaced. **Get free replacement decals from Maxon.**
7. **Never drive a forklift on the Liftgate platform.**
8. Do not move vehicle unless Liftgate is correctly stowed.
9. **Correctly stow platform when not in use. Extended platforms can create a hazard for people and vehicles passing by.**
10. A correctly installed Liftgate will operate smoothly and reasonably quiet. The only noticeable noise, during Liftgate operation, is from the power unit while the platform is raised. Listen for scraping, grating and binding noises and have the problem corrected before continuing to operate the Liftgate.
11. Above all, **USE GOOD COMMON SENSE** when operating this Liftgate.
12. Never use a cell phone while operating the Liftgate.

LIFTGATE TERMINOLOGY

TE-25 & TE-25L

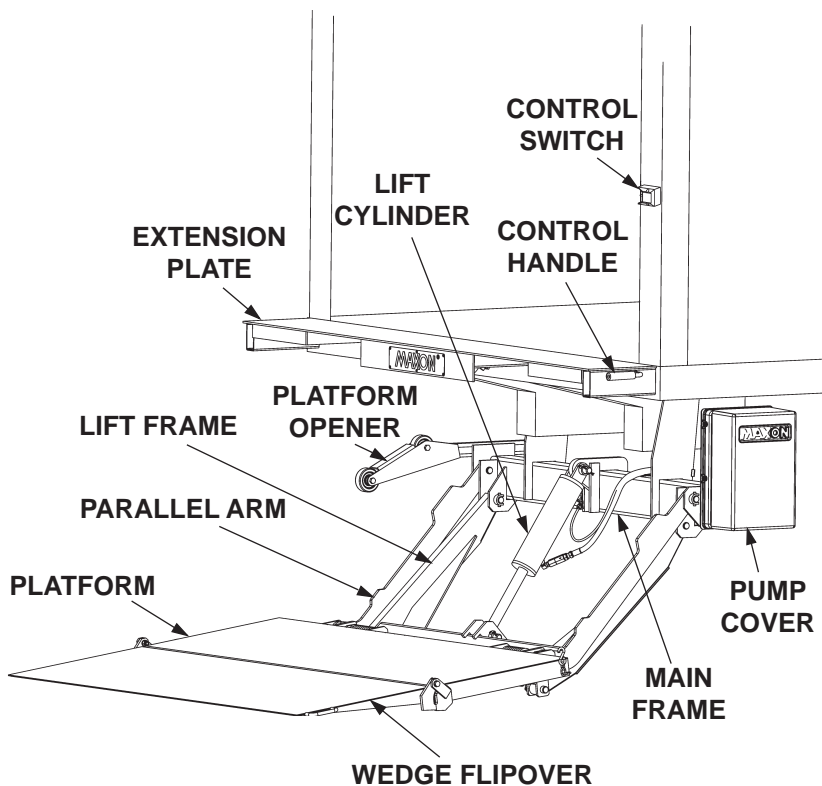

RECOMMENDED DAILY OPERATION CHECKS

NOTE: Before you check the Liftgate, park vehicle on flat ground and set the parking brake.

NOTE: If any of the following operation checks reveal a need to service or repair Liftgate, do not operate the Liftgate until a qualified mechanic services or repairs the Liftgate.

Before operating the Liftgate, the operator should do the following:

- Make sure battery is fully charged and battery terminal connections are clean and tight.
- Make sure cab cutoff switch is **ON**, if equipped.
- Visually check that pump cover is bolted on securely and undamaged. Look for hydraulic fluid leaking from the pump box.
- Visually check that control switch is in place and undamaged.
- Visually check for cracks and bends on the extension plate. Also, make sure fasteners are in place and undamaged and extension plate is clean (no oil, debris, or corrosion).
- Visually check that all decals are in place (see **DECALS** page). Make sure decals are legible, clean, and undamaged.

Use the operation instructions in this manual to lower the Liftgate to the ground and open the platform and flipover.

- Check main frame, lift arms, parallel arms and platform openers for cracks and bends. Make sure rollers, on the platform openers, roll freely. Also, make sure all bolts and pins are in place and undamaged.
- Make sure main frame, lift arms, parallel arms and platform openers are clean (no oil, debris, or corrosion).
- Check the hydraulic cylinders for leaking seals and hose connections. Follow the hydraulic hoses (or return lines for gravity down Liftgates) from the cylinders to pump box. Make sure all hoses are connected at both ends and there are no cracks, chafing, and fluid leaks.

- With the platform unfolded and on the ground, check if the shackles and the tip of platform touch the ground at the same time (**YES illustration**). If the platform looks like the **YES illustration**, you can operate Liftgate. If the shackles are off the ground and platform looks like the **NO illustration**, do not operate the Liftgate. (See **NOTE** at beginning of the **DAILY OPERATION CHECKS**.)

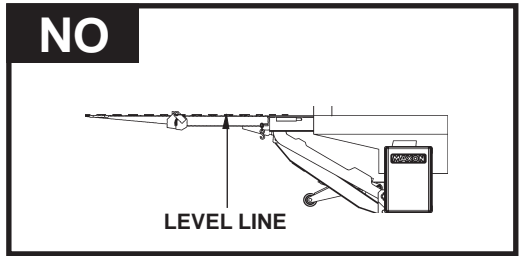
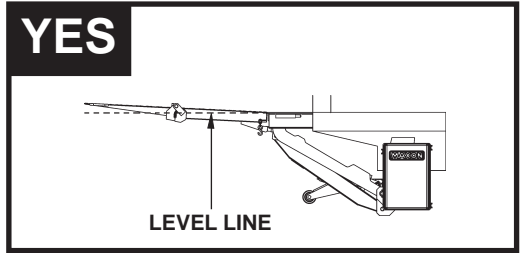

- Check the platform and flipover for cracks, holes, and bends on the load-carrying surface and side plates. Also, make sure torsion bars, coil springs and fasteners are in place and undamaged.
- Make sure platform and flipover load-carrying surfaces are clean (no oil, debris, or corrosion).

Use the operation instructions in this manual to operate the Liftgate through one cycle without a load on the platform. RAISE the platform to vehicle bed height. Lower the platform to ground level.

- When the Liftgate is moving, listen for unusual noises and look for jerking motion or uneven movement on either side of the platform.

If service or repairs are not required (or if completed), stow the Liftgate.

DECALS

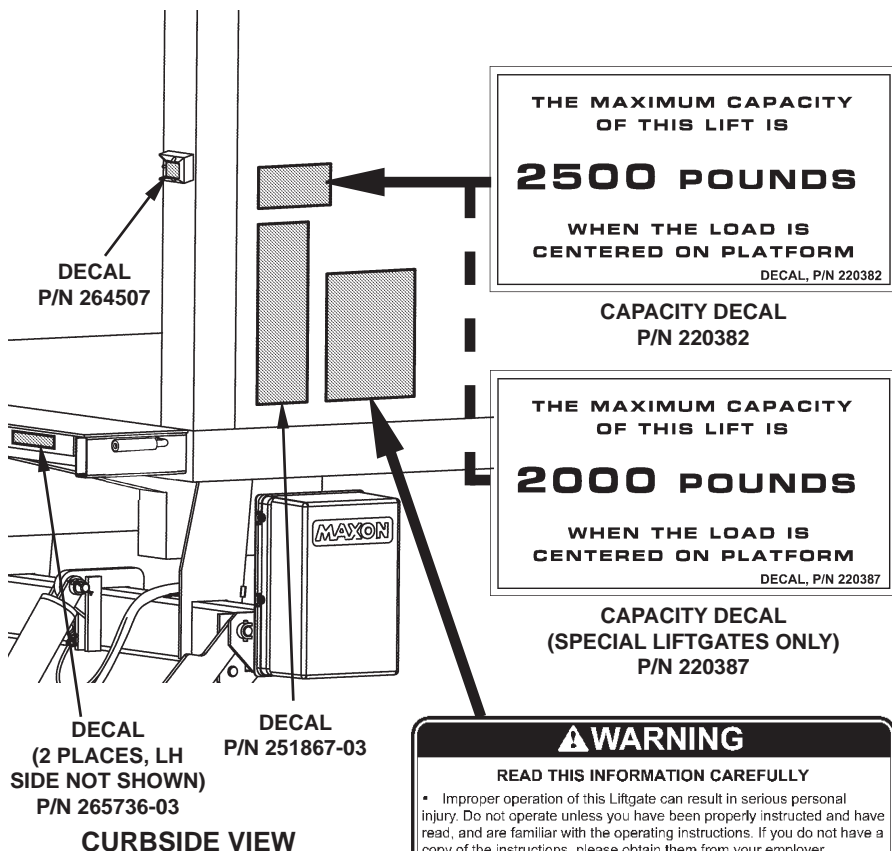

**WARNING DECAL
P/N 264081**



WARNING DECAL
P/N 265736-03

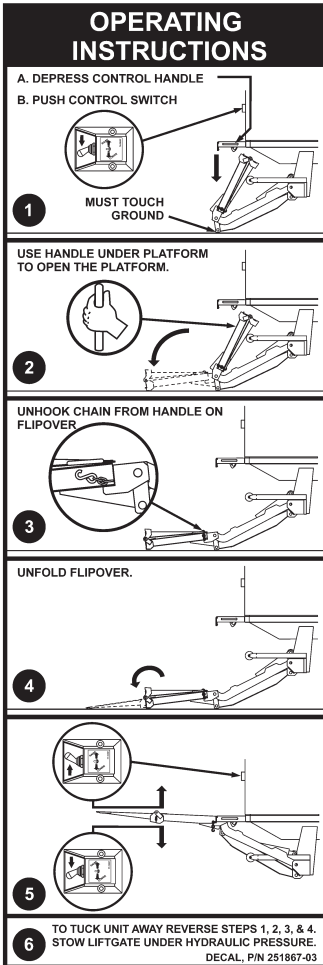

INSTRUCTION DECAL
P/N 251867-03

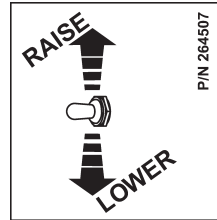

RAISE/LOWER DECAL
P/N 264507

FORKLIFT ADVISORY

⚠ WARNING
Keep forklift OFF of platform.

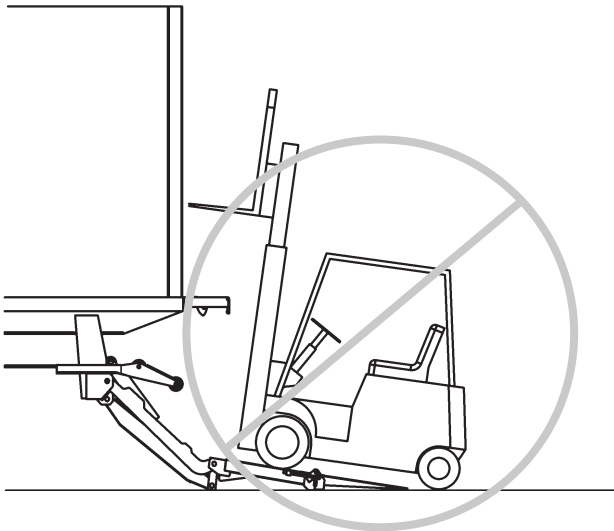
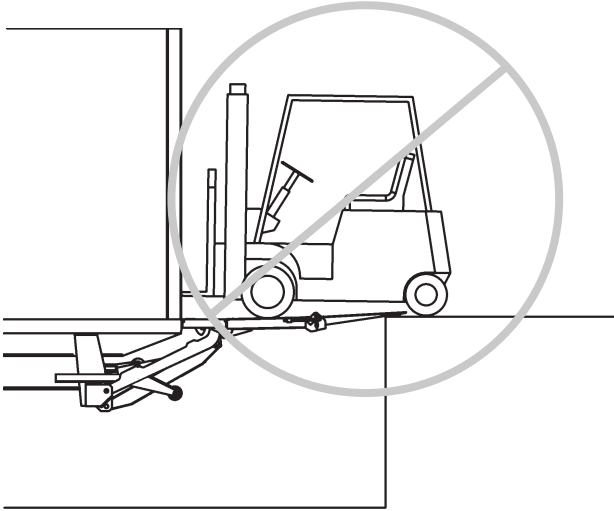

FIG. 10-1

ROADSIDE OPERATION ADVISORY

WARNING

Operating the Liftgate by the side of a busy road with vehicle traffic increases the chance of personal injury and damage to Liftgate, cargo & vehicle. Making the loading area more visible to passing traffic can help reduce the chance of injury and damage.

NOTE: MAXON recommends placing at least 2 traffic cones on the traffic side of the platform loading area as illustrated below. Remove cones after platform is stowed and before moving the vehicle.

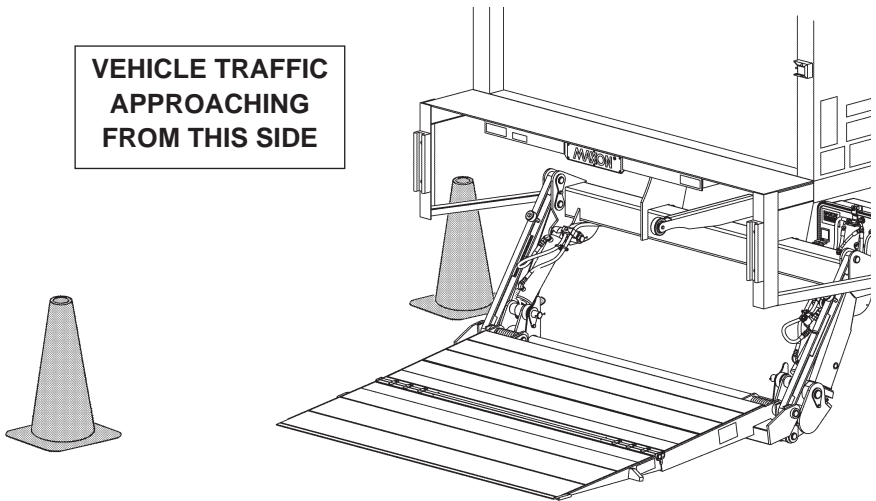

**TRAFFIC CONES POSITIONED BY PLATFORM LOADING AREA
(GPT LIFTGATE SHOWN)**

FIG. 11-1

OPERATION

CAUTION

Before lowering Liftgate, make sure chain (FIG. 12-1A) is secured to platform and hooked to handle on the flipover.

1. Standing to the side of platform (FIG. 12-1A), push down control handle (FIG.12-1B) and push the toggle switch to **LOWER** position as shown in FIG. 12-1C. Release control handle after platform is lowered about 2 inches.

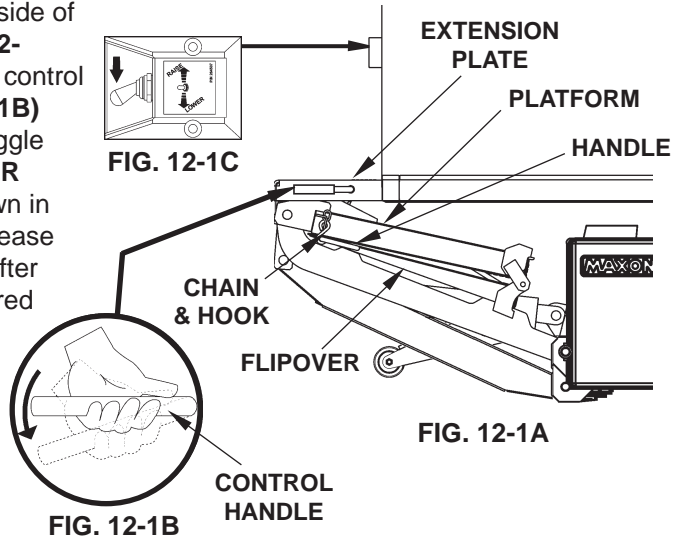

WARNING

Never operate control switch while unfolding (and folding) platform and flipover. Always use handle on side of flipover to unfold (and fold) flipover. Holding the flipover any other way can create a hazard and injure operator.

2. Lower the platform (FIG. 12-2A) until it touches the ground. Use handle (FIG. 12-2B) to unfold the platform (FIG. 12-3).

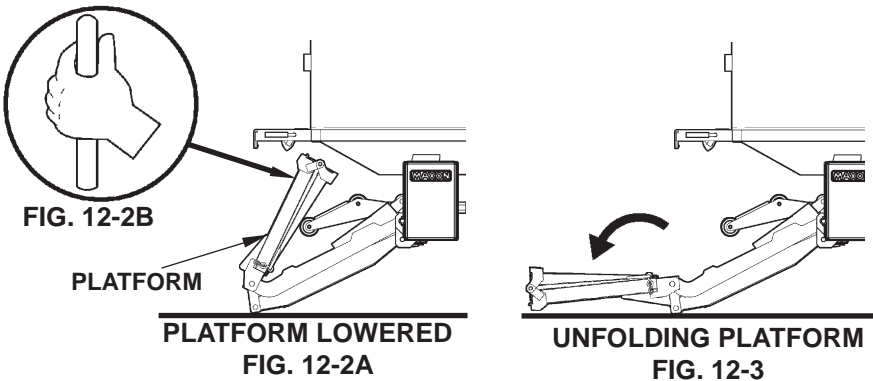

3. Unhook chain from handle on the flipover (FIG. 13-1B). Use handle (FIG. 13-1C) to unfold the flipover (FIG. 13-1A).

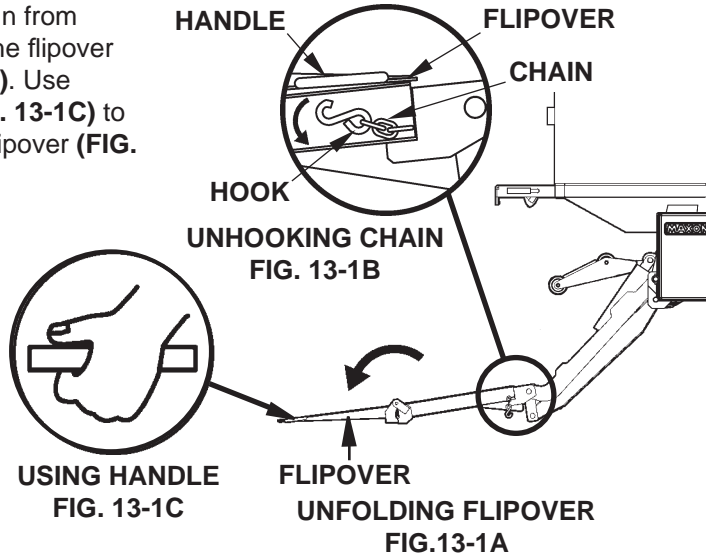

NOTE: While operating the Liftgate, release toggle switch to stop the platform.

4. Raise the platform (FIG. 13-2A) by pushing the toggle switch to the **RAISE** position (FIG. 13-2B). After the platform reaches bed height, wait a second before releasing the toggle switch. To lower the platform, push the toggle switch to the **LOWER** position (FIG. 13-2C).

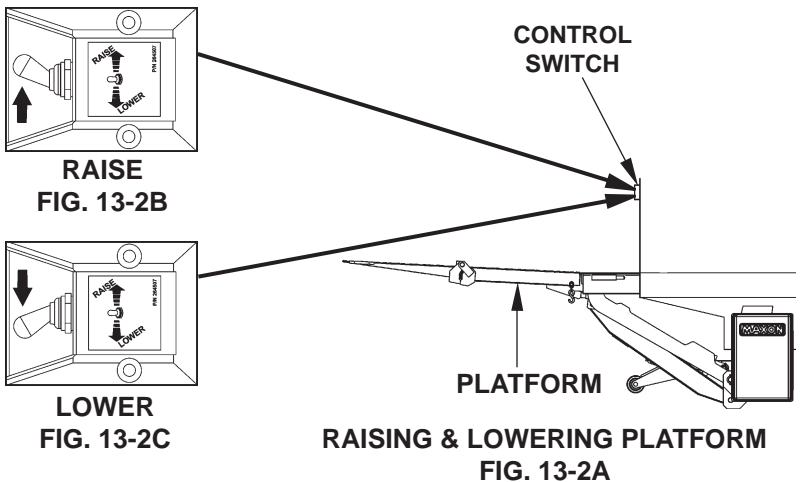

OPERATION - Continued

WARNING

A load should never extend past the edges of the platform. Do not place unstable loads on platform and do not allow load to exceed the lifting capacity of the Liftgate. If standing on platform, do not allow your feet to extend beyond the inboard edge of the platform.

5. Load the platform at ground level as shown in **FIG. 14-1**.

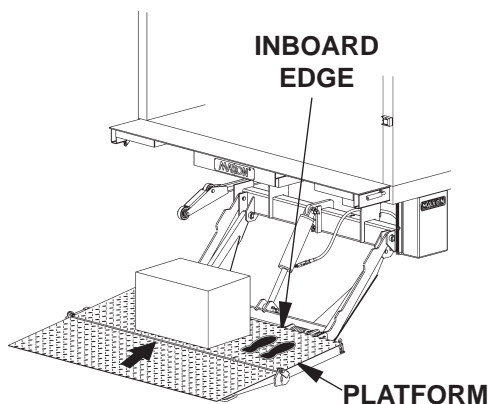

LOADING PLATFORM AT GROUND LEVEL

FIG. 14-1

6. Raise the platform to bed level. Move the load into vehicle.

WARNING

Pulling the load from vehicle to platform can result in a fall from platform and serious injury. When unloading vehicle, always push the load out on the platform.

7. Load the platform at bed level (**FIG. 14-2**) as follows. Push load out of the vehicle to correct position on the platform. Place all loads as close as possible to the inboard edge of the platform with heaviest part toward the truck body as shown in **FIG. 14-2**. If standing on platform with the load, stand in the footprint area shown and comply with the **WARNING** at top of this page.

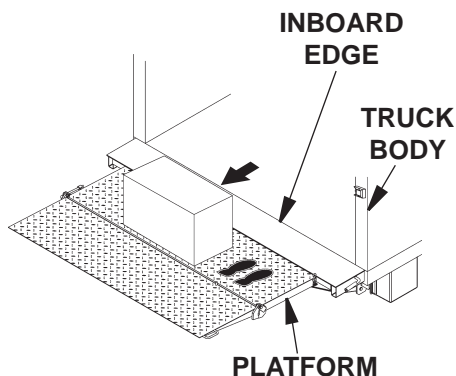

LOADING PLATFORM AT BED LEVEL

FIG. 14-2

- Lower the platform to ground level (**FIG. 15-1**). Move load off the platform.

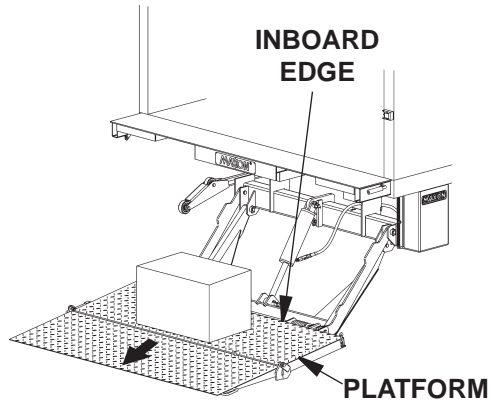

PLATFORM AT GROUND LEVEL
FIG. 15-1

⚠ WARNING
Never move the vehicle unless the Liftgate is properly stowed.

- Before moving the vehicle, prepare the Liftgate as follows. Make sure load is removed from platform. If the platform is at bed level, push the toggle switch to the **LOWER** position as shown in **FIG. 15-2B**. Release toggle switch when platform touches the ground (**FIG. 15-2A**).

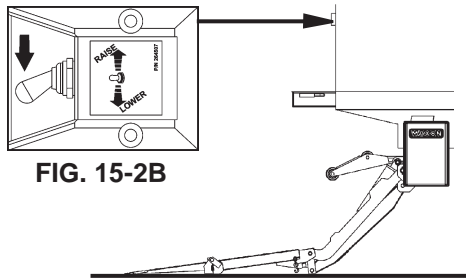

FIG. 15-2B

LIFTGATE LOWERED TO THE GROUND
FIG. 15-2A

- Stow the Liftgate by doing the following. **RAISE** the platform about 2" above the ground (**FIG. 15-3A**) by pushing the toggle switch to the **RAISE** position (**FIG. 15-3B**).

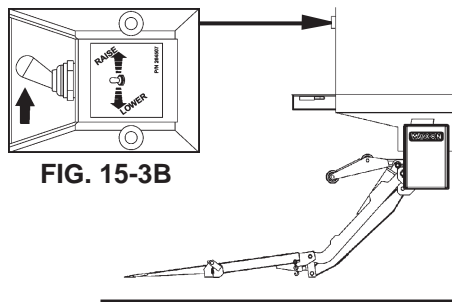
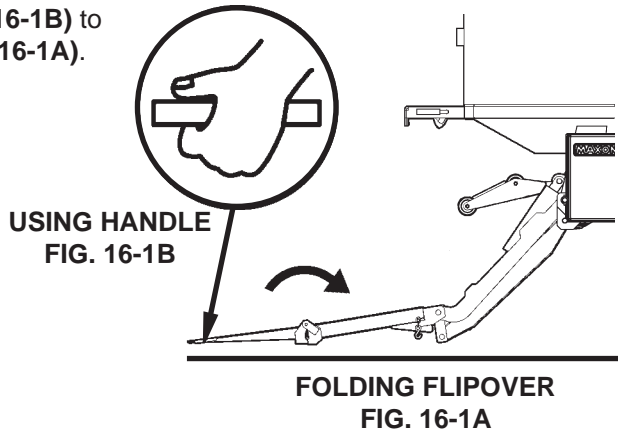

FIG. 15-3B

FIG. 15-3A

OPERATION - Continued

11. Use handle (FIG. 16-1B) to fold flipover (FIG. 16-1A).



WARNING

Keep hands clear of the extension plate when folding the platform under the extension plate.

12. Fold the flipover (FIG. 16-2A). Hook the chain on the handle (FIG. 16-2B) to lock the flipover in position.

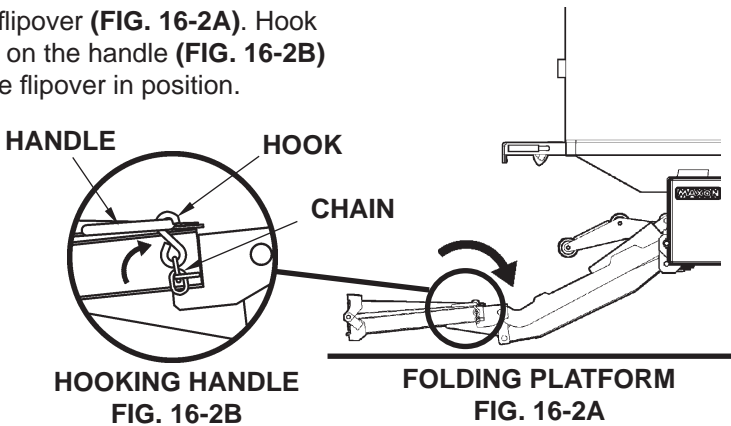

CAUTION

Before raising Liftgate, make sure chain is secured to platform and hooked to handle on the flipover.

13. Fold the platform against opener (FIG. 17-1).

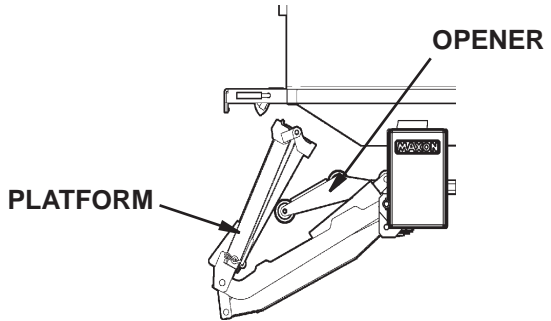

FOLDING PLATFORM AGAINST FLIPOVER
FIG. 17-1

CAUTION

Stow Liftgate under hydraulic pressure.

14. Raise the Liftgate to stowed position (FIG. 17-2A) by pushing the toggle switch to the **RAISE** position (FIG. 17-2B). Wait a second before releasing toggle switch after Liftgate is raised all the way (FIG. 17-2A).

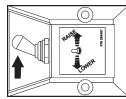
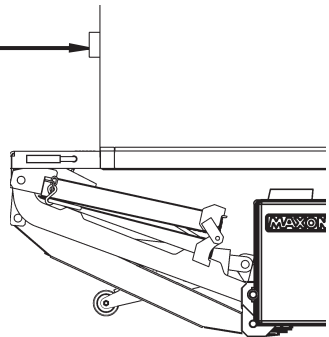

FIG. 17-2B



CORRECTLY STOWED LIFTGATE
FIG. 17-2A

15. Liftgate is ready for transport.

