

Columnlift®

BMR-A & BMRSD Series Flashing Platform Lights

MAXON®

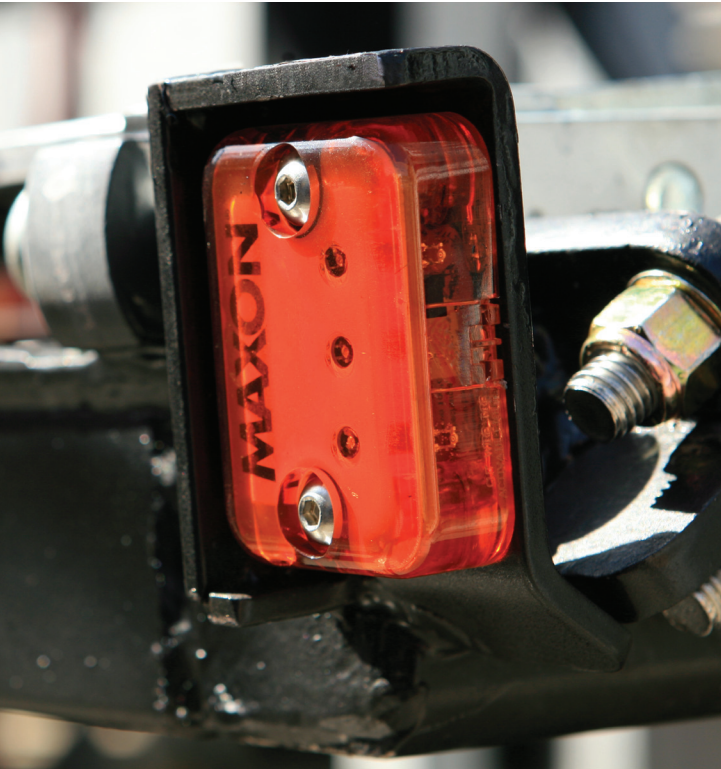

Standard Flashing Platform Lights

Maxon **BMRA** and **BMRSD** Columnlifts now come standard with flashing lights that are attached to the corners of the platform. These lights are self-contained (battery powered) and switch on when the platform is horizontal and switch off when the platform is stowed.

These lights are also available as kits to retrofit older units.

Note that in order to activate the lights initially, a link wire (see picture) needs to be cut.

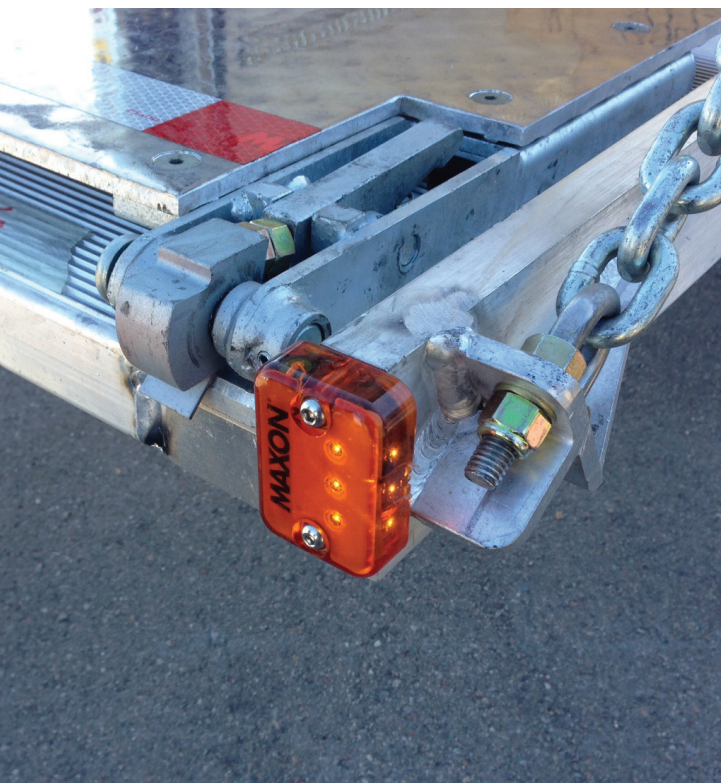

*Excludes the gas bottle "CS" models which will follow at a later date



Maxon Lift Corp. 11921 Slauson Ave., Santa Fe Springs, CA 90670
800.227.4116 Fax 888.771.7713, www.maxonlift.com

Columnlift®

BMR-A & BMRSD Series Flashing Platform Lights

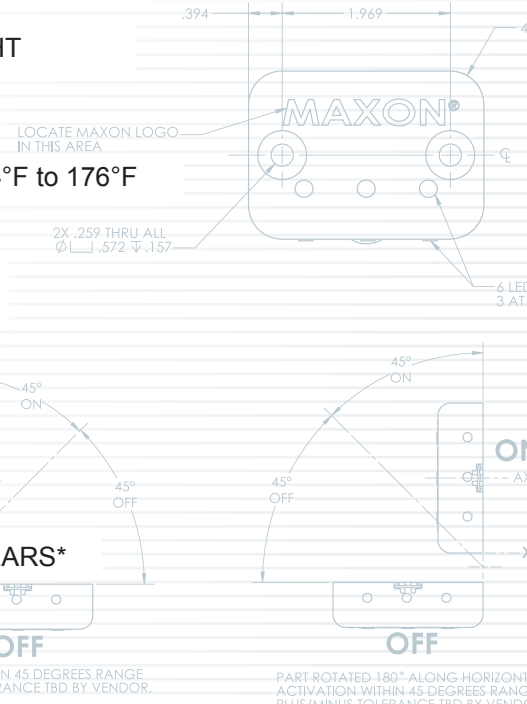
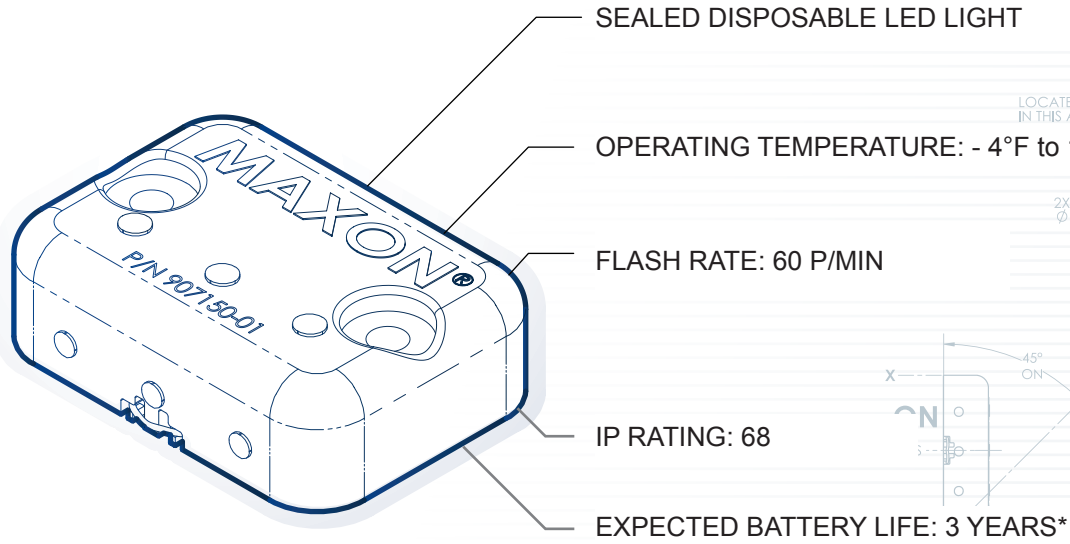

* Assumptions: average 90 minutes continuous flashing / day

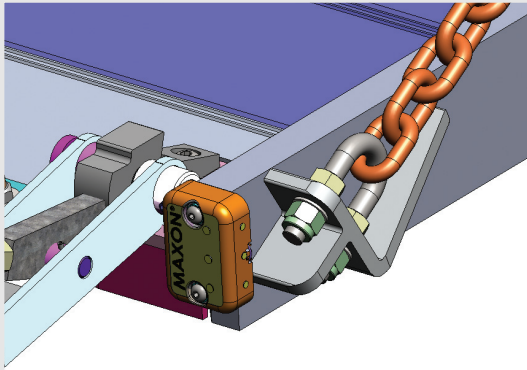

ALUMINUM PLATFORM WITH ALUMINUM RETENTION RAMP

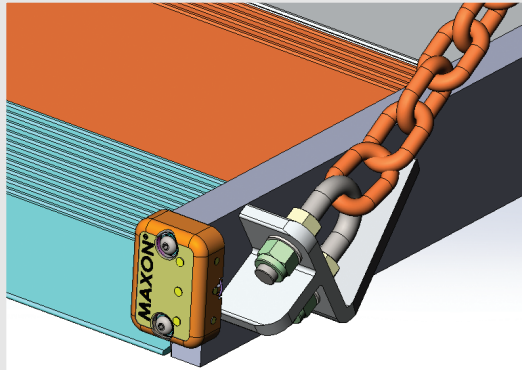

ALUMINUM PLATFORM WITH FIXED RAMP

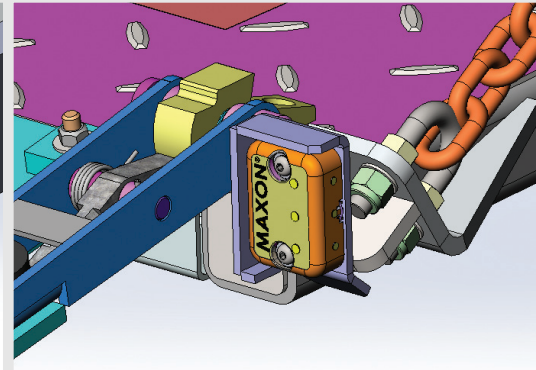

STEEL PLATFORM WITH ALUMINUM RETENTION RAMP

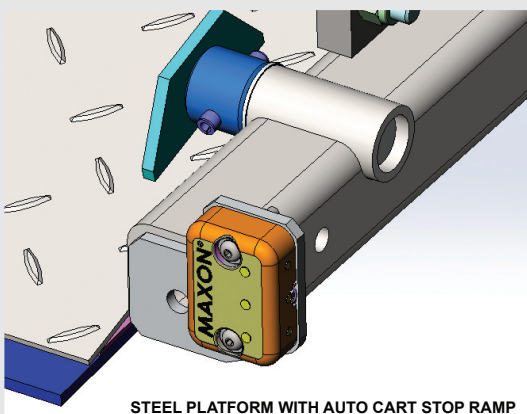

STEEL PLATFORM WITH AUTO CART STOP RAMP

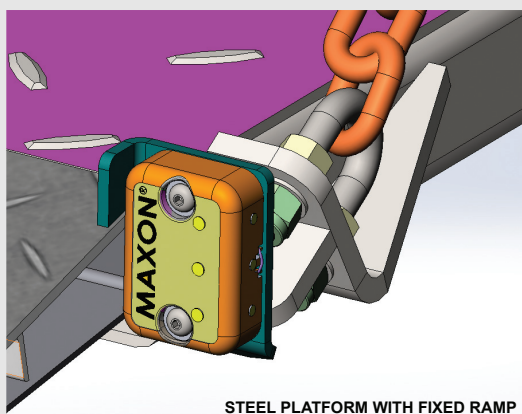

STEEL PLATFORM WITH FIXED RAMP

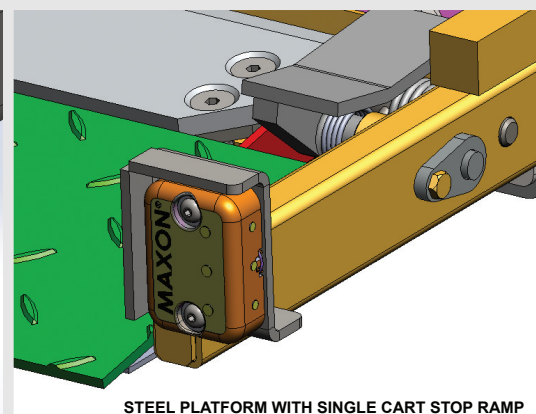

STEEL PLATFORM WITH SINGLE CART STOP RAMP

M-204-1113



Maxon Lift Corp. 11921 Slauson Ave., Santa Fe Springs, CA 90670
 800.227.4116 Fax 888.771.7713, www.maxonlift.com