

**INSTRUCTION, MTB 102" EXTENTION  
INSTALLATION KIT  
P/N 266113**

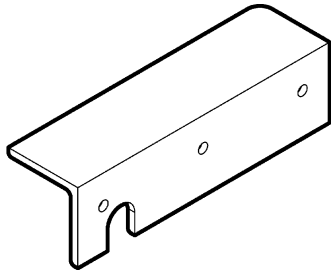

**RIGHT HAND ANGLE  
3" x 3" x 11" x 1/4"  
QTY - 1  
P/N 266115-01**

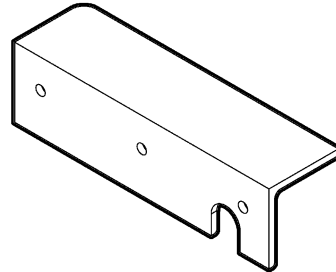

**LEFT HAND ANGLE  
3" x 3" x 11" x 1/4"  
QTY - 1  
P/N 266114-01**

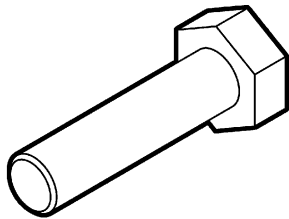

**HEX HEAD BOLT  
3/8"-16 x 1-1/4, GRADE 8  
QTY - 6  
P/N 900014-5**

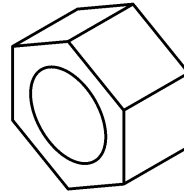

**HEX NUT  
3/8"-16  
QTY - 6  
P/N 901011-5**

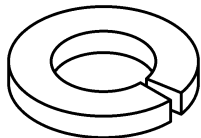

**LOCK WASHER, 3/8"  
QTY - 6  
P/N 902011-4**

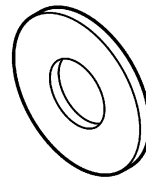

**FLAT WASHER, 3/8"  
QTY - 12  
P/N 902001-2**

1. Lower platform to the ground. Measure, mark and drill three holes on the Right Hand (RH) Side Plate as shown in **FIG. 1**.

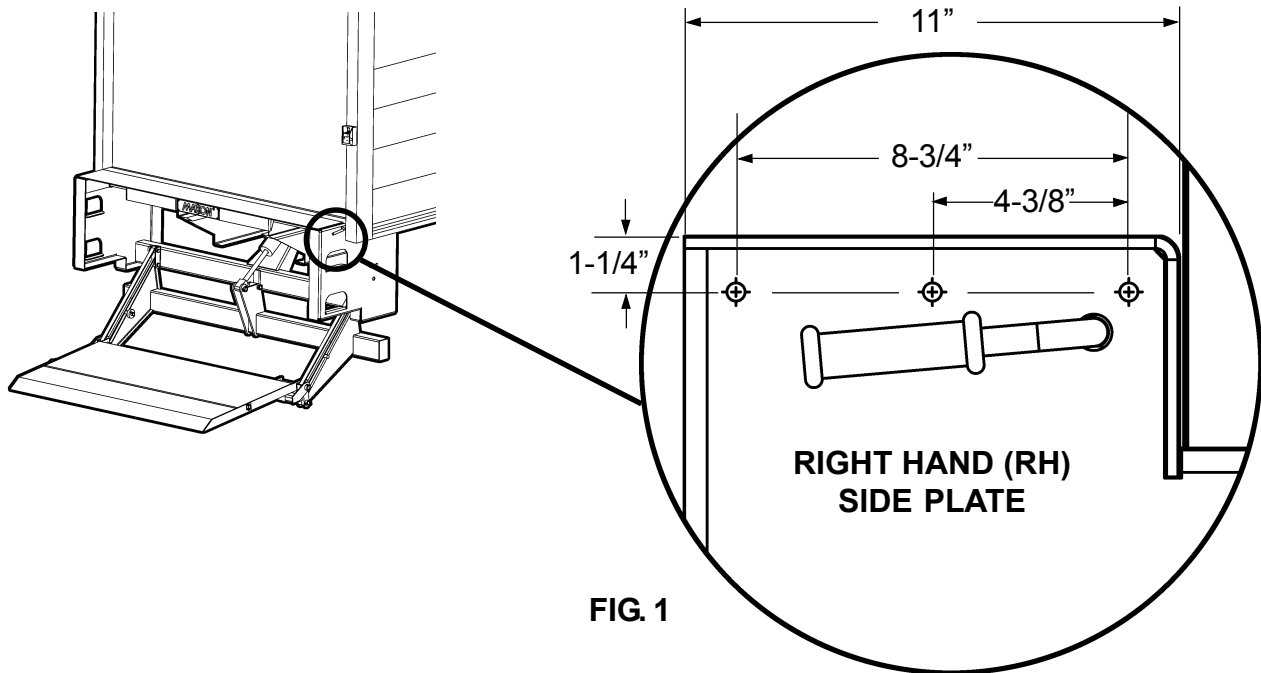

2. Line up the 3 holes in the RH Angle with the 3 holes in RH Side Plate as shown in **FIG. 2**. Bolt the RH Angle on the RH Side Plate with bolts, nuts, lock washers, and flat washers from the Kit. (**FIG. 2**).

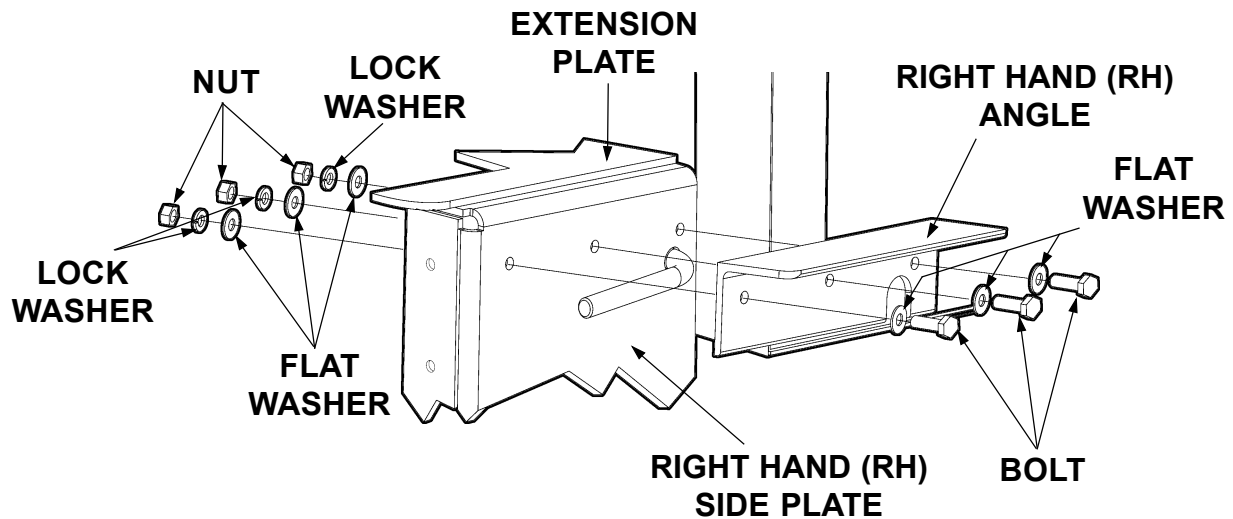

3. Measure, mark and drill three holes on the Left Hand (LH) Side Plate as shown in FIG. 3.

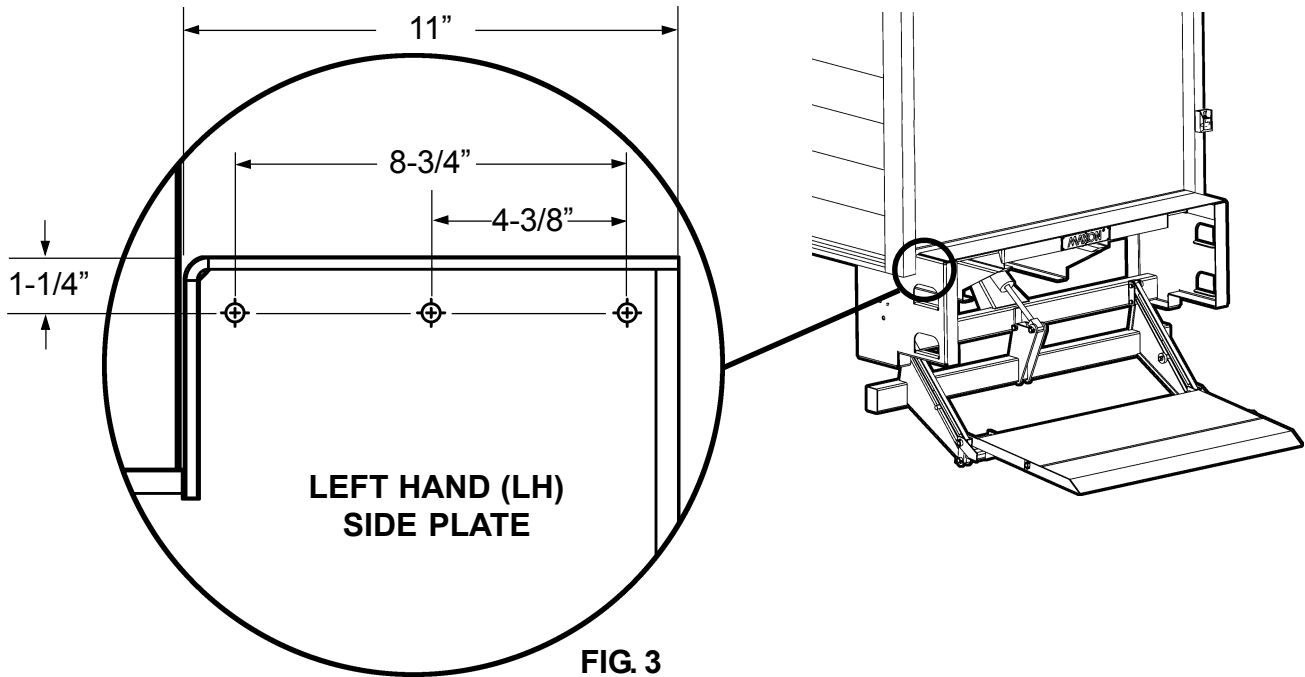

4. Line up the 3 holes in the LH Angle with the 3 holes in LH Side Plate as shown in FIG. 4. Bolt the LH Angle on the LH Side Plate with bolts, nuts, lock washers, and flat washers from the Kit. (FIG. 4).

