

INSTRUCTION, GPTLR HAND PUMP INSTALLATION, GD P/N 281295-01

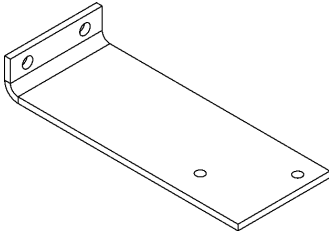

HAND PUMP BRACKET
P/N 281286-01
QTY. 1

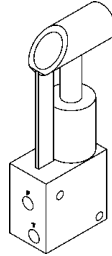

HAND PUMP, SAE #4 PORTS
P/N 266588-01
QTY. 1

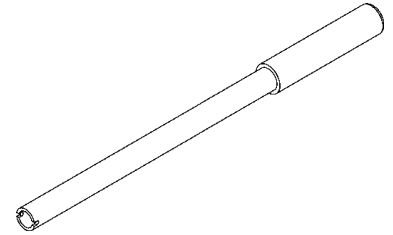

HAND PUMP HANDLE
P/N 251407-02
QTY. 1



SPRING CLIP HOLDER
P/N 227681
QTY. 2



POP RIVET 3/16" X 13/32" LG.
P/N 207644
QTY. 2



HOSE CLAMP, SCREW-TYPE
P/N 251854
QTY. 2

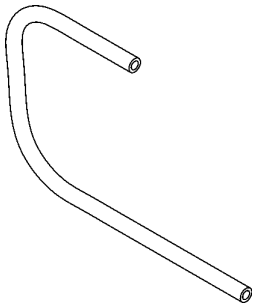

HOSE 3/8" LP, 25" LG.
P/N 251855-06
QTY. 1

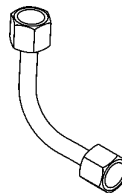

TUBE ASSEMBLY
P/N 281284-01
QTY. 1

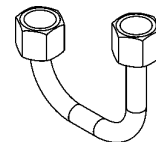

TUBE ASSEMBLY (GRAVITY DOWN)
P/N 281287-01
QTY. 1



**POPPET VALVE,
FREE REVERSED FLOW**
P/N 906768-01
QTY. 1

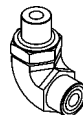

**ELBOW
(9/16"-18 O.R. MALE TO
11/16"-16 F.S. MALE)**
P/N 906707-01
QTY. 2

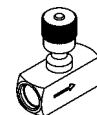

**NEEDLE VALVE ADJUSTER
(9/16"-18 PORTS)**
P/N 906739-01
QTY. 1

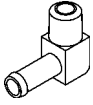

ELBOW
(1/4" MALE-3/8" TUBE)
P/N 251853
QTY. 2



TEE, O-RING
(11/16"-16 SWIVEL,
11/16"-16 F.S. MALE)
P/N 906750-01
QTY. 1



CONNECTOR
(11/16"-16 MALE TO
7/16"-20 O.R. MALE)
P/N 906759-01
QTY. 1



SWIVEL
(11/16"-16, 9/16"-18 O.R. MALE)
P/N 906751-01
QTY. 1



ADAPTER
(9/16"-18 MALE - 1/4" FEMALE)
P/N 228012
QTY. 1



ADAPTER
(7/16"-20 O.R. MALE
TO 1/4" NPT FEMALE)
P/N 906756-01
QTY. 1



HEX BOLT, 1/4"-20 X 2-1/4" LG.,
GRADE 8
P/N 900000-9
QTY. 2

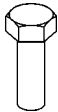

CAP SCREW, 5/16"-18 X 1" LG.,
GRADE 8
P/N 900009-2
QTY. 2



LOCK NUT, 5/16"-18
P/N 901001
QTY. 2



LOCK NUT, 1/4"-20
P/N 901000
QTY. 2



FLAT WASHER, 1/4", 9/16" WIDE
P/N 902007-1
QTY. 2



FLAT WASHER, 5/16"
P/N 902000-8
QTY. 4



FLAT WASHER, 1/4", 7/8" WIDE
P/N 902000-1
QTY. 2

1. Position the Platform to gain access to hydraulic cylinders and hoses as follows. Lower the Platform to a comfortable work height (**FIG. 3-1**). Use floor jack & jack stands under the Underride to support the Lift.

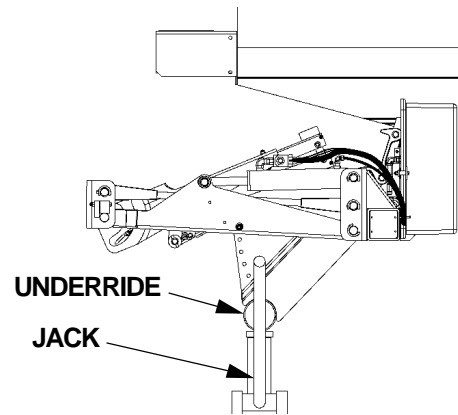

**SUPPORTING LIFT AT WORK HEIGHT
(RH SIDE SHOWN)
FIG. 3-1**

⚠ WARNING

To prevent accidental personal injury and equipment damage, make sure power is disconnected from Liftgate while installing parts.

2. Disconnect power from Liftgate by removing nut from positive (+) battery terminal connector and disconnect Power Cable (**FIG. 3-2**). Reinstall nut on positive (+) battery terminal connector.

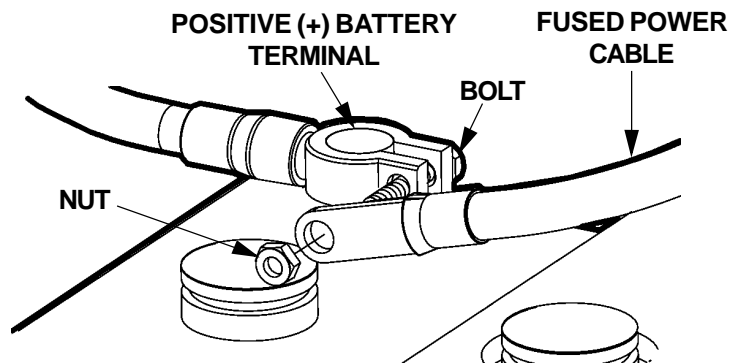

**DISCONNECTING BATTERY
FIG. 3-2**

3. Unbolt the Pump Cover as shown in **FIG. 3-3**.

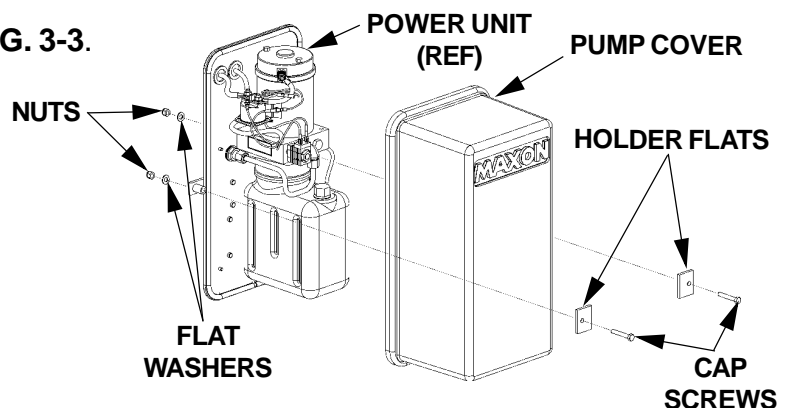

**REMOVING COVER
FIG. 3-3**

CAUTION

Keep dirt, water and other contaminants from entering the hydraulic system. Before opening the hydraulic fluid reservoir filler cap, drain plug and hydraulic lines, clean up contaminants that can get in the openings. Also, protect the openings from accidental contamination.

4. Place a 5 gallon bucket under the Pump to catch fluid. Remove Tube Assembly and Plug as shown in FIG. 4-1.

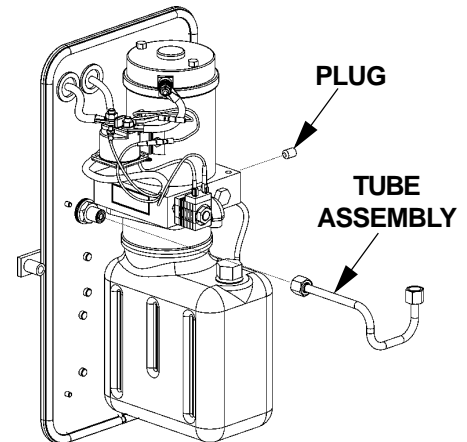

REMOVING EXISTING PARTS
FIG. 4-1

5. Bolt the Hand Pump Bracket to the Mounting Plate (FIG. 4-2). Then bolt Hand Pump to Hand Pump Bracket (FIG. 4-2).

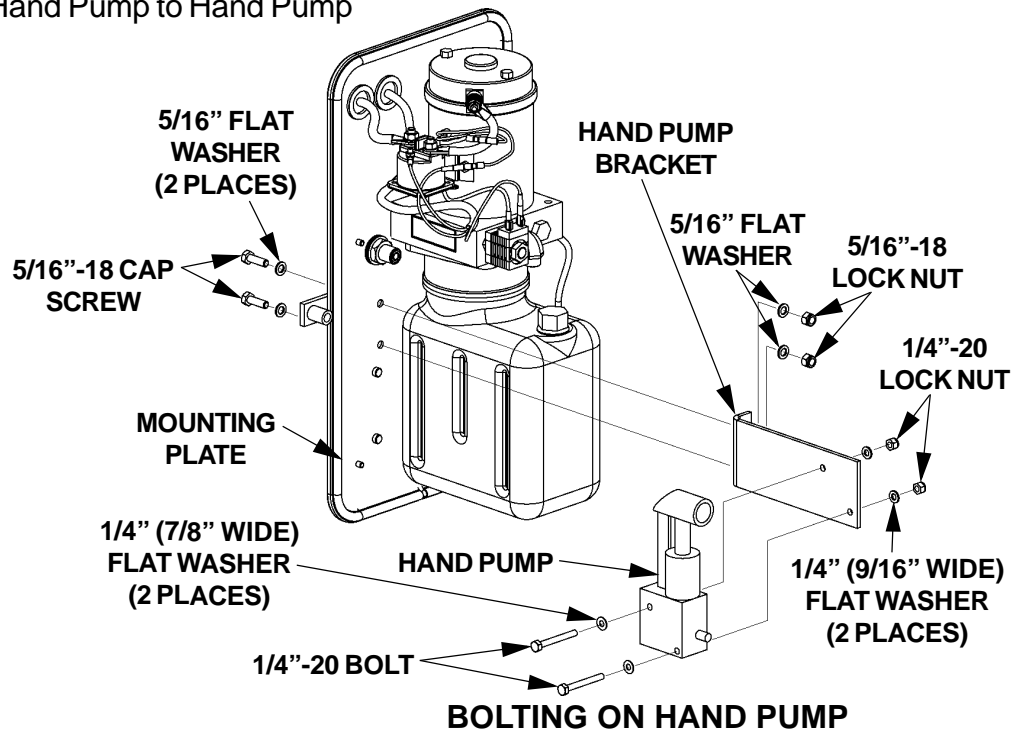

BOLTING ON HAND PUMP
FIG. 4-2

NOTE: Position the Raising Needle Valve Adjuster with arrow pointing toward elbow and the Lowering Needle Valve Adjuster with arrow pointing at the tee connection. The Hand Pump will not work if the Needle Valve Adjusters are reversed.

6. Connect the Hand Pump hydraulic lines, Needle Valve Adjuster, and connectors to Power Unit as shown in **FIG. 5-1**. Tighten all connections securely.

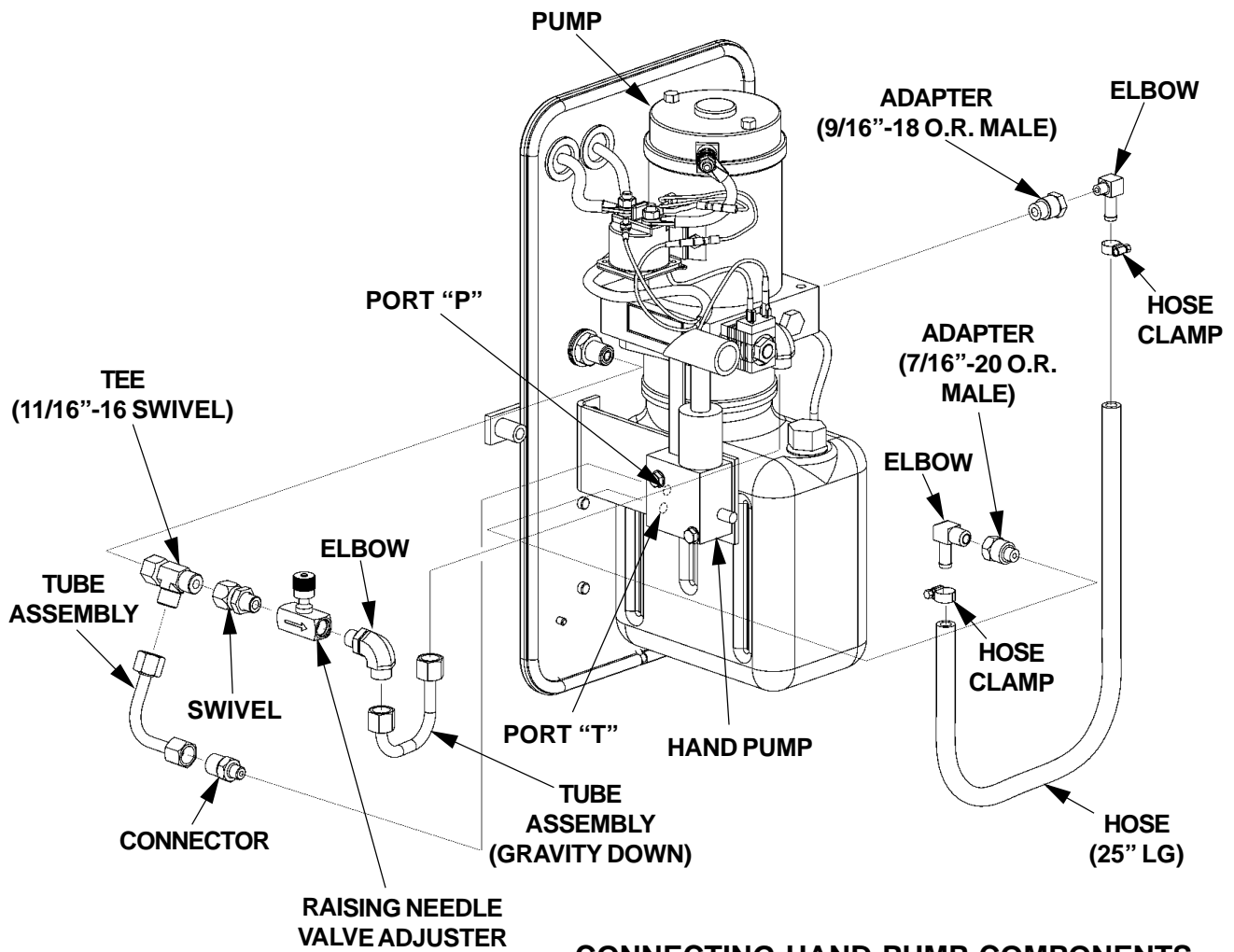

CONNECTING HAND PUMP COMPONENTS
FIG. 5-1

7. Rivet the 2 Spring Clip Holders to Mounting Plate as shown in **FIG. 6-1**. Then secure the Hand Pump Handle within the Spring Clips Holders.

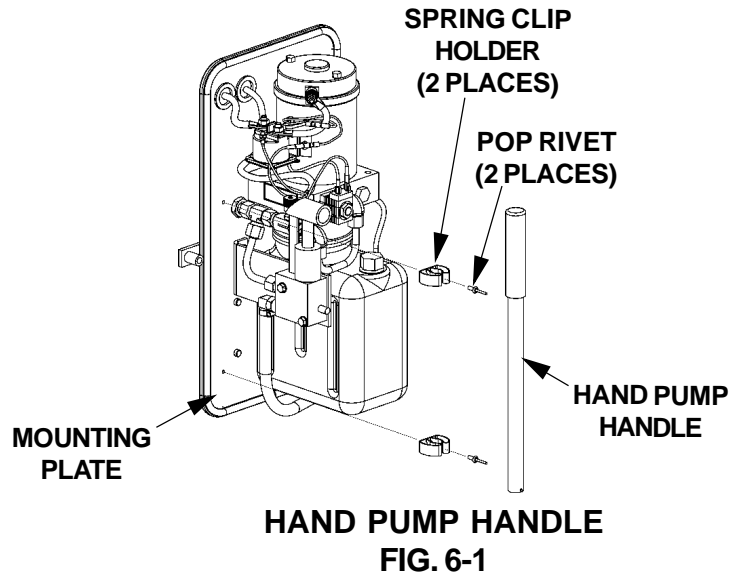

CAUTION

Small amount of torque is required for tightening the hex nut on Poppet Valve. Torque the Poppet Valve hex nut to 30 LB.-IN. Overtightening hex nut may damage Poppet Valve.

NOTE: Do not disconnect the Hydraulic Lock wiring.

8. Remove cartridge valve from Hydraulic Lock (**FIG. 6-2**). Install the Poppet Valve (Kit item) in the Hydraulic Lock.

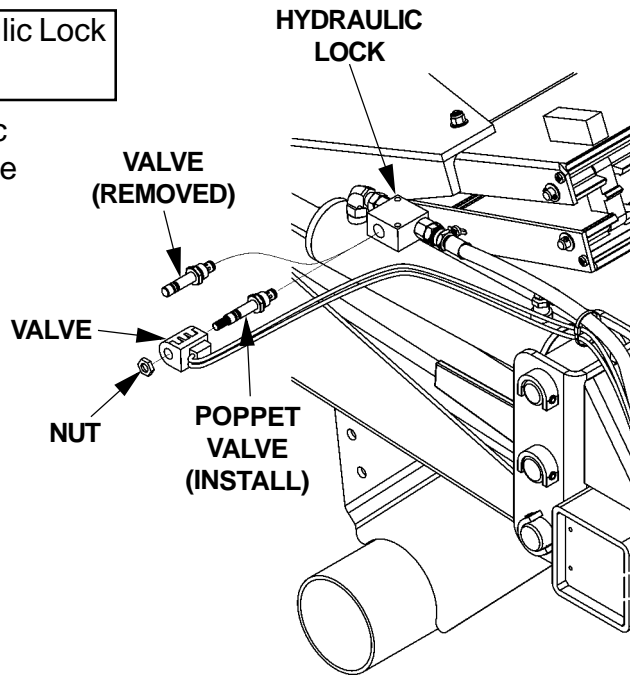

REMOVING VALVE CARTRIDGE
FIG. 6-2

9. Use floor jack to raise Lift by the Underride enough to remove jack stands (**FIG. 7-1**). Lower and remove floor jack.

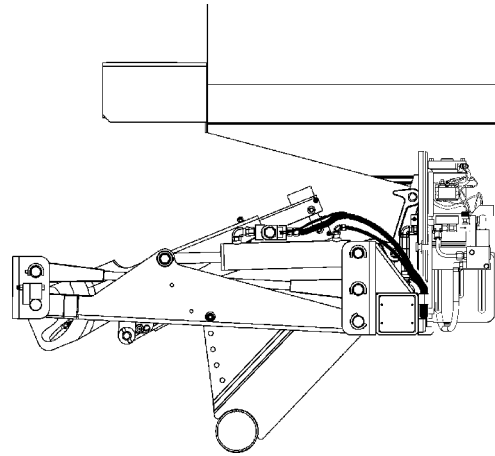

FLOOR JACK REMOVED
FIG. 7-1

10. Open the Needle Valve Adjuster by turning counterclockwise (**FIG. 7-2B**). Open the Hydraulic Lock by pulling and rotating knob 1/4 turn (**FIG. 7-3**).

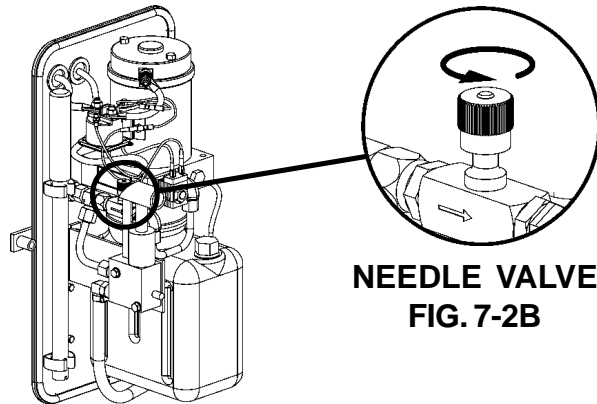

NEEDLE VALVE
FIG. 7-2B

OPENING NEEDLE VALVE
FIG. 7-2A

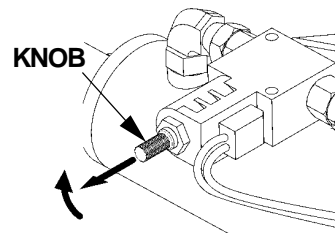

OPENING HYDRAULIC LOCK
FIG. 7-3

11. Lower the Platform about 6" by opening the Pressure release Valve 1/2 turn counterclockwise with the Pump Handle (**FIG. 8-1**). Close the Pressure Release Valve by turning clockwise to stop the Platform from lowering.

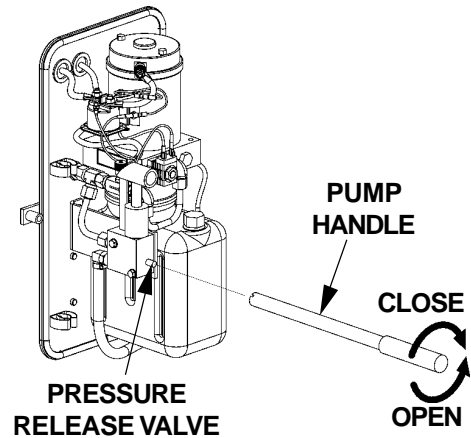

**OPENING/CLOSING PRESSURE
RELEASE VALVE
FIG. 8-1**

12. Close Needle Valve Adjuster (**FIG. 8-2B**) by turning clockwise. Then close Hydraulic Lock by turning Knob until it drops in the top of the Poppet Valve (**FIG. 8-3**).

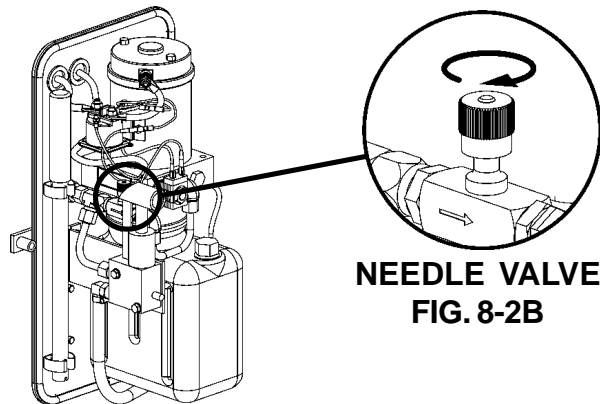

**CLOSING NEEDLE VALVE
FIG. 8-2A**

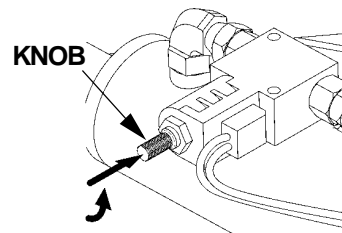

**OPENING HYDRAULIC LOCK
FIG. 8-3**

13. Reconnect power to Liftgate by removing nut from positive (+) battery terminal connector and connecting Power Cable (**FIG. 9-1**). Reinstall nut on positive (+) battery terminal connector.

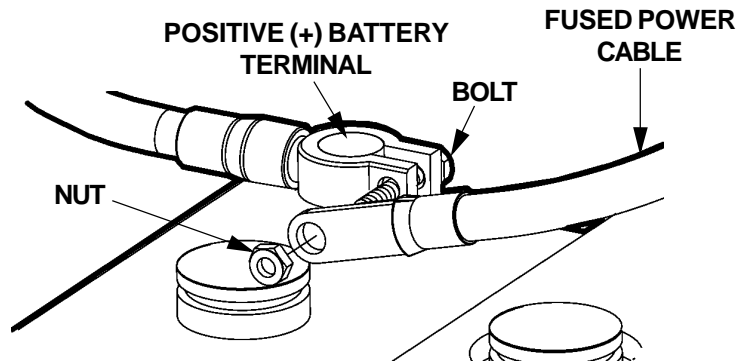

CONNECTING BATTERY
FIG. 9-1

14. Use the Control Switch to **LOWER** Platform to the ground (**FIG. 9-2**).

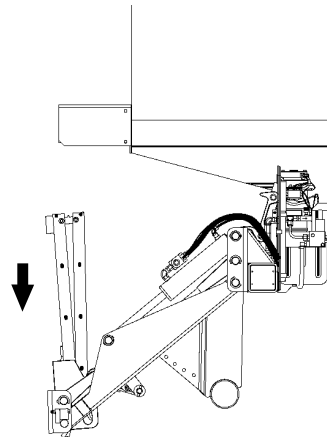

PLATFORM LOWERED TO THE GROUND
FIG. 9-2

15. Use Control Switch to Stow Liftgate (**FIG. 9-3**).

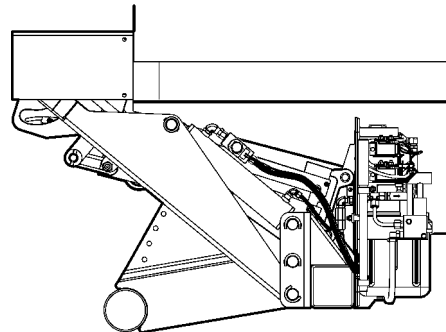

LIFTGATE STOWED
FIG. 9-3

CAUTION

Keep dirt, water and other contaminants from entering the hydraulic system. Before opening the hydraulic fluid reservoir filler cap, drain plug and hydraulic lines, clean up contaminants that can get in the openings. Also, protect the openings from accidental contamination.

NOTE: Use correct grade of hydraulic fluid for your location.

- +70 to +140 Degrees F - Grade ISO 32
- +40 to +105 Degrees F - Grade ISO 15
- Below + 70 Degrees F - Grade ISO 10 or MIL-H-5606

See TABLES 9-1, 9-2 & 9-3 on the next page for recommended brands.

16. Check the Hydraulic Fluid level in Reservoir. With Liftgate stowed, level should be 3" (FIG. 10-1). If needed, add fluid to the Reservoir as follows.

17. Pull out (no threads) Filler Cap (FIG. 10-1). Fill the Reservoir with Hydraulic Fluid to level shown in FIG. 10-1. Reinstall Filler Cap (FIG. 10-1)

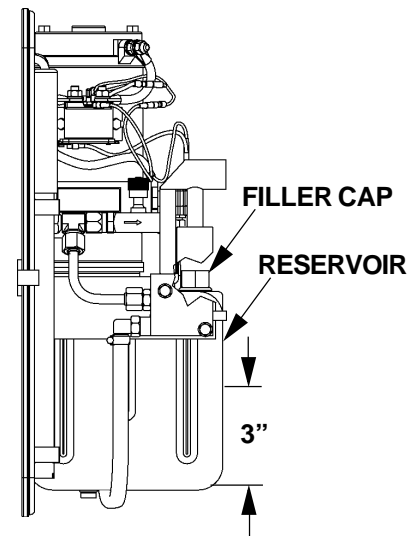

FLUID LEVEL
FIG. 10-1

CAUTION

Pump Cover must be correctly secured to prevent it from becoming a hazard. To secure Pump Cover, the long side of the Holder Flats must be installed as shown in the illustration.

18. Bolt on the Pump Cover as shown in FIG. 10-2. Torque the 5/16"-18 cover bolts 20 to 29 LBS.-FT.

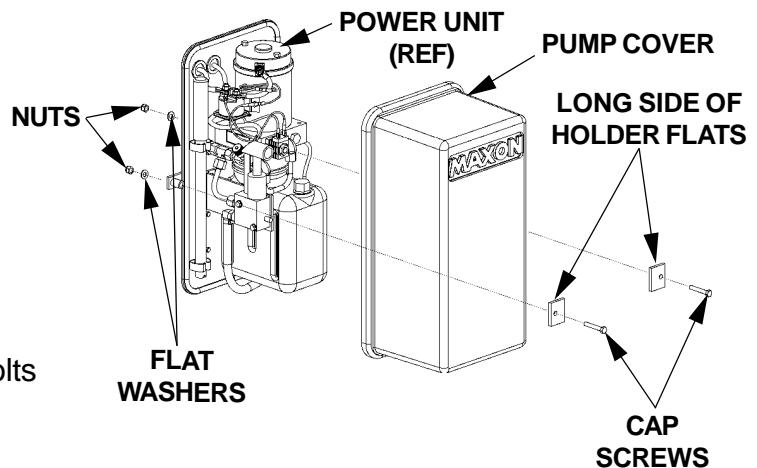

BOLTING ON PUMP COVER
FIG. 10-2

ISO 32 HYDRAULIC OIL	
RECOMMENDED BRANDS	PART NUMBER
AMSOIL	AWH-05
CHEVRON	HIPERSYN 32
KENDALL	GOLDEN MV
SHELL	TELLUS T-32
EXXON	UNIVIS N-32
MOBIL	DTE-13M, DTE-24, HYDRAULIC OIL-13

TABLE 11-1

ISO 15 HYDRAULIC OIL	
RECOMMENDED BRANDS	PART NUMBER
AMSOIL	AWF-05
CHEVRON	FLUID A, AW-MV-15
KENDALL	GLACIAL BLU
SHELL	TELLUS T-15
EXXON	UNIVIS HVI-13
MOBIL	DTE-11M

TABLE 11-2

ISO-10 OR MIL-H-5606 HYDRAULIC FLUID	
RECOMMENDED BRANDS	PART NUMBER
AMSOIL	N/A
CHEVRON	FLUID A, FLUID G
KENDALL	GLACIAL BLU
SHELL	AEROSHELL FLUID-41
EXXON	UNIVIS HVI-13
MOBIL	AERO HFA

TABLE 11-3