

INSTRUCTION, GPT HAND PUMP KIT INSTALLATION P/N 267491-01

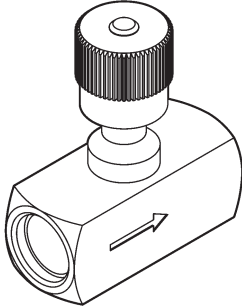

NEEDLE VALVE, ADJUSTABLE
P/N 906739-01
QTY. 1

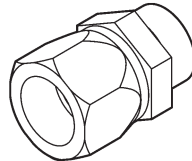

SWIVEL, O-RING, JIC #6
P/N 905181
QTY. 1

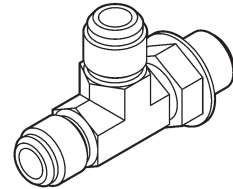

TEE, O-RING
P/N 264180
QTY. 1

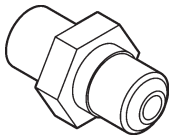

FITTING, O-RING, SAE#4
P/N 906741-01
QTY. 2

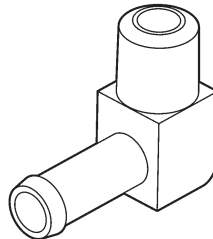

ELBOW, 90 DEGREE, 1/4" M-3/8" BARB
P/N 251853
QTY. 1

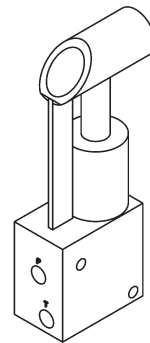

HAND PUMP, SAE #4 PORTS
P/N 266588-01
QTY. 1

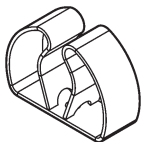

SPRING CLIP HOLDER
P/N 227681
QTY. 2

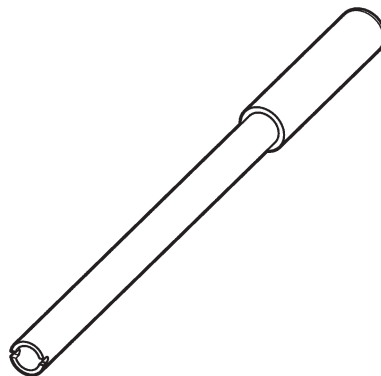

HANDLE, HAND PUMP
P/N 251407-02
QTY. 1



FLAT WASHER, 1/4"
P/N 902013-09
QTY. 4



LOCK WASHER, 1/4"
P/N 902011-2
QTY. 2



HEX NUT 1/4"-20
P/N 901011-1
QTY. 2



BLIND RIVET, 3/16 X .565 DOME ZC
P/N 904002-1
QTY. 2

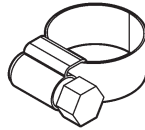

HOSE CLAMP
P/N 251854
QTY. 2

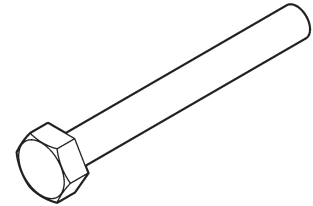

HEX BOLT, 1/4"-20 X 2-1/4" LG.
P/N 900000-9
QTY. 2



HOSE 3/8" LP, 12" LG.
P/N 251855-04
QTY. 1

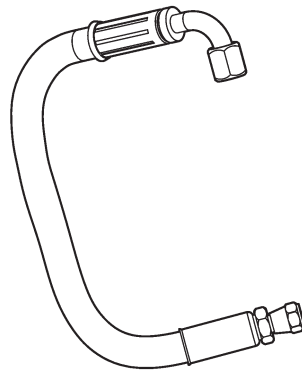

HOSE, 3/8" HP, 15-7/8" LG.
P/N 266801-01
QTY. 1

⚠ WARNING

To prevent personal injury and equipment damage, make sure power is disconnected from Liftgate while installing parts.

1. LOWER the Platform to the ground (FIG. 3-1).

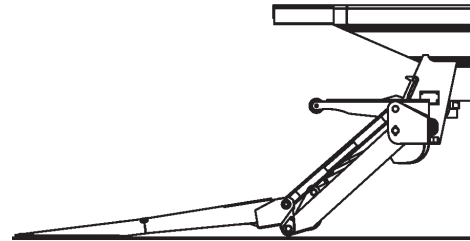

PLATFORM LOWERED TO GROUND
FIG. 3-1

2. Disconnect power from Pump Box by removing positive (+) battery terminal connector and disconnect Power Cable (FIG. 3-2). Reinstall nut on positive (+) battery terminal connector.

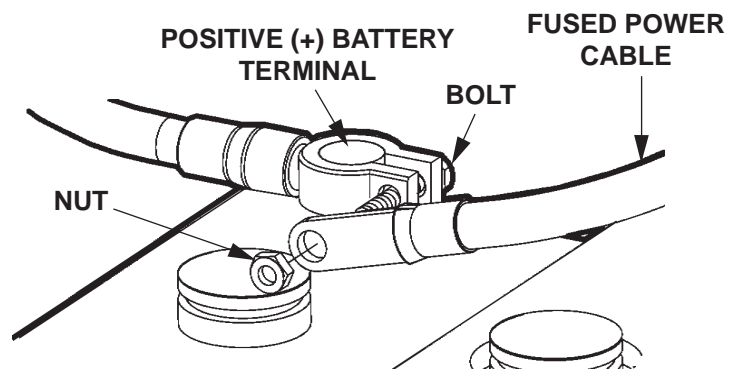

DISCONNECTING BATTERY POWER
FIG. 3-2

3. Open the Pump Box Cover (FIG. 3-3).

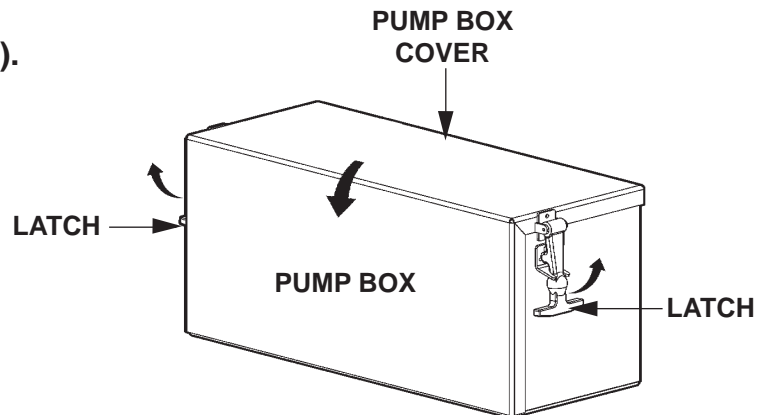

OPENING PUMP BOX COVER
FIG. 3-3

4. Disconnect the High Pressure (HP) hose from Flow Control Valve. Then disconnect Flow Control from pressure port fitting on Pump (**FIGS. 4-1A & 4-1B**).

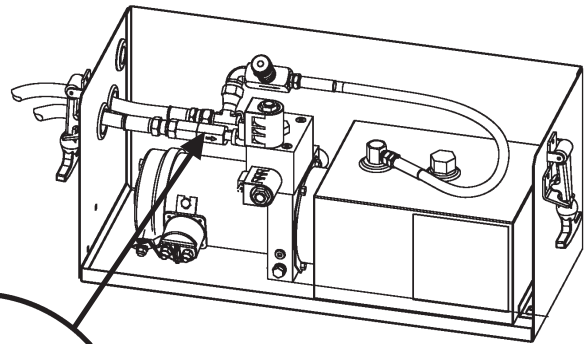
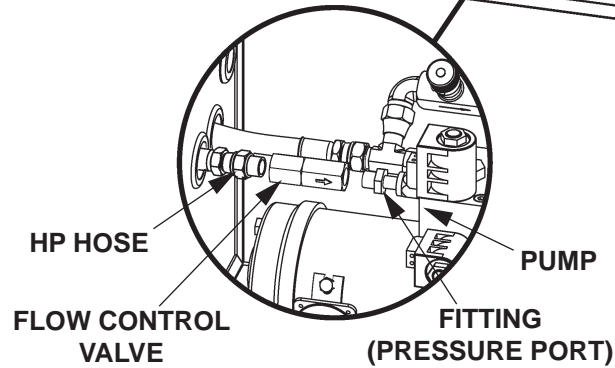
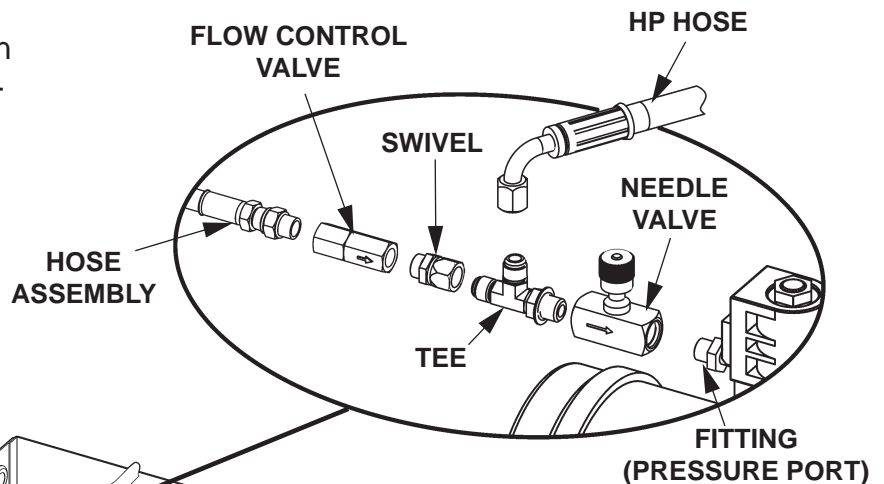

FIG. 4-1A



DISCONNECTING FLOW CONTROL VALVE
FIG. 4-1B

5. Connect the Swivel, Tee, and Needle Valve (Kit items) between the Flow Control Valve and pressure port fitting (**FIGS. 4-2A & 4-2B**). Then connect the High Pressure (HP) Hose (Kit item) to the Tee.



CONNECTING VALVE & HOSE
FIG. 4-2B

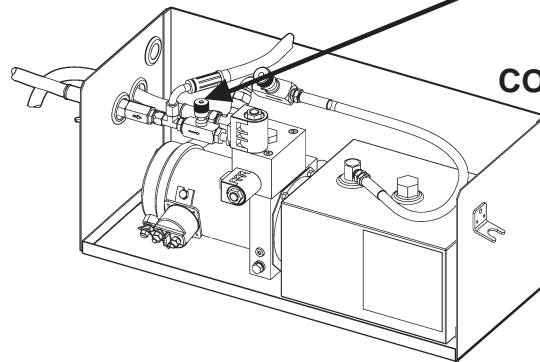
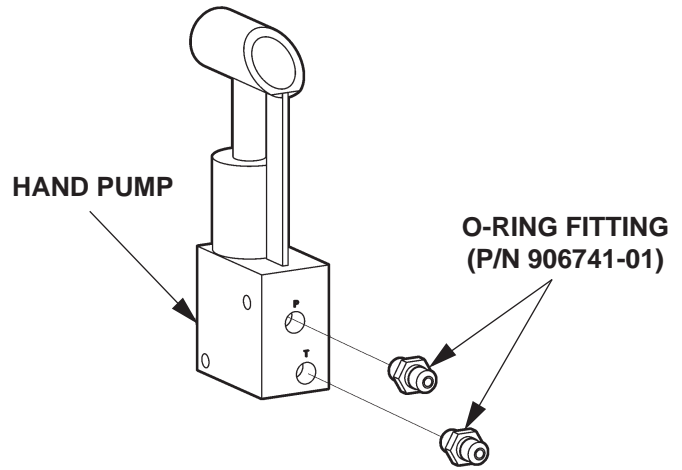

FIG. 4-2A

6. Install the O-ring Fittings on the Hand Pump (Kit items) (FIG. 5-1).



**INSTALLING FITTINGS
ON HAND PUMP
FIG. 5-1**

7. Bolt the Hand Pump to the pre-drilled holes on the Pump Box (FIGS. 5-2A & 5-2B).

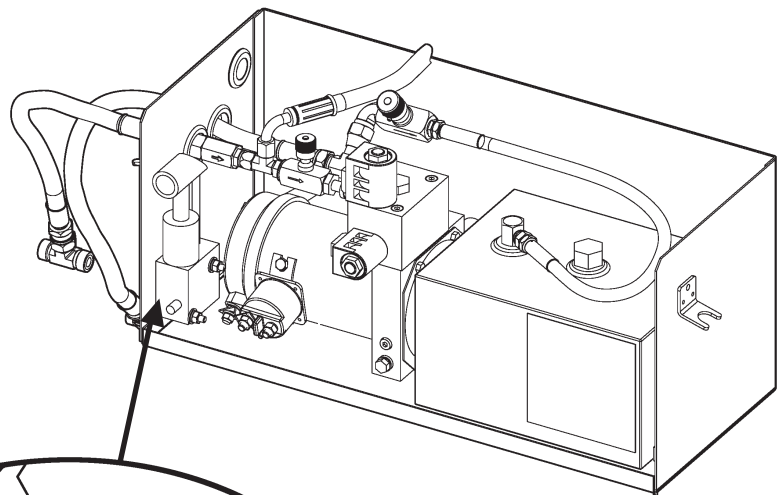
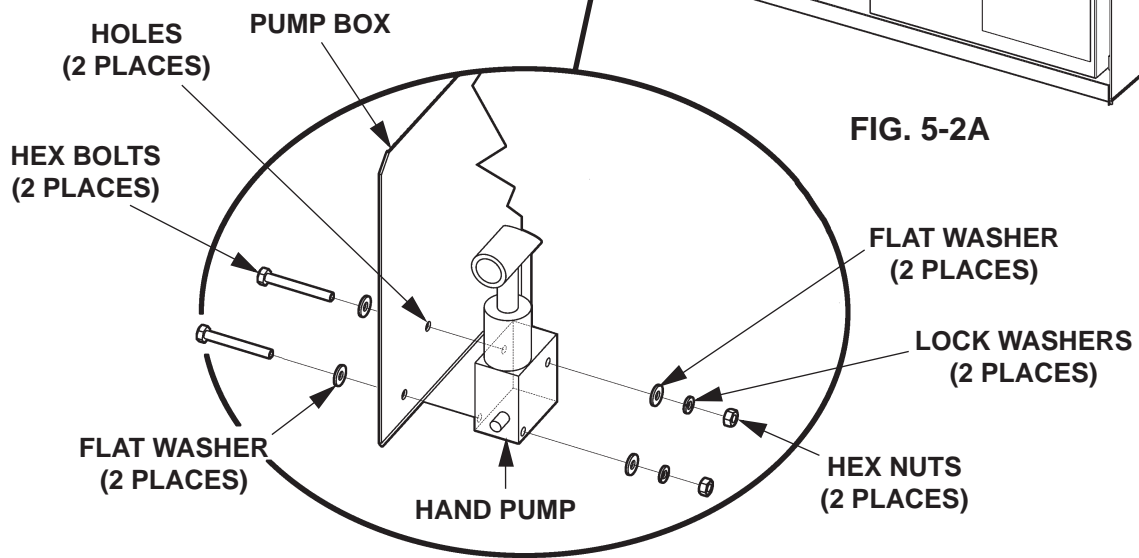

FIG. 5-2A



**BOLTING ON HAND PUMP
FIG. 5-2B**

8. Connect 90 Degree Elbow (Kit item) to Pump Assembly (FIGS. 6-2A & 6-2B). Clamp one end of the 12" LP Hose (Kit item) to the 90 Degree Elbow and the other end to the top O-ring Fitting on Hand Pump. Then connect the 15-7/8" HP Hose (Kit item) to the bottom O-ring Fitting on the Hand Pump (FIGS. 6-2A & 6-2B).

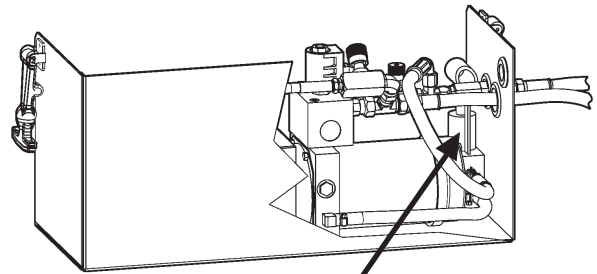
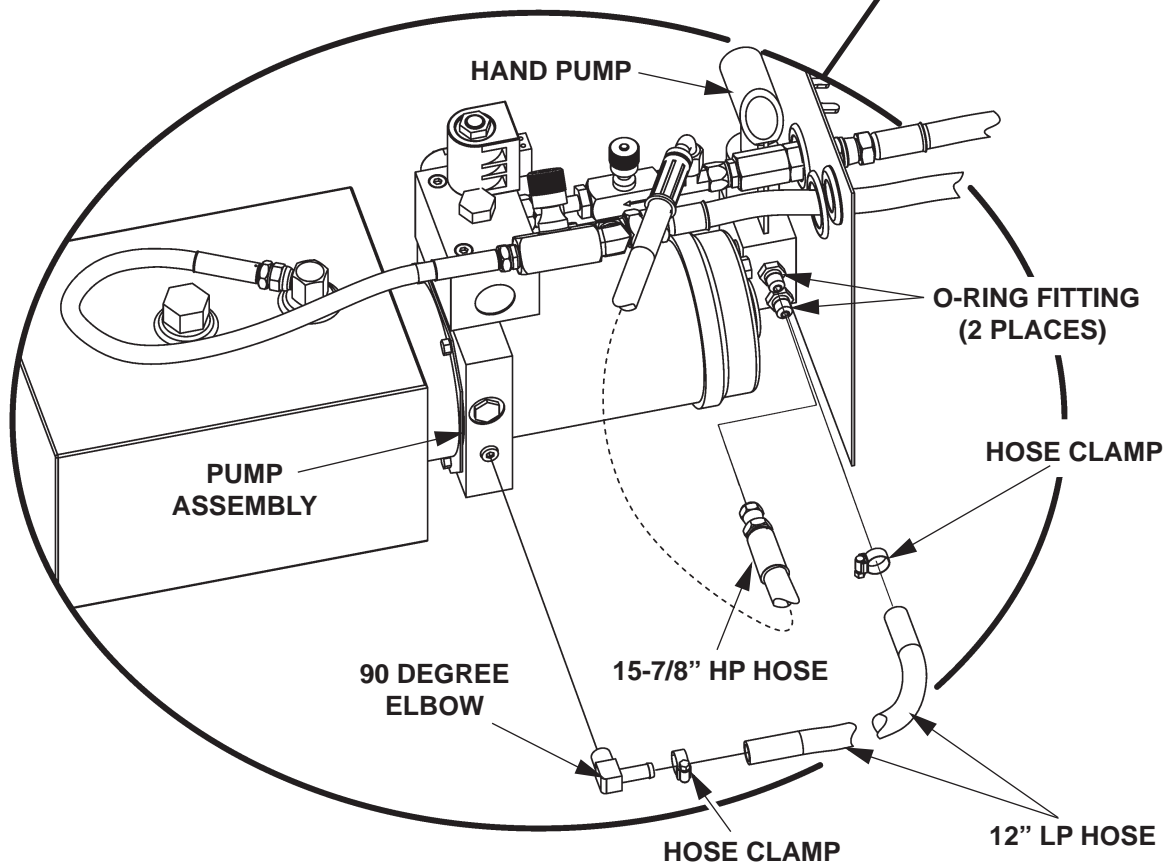
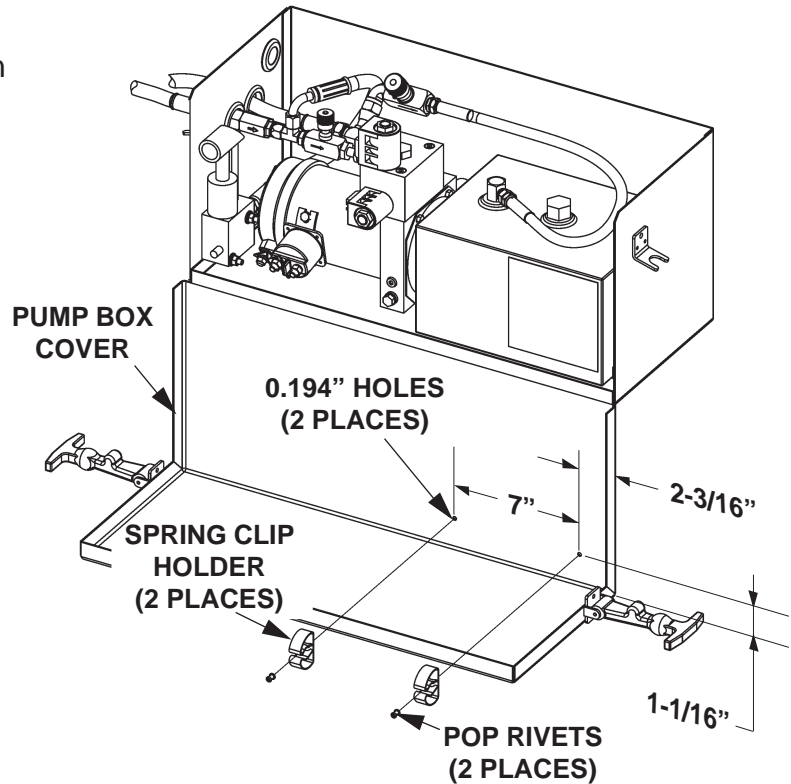

FIG. 6-2A



CONNECTING HOSES TO HAND PUMP
FIG. 6-2B

9. Drill two 0.194" holes (#10 drill bit) in the Pump Box Cover as shown in FIG. 7-1.



10. Rivet the 2 Spring Clip Holders to the Pump Box Cover (FIG. 7-1).

RIVETING SPRING CLIP HOLDERS
FIG. 7-1

11. Place the Handle in the Spring Clip Holders (FIG. 7-2).

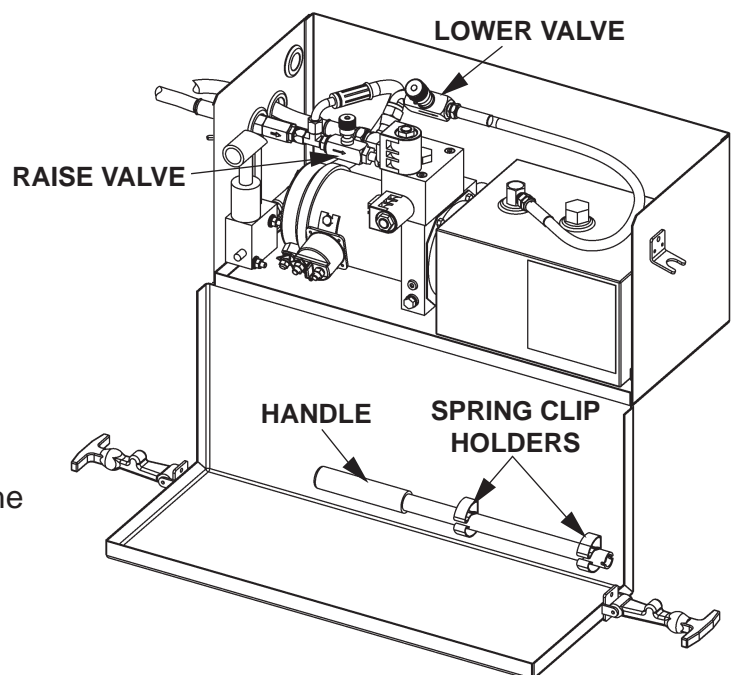

12. For normal Liftgate operation, open the **RAISE** Valve and close the **LOWER** Valve (FIG. 7-2). To use Hand Pump for backup operation, close **RAISE** Valve and open **LOWER** Valve.

VALVE SETTINGS
FIG. 7-2

13. Close the Pump Box Cover
(FIG. 8-1).

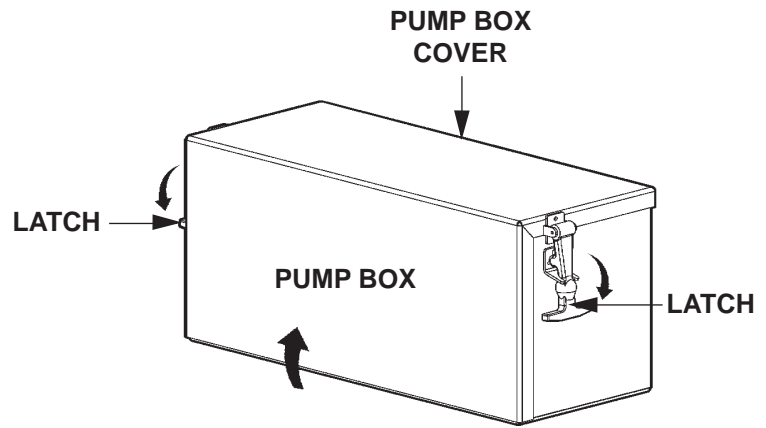

CLOSING PUMP BOX COVER
FIG. 8-1

14. Reconnect power to Pump Box.
Remove nut from positive (+) battery terminal connector. Reconnect the Power Cable to positive (+) battery terminal connector (FIG. 8-2). Reinstall and tighten nut.

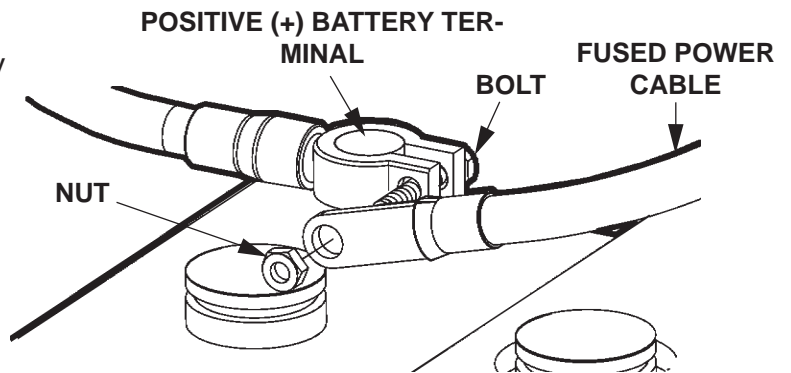

RECONNECTING BATTERY POWER
FIG. 8-2