

INSTRUCTION, GPTLR-44 & GPTLR-55 UNDERRIDE KIT (U.S. & CANADA)

Kit P/N 282803-01 (96" WIDE VEHICLES)

NOTE: Install this kit only on vehicles with 49" bed height (loaded), and 50" to 55" bed heights (unloaded).

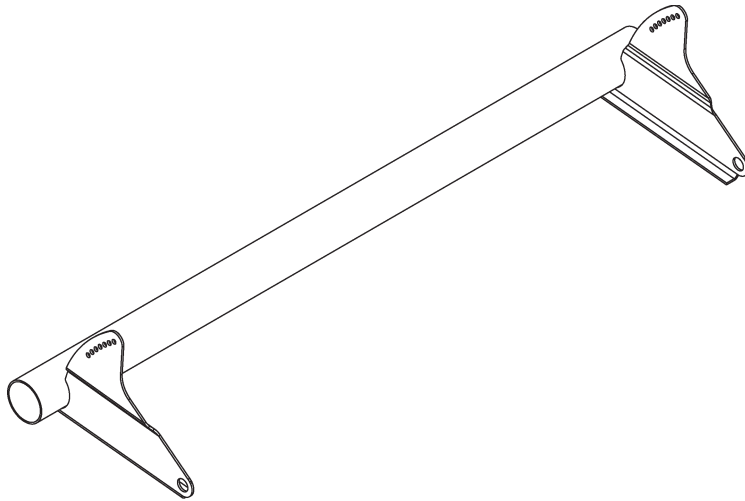

**UNDERRIDE (96" WIDE VEHICLE)
P/N 282802-01
QTY. 1**



**CONSPICUITY TAPE
(REFLECTIVE, 7'6" LG.)
P/N 908150-01
QTY. 1**

Kit P/N 282803-02 (102" WIDE VEHICLES)

NOTE: Install this kit only on vehicles with 49" bed height (loaded), and 50" to 55" bed heights (unloaded).

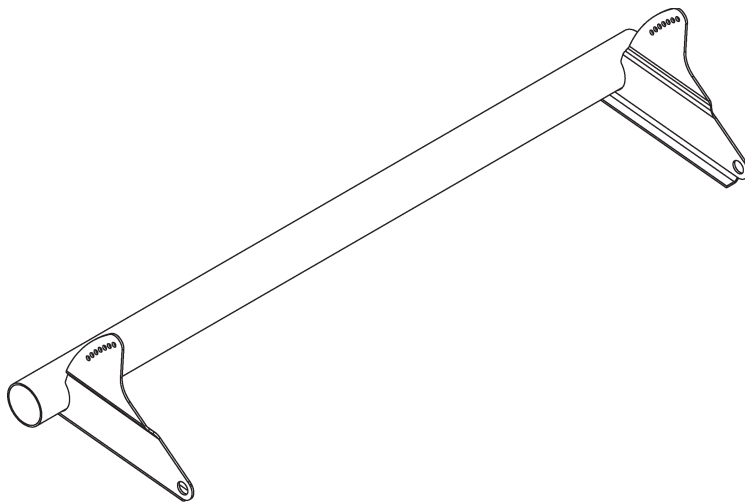

UNDERRIDE (102" WIDE VEHICLE)
P/N 282802-02
QTY. 1

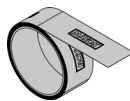

CONSPICUITY TAPE
(REFLECTIVE, 7'11" LG.)
P/N 908150-01
QTY. 1

REMOVING OLD UNDERRIDE

1. Lower platform to the ground. Then, unfold platform and flipover (**FIG. 3-1A**).

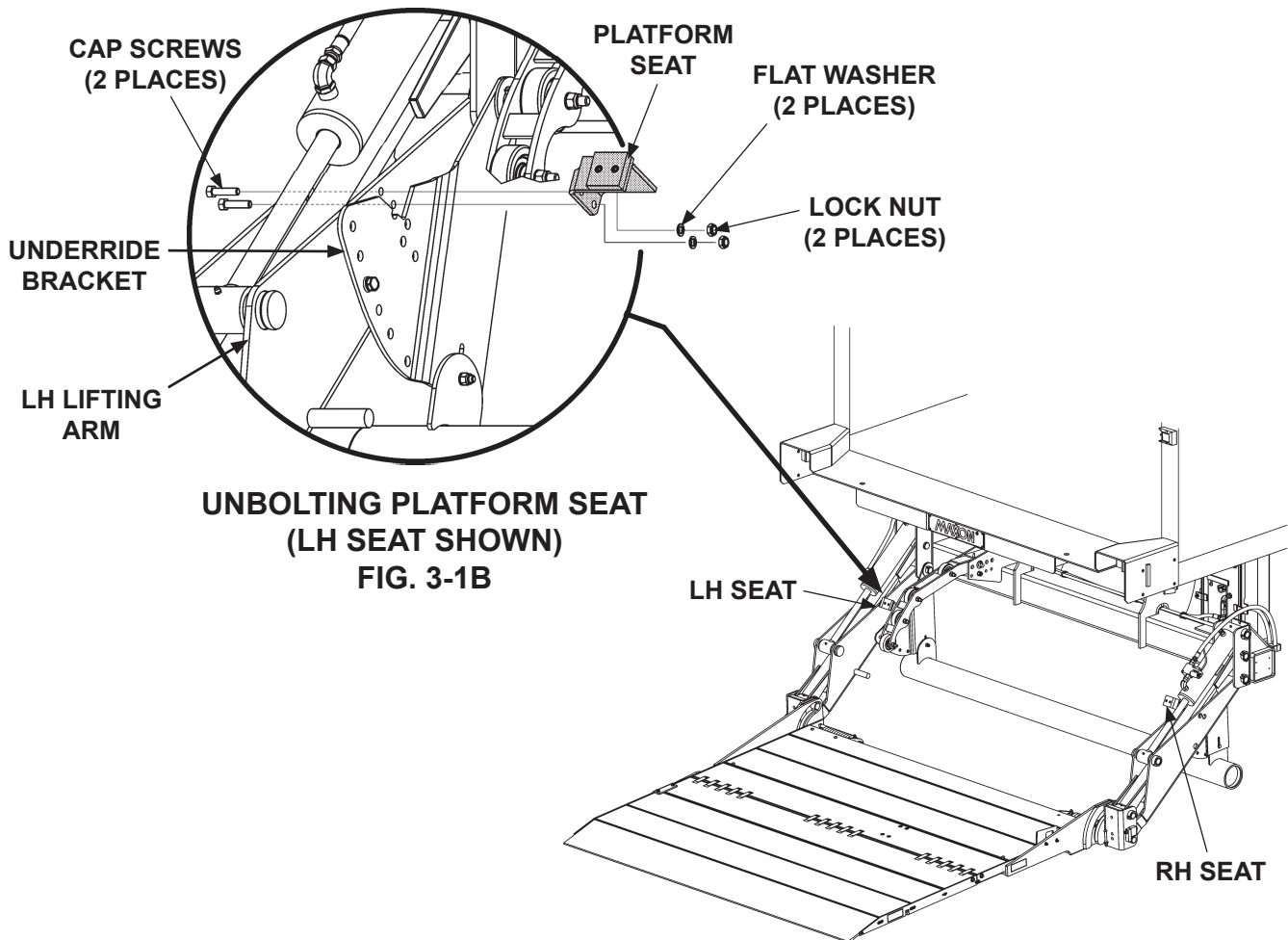

NOTE: Do step 2 only if platform stops are bolted through the underride brackets. If the stops are bolted directly to lift arms, go to step 3 (skip step 2).

2. Unbolt the platform seats from the LH and RH underride brackets and lift arms (**FIG. 3-1B**).

NOTE: Underride may have too little ground clearance for a jack. If necessary, raise the platform up to 6" to get a jack in position to support the underride.

3. Support underride with floor jack (**FIG. 4-1A**). Next, unbolt LH underride support bracket (**FIG. 4-1B**) and RH underride support bracket.

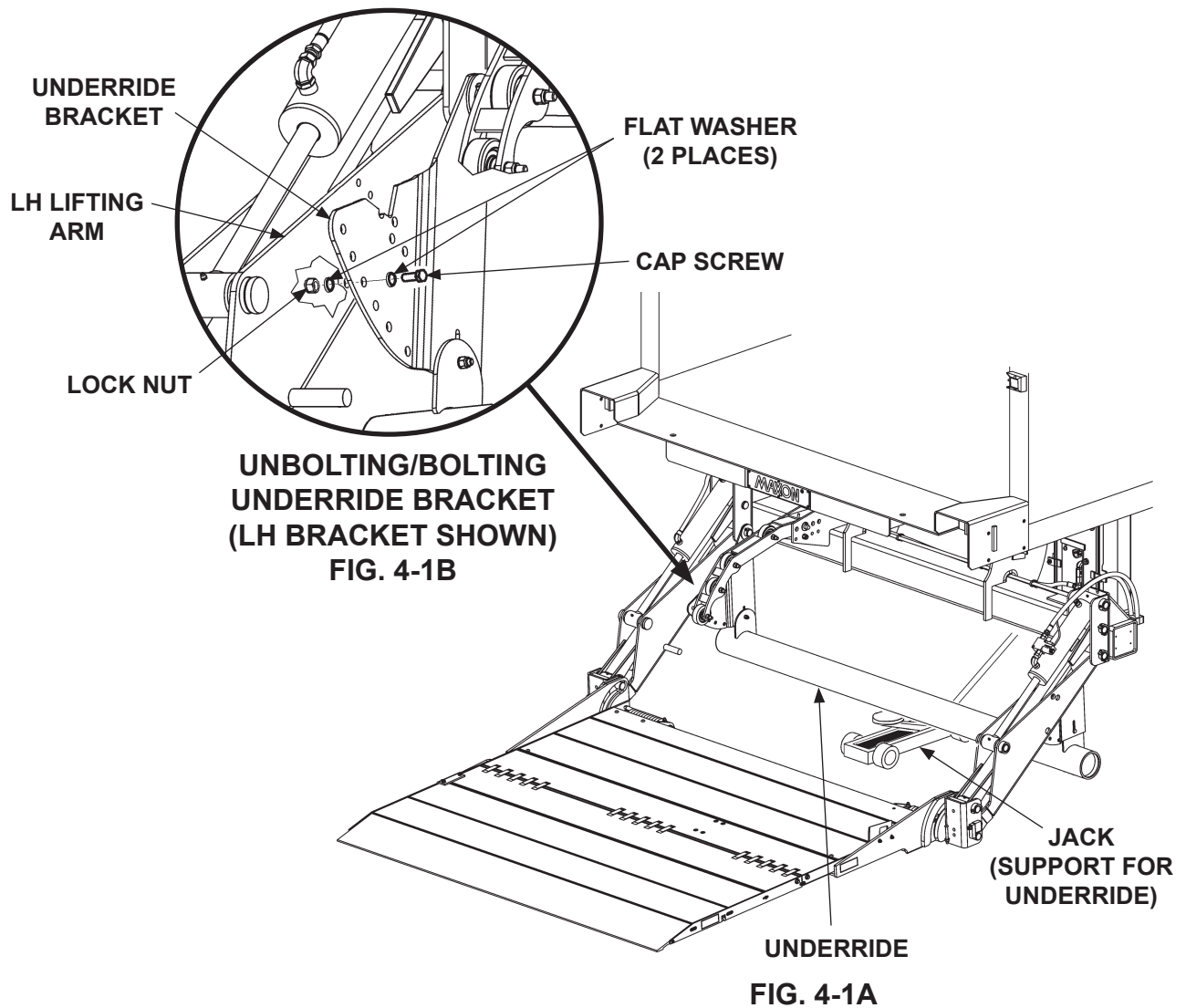

⚠ CAUTION

To prevent personal injury and equipment damage, keep the underride from moving or falling when attaching hardware is removed. Get a second person to help hold and remove the underride from under the Liftgate.

- Remove roll pins and washer from the lift arm pin that supports LH underride bracket (FIG. 5-1B and 5-1C). Repeat this step for RH underride bracket.

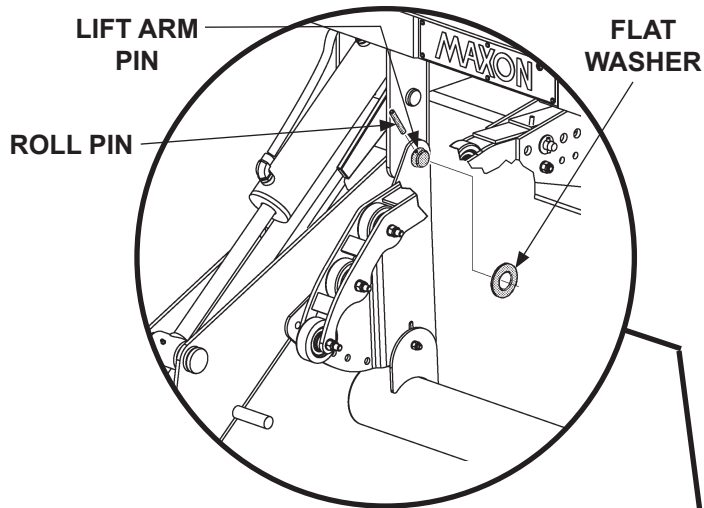

**REMOVING ROLL PIN & WASHER
FIG. 5-1C**

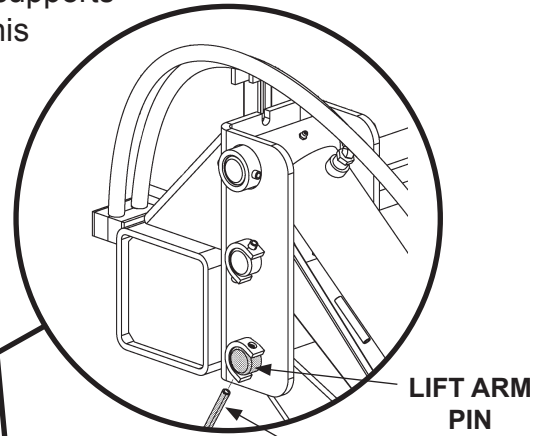

**REMOVING ROLL PIN
FIG. 5-1B**

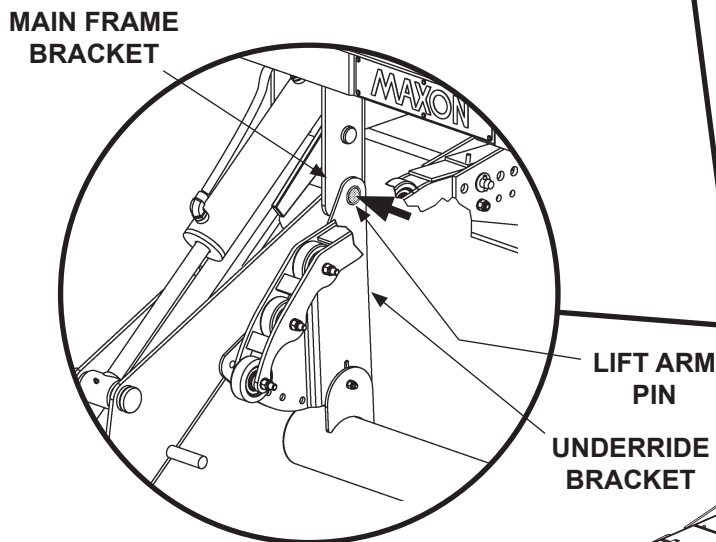

**FREING LH BRACKET
FIG. 5-1D**

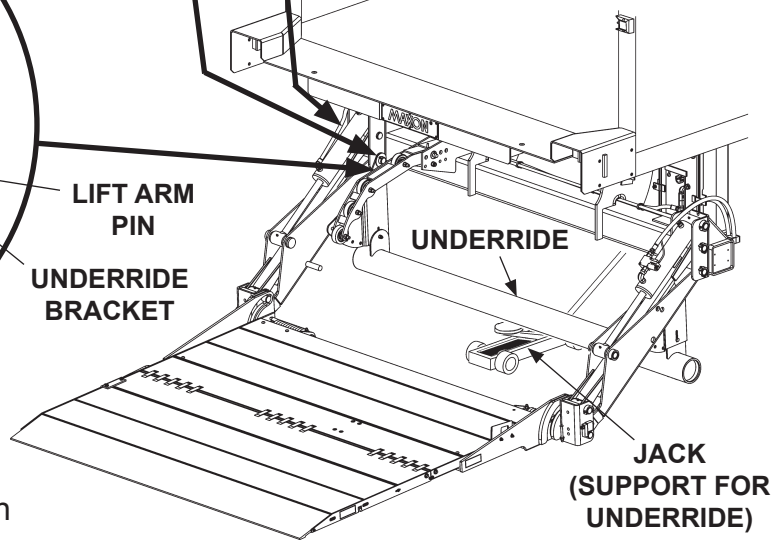

FIG. 5-1A

- To free the LH underride bracket, push the lift arm pin until flush with main frame bracket (FIG. 5-1D).

6. Move the old underride and floor jack (FIG. 6-1A) away from vehicle.

NOTE: Do step 7 only if platform stops were removed (step 2). If the stops were not removed, go to step 8 (skip step 7).

7. Bolt the platform seats to the LH and RH lift arms (FIGS. 6-1A and 6-1B).

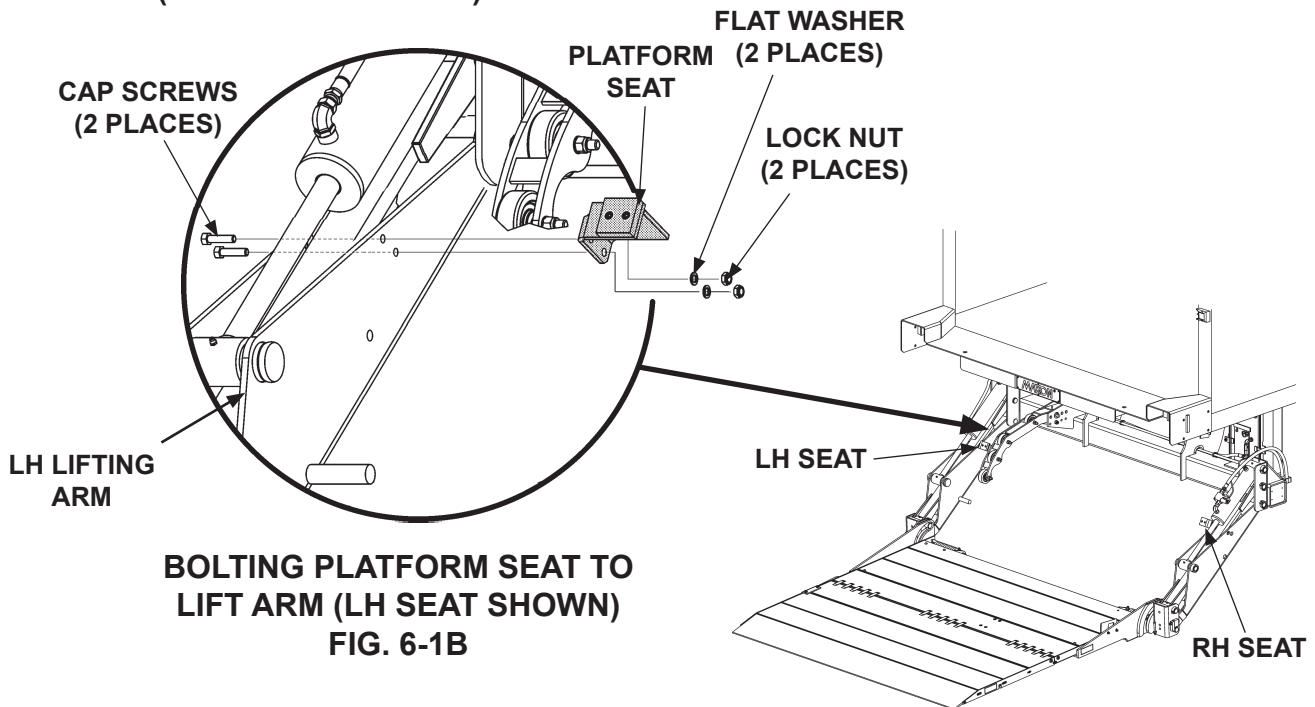

8. Stow the platform (FIG. 6-2).

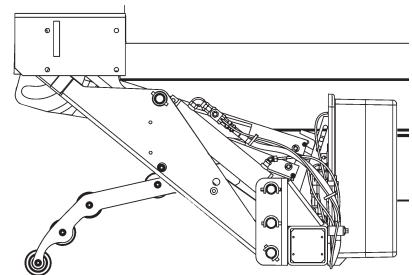

LIFTGATE WITH PLATFORM STOWED
FIG. 6-2

INSTALLING NEW UNDERRIDE

CAUTION

To prevent personal injury and equipment damage, use a forklift to support the underride and a competent second person to help position the underride until bolted in place.

9. Lift new underride (Kit item) with forklift (**FIG. 7-1**). Then, clamp each fork to keep underride from falling.

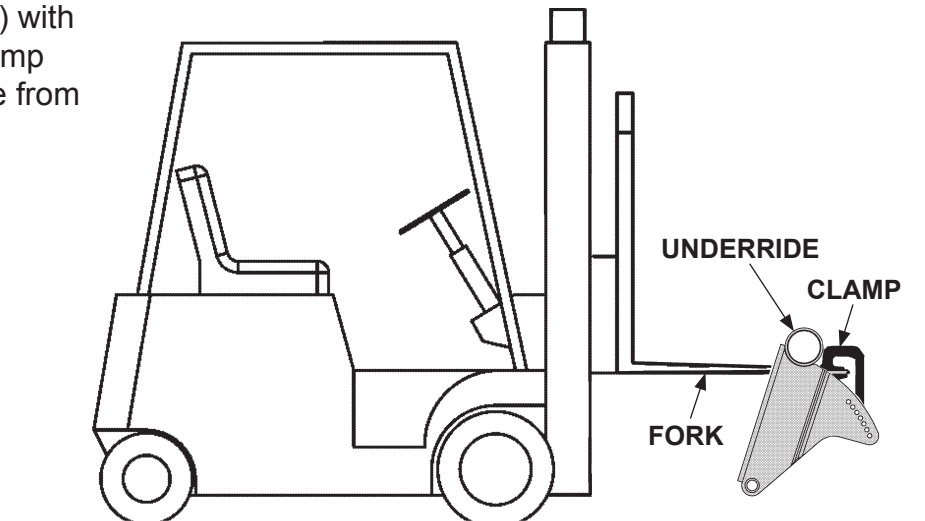

**LIFTING UNDERRIDE WITH FORKLIFT
(RH SIDE VIEW)
FIG. 7-1**

10. Position underride brackets against lift arm brackets on RH and LH sides of Liftgate (**FIG. 7-2**). Then align lift arm pin with bearing in the RH and LH underride brackets.

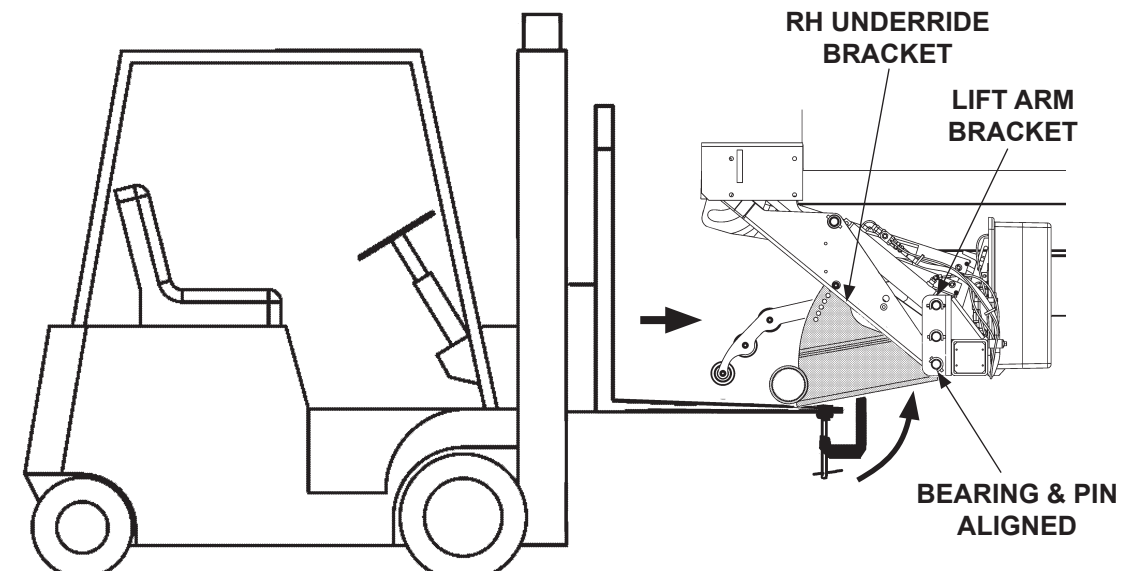

**POSITIONING UNDERRIDE (RH SIDE VIEW)
FIG. 7-2**

⚠ CAUTION

To prevent personal injury and equipment damage, keep the underride from moving or falling when attaching hardware is removed. Get a second person to help hold and remove the underride from under the Liftgate.

11. To capture the LH underride bracket, push the lift arm pin until hole in the pin lines up with hole in the collar (**FIG. 8-1B**).

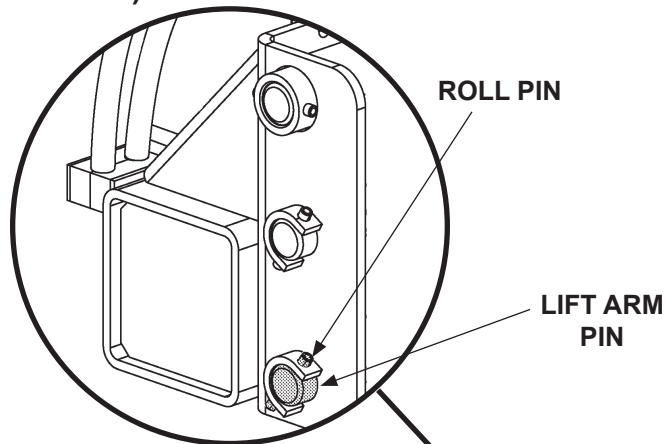

**INSTALLING ROLL PIN
FIG. 8-1B**

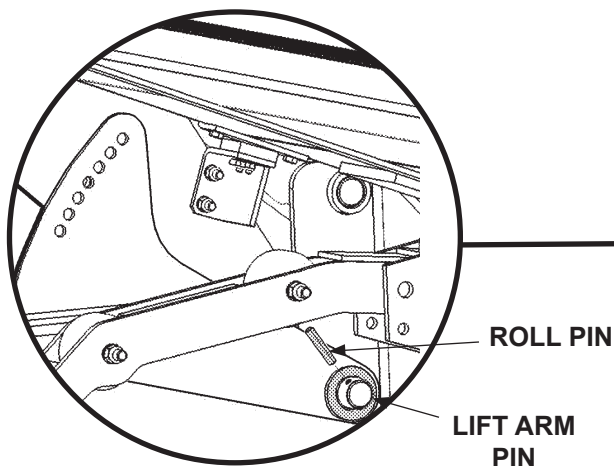

**INSTALLING FLAT WASHER
& ROLL PIN
FIG. 8-1C**

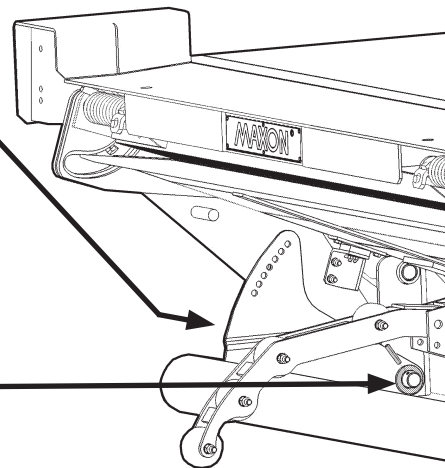

**PLATFORM STOWED
FIG. 8-1A**

12. Secure the lift arm pin with flat washer and roll pin (**FIG. 8-1C**) removed in step 4.
13. Repeat steps 11 and 12 for the RH underride bracket.

ADJUSTING UNDERRIDE

14. Measure vehicle bed height (FIG. 9-1). Then refer to TABLE 9-1 for the correct hole for bolting on the under-ride brackets.

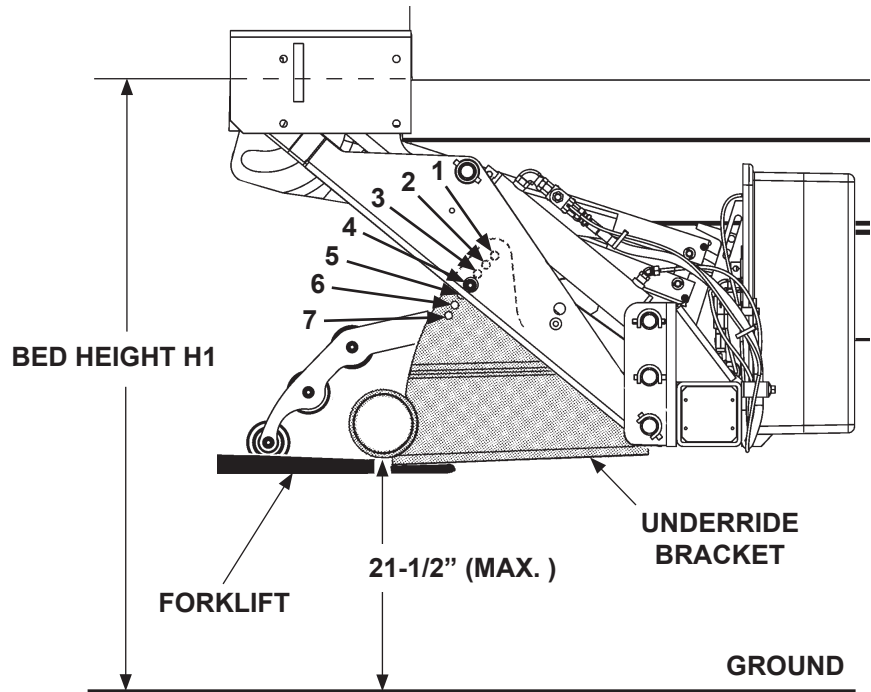

**SELECTING CORRECT BOLT HOLE (UNDERRIDE IS SHOWN POSITIONED AT HOLE 4)
FIG. 9-1**

NOTE: Instructions for measuring ground clearance “H2” with platform on the ground, are covered in step 17.

MODEL	SELECT HOLE	VEHICLE BED HT “H1” (UNLOADED EXCEPT AS NOTED)	UNDERRIDE MIN. GROUND CLEARANCE “H2” (PLATFORM ON GROUND)	MEETS FMVSS	MEETS CANADIAN MOTOR VEH REG
GPTLR-44 & GPTLR-55	#1	55”	4-3/16”	YES	YES
		54	3-3/16”		
		53	2-5/16”		
	#2	54”	2-3/16”		
	#3	53”	2-3/4”		
		52”	2”		
	#4	52”	2-3/16”		
	#5	51”	1-3/4”		
		50”	1”		
	#6	50”	1-1/2”		
#7	49” (LOADED)	1”			

TABLE 9-1

15. Reposition underride to correct hole position from **TABLE 10-1**. Ensure underride is equal to or less than the 21-1/2" maximum height requirement (**FIG. 10-1**). Then bolt LH and RH underride brackets to lift arms (**FIG. 10-1**).

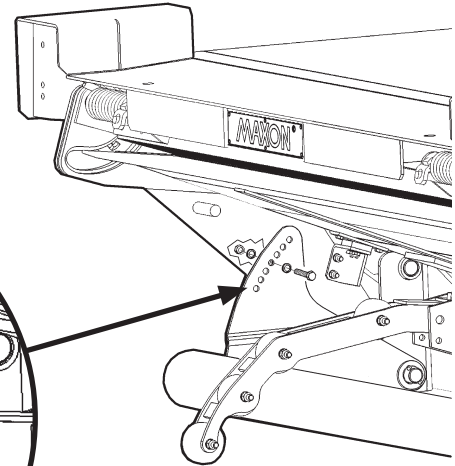
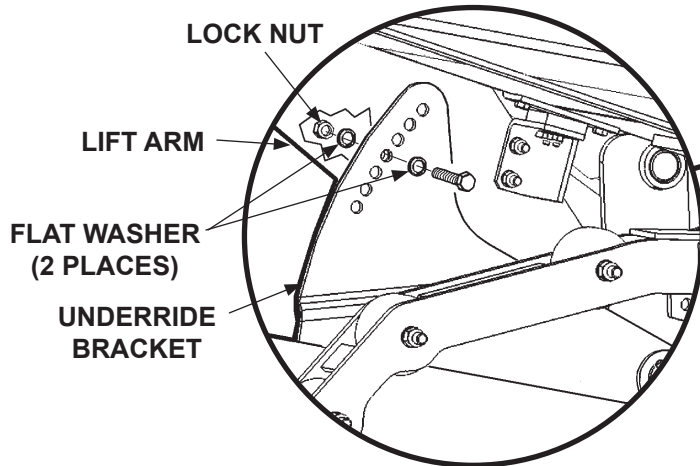
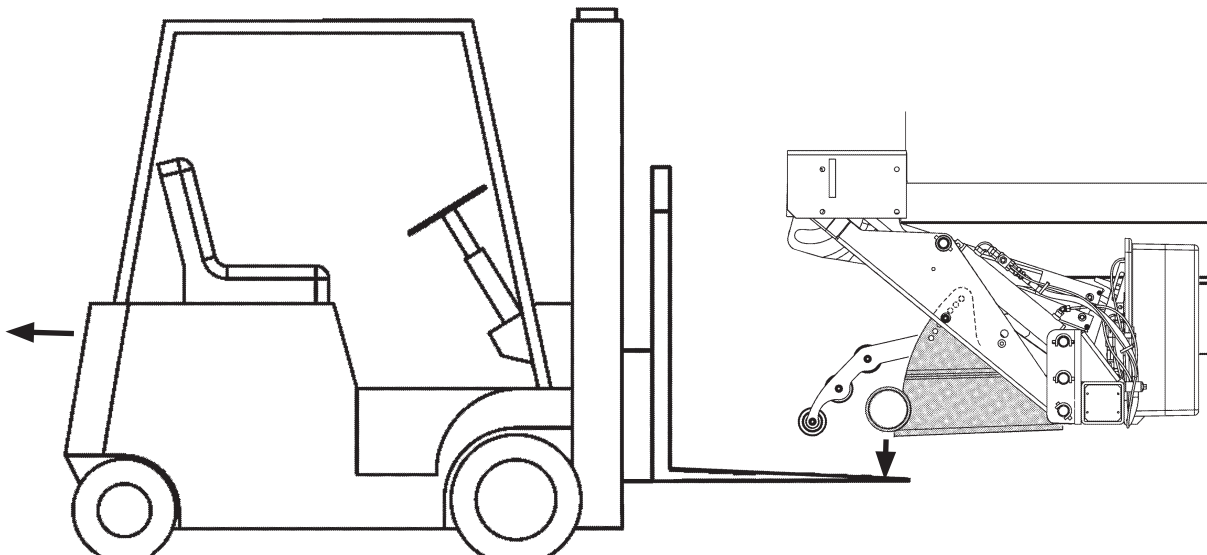

FIG. 10-1A

**BOLTING UNDERRIDE
BRACKET TO LIFT ARM
(HOLE 4 ON LH BRACKET IS SHOWN)
FIG. 10-1B**

16. Remove clamps. Then, lower the forks and back out forklift (**FIG. 10-2**).



**BACKING OUT FORKLIFT
FIG. 10-2**

NOTE: For some bed heights, underride brackets can be moved 1 or 2 holes to increase ground clearance when platform is on the ground. Use the settings shown in **TABLE 11-1**, only. Ensure ground clearance does not exceed the 21-1/2" maximum clearance when platform is stowed.

17. Lower platform to the ground (**FIG. 11-1**). Measure ground clearance "H2" of the underride. Refer to the "H2" clearance dimensions for your bed height "H1" in **TABLE 11-1**. For some bed heights, underride can be moved up 1 or 2 holes

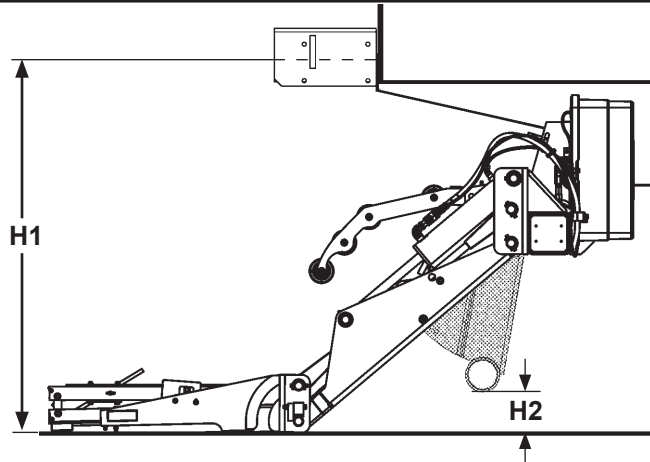

GROUND CLEARANCE, PLATFORM ON THE GROUND
FIG. 11-1

MODEL	SELECT HOLE	VEHICLE BED HT "H1" (UNLOADED EXCEPT AS NOTED)	UNDERRIDE MIN. GROUND CLEARANCE "H2" (PLATFORM ON GROUND)	MEETS FMVSS	MEETS CANADIAN MOTOR VEH REG
GPTLR-44 & GPTLR-55	#1	55"	4-3/16"	YES	YES
		54"	3-3/16"		
		53"	2-5/16"		
	#2	54"	2-3/16"		
	#3	53"	2-3/4"		
		52"	2"		
	#4	52"	2-3/16"		
	#5	51"	1-3/4"		
		50"	1"		
	#6	50"	1-1/2"		
#7	49" (LOADED)	1"			

TABLE 11-1

NOTE: Ensure underride tube is clean before attaching reflective tape.

18. Remove backing from reflective tape (Kit item). Then, center tape on underride as shown in **FIG. 12-1**. Press tape firmly in place and remove air pockets.

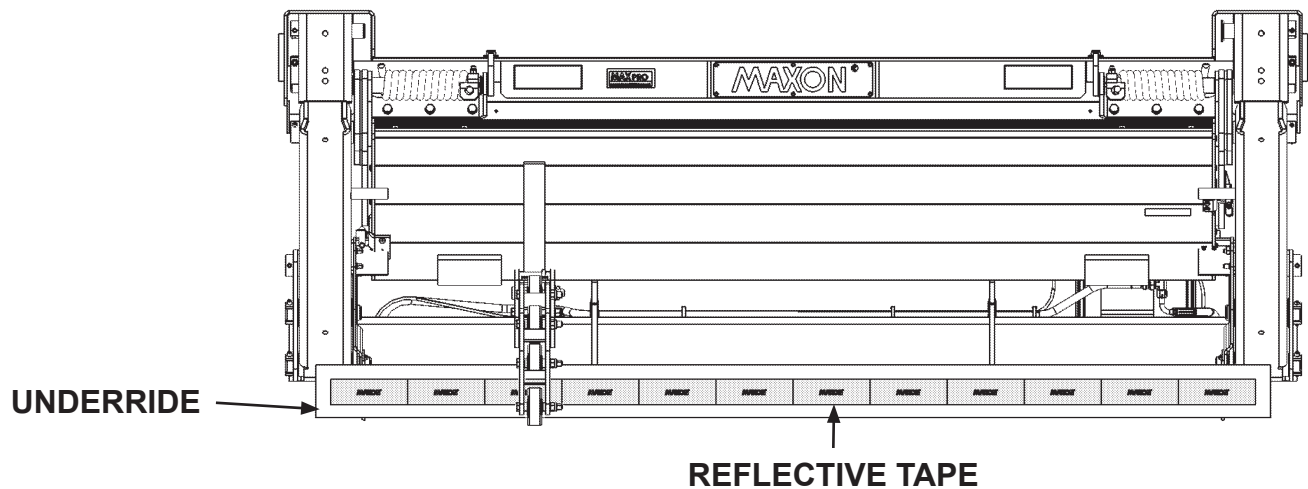

REFLECTIVE TAPE ATTACHED TO UNDERRIDE
FIG. 12-1

19. Lower and raise the platform to ensure there is no interference between underride and the Liftgate. (**Refer to GPTLR Operation Manual.**)