

INSTRUCTION, GPT'S BUMPER KIT

Kit P/N 282734-01

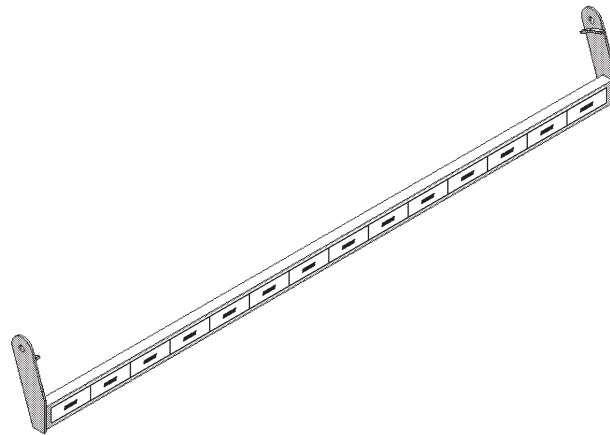

BUMPER (ICC TYPE)
P/N 282732-01
QTY. 1

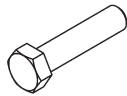

CAP SCREW, 3/4"-10 X 3-1/4" LG, GR8
P/N 900038-12
QTY. 2



FLAT WASHER, 3/4"
P/N 902013-16
QTY. 2



LOCK NUT, NYLON, 3/4"-10, GR8
P/N 903127-01
QTY. 2

NOTE: For operating instructions, refer to **GPT OPERATION MANUAL**.

1. Stow the platform (**FIG. 2-1**).

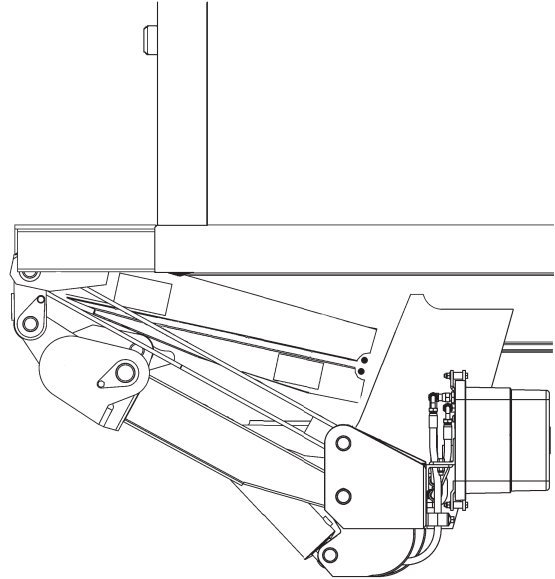

PLATFORM STOWED (RH SIDE VIEW)
FIG. 2-1

⚠ CAUTION

To prevent personal injury and equipment damage, support the bumper and a competent second person to help position the bumper until bolted in place.

2. Position bumper brackets against lift arms on the RH and LH sides of Liftgate (**FIG. 2-2**).
3. Bolt each bumper bracket to lift arm on RH and LH sides of Liftgate (**FIG. 2-2**). Use fasteners supplied with kit. Keep the bolts loose enough to reposition bumper.

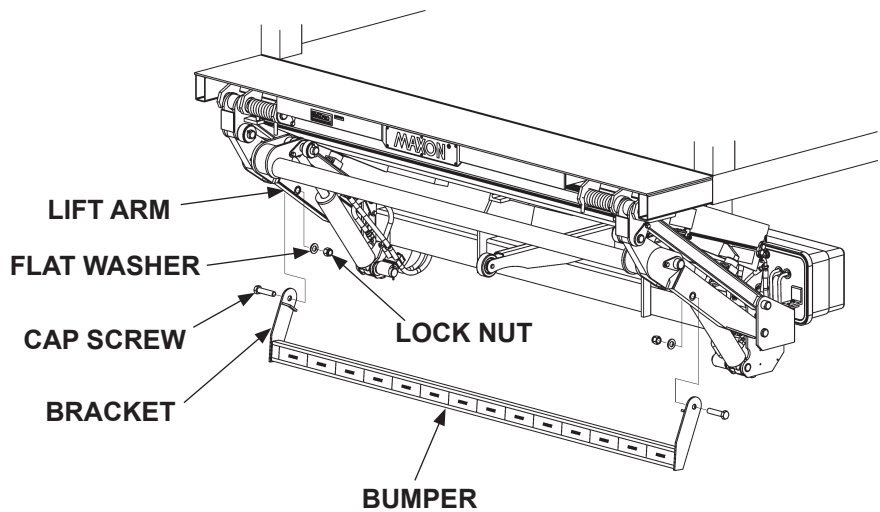

POSITIONING & BOLTING BUMPER TO LIFT ARMS
FIG. 2-2

NOTE: If installed correctly, there should be approximately a 90 degree angle between the face of the bumper and the ground when platform is stowed.

4. Position bumper as required. For GPT Liftgates, refer to **FIG. 3-1**. See **FIG. 3-2** for GPTWR Liftgates.

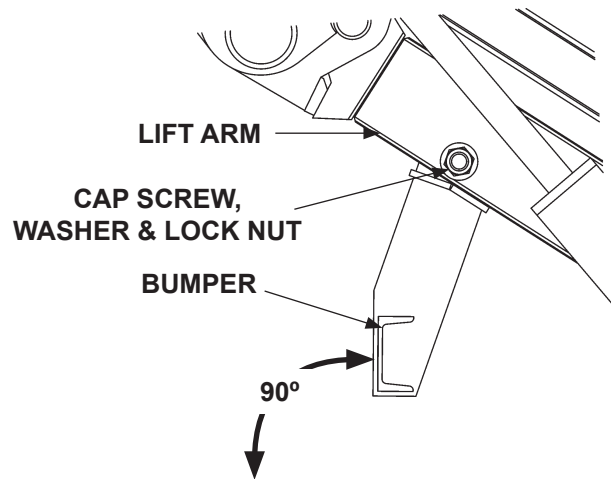

**BUMPER POSITION FOR GPT LIFTGATES
FIG. 3-1**

5. Tighten the cap screw and lock nut, on RH and LH side of the bumper securely to keep bumper in correct position (**FIGS. 3-1 and FIG. 3-2**). Torque both cap screws and lock nuts to **105 lb.-ft.**

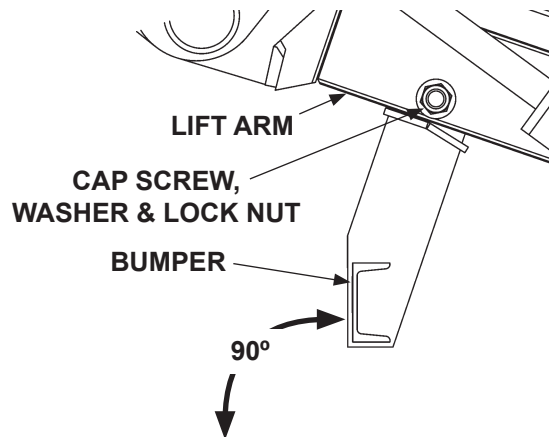

**BUMPER POSITION FOR GPTWR LIFTGATES
FIG. 3-2**

6. Lower and raise the platform to ensure there is no interference between bumper and the Liftgate (**FIG. 4-1**).

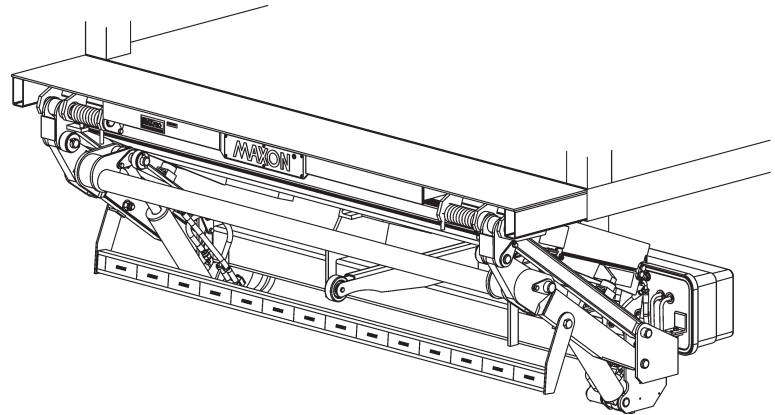

PLATFORM IN STOWED POSITION
FIG. 4-1