

INSTRUCTION, BATTERY BOX & FRAME INSTALLATION KIT

2-BATTERY BOX KIT

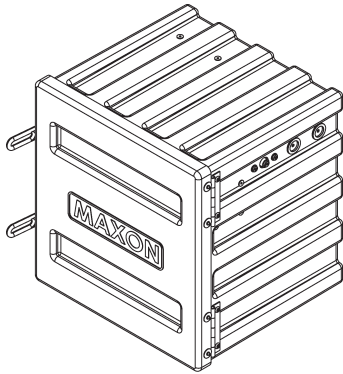

BATTERY BOX ASSEMBLY
P/N 269560-01
QTY. 1

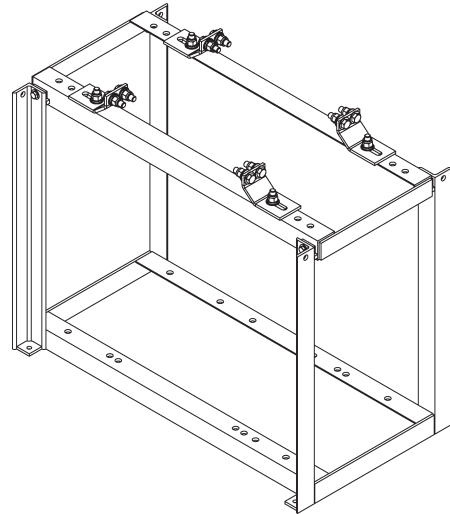

SINGLE FRAME ASSEMBLY
P/N 285720-11
P/N 285720-11G (GALVANIZED)
QTY. 1

3-BATTERY BOX KIT

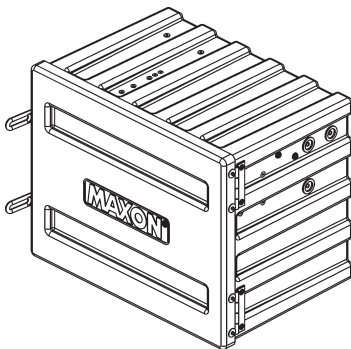

BATTERY BOX ASSEMBLY
P/N 269950-01
QTY. 1

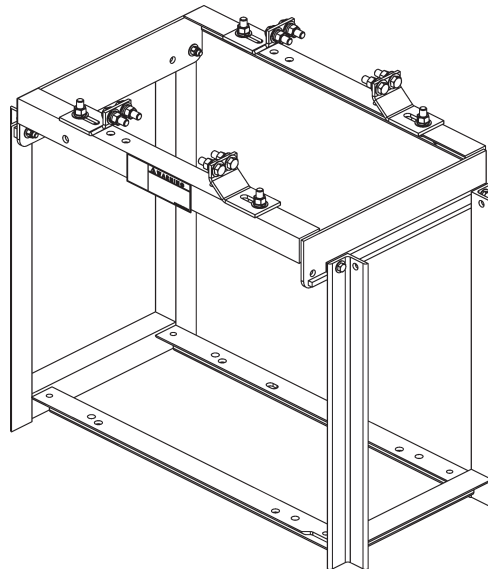

SINGLE FRAME ASSEMBLY
P/N 287929-01G (GALVANIZED)
QTY. 1

1. Select holes on top of battery box frame to align mounting brackets flush to cross members. Refer to **FIGS. 2-1 & 2-1A** for trailers and **FIG. 2-2** for trucks. Bolt mounting brackets to battery box frame as shown in **FIG. 2-1B**. Torque each bolt and lock nut to **85-128 lb-ft.**

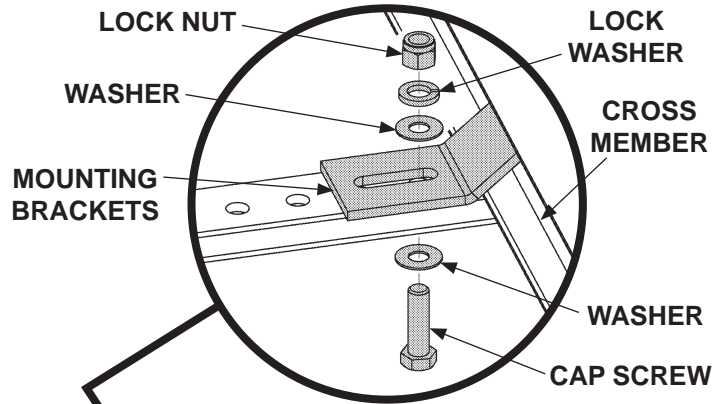

**BOLTING BRACKETS
(4 PLACES)
FIG. 2-1B**

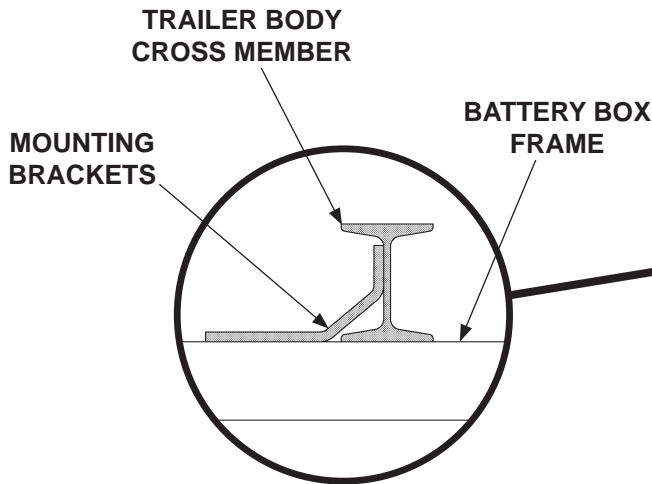

**FLUSH BRACKETS FOR
TRAILERS (4 PLACES)
FIG. 2-1A**

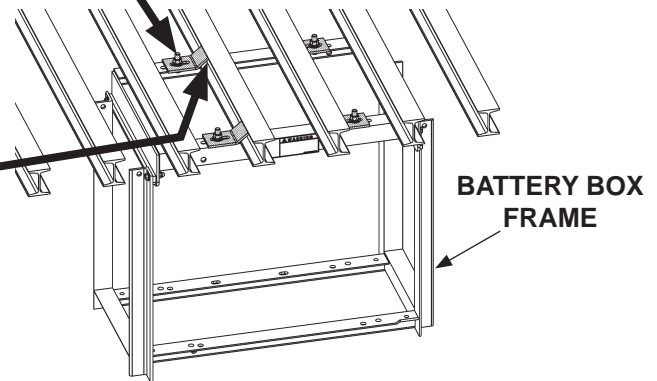

**ALIGNING BATTERY BOX FRAME
(TRAILER SHOWN)
FIG. 2-1**

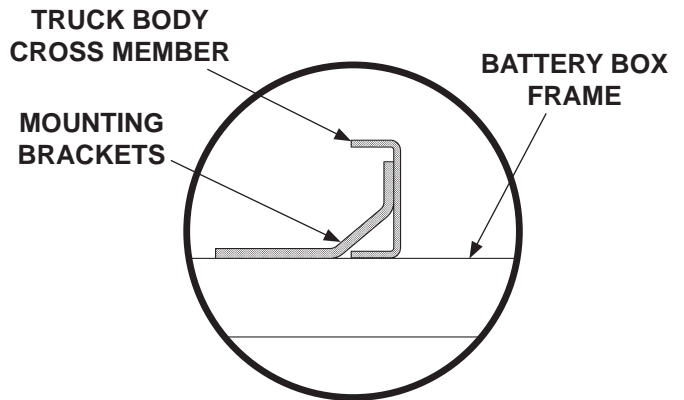

**FLUSH BRACKETS FOR
TRUCKS (8 PLACES)
FIG. 2-2**

NOTE: If welding mounting brackets to cross members, skip instruction 2.

- Using mounting brackets as a template, mark and drill holes through cross members (**FIG. 3-1**). Bolt mounting brackets to cross members as shown in **FIGS. 3-2 and 3-2A**. Torque bolts and lock nuts to **85-128 lb-ft.**

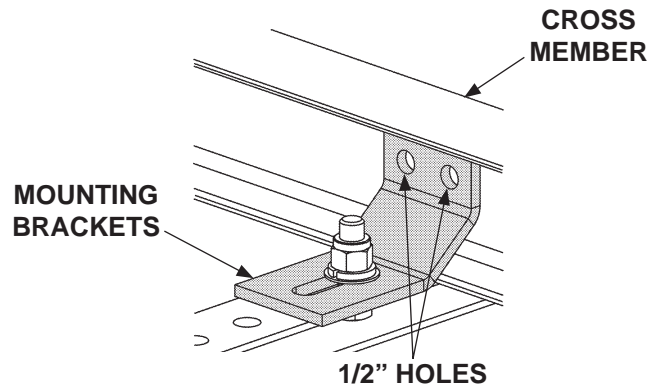

MARK AND DRILL
FIG. 3-1

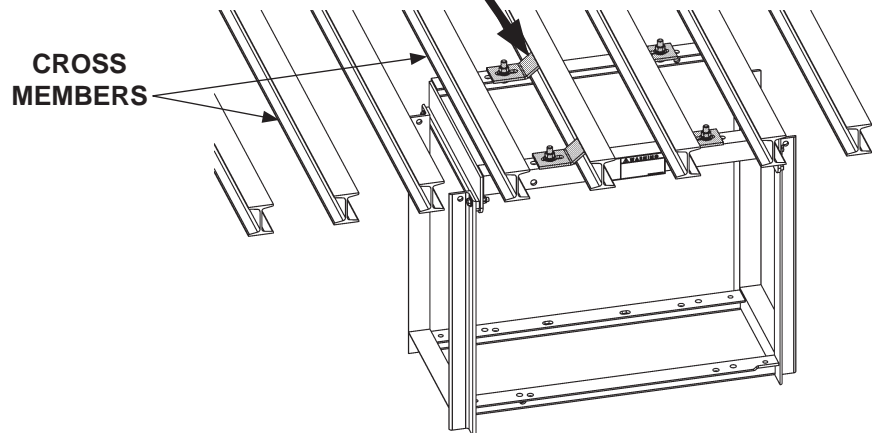
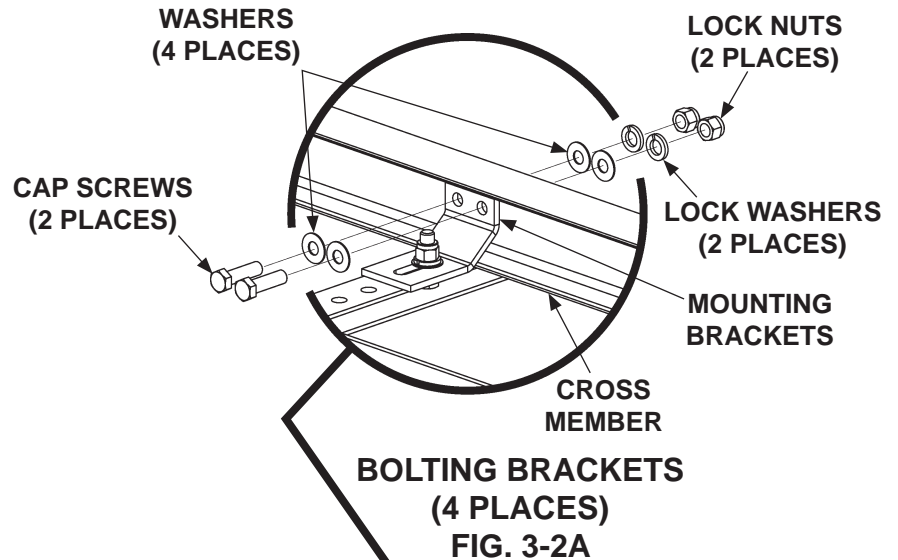

BOLTING BATTERY BOX FRAME
FIG. 3-2

! WARNING

Recommended practices for welding on steel parts are contained in the current AWS (American Welding Society) D1.1 Structural Welding Code - Steel. Damage to Liftgate and/or vehicle, and personal injury can result from welds that are done incorrectly.

CAUTION

To prevent pump box components from being damaged by electric current from welding, connect welder grounding cable to the part being welded.

CAUTION

Cover battery box with flame-resistant covering before welding pump box frame to vehicle.

3. For galvanized frame, read warning decal shown in **FIGS. 4-1 and FIGS. 4-1A** before welding. Weld each bracket to cross members as shown in **FIGS. 4-1 and 4-1B**. Weld top of bracket if accessible.

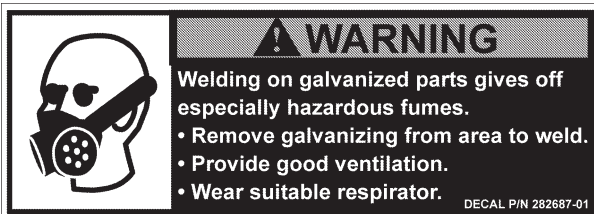
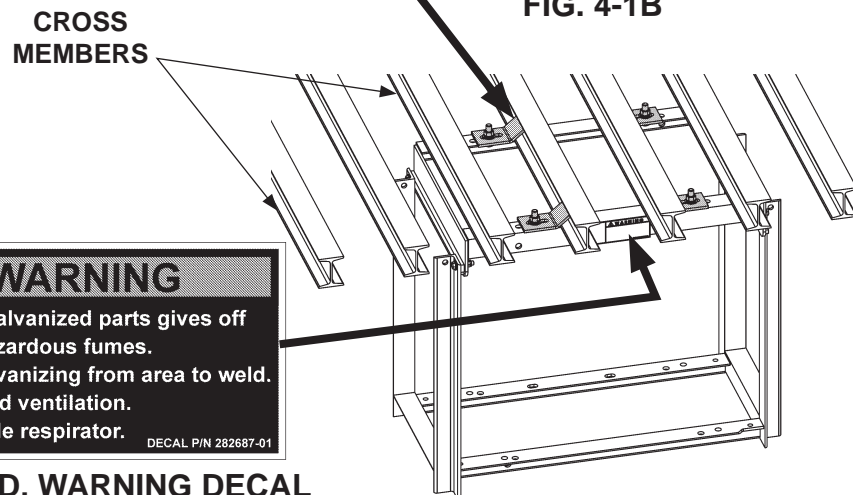
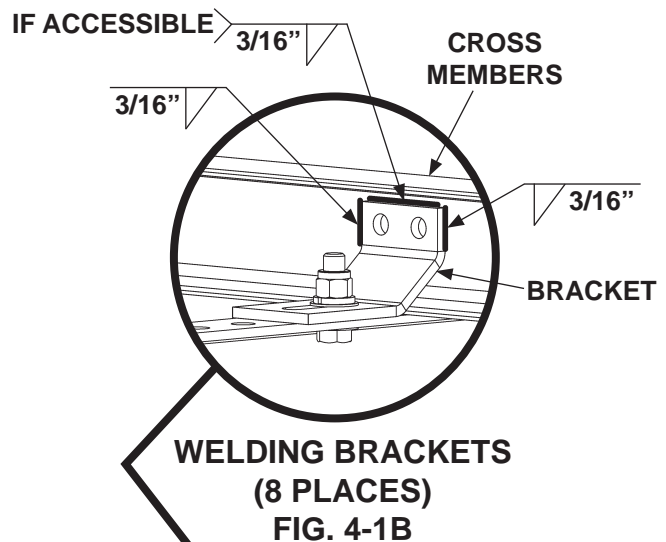

WELDING GALVANIZED, WARNING DECAL
FIG. 4-1A

BOLTING BATTERY BOX FRAME
FIG. 4-1

⚠ WARNING

Explosive hydrogen gas from charging batteries can accumulate in battery box if not vented from the box. To prevent hydrogen gas from accumulating, ensure the 3 ventilation holes in battery box are not plugged or covered.

4. Bolt battery box to battery box frame as shown in **FIG. 5-1**. Torque bolts and hex nuts to **50 lb-ft**. Ensure ventilation holes are not covered or plugged (**FIG. 5-1**).

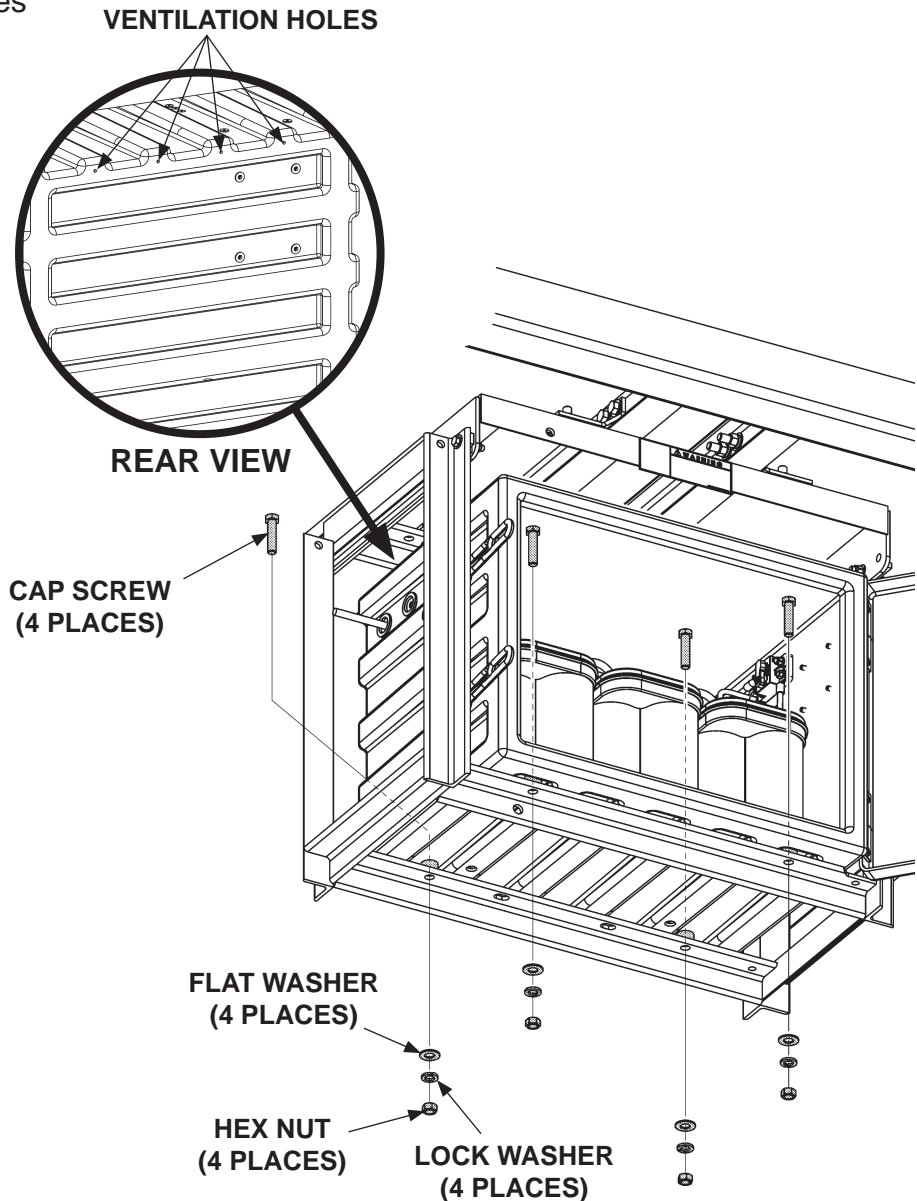

**BOLTING BATTERY BOX
(3 BATTERY BOX SHOWN)
FIG. 5-1**

⚠ WARNING

Remove all rings, watches and jewelry before doing any electrical work.

5. Attach battery plate, batteries, battery strap, and j-bolt tie-downs in battery box as shown in **FIG. 6-1 (2 Battery Box)** and **FIG. 7-1 (3 Battery Box)**. Continue with step 6 to connect electrical cables and 150 amp circuit breaker.

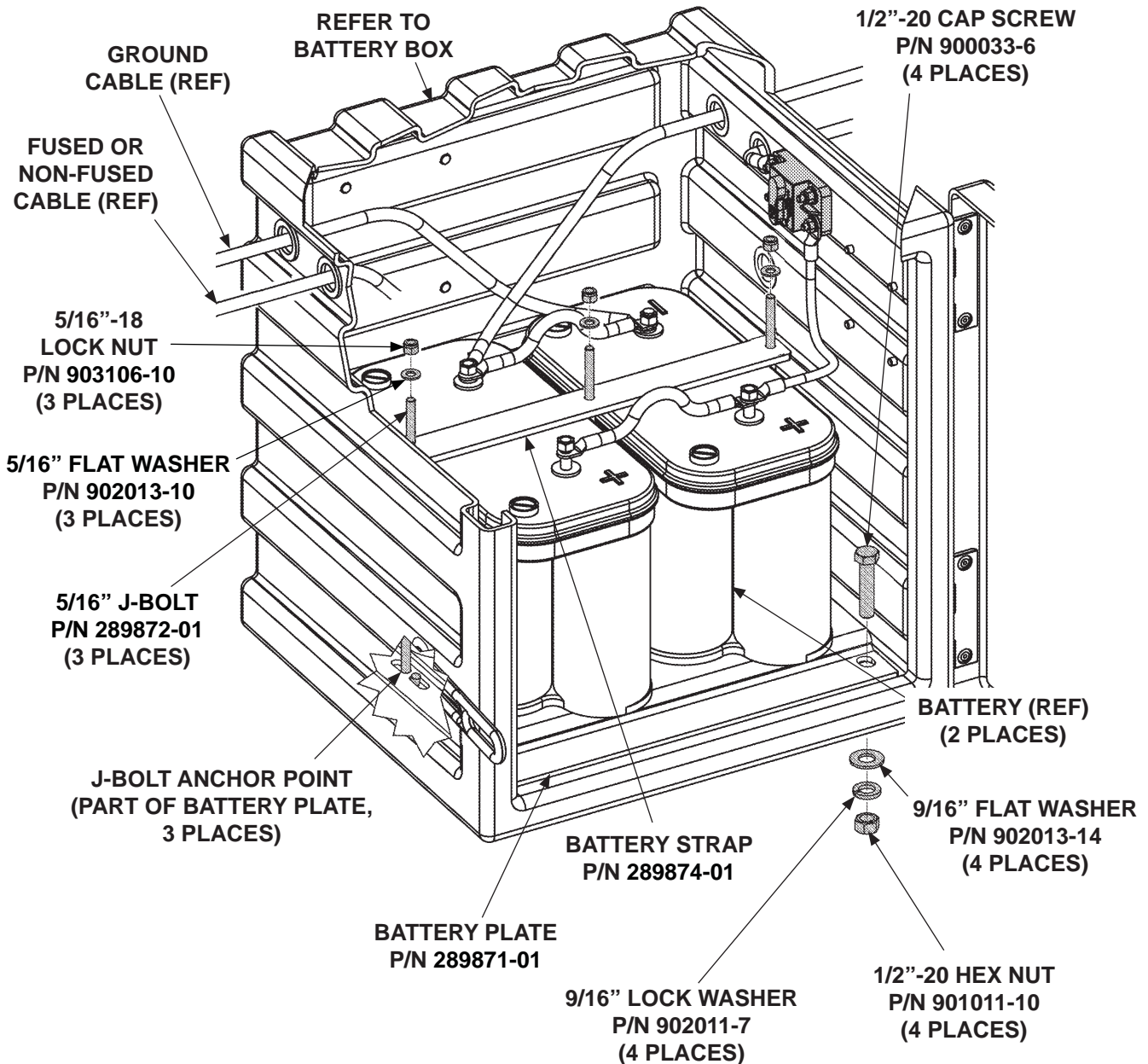

**2 BATTERY BOX ASSEMBLY
FIG. 6-1**

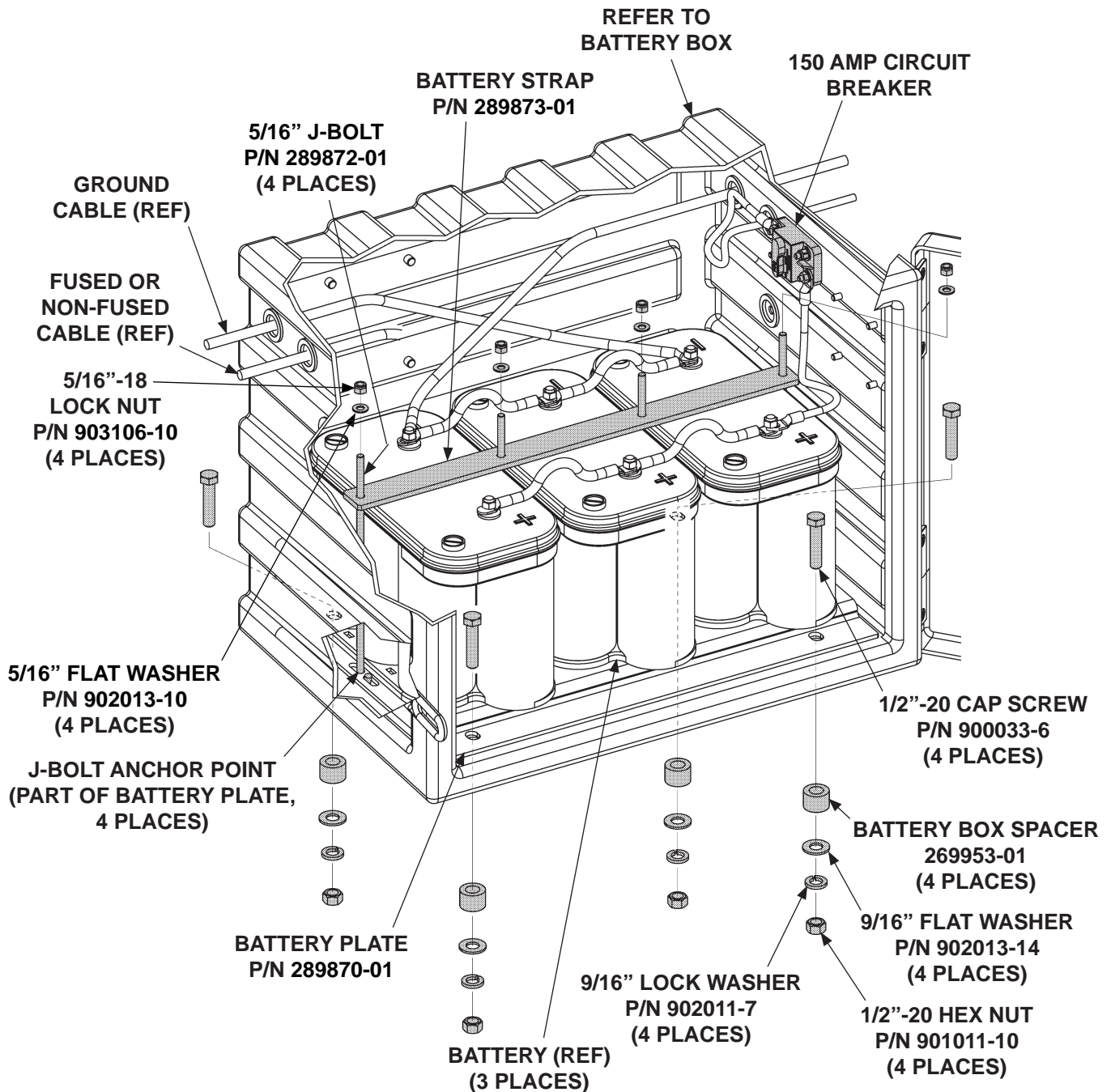

**3 BATTERY BOX ASSEMBLY
FIG. 7-1**

NOTE:

- Always connect fused end of power cable to battery positive (+) terminal.
- To connect charge lines, refer to instructions provided with each charge line kit.
- **MAXON** recommends using dielectric grease on all electrical connections.

6. Connect cables as shown in **FIG. 8-1 (2 Battery Box)** or **FIG. 9-1 (3 Battery Box)**. Refer to Liftgate installation manual for instructions to install additional electrical cables or circuit breaker. Cable P/N 251871-05 (2 gauge 16" long) is included with battery box to set up 24 vdc power if required.

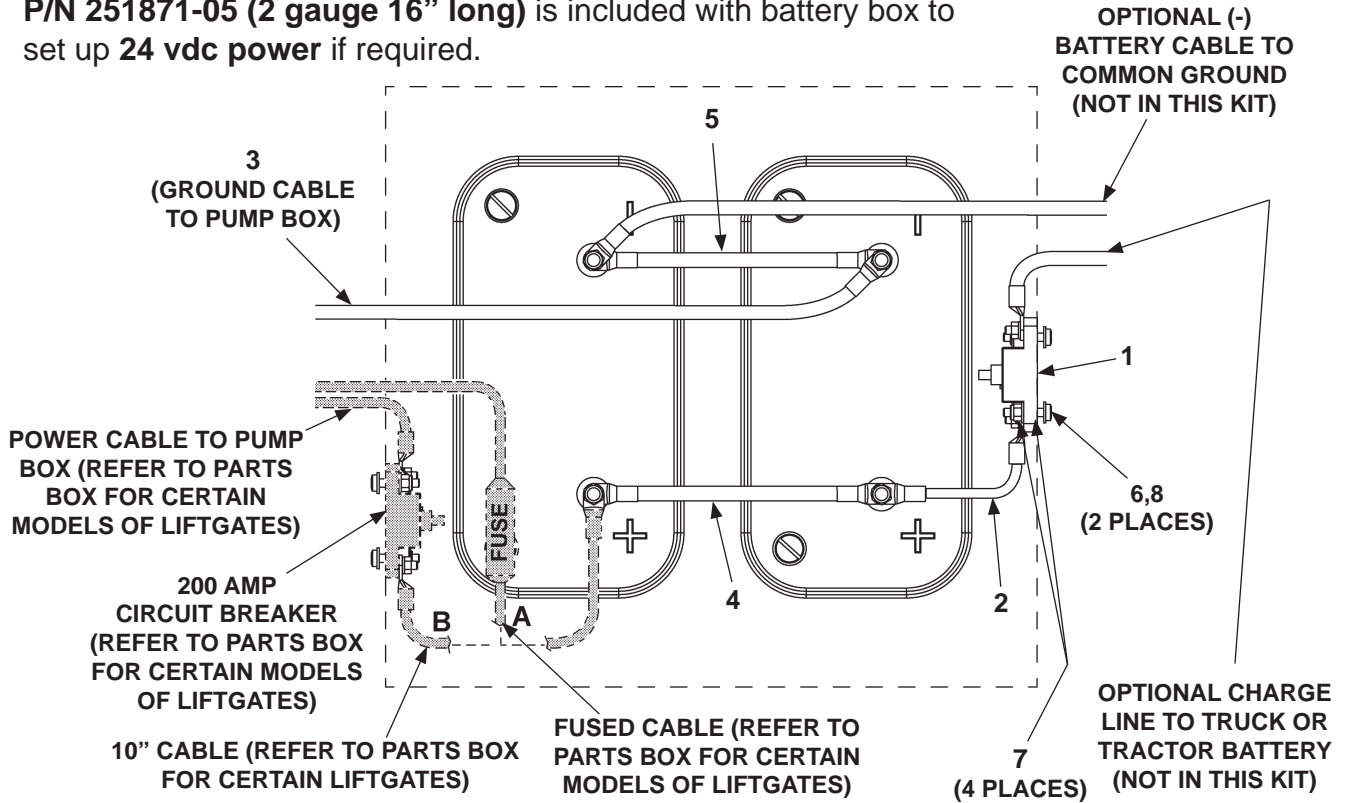

ITEM	QTY	PART NO.	DESCRIPTION
1	1	907207-01	CIRCUIT BREAKER, 150 AMP
2	1	269308-12	CABLE ASSEMBLY, 2 GA, RED, 12" LG.
3	1	268226-06	CABLE ASSEMBLY, 2 GA, 74" LG.
4	1	269308-10	CABLE ASSEMBLY, 2 GA, RED, 10" LG.
5	1	251871-14	CABLE ASSEMBLY, 2 GA, 10" LG. (BLACK)
6	2	900002-5	PAN HEAD SCREW, 1/4"-20 X 1-1/4" LG.
7	4	902013-09	FLAT WASHER, 1/4"
8	2	901000	LOCK NUT, 1/4"-20

BATTERY BOX ELECTRICAL PARTS (2 BATTERY BOX)
TABLE 8-1

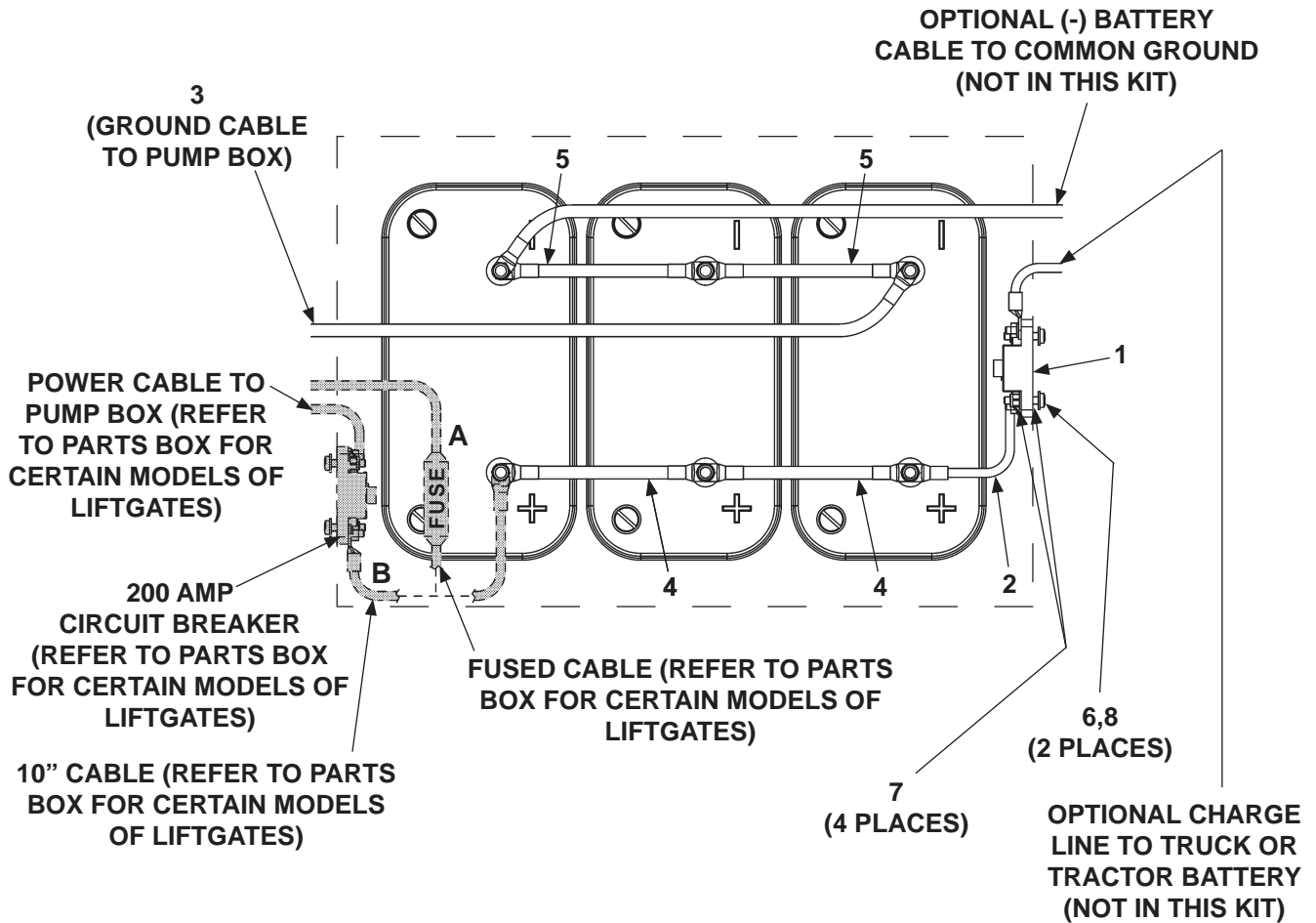

12 VOLT BATTERY CONNECTIONS (3 BATTERY BOX)
FIG. 9-1

ITEM	QTY	PART NO.	DESCRIPTION
1	1	907207-01	CIRCUIT BREAKER, 150 AMP
2	1	269308-12	CABLE ASSEMBLY, 2 GA, RED, 12" LG.
3	1	268226-06	CABLE ASSEMBLY, 2 GA, 74" LG.
4	2	269308-10	CABLE ASSEMBLY, 2 GA, RED, 10" LG.
5	2	251871-14	CABLE ASSEMBLY, 2 GA, 10" LG. (BLACK)
6	2	900002-5	PAN HEAD SCREW, 1/4"-20 X 1-1/4" LG.
7	4	902013-09	FLAT WASHER, 1/4"
8	2	901000	LOCK NUT, 1/4"-20

BATTERY BOX ELECTRICAL PARTS (3 BATTERY BOX)
TABLE 9-1

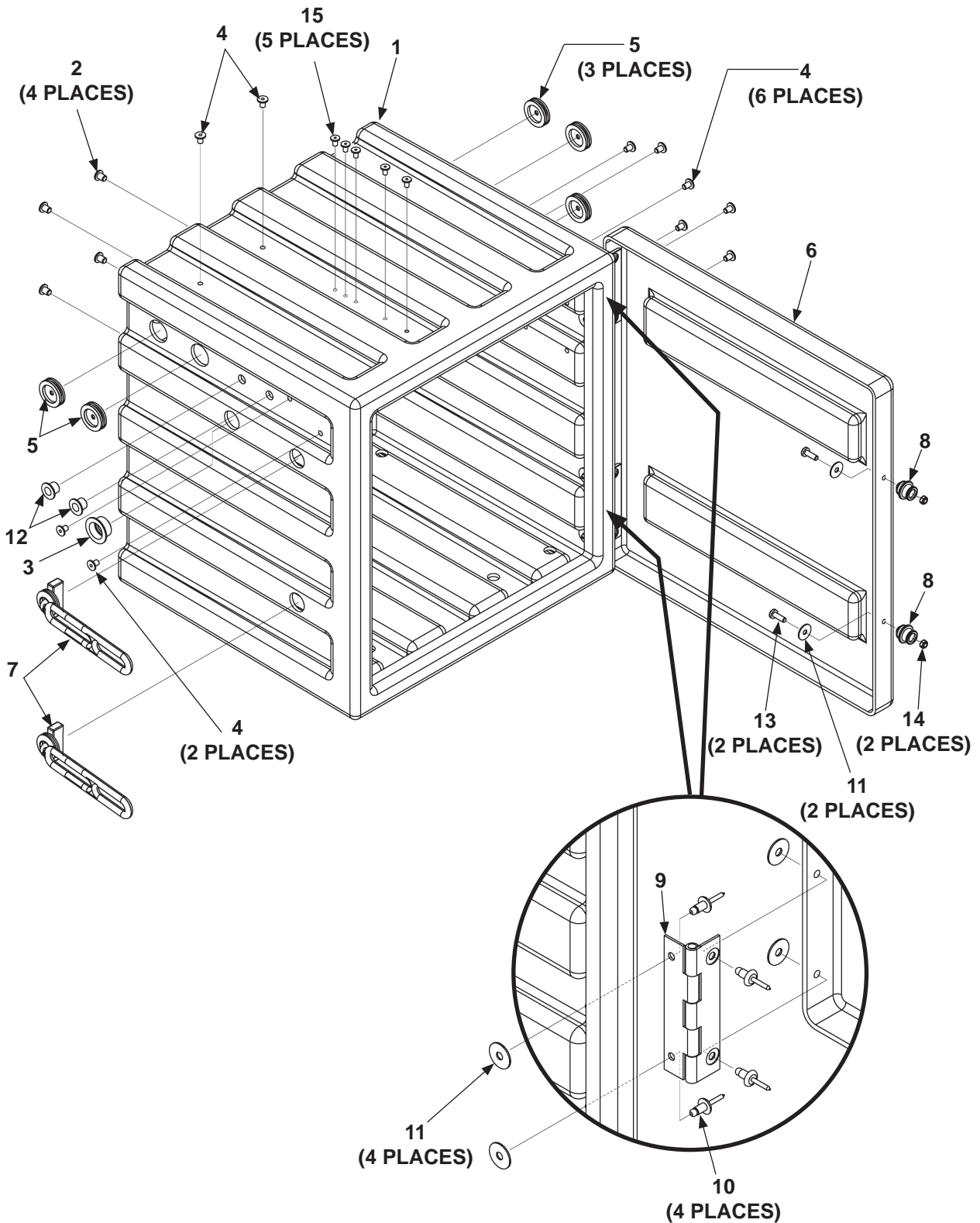

BATTERY BOX PARTS (2 BATTERY BOX)
FIG. 10-1

ITEM	QTY	PART NO.	DESCRIPTION
REF	1	269561-01	BATTERY BOX ASSEMBLY
1	1	289854-01	BATTERY BOX (WITH HOLES)
2	4	908022-03	FLEXIBLE PLUG, 5/16"
3	1	908022-08	FLEXIBLE PLUG, 1-1/16"
4	10	908022-07	FLEXIBLE PLUG, 1/4"
5	5	266428-02	GROMMET, 1" DIAPHRAGM, 1/4" HOLE
6	1	269558-01	COVER
7	2	908193-01	RUBBER LATCH
8	2	908194-01	FASTENING KNOB
9	2	285970-01	PLASTIC HINGE ASSEMBLY
10	8	903715-03	BLIND RIVET, 1/4" X 1/4"-3/8"
11	10	903438-01	WASHER, 1/4"
12	2	908022-05	FLEXIBLE PLUG, 9/16"
13	2	900719-07	BUTTON HEAD SCREW, 1/4"-20 X 1" LG.
14	2	903137-01	LOCK NUT, 1/4"-20, NYLON
15	5	908022-01	FLEXIBLE PLUG, 1/4"

**BATTERY BOX PARTS (2 BATTERY BOX)
TABLE 11-1**

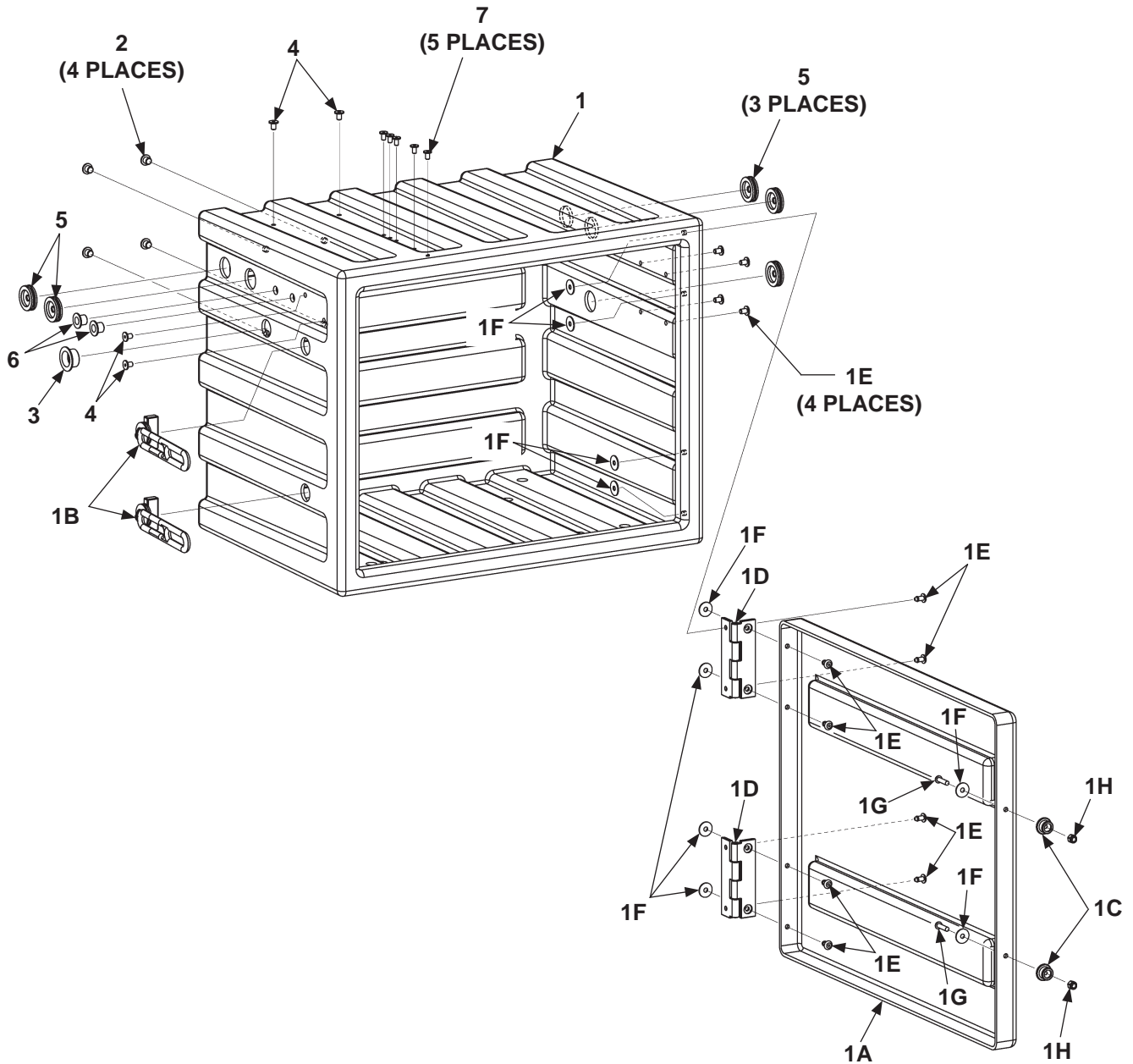

BATTERY BOX PARTS (3 BATTERY BOX)
FIG. 12-1

ITEM	QTY	PART NO.	DESCRIPTION
REF	1	269950-01	BATTERY BOX ASSEMBLY
1	1	269951-01	3 BATTERY BOX, PLASTIC
1A	1	269955-01	COVER, 3 BATTERY BOX
1B	2	908193-01	RUBBER LATCH
1C	2	908194-01	FASTENING KNOB
1D	2	285970-01	PLASTIC HINGE ASSEMBLY
1E	8	903715-04	BLIND RIVET, 1/4" X 3/8"-1/2"
1F	10	903438-01	WASHER, 1/4"
1G	2	900719-07	BUTTON HEAD SCREW, 1/4"-20 X 1" LG.
1H	2	903137-01	LOCK NUT, 1/4"-20, NYLON
2	4	908022-03	FLEXIBLE PLUG, 3/8"
3	1	908022-08	FLEXIBLE PLUG, 1-1/16"
4	8	908022-07	FLEXIBLE PLUG, 1/4"
5	5	266428-04	GROMMET, 1" DIAPHRAGM, 3/8" HOLE
6	2	908022-05	FLEXIBLE PLUG, 9/16"
7	5	908022-01	FLEXIBLE PLUG, 1/4"

**BATTERY BOX PARTS (3 BATTERY BOX)
TABLE 13-1**

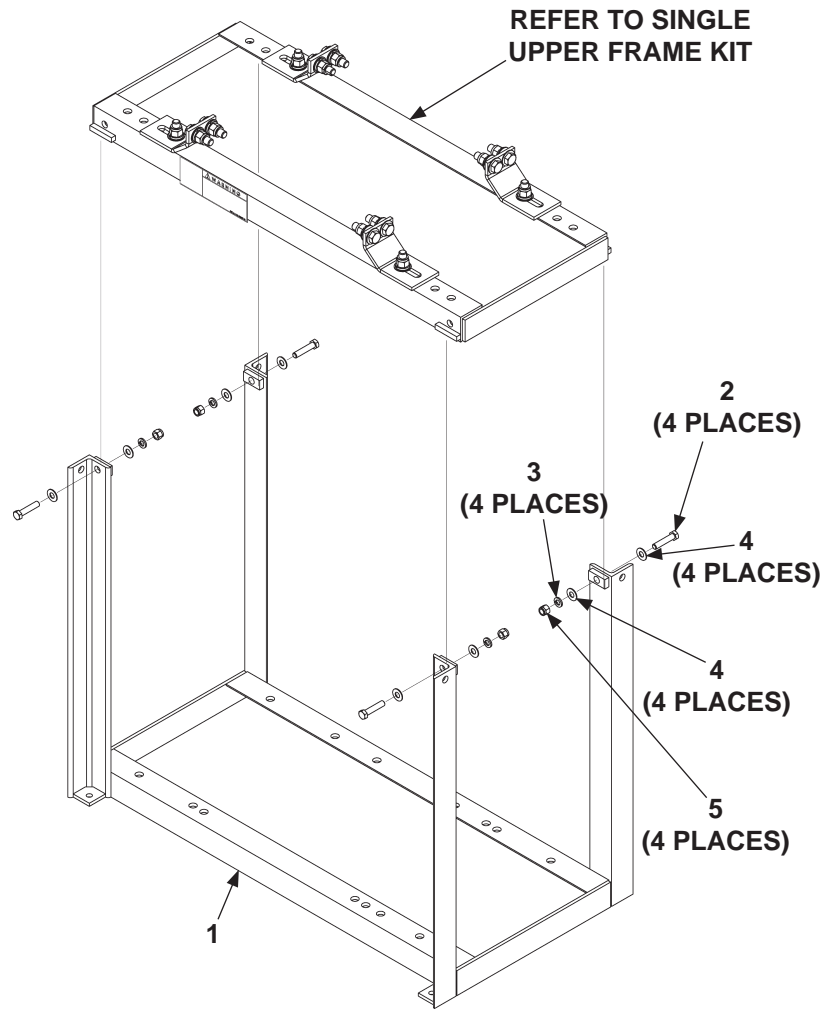

SINGLE FRAME ASSEMBLY PARTS (2 BATTERY BOX)
FIG. 14-1

ITEM	QTY	PART NO.	DESCRIPTION
REF	1	285720-11	SINGLE FRAME ASSEMBLY
		285720-11G	SINGLE FRAME ASSEMBLY (GALVANIZED)
1	1	285724-11	SINGLE FRAME WELDMENT
		285724-11G	SINGLE FRAME WELDMENT (GALVANIZED)
2	4	900014-7	HEX HEAD CAP SCREW, 3/8"-16 X 1-3/4" LG, GR8
3	4	902011-4	LOCK WASHER, 3/8"
4	8	903409-03	FENDER WASHER, 13/32"
5	4	901002	LOCK NUT, 3/8"-16

SINGLE FRAME ASSEMBLY PARTS (2 BATTERY BOX)
TABLE 14-1

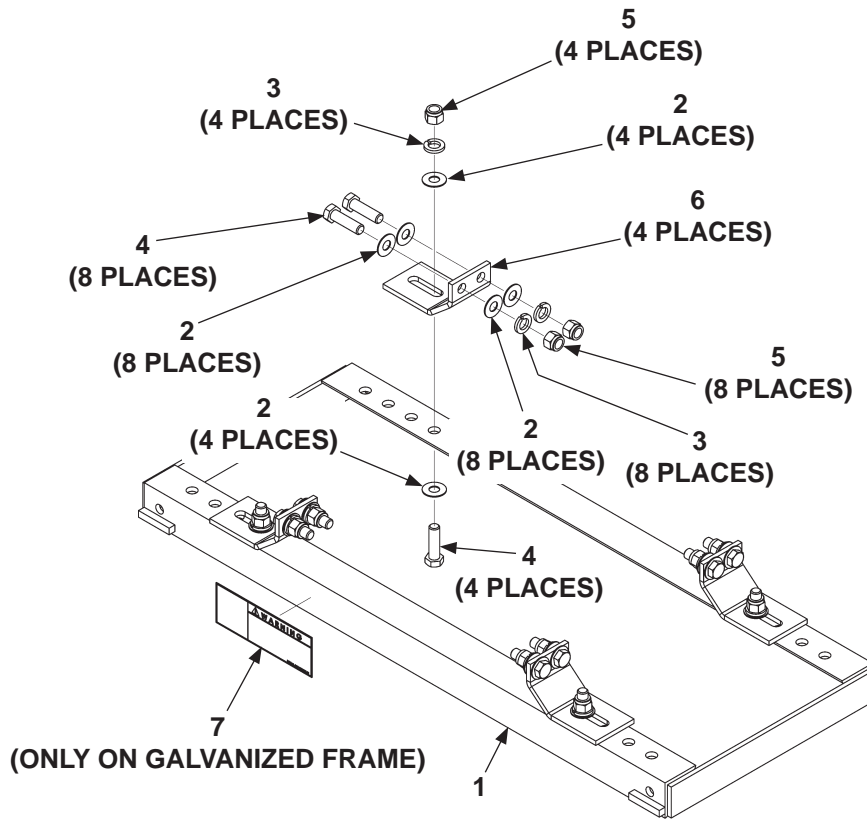

**SINGLE UPPER FRAME KIT (2 BATTERY BOX)
FIG. 15-1**

ITEM	QTY	PART NO.	DESCRIPTION
REF	1	285725-01	SINGLE UPPER FRAME KIT
		285725-01G	SINGLE UPPER FRAME KIT (GALVANIZED)
1	1	285726-01	SINGLE UPPER FRAME WELDMENT
		285726-01G	SINGLE UPPER FRAME WELDMENT (GALVANIZED)
2	24	903409-04	FENDER WASHER, 1/2"
3	12	902011-7	LOCK WASHER, 9/16"
4	12	900033-4	CAP SCREW, 1/2"-20 X 1-3/4" LG, GR8
5	12	901008	LOCK NUT, 1/2"-20
6	4	285837-01	MOUNTING BRACKET
7	1	282687-01	WARNING DECAL, WELD ON GALVANIZED

**SINGLE UPPER FRAME KIT (2 BATTERY BOX)
TABLE 15-1**

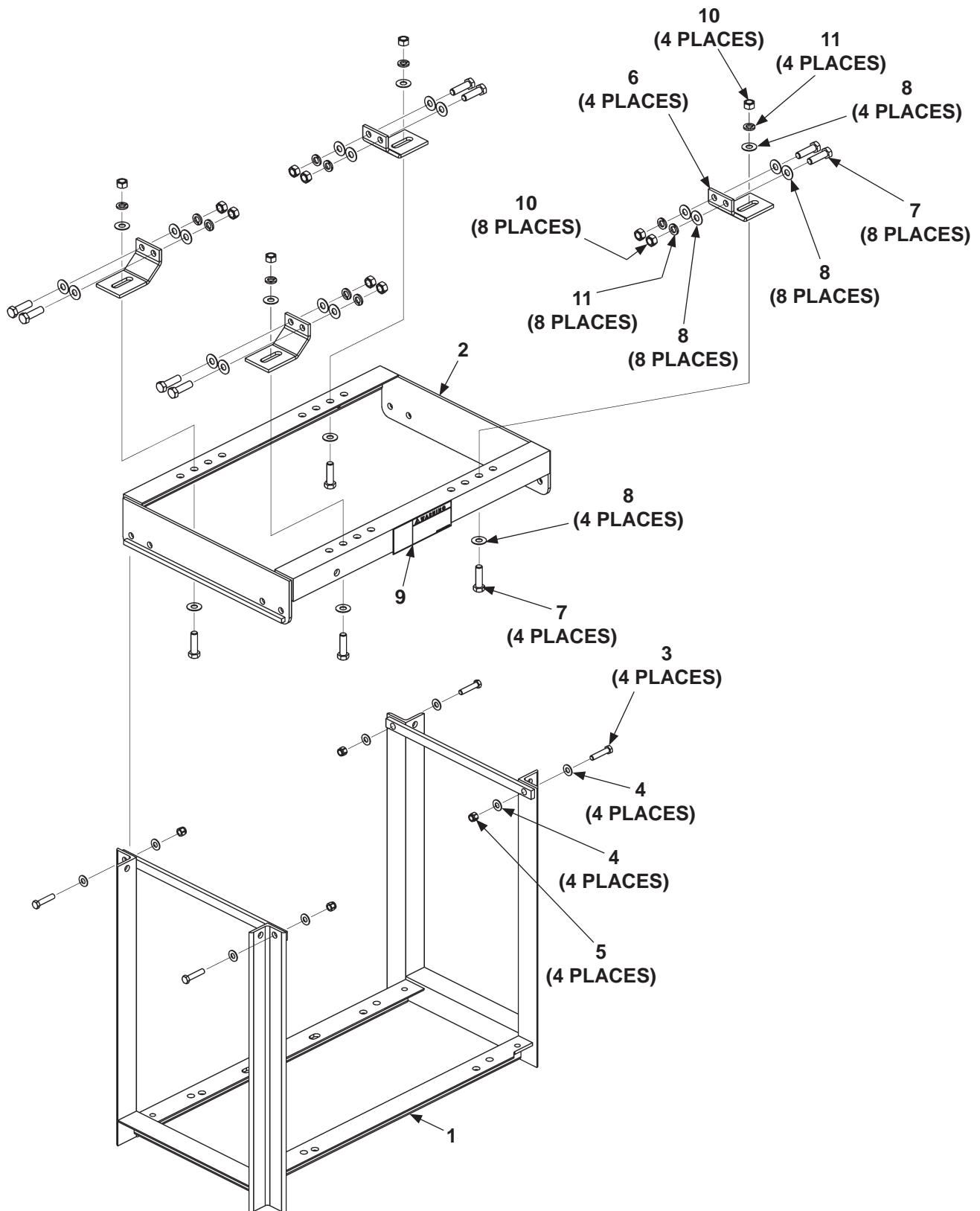

**SINGLE FRAME ASSEMBLY PARTS (3 BATTERY BOX)
FIG. 16-1**

ITEM	QTY	PART NO.	DESCRIPTION
REF	1	287929-01G	SINGLE FRAME ASSEMBLY (GALVANIZED)
1	1	287925-01G	SINGLE FRAME
2	1	287928-01G	SINGLE UPPER FRAME
3	4	900014-7	HEX HEAD CAP SCREW, 3/8"-16 X 1-3/4" LG, GR8
4	8	903409-03	FENDER WASHER, 7/8"
5	4	901002	LOCK NUT, 3/8"-16
6	4	285837-01	MOUNTING BRACKET
7	12	900035-4	CAP SCREW, 1/2"-13 X 1-3/4" LG.
8	24	903409-04	FENDER WASHER, 1/2"
9	1	282687-01	WARNING DECAL, WELD ON GALVANIZED
10	12	901011-9	HEX NUT, 1/2"-13
11	12	902011-6	LOCK WASHER, 1/2"

**SINGLE FRAME ASSEMBLY PARTS (3 BATTERY BOX)
TABLE 17-1**