

M-09-25
REV. B
AUGUST 2012

MAXON[®] CONVENTIONAL LIFTGATE SERIES

GPC-22, GPC-33 & GPC-44

OPERATION MANUAL

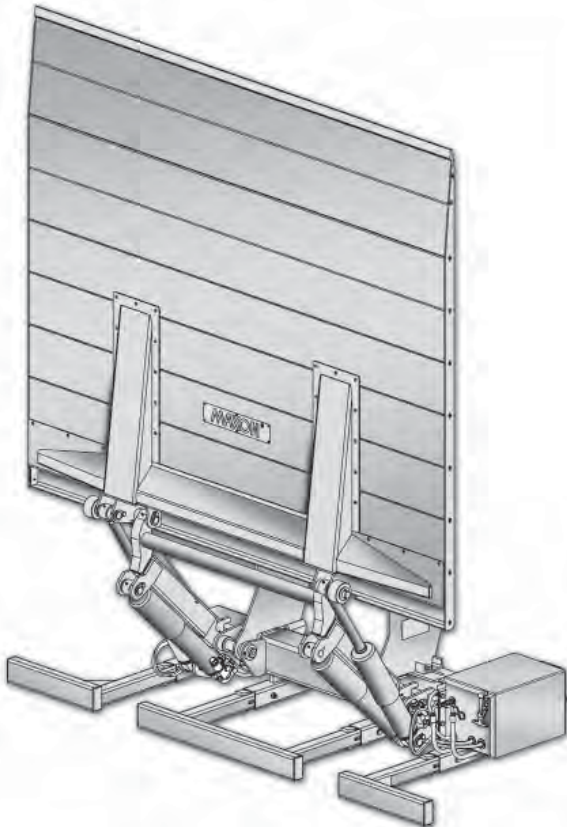

KEEP THIS MANUAL IN CAB OF VEHICLE

Register your liftgate on line at www.maxonlift.com/htm/services/reg.htm.

For a free copy of other manuals that pertain to these liftgate models, please visit our website at www.maxonlift.com or call Customer Service at (800) 227-4116.

© MAXON Lift Corp. 2012

TABLE OF CONTENTS

WARNINGS	4
LIFTGATE TERMINOLOGY	5
RECOMMENDED DAILY OPERATION CHECKS	6
DECALS	8
FORKLIFT ADVISORY	12
OPERATION	13

WARNING

1. Incorrect operation of this Liftgate can result in serious personal injury. Comply with **WARNINGS** and Liftgate operating instructions in this manual. Do not allow untrained persons or children to operate the Liftgate. If you need to replace an **Operation Manual**, additional copies are available from:

MAXON Lift Corp.
11921 Slauson Ave
Santa Fe Springs, CA 90670
(800) 227-4116

NOTE: For latest version manuals (and replacements), download manuals from Maxon's website at **www.maxonlift.com**.

2. Do not exceed rated load capacity of the Liftgate, which is **2200 lbs. for the GPC-22, 3300 lbs. for the GPC-33, and 4400 lbs. for the GPC-44**
3. Do not allow any part of your body to be placed under, within, or around any portion of the moving Liftgate or its mechanisms, or in a position that would trap them between the platform and the floor of truck body (or between platform and the ground) when Liftgate is operating.
4. Consider the safety and location of bystanders and location of nearby objects when operating the Liftgate. Stand to one side of platform while operating the Liftgate. Be certain that the area the Liftgate will move through during operation is clear of all obstacles.
5. Comply with all attached instruction decals and warning decals.
6. Keep decals clean and legible. If decals are illegible or missing, have them replaced. **Get free replacement decals from Maxon.**
7. **Never drive a forklift on the Liftgate platform.**
8. Do not move vehicle unless Liftgate is correctly stowed.
9. **Correctly stow platform when not in use. Extended platforms could create a hazard for people and vehicles passing by.**
10. A correctly installed Liftgate will operate smoothly and reasonably quiet. The only noticeable noise, during Liftgate operation, is from the power unit while the platform is raised. Listen for scraping, grating and binding noises and have the problem corrected before continuing to operate the Liftgate.
11. Above all, **USE GOOD COMMON SENSE** when operating the Liftgate.
12. Never use a cell phone while operating the Liftgate.

LIFTGATE TERMINOLOGY

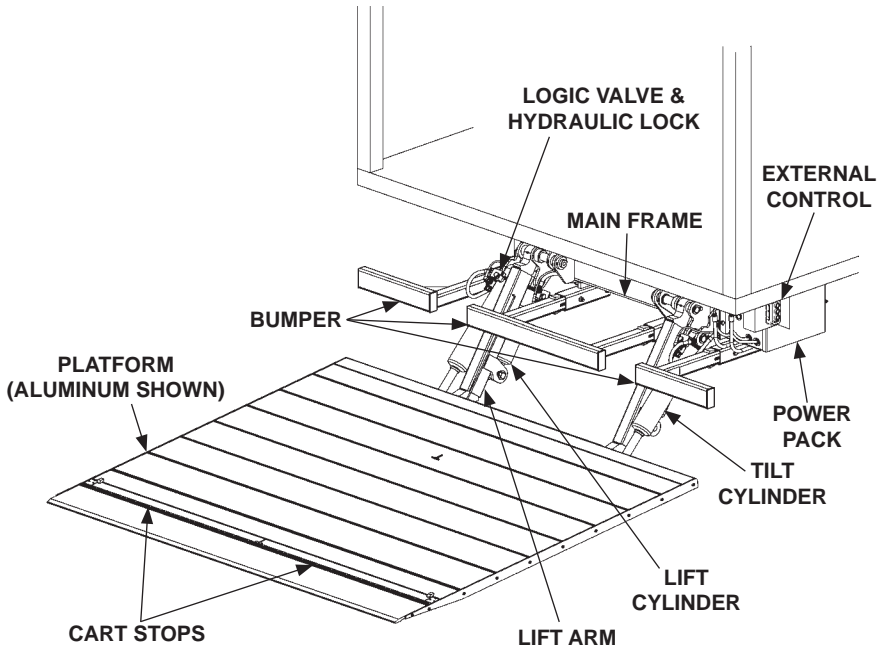

RECOMMENDED DAILY OPERATION CHECKS

NOTE: Before you check the Liftgate, park vehicle on flat ground and set the parking brake.

NOTE: If any of the following operation checks reveal a need to service or repair Liftgate, do not operate the Liftgate until a qualified mechanic services or repairs the Liftgate.

Before operating the Liftgate, the operator should do the following:

- Make sure battery is fully charged and battery terminal connections are clean and tight.
- Make sure cab cutoff switch is **ON**, if equipped.
- Visually check that pump cover is latched closed securely and undamaged. Look for hydraulic fluid leaking from the pump box.
- Visually check that external control switch, 2-hand operation switch, and internal operation switch are in place and undamaged.
- Visually check that hydraulic locks are in place and undamaged.
- Visually check that all decals are in place (see **DECAL** pages). Also make sure decals are clean, legible, and undamaged.

Use the operation instructions in this manual to lower the Liftgate to the ground and open the platform and flipover.

- Check main frame and lift arms for cracks and bends. Also, make sure all bolts, nuts and pins are in place and undamaged.
- Make main frame and lift arms are clean (no oil, debris, or corrosion).
- Check the platform for cracks, holes, and bends on the load-carrying surface and side plates. Also, make sure fasteners are in place and undamaged.
- Make sure platform load-carrying surface is clean (no oil, debris, or corrosion).
- Check the hydraulic lift cylinders and tilt cylinders for leaking seals and hose connections. Follow the hydraulic hoses from the cylinders to power unit. Make sure all hoses are connected at both ends and there are no cracks, chafing, and fluid leaks.

Use the operation instructions in this manual to operate the Liftgate through one cycle without a load on the platform. Raise the platform to vehicle bed height. Next, lower the platform to ground level.

- When the Liftgate is moving, listen for unusual noises and look for a “jerking” motion or uneven movement on either side of the platform.

If service or repairs are not required (or if completed), stow the Liftgate.

THIS PAGE INTENTIONALLY LEFT BLANK

DECALS

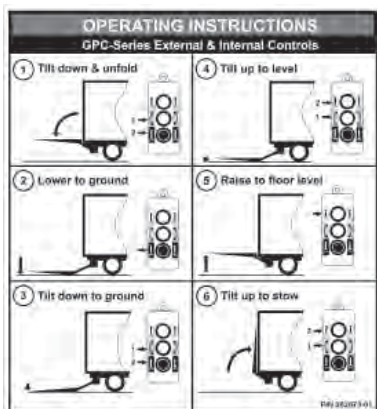

**OPERATION INSTRUCTIONS DECAL
(EXTERNAL & INTERNAL CONTROLS)
P/N 282673-01**

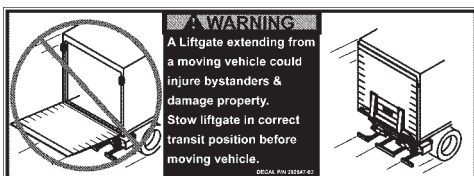

**WARNING DECAL
P/N 282847-03**

**CAPACITY DECAL
(SEE PAGE 10)**

DECAL "F"

DECAL "A"

DECAL "B"

**PLATFORM
LOAD DECAL
(SEE PAGE 11)**

DECAL "C"



**SERIAL PLATE
(REF)**

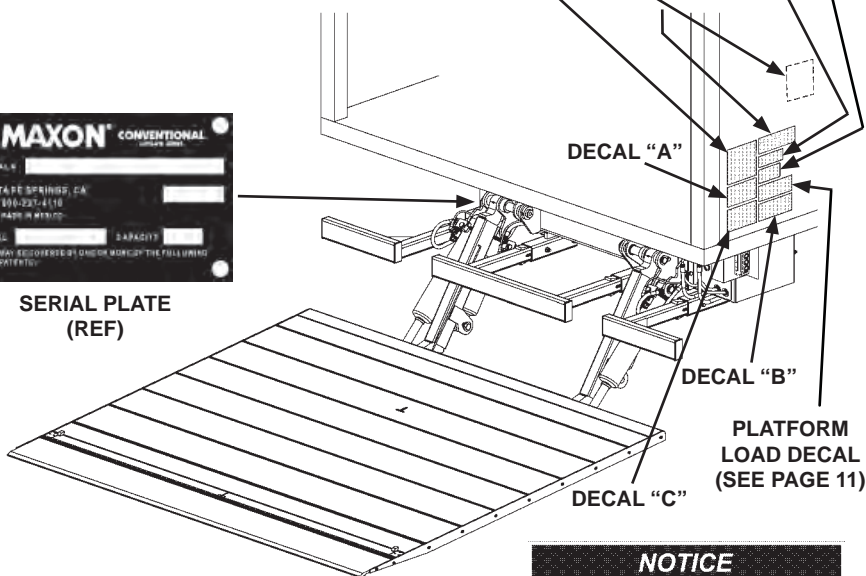

NOTE: Ensure there is no residue, dirt, or corrosion where decals are attached. If necessary, clean surface before attaching decals.

NOTICE
The REAR IMPACT GUARDS on this Liftgate are FMVSS-certified if Liftgate is installed correctly in accordance with the installation manual.

**NOTICE DECAL
(2 PLACES, MOUNTING PLATES)
P/N 282674-01**

FIG. 8-1

SAFETY INSTRUCTIONS

Read all decals and operation manual before operating liftgate.

1. Do not use liftgate unless you have been properly instructed and have read, and are familiar with, the operating instructions.
2. Be certain vehicle is properly and securely braked before using the liftgate.
3. Always inspect this liftgate for maintenance or damage before using it. Do not use liftgate if it shows any sign of damage or improper maintenance.
4. Do not overload.
5. Make certain the area in which the platform will open and close is clear before opening or closing the platform.
6. Make certain platform area, including the area in which loads may fall from platform, is clear before and at all times during operation of liftgate.
7. This liftgate is intended for loading and unloading of cargo only. Do not use this liftgate for anything but its intended use.

(A)

	<p>⚠ WARNING</p> <p>Liftgate hazards can result in crushing or falling.</p> <p>Keep hands and feet clear of pinch points.</p> <p>If riding liftgate, make sure load is stable and footing is solid.</p>
<p>Read and understand all instructions and WARNINGS before use.</p>	

(B)

⚠ WARNING

Read this information carefully.

- Improper operation of this Liftgate can result in serious personal injury. If you do not have a copy of the operating instructions, please obtain them from your employer, distributor, or lessor before you attempt to operate Liftgate.
- If there are signs of improper maintenance, damage to vital parts, or slippery platform surface, do not use the Liftgate until these problems have been corrected.
- If you are using a pallet jack, be sure it can be maneuvered safely.
- Do not operate a forklift on the platform.
- Do not allow any part of yours or your helper's body to be placed under, within, or around any portion of the moving Liftgate, or its mechanisms, or in a position that would trap them between the platform and the ground or truck when the Liftgate is operated.
- If a helper is riding the platform with you, make sure you are both doing so safely and that you are not in danger of coming in contact with any moving or potentially moving obstacles.
- **USE GOOD COMMON SENSE**
- If load appears to be unsafe, do not lift or lower it.

For a free copy of other manuals that pertain to this model Liftgate, please visit our website at www.maxonlift.com or call Customer Service at (800) 227-4116.

(C)

⚠ CAUTION

Always stand clear of platform area.

(E)

DECAL SHEET P/N 282522-01
FIG. 9-1

DECALS - Continued

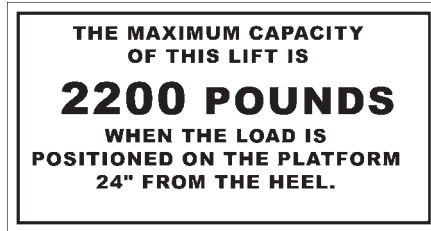

GPC-22 LIFT CAPACITY DECAL
P/N 282523-01
FIG. 10-1

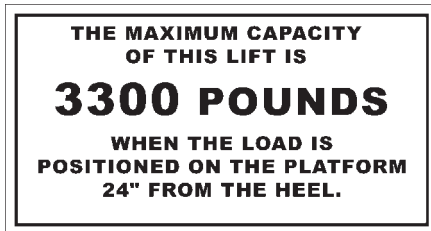

GPC-33 LIFT CAPACITY DECAL
P/N 282523-02
FIG. 10-2

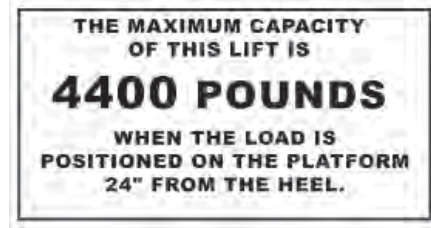

GPC-44 LIFT CAPACITY DECAL
P/N 282523-03
FIG. 10-3

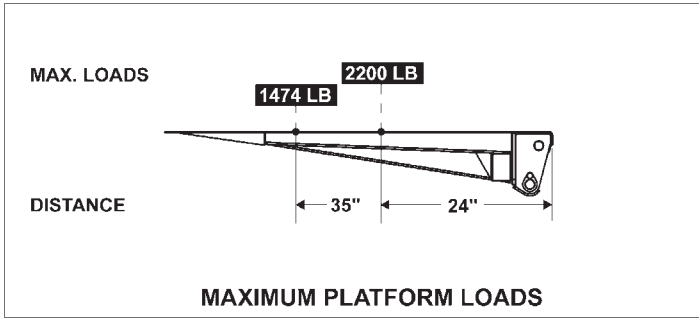

GPC-22 PLATFORM LOAD DECAL
P/N 282663-01
FIG. 11-1

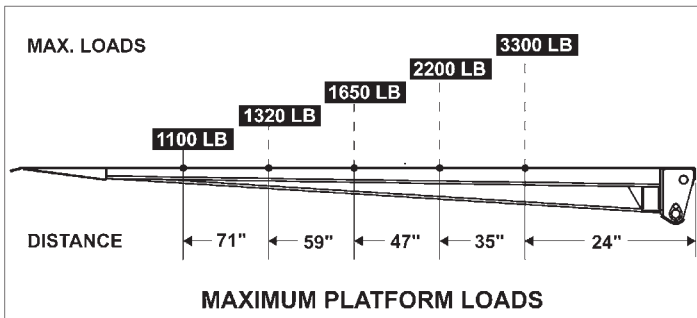

GPC-33 PLATFORM LOAD DECAL
P/N 282663-02
FIG. 11-2

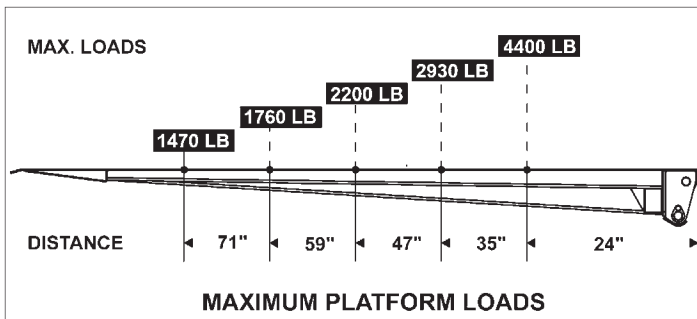

GPC-44 PLATFORM LOAD DECAL
P/N 282663-03
FIG. 11-3

FORKLIFT ADVISORY

⚠ WARNING
Keep forklift OFF of platform.

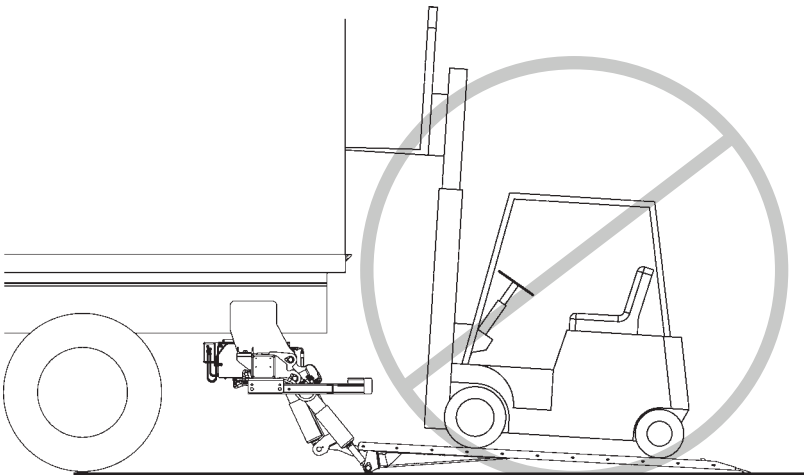
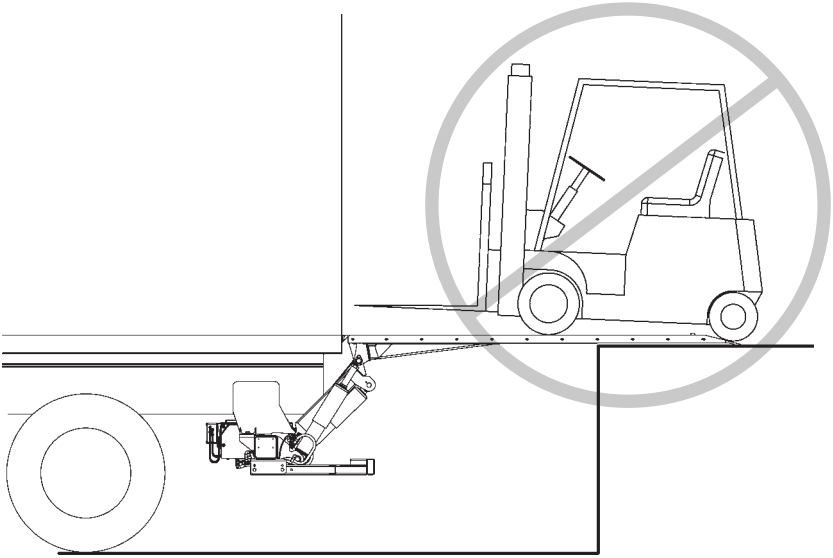
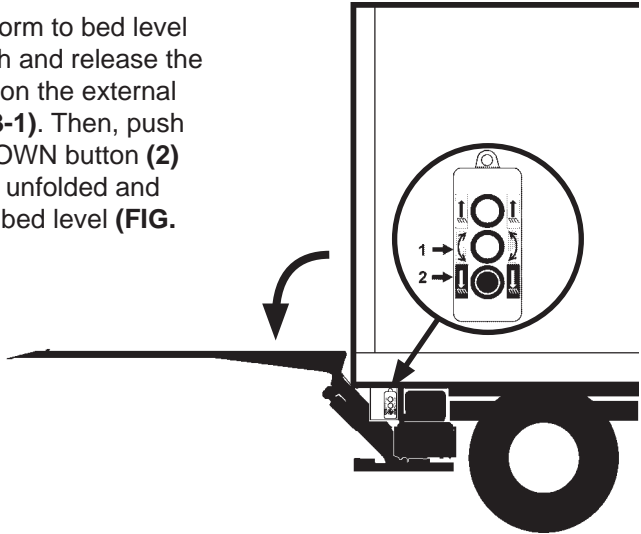

FIG. 12-1

OPERATION

NOTE: If necessary, release the down button to stop the platform from moving.

1. Unfold the platform to bed level as follows. Push and release the TILT button (1) on the external control (FIG. 13-1). Then, push and hold the DOWN button (2) until platform is unfolded and level at vehicle bed level (FIG. 13-1).



PLATFORM UNFOLDED
FIG. 13-1

2. Lower the platform to the ground as follows. Push and hold the DOWN button until heel of platform touches the ground (FIG. 13-2).

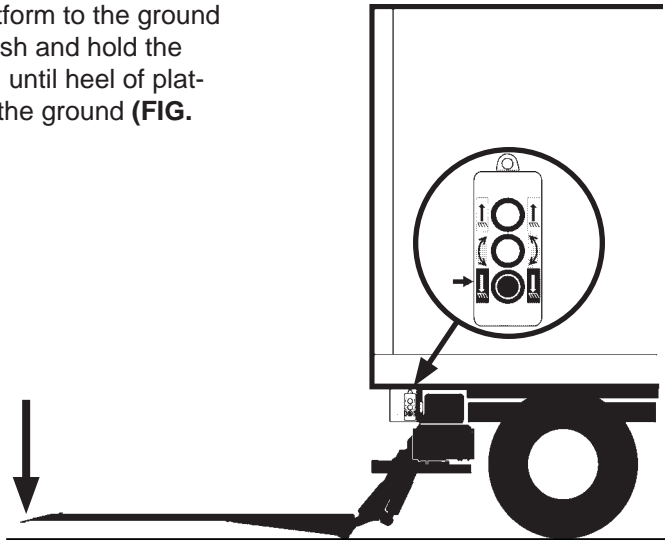

PLATFORM LOWERED
TO THE GROUND
FIG. 13-2

OPERATION - Continued

3. Tilt the tip of platform to the ground as follows. Push and hold the TILT button (1) and DOWN button (2) on the external control until tip of platform touches the ground (FIG. 14-1).

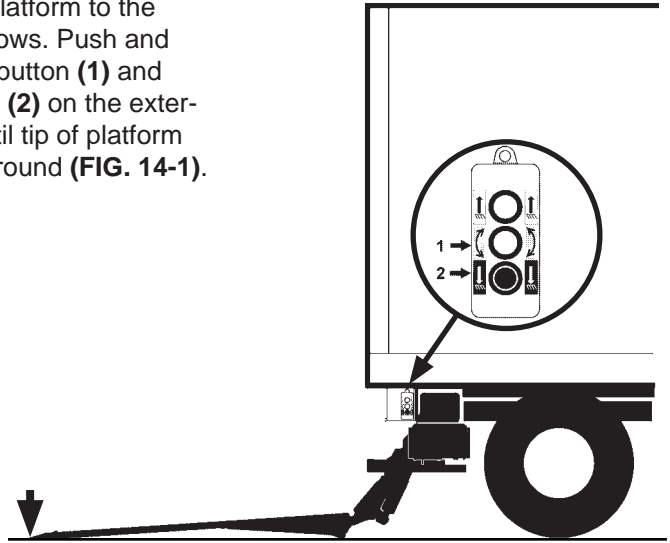

**PLATFORM TIP TILTED
TO THE GROUND
FIG. 14-1**

! WARNING

A load should never extend past the edges of the platform. Do not place unstable loads on platform and do not allow load to exceed the lifting capacity of the Liftgate. Maximum load capacity is defined with load centered 24" from heel of platform. Refer to applicable platform loading decal on vehicle and in DECALS section of this manual. If standing on platform, do not allow your feet to extend beyond the inboard edge of the platform.

4. Load the platform at ground level as follows. Make sure cart stops are closed (FIG. 15-1). Then, move load on the platform as shown in FIG. 15-1.

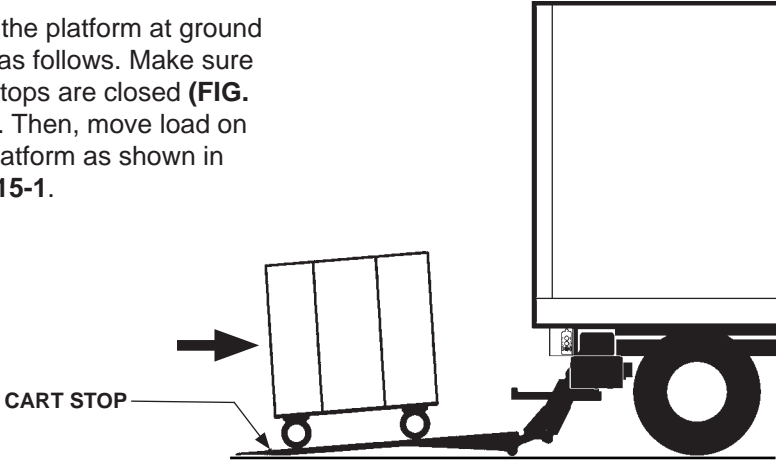

LOADING PLATFORM AT GROUND LEVEL

FIG. 15-1

5. When load is on the platform, open cart stops (FIG. 15-2).

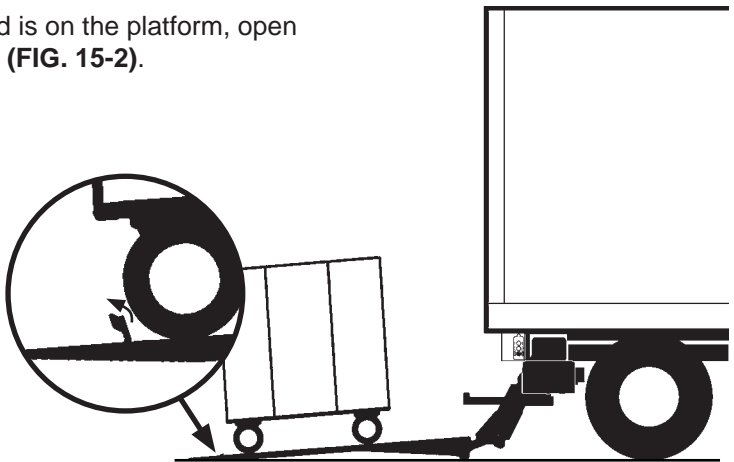

OPENING CART STOP(S)

FIG. 15-2

OPERATION - Continued

6. Tilt up the tip of platform to level position as follows. Push and hold the **TILT** button (1) and **UP** button (2) on the external control until platform is level (**FIG. 16-1**).

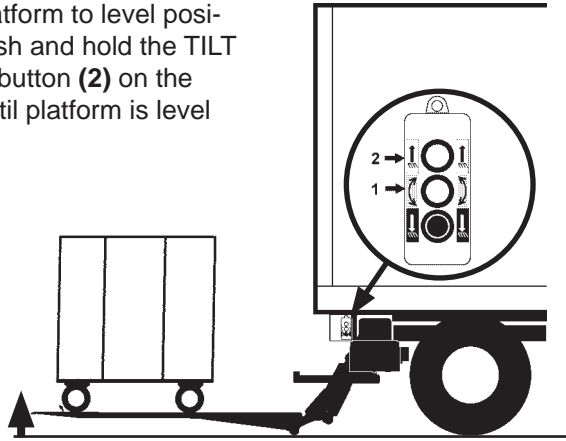

LEVELING PLATFORM
FIG. 16-1

7. To ride on the platform with load, stand in correct area. Refer to **WARNING** on previous page.

NOTE: If necessary, release the up button to stop the platform from moving.

8. Raise the platform to bed level as follows. Push and hold the **UP** button on the internal control until platform reaches bed level and butts against rear sill (**FIG. 16-2**).

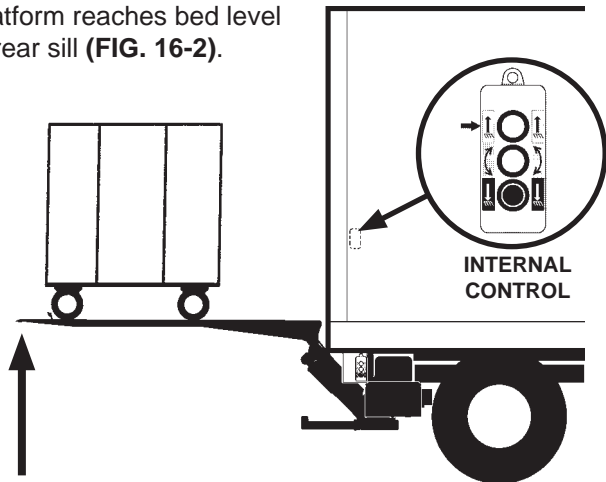

RAISING PLATFORM WITH LOAD
FIG. 16-2

9. Move load from the platform to inside the vehicle body (FIG. 17-1).

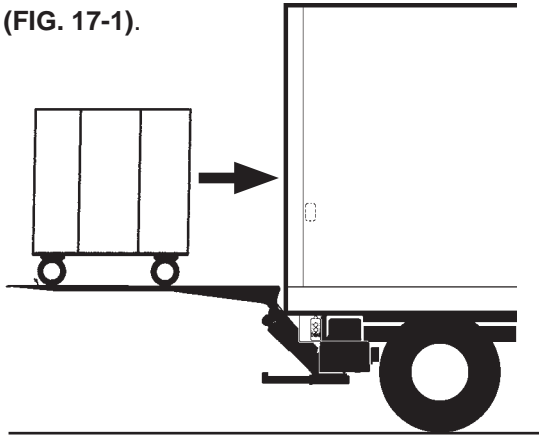

MOVING LOAD IN VEHICLE
FIG. 17-1

! WARNING

Pulling the load from vehicle to platform can result in a fall from platform and serious injury. When unloading vehicle, always push the load out on the platform.

10. Load the platform at bed level as follows. Make sure cart stop(s) are open (FIG. 17-2). Then, push load out of the vehicle body to correct position on the platform. If standing on platform with the carts, stand in the footprint area. Comply with **WARNING** on page 15.

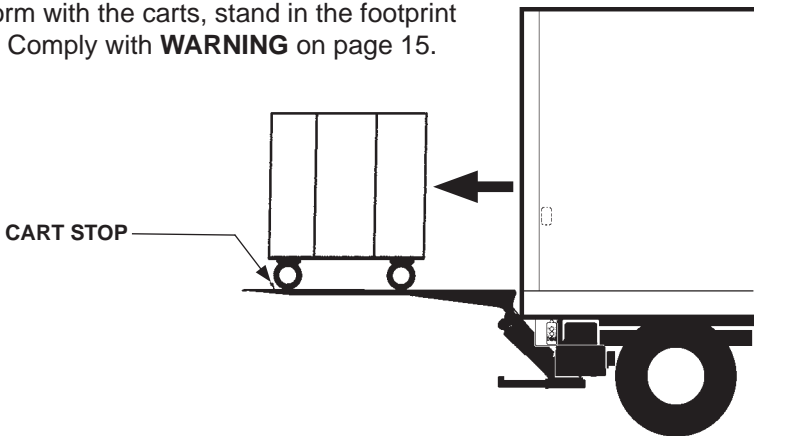

MOVING LOAD ON PLATFORM
FIG. 17-2

OPERATION - Continued

11. Lower the platform to ground level as follows. Push and hold the DOWN button until heel of platform is sitting on the ground (**FIG. 18-1**).

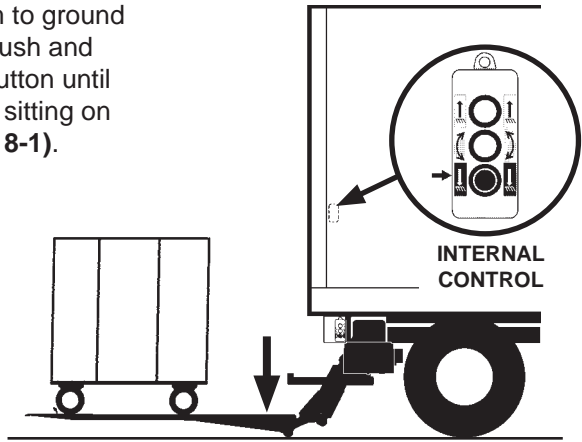

PLATFORM ON THE GROUND
FIG. 18-1

12. To move load off the platform, tilt the tip of the platform to the ground as follows. Push and hold the TILT button (1) and DOWN button (2) on the external control until tip of platform is on the ground (**FIG. 18-2**).

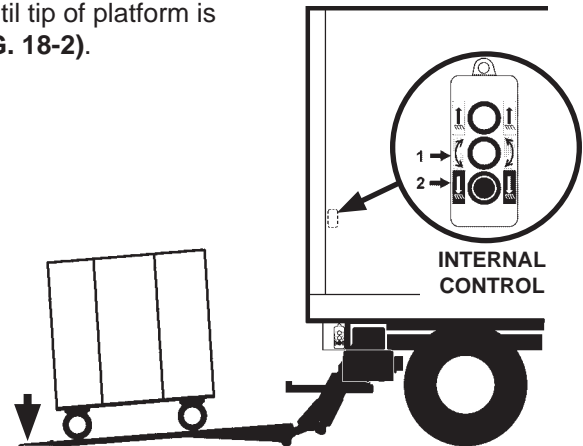

TILTING PLATFORM TO THE GROUND
FIG. 18-2

13. Close cart stop(s) (**FIG. 19-1**).
Then, move cart off the platform
as shown in **FIG. 19-2**.

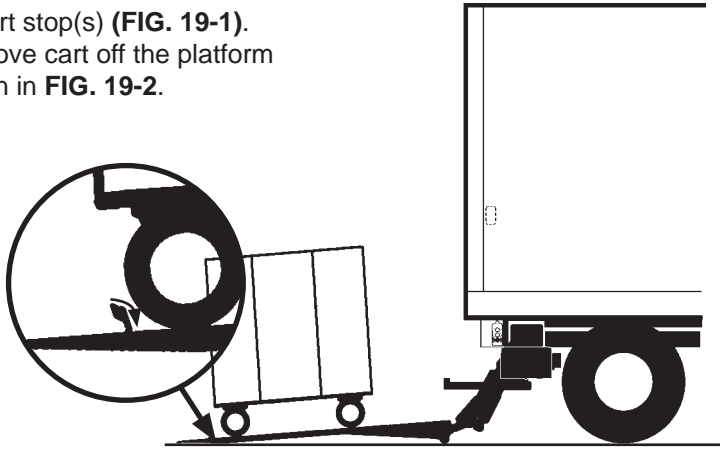

CLOSING CART STOPS
FIG. 19-1

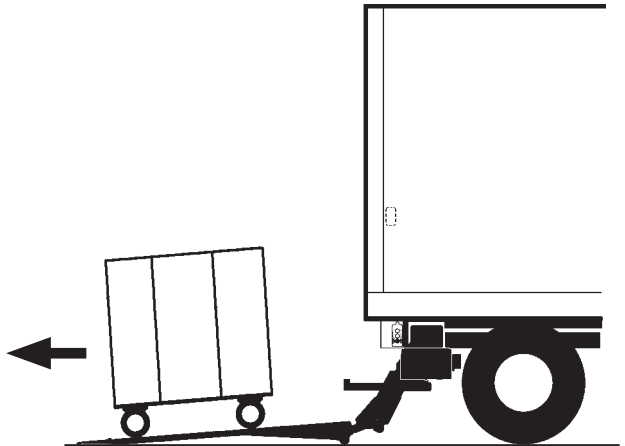

MOVING LOAD OFF PLATFORM
FIG. 19-2

OPERATION - Continued

WARNING

Never move the vehicle unless the Liftgate is properly stowed.

NOTE: If necessary, release the toggle switch to stop the platform from moving.

14. Before moving the vehicle, prepare the Liftgate as follows.
15. Tilt up the tip of platform to level position as follows. Push and hold the TILT button (1) and UP button (2) on the external control until platform is level (**FIG. 20-1**).

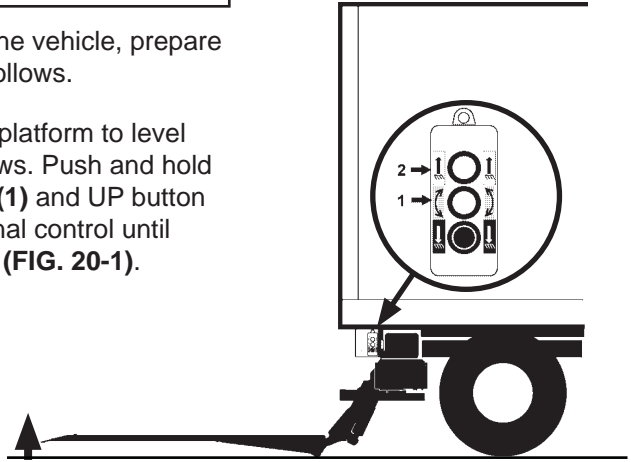

PLATFORM LOWERED TO THE GROUND
FIG. 20-1

16. Raise the platform to bed level as follows. Push and hold the UP button on the external control (**FIG. 20-2**) until platform reaches vehicle bed level (**FIG. 20-2**).

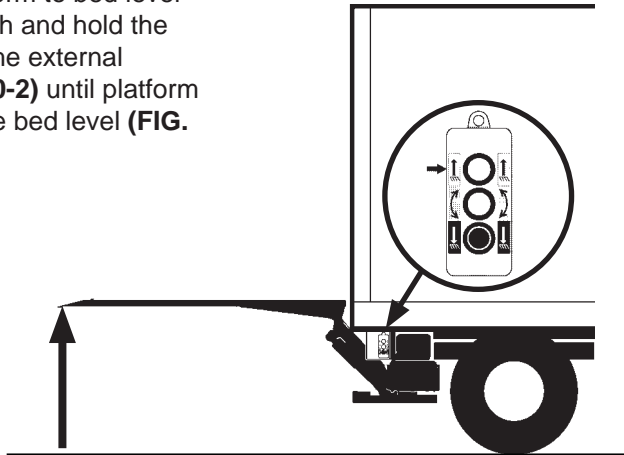

PLATFORM RAISED TO BED LEVEL
FIG. 20-2

17. Stow the platform as follows.
Push and hold the TILT button (1)
and UP button (2) on the external
control until platform is folded
against vehicle body (FIG. 21-1).

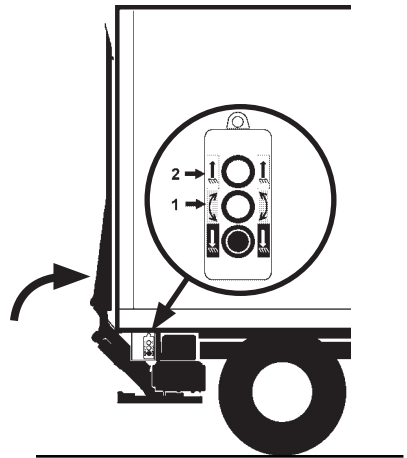

STOWING PLATFORM
FIG. 21-1

18. Vehicle is ready to move.

