

INSTRUCTIONS, C2 LATCH REPLACEMENT

C2 (PICKUP) LATCH REPLACEMENT KIT, P/N 295467-01 (2017)

C2 (STAKEBED) LH LATCH REPLACEMENT KIT, P/N 295494-01 (2583)

C2 (STAKEBED) RH LATCH REPLACEMENT KIT, P/N 295494-02 (2584)

⚠ WARNING

To prevent accidental personal injury and equipment damage, disconnect (-) battery cable from battery.

1. Disconnect ground (-) battery cable from vehicle battery.

2. Unfold the platform (FIG. 1-1). Refer to **C2 Operation Manual** for instructions.

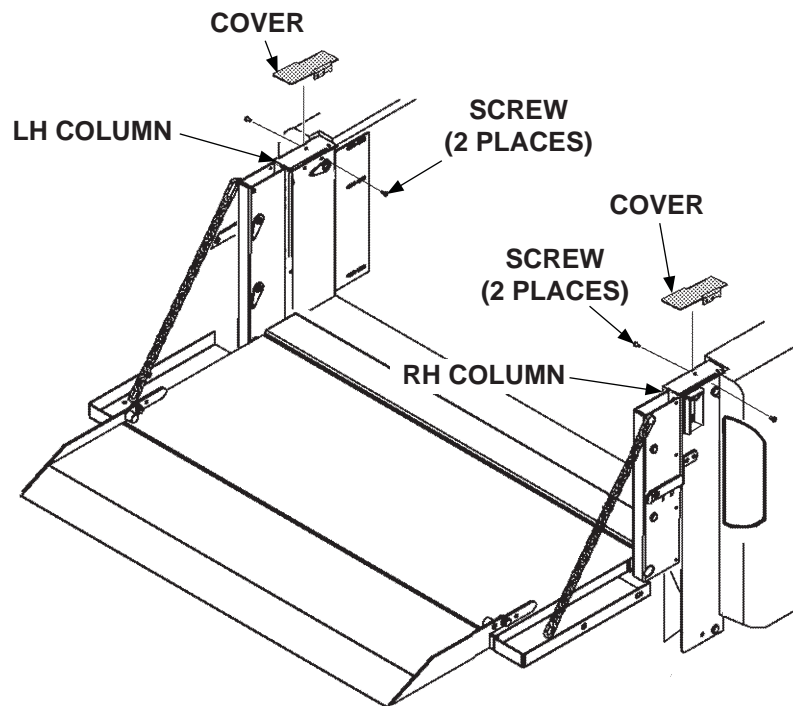

UNBOLTING COLUMN COVERS
FIG. 1-1

3. Unbolt the cover from RH column to replace RH latch, and/or from LH column to replace LH latch (FIG. 1-1).

4. If the RH latch is being replaced, remove three 1/4"-20 self-tapping screws from back of the control box (FIG. 2-1). Move control box enough to gain access to lock nuts and compression spring inside the column (FIG. 2-1).

5. Unbolt latch, 3/8" flat washer, compression spring, and 3/8"-16 lock nut from RH and/or LH column (FIG. 2-1). Discard the old latch, cap screw, flat washer, spring and lock nut.

6. Unbolt 1/4"-20 socket head screw, 1/4" lock washer, and 1/4"-20 lock nut from RH and/or LH column (FIG. 2-1). Discard the old socket head screw, lock washer, and lock nut.

7. Fasten 1/4"-20 socket head screw, 1/4" lock washer, and 1/4"-20 lock washer (Kit items) to RH and/or LH column (FIG. 2-1).

NOTE: Before tightening latch bolt, ensure latch is correctly seated on on the head of the socket screw.

8. Position new RH latch and/or LH latch (Kit items) on RH and/or LH column and over the head of the socket screw (FIG. 2-1). Next, bolt the new latch, flat washer, and spring (Kit items) to column as shown in FIG. 2-1. Then, tighten bolt and lock nut until latch spring is compressed to correct dimension shown in FIG. 2-2.

9. If the RH latch was replaced, put control box in correct position inside the column (FIG. 2-1). Fasten control box to column with three 1/4"-20 self-tapping screws (FIG. 2-1).

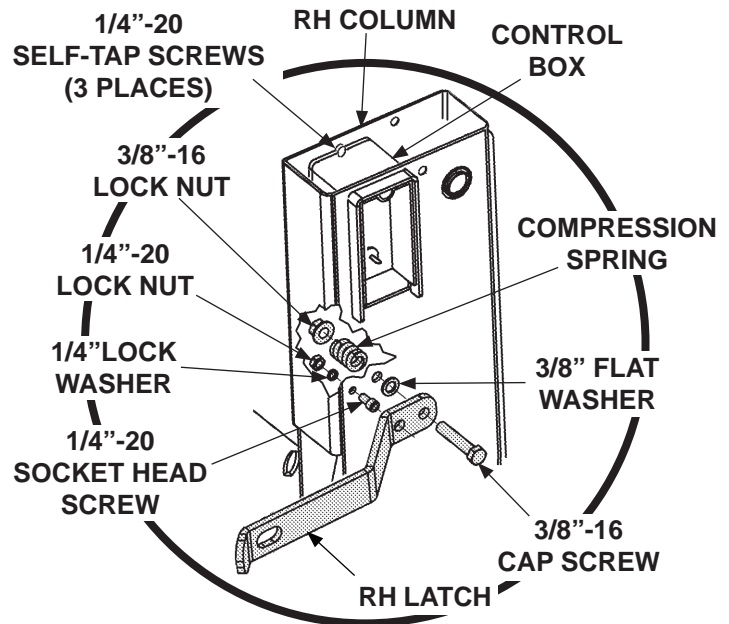

RH LATCH & FASTENERS FOR PICKUP LIFTGATE
FIG. 2-1

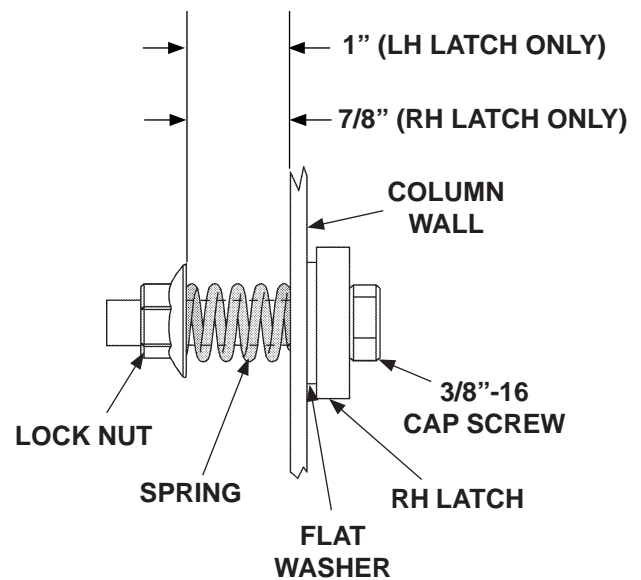

RH LATCH SPRING COMPRESSED TO CORRECT LENGTH
FIG. 2-2

ADJUST LATCH PIN (IF REQUIRED)

1. Fold the platform (**FIG. 3-1**). Ensure the RH latch captures the pin on the RH side of the platform (**FIG. 3-1A**). Also ensure there is no interference between pin and latch.
2. If there is interference between the latch and pin (**FIG. 3-1A**), loosen the locknut on the pin enough to move the pin (**FIG. 3-1B**). Center the pin, as much as possible, within the slotted hole on the latch (**FIG. 3-1A**). Then, tighten lock nut (**FIG. 3-1B**). If necessary, repeat for LH latch.

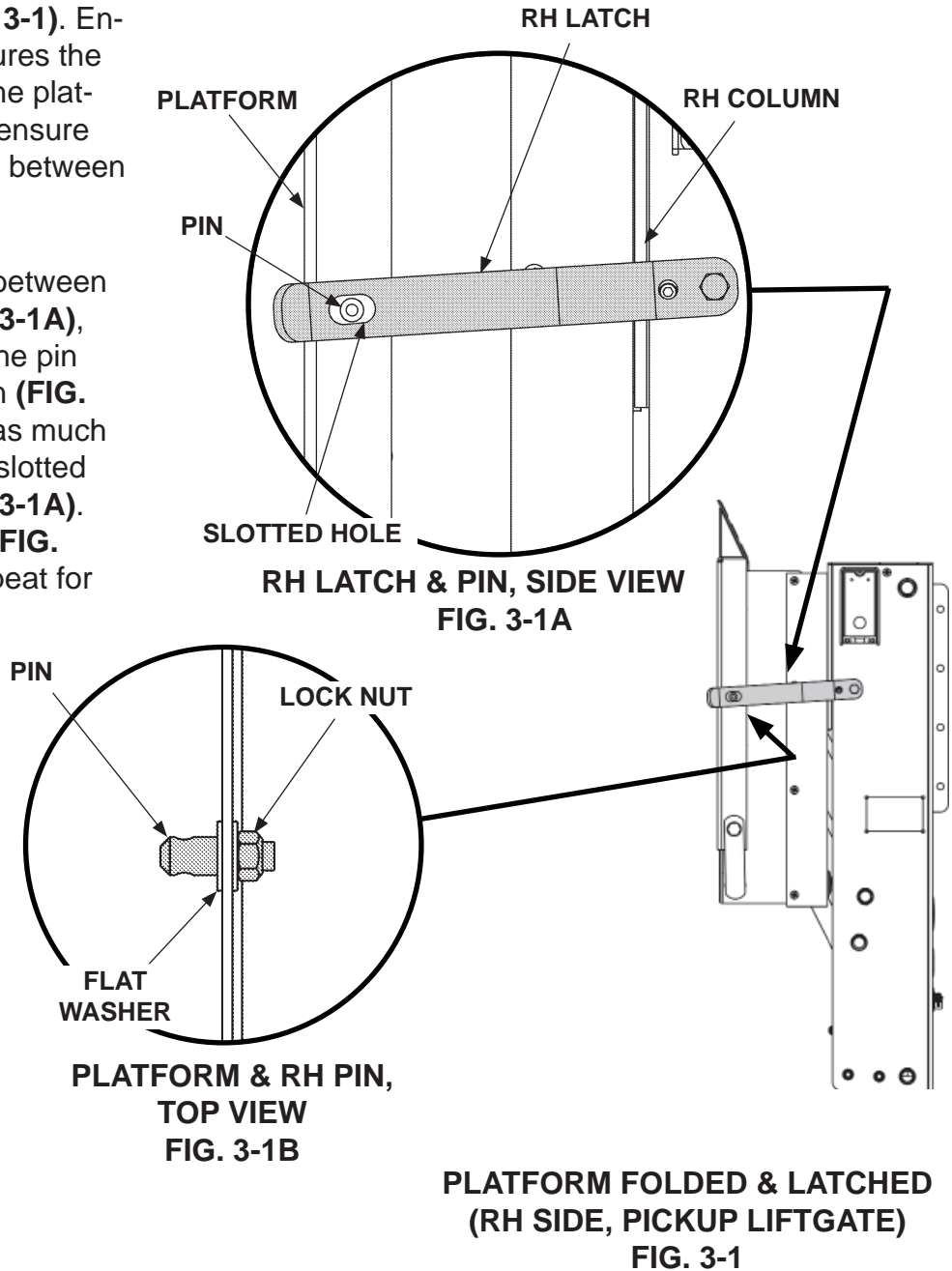

REINSTALL COLUMN COVERS

1. Bolt cover on RH column and/or LH column (**Sht. 1, FIG. 1-1**).
2. Reconnect ground (-) battery cable to vehicle battery.